



FORD 2017-20 F-250 Rear Bumper

Thank you for choosing Rough Country for all your vehicle needs.

Please read instructions before beginning installation. Check the kit hardware against the kit contents shown below. Be sure you have all needed parts and know where they go.

If question exist, please call us @1-800-222-7023. We will be happy to answer any questions concerning this product.

Check all fasteners for proper torque. Check to ensure for adequate clearance between all components.

Periodically check all hardware for tightness.

KIT CONTENTS:
 Rear Bumper x1
 Sensor Mounting Kit x1

TOOLS NEEDED:
 2.5mm Allen Wrench
 4mm Allen Wrench
 15mm Socket
 21mm Socket
 Ratchet

HARDWARE INCLUDED:
 4mm x 10mm Socket Head Bolts x8
 12mm x 35mm Hex Bolt x4
 12mm Hex Nut x4
 12mm Flat Washer x8
 12mm Lock Washer x4
 Plastic License Plate Mount x2



Torque Specs:

Size	Grade 5	Grade 8	Size	Class 8.8	Class 10.9
5/16"	15 ft/lbs	20ft/lbs	6MM	5ft/lbs	9ft/lbs
3/8"	30 ft/lbs	35ft/lbs	8MM	18ft/lbs	23ft/lbs
7/16"	45 ft/lbs	60ft/lbs	10MM	32ft/lbs	45ft/lbs
1/2"	65 ft/lbs	90ft/lbs	12MM	55ft/lbs	75ft/lbs
9/16"	95 ft/lbs	130ft/lbs	14MM	85ft/lbs	120ft/lbs
5/8"	135ft/lbs	175ft/lbs	16MM	130ft/lbs	165ft/lbs
3/4"	185ft/lbs	280ft/lbs	18MM	170ft/lbs	240ft/lbs



INSTALLATION INSTRUCTIONS

1. Disconnect the wiring harness from the 7 pin trailer plug on the inside of the bumper. **See Photo 1.**
2. Disconnect the backup sensor and the license plate wiring harness. **See Photo 2.**

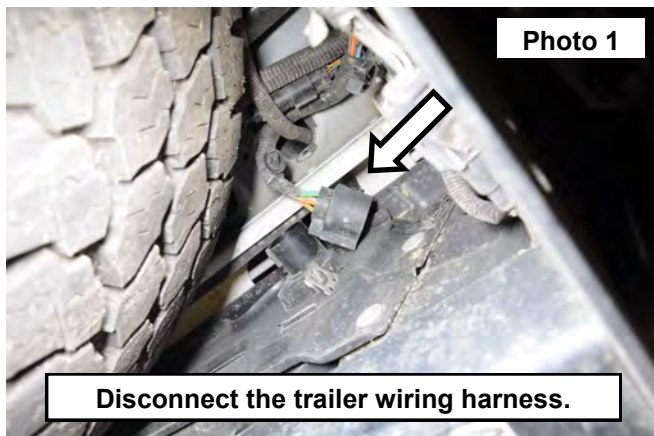

3. Using a 15mm socket remove the two bolts in the center of bumper. **See Photo 3.**
4. Using a 21mm socket remove the 6 nuts and flag bolts from frame on each side of the bumper. **See Photo 4.**

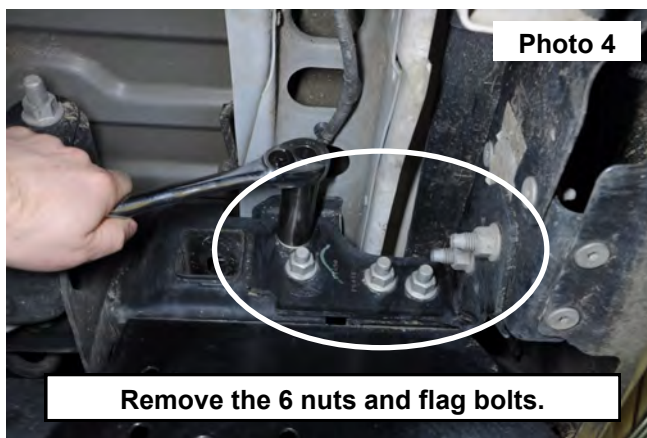
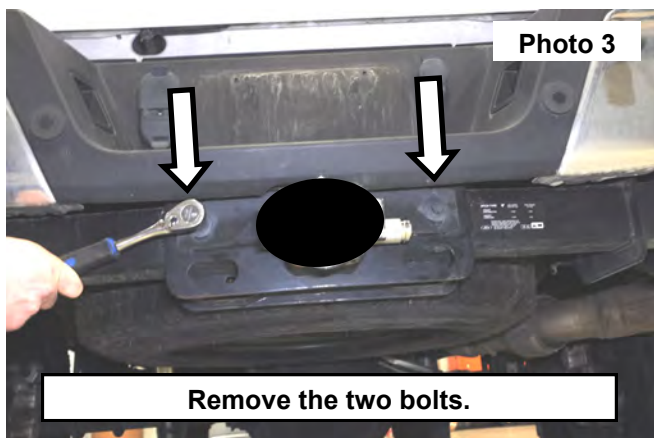

5. Remove the bumper from the vehicle.
6. Remove the 12 bolts in the bumper support brackets on each side using a 45 Torx bit. **See Photo 5.**
7. Unclip the 7 pin trailer plug from the bumper and remove. **See Photo 6.** Retain plug for later use.

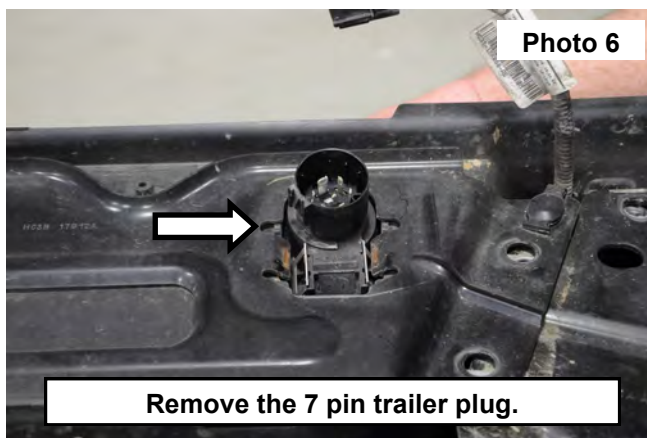
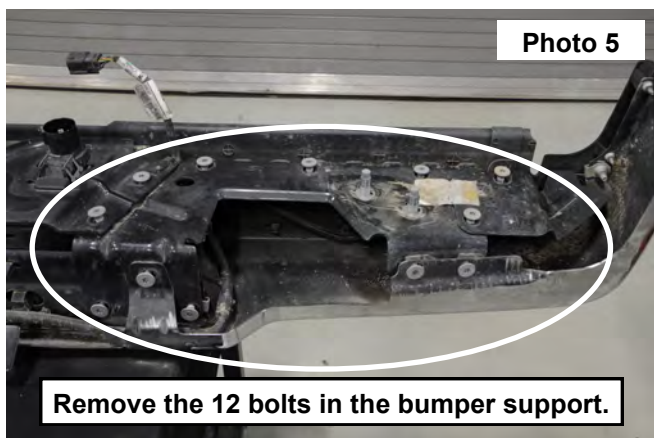

8. Then remove the support brackets in place to gain access to proximity sensors and wiring harness. **See Photo 7.**
9. Disconnect the proximity sensors and license plate light plugs. **See Photo 8.**

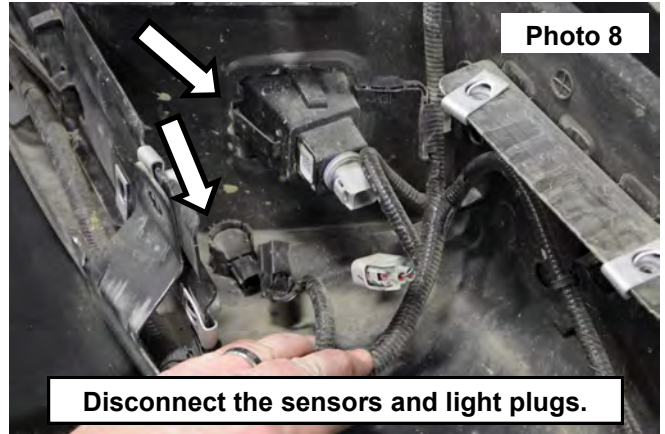
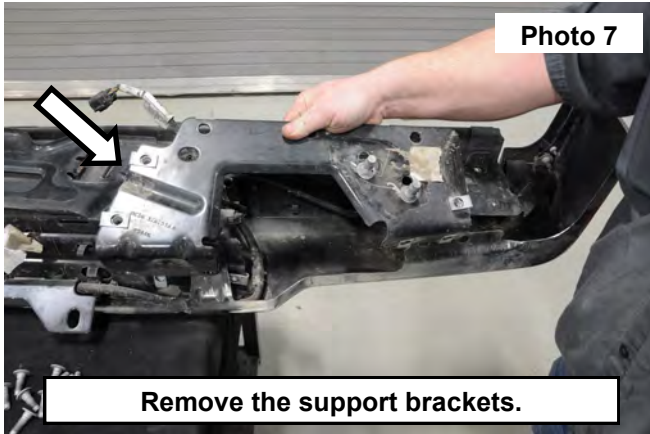

10. Remove the wiring harness from the bumper. **See Photo 9.**
11. Use care and remove the proximity sensors and license plate lights from the bumper. **See Photo 10.**

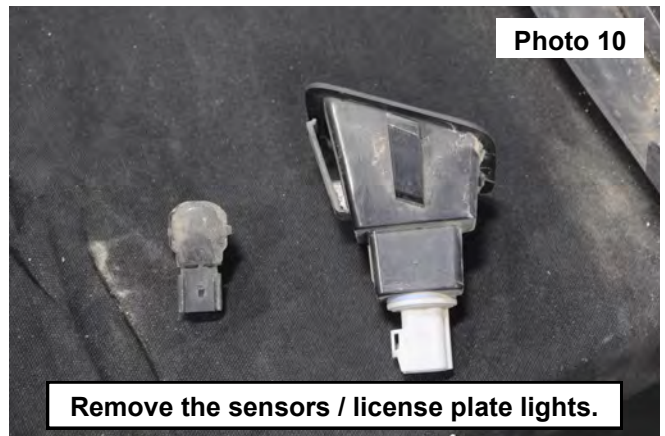
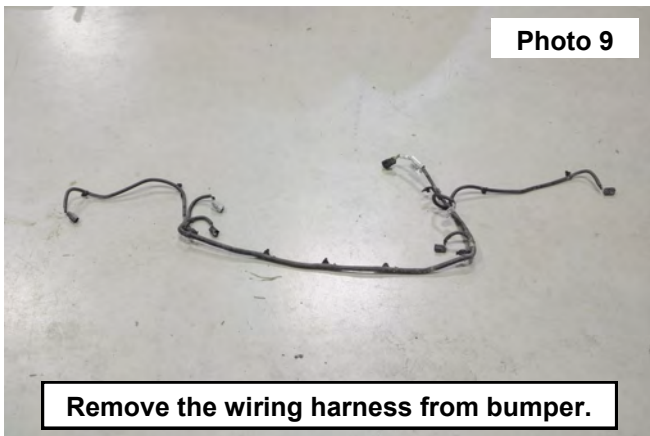

12. Use the ignition key to remove the spare tire lock from the bumper. **See Photo 11.**
13. Install the 7 pin trailer plug and the license plate lights into the bumper. **See Photo 12.**



14. Install the spare tire lock into the bumper. **See Photo 13.**
15. Install the flush mount lights using the hardware supplied with the light kit. **See Photo 14.**



16. Tighten the bolts in the lights using a 4mm allen wrench and a 10mm wrench. **See Photo 15.**
17. Install the proximity sensors into the bumper. Secure using 2 of the supplied 4mm button head bolts in each sensor using a 2.5mm allen wrench. Do not over tighten and damage the sensor. **See Photo 16.**
18. If the vehicle is not equipped with the proximity sensors install the Sensor rubber plug kit.

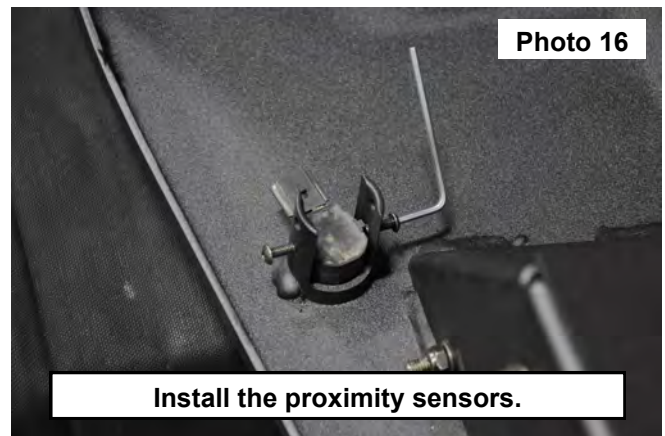
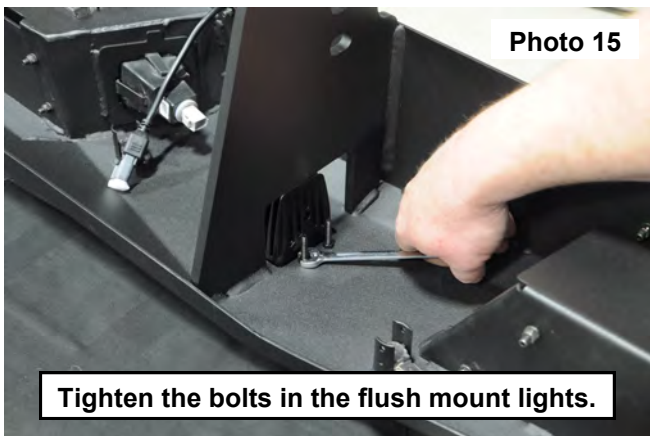

19. Connect the wiring harness to the proximity sensors and the license plate lights on each side of the bumper. **See Photo 17.**
20. Install the bumper onto the vehicle. Use stands to hold the bumper in place. **See Photo 18.**

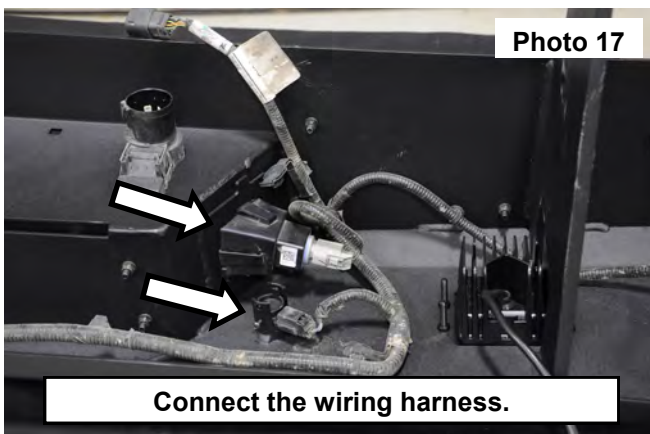

21. Secure the bumper using the OE flag bolts and nuts. Adjust the bumper to the desired height and tighten using a 21mm socket. **See Photos 19 and 20.**

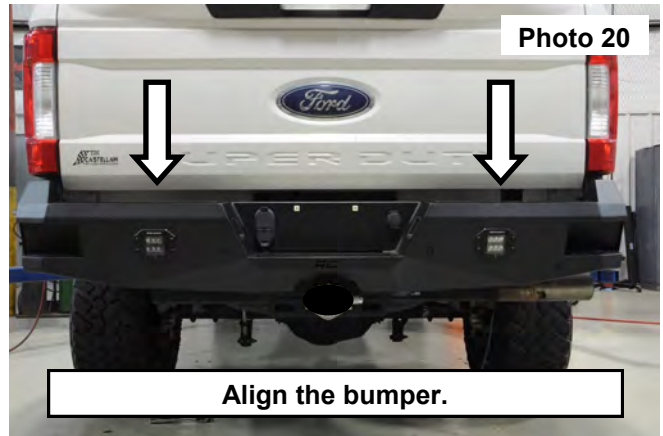
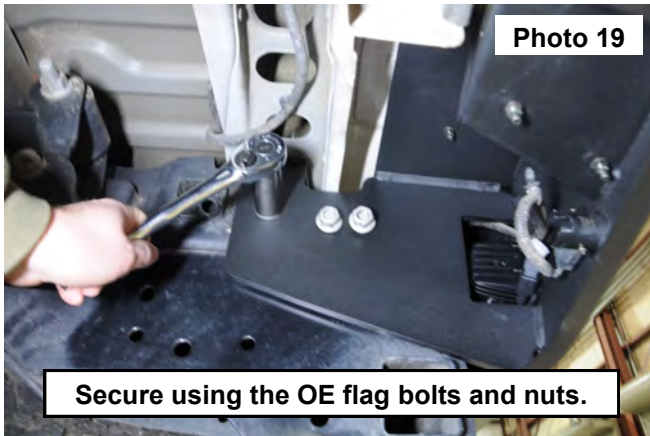

22. Connect the 7 pin trailer wiring harness to the bumper plug. **See Photo 21.**

23. Connect the proximity sensor and the license plate light wiring harness together. **See Photo 22.**

24. Install the wiring harness supplied with the LED light kit using the corresponding instruction sheet supplied with the light kit. Then connect the wiring harness to the flush mount lights.

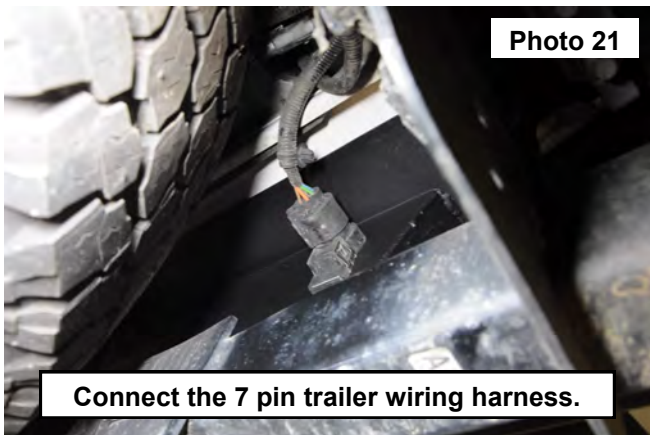

25. Install the license plate plastic plugs and reinstall license plate. **See Photos 23 and 24.**

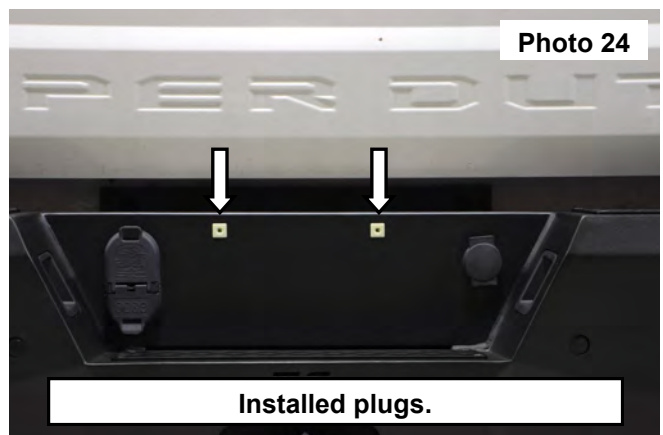
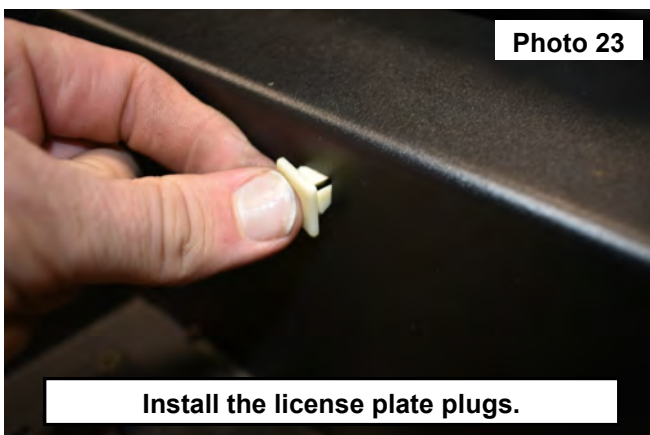

By purchasing any item sold by Rough Country, LLC, the buyer expressly warrants that he/she is in compliance with all applicable, State, and Local laws and regulations regarding the purchase, ownership, and use of the item. It shall be the buyers responsibility to comply with all Federal, State and Local laws governing the sales of any items listed, illustrated or sold. The buyer expressly agrees to indemnify and hold harmless Rough Country, LLC for all claims resulting directly or indirectly from the purchase, ownership, or use of the items.



