

ROUGH COUNTRY

SUSPENSION SYSTEMS®

JEEP 2018-UP JL / 2020 GLADIATOR REAR TUBE DOORS

Thank you for choosing Rough Country for all your vehicle needs.

Please read instructions before beginning installation. Check the kit hardware against the kit contents shown below. Be sure you have all needed parts and know where they go.

If question exist, please call us @1-800-222-7023. We will be happy to answer any questions concerning this product.

Check all fasteners for proper torque. Check to ensure for adequate clearance between all components.

Periodically check all hardware for tightness.

KIT CONTENTS:

Driver Side Rr Tube Door x1
 Passengers Side Rr Tube Door x1
 Door Latch Mounting Bracket x2
 Driver Side Door Latch x1
 Passengers Side Door Latch x1
 Door Latch shims x8
 Rubber Snubber x2

TOOLS NEEDED:

T40 Torx Bit
 10mm wrench or socket
 13mm wrench or socket
 Ratchet

HARDWARE INCLUDED:

6mm Lock Washer x4
 6mm Flat Washer x12
 6mm x 25mm Button Head Bolt x8
 6mm Lock Nut x4
 8mm Lock Nut x4
 8mm Flat Washer x4
 Included Tool 4mm Allan Wrench



Torque Specs:

| Size | Grade 5 | Grade 8 | Size | Class 8.8 | Class 10.9 |
|-------|-----------|-----------|------|-----------|------------|
| 5/16" | 15 ft/lbs | 20ft/lbs | 6MM | 5ft/lbs | 9ft/lbs |
| 3/8" | 30 ft/lbs | 35ft/lbs | 8MM | 18ft/lbs | 23ft/lbs |
| 7/16" | 45 ft/lbs | 60ft/lbs | 10MM | 32ft/lbs | 45ft/lbs |
| 1/2" | 65 ft/lbs | 90ft/lbs | 12MM | 55ft/lbs | 75ft/lbs |
| 9/16" | 95 ft/lbs | 130ft/lbs | 14MM | 85ft/lbs | 120ft/lbs |
| 5/8" | 135ft/lbs | 175ft/lbs | 16MM | 130ft/lbs | 165ft/lbs |
| 3/4" | 185ft/lbs | 280ft/lbs | 18MM | 170ft/lbs | 240ft/lbs |



INSTALLATION INSTRUCTIONS

1. Locate and remove the rear trim panel on the center post of the vehicle. **See Photo 1.** Save for reinstallation.
2. Release the clip and unplug the door power plug. **See Photo 2.**

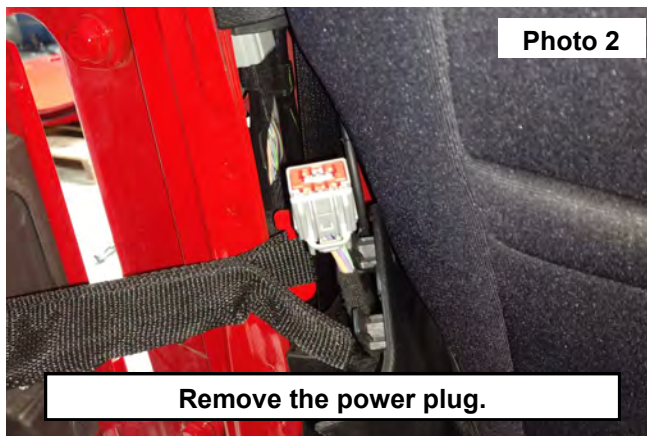
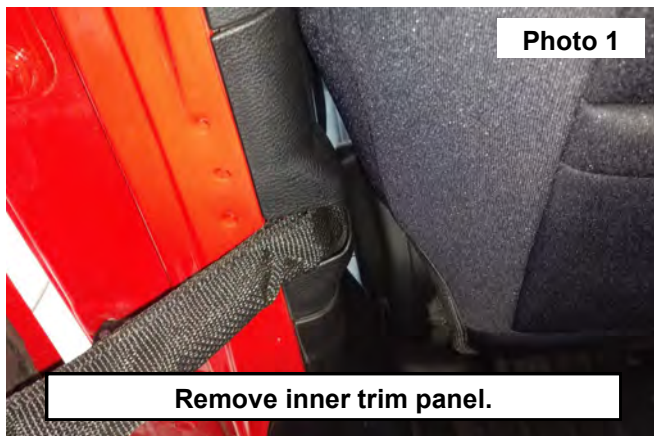

3. Disconnect the tether from the hook. **See Photo 3.**
4. Using a T40 torx bit remove the door stop from the body of the vehicle. **See Photo 4.** Retain hardware for reinstallation of the doors.

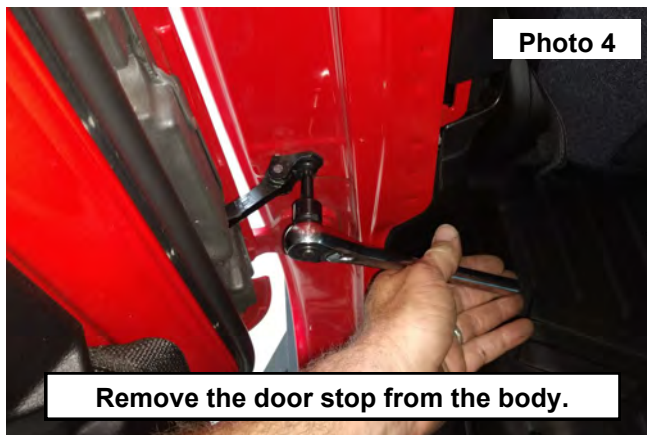
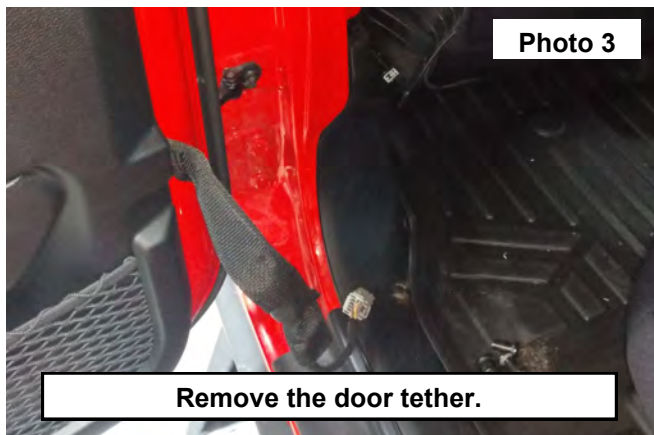

5. Using a T45 torx bit remove the upper and lower nuts from the bottom of the hinge pin. **See Photos 5.** Retain hardware for later use when the factory doors are re-installed onto the vehicle.
6. Lifting up releasing the door hinge from the body of the vehicle. Remove the rear door from the vehicle taking care not to damage the surrounding area. **See Photo 6.** Set aside in a safe place on padding and cover to prevent damage.

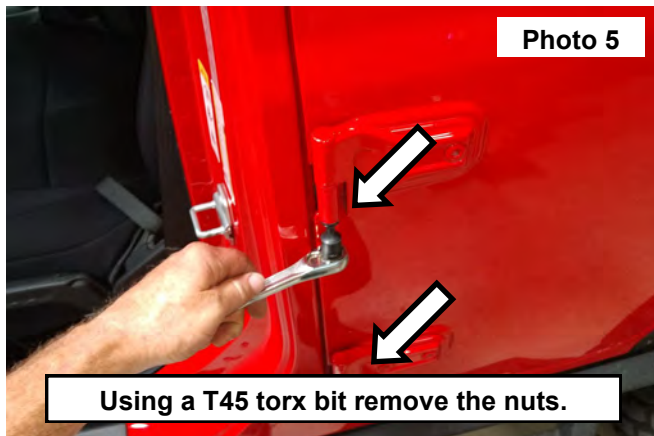

7. Install new Rough Country tube door onto the vehicle. **See Photo 7.**
8. Hook the tube doors tether onto the body mount hook. Then reinstall the inner trim panel. **See Photo 8.**



9. Install the door latch plate onto the tube door using 2 of the supplied 6mm x 25mm button head bolt, (4) 6mm flat washers and (2) 6mm nylock nut. Snug hardware using a 4mm allen wrench and a 10mm open end wrench. **See Photo 9.**
10. Install the door latch onto the latch plate with the latch release pointed down as shown using 2 of the supplied 6mm x 25mm button head bolt, (2) 6mm flat washers. Snug hardware using a 4mm allen wrench. **See Photo 10.** If needed install the shim plates between the latch plate and the tube door to allow the latch to function properly.
11. Snug all hardware down then shut the door setting the latch to the desired position. Open the tube door then tighten all installed hardware using a 4mm allen wrench and a 10mm wrench.



12. Install the rubber snubber (if not already installed) in the bottom mount of the door. **See Photo 11.**
13. Install the supplied 8mm flat washers and nuts on the bottom of the studs. Snug down using a 13mm wrench, then back off half of a round to free up the door. **See Photo 12.**

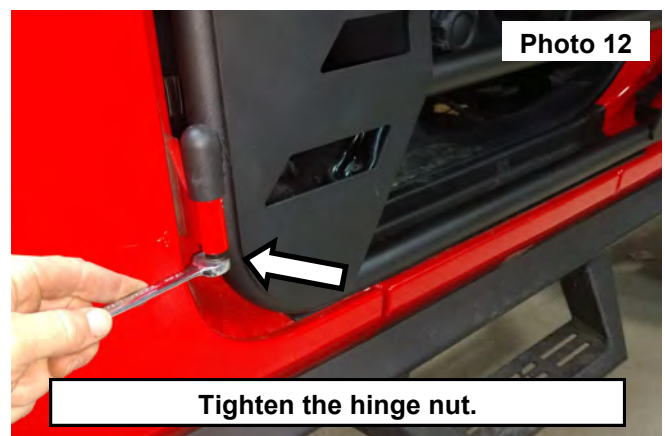
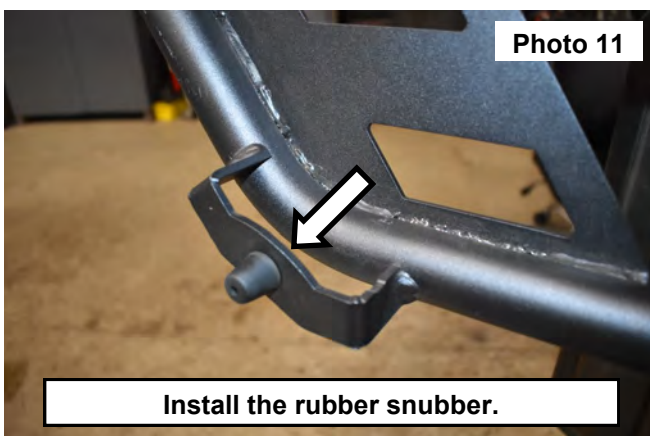

By purchasing any item sold by Rough Country, LLC, the buyer expressly warrants that he/she is in compliance with all applicable, State, and Local laws and regulations regarding the purchase, ownership, and use of the item. It shall be the buyers responsibility to comply with all Federal, State and Local laws governing the sales of any items listed, illustrated or sold. The buyer expressly agrees to indemnify and hold harmless Rough Country, LLC for all claims resulting directly or indirectly from the purchase, ownership, or use of the items.

