



CAN-AM 2017-20 HD10,HD8,HD5 Defender Cargo Rack

Thank you for choosing Rough Country for all your vehicle needs.

Please read instructions before beginning installation. Check the kit hardware against the kit contents shown below. Be sure you have all needed parts and know where they go.

If questions exist, please call us @1-800-222-7023. We will be happy to answer any questions concerning this product. Check all fasteners for proper torque. Check to ensure for adequate clearance between all components. Periodically check all hardware for tightness.

⚠ WARNING This rack allows a load to be carried at an elevated level over the vehicle. Carrying an elevated load can cause the vehicle to become top heavy and easier to roll. Use caution when carrying an elevated load. Seatbelts and shoulder harnesses should be worn at all times. Avoid situations where a rollover may occur. Be sure contents carried on the rack are secure and will not shift during travel.

KIT CONTENTS:

- Cargo Rack Driver x1
- Cargo Rack Passenger x1
- Driver Side Gusset x1
- Passengers side Gusset x1
- Floor Stiffener x1
- Flat Panel x1
- Outside End Cap x1

TOOLS NEEDED:

- 5mm Allen Wrench
- 4mm Allen Wrench
- 13mm Socket
- 10mm Socket
- 5/16" Drill
- Drill Motor

HARDWARE INCLUDED:

- 8mm x 25mm Button Head Bolt x10
- 8mm Flat Washer x16
- 8mm Nylock Nut x6
- 6mm Nylock Nut x20
- 6mm x 20mm Button Head Bolt x20
- 6mm Flat Washer x20



Torque Specs:

Size	Grade 5	Grade 8	Size	Class 8.8	Class 10.9
5/16"	15 ft/lbs	20ft/lbs	6MM	5ft/lbs	9ft/lbs
3/8"	30 ft/lbs	35ft/lbs	8MM	18ft/lbs	23ft/lbs
7/16"	45 ft/lbs	60ft/lbs	10MM	32ft/lbs	45ft/lbs
1/2"	65 ft/lbs	90ft/lbs	12MM	55ft/lbs	75ft/lbs
9/16"	95 ft/lbs	130ft/lbs	14MM	85ft/lbs	120ft/lbs
5/8"	135ft/lbs	175ft/lbs	16MM	130ft/lbs	165ft/lbs
3/4"	185ft/lbs	280ft/lbs	18MM	170ft/lbs	240ft/lbs



INSTALLATION INSTRUCTONS

1. Stand the cargo rack onto each end with the bottom of the rack facing together. **See Photo 1.**
2. Insert the floor stiffener onto the bottom of the rack and secure using (8) 6mm x 20mm Button Head Bolts (8) Flat Washers and (8) Nylock Nuts. Do not tighten at this time. **See Photo 2.**

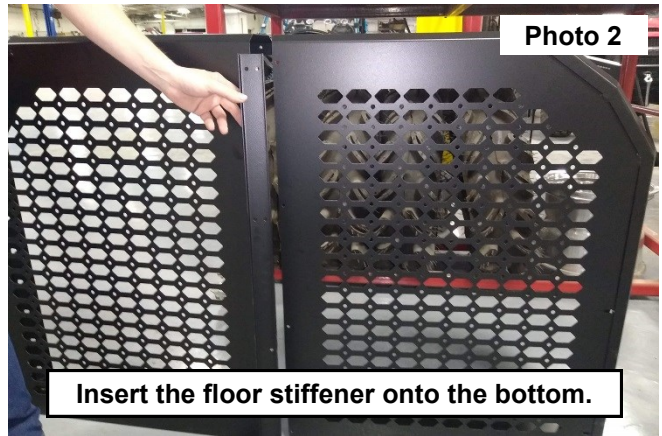
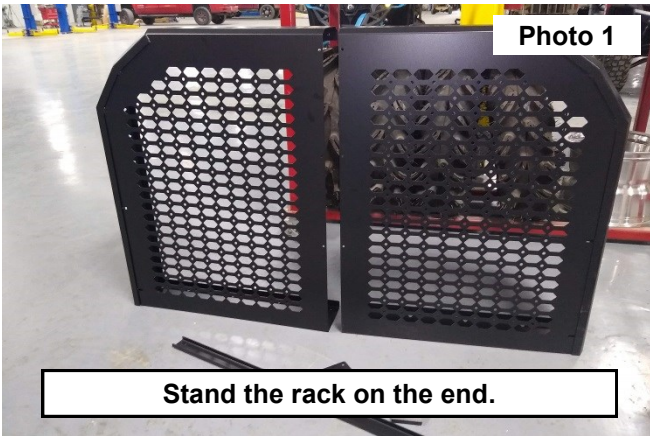

3. Install the flat connector onto the flat end of the rack and secure using (6) 6mm x 20mm Button Head Bolts (6) Flat Washers and (6) Nylock Nuts. Do not tighten at this time. **See Photo 3.**
4. Install the outside end cap onto the center of the racks and secure using (6) 6mm x 20mm Button Head Bolts (6) Flat Washers and (6) Nylock Nuts. Do not tighten at this time. **See Photo 4.**

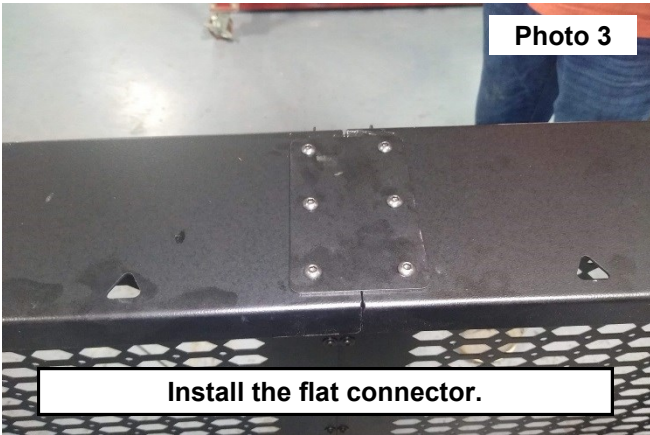

5. Install (2) of the 8mm x 25mm Button Head Bolts (2) 8mm Flat Washers into the top of the cargo rack. **See Photo 5.**
6. Install the gusset onto the bottom of the cargo rack, aligning the holes with the installed bolts and secure using (2) 8mm Flat Washers and (2) 8mm Nylock Nuts. Do not tighten at this time. **See Photo 6.**
7. Repeat steps 5 & 6 for gusset on opposite side.

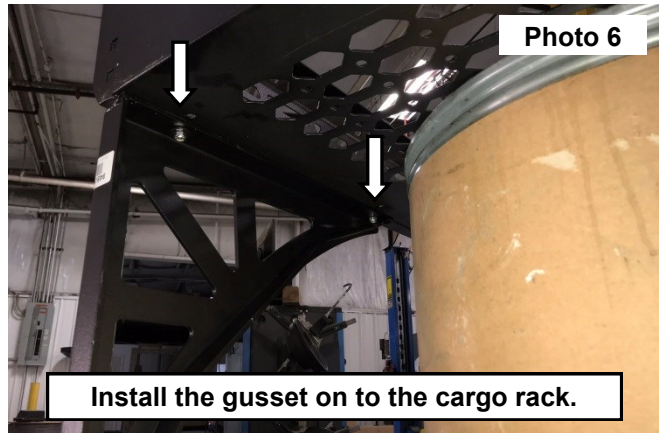
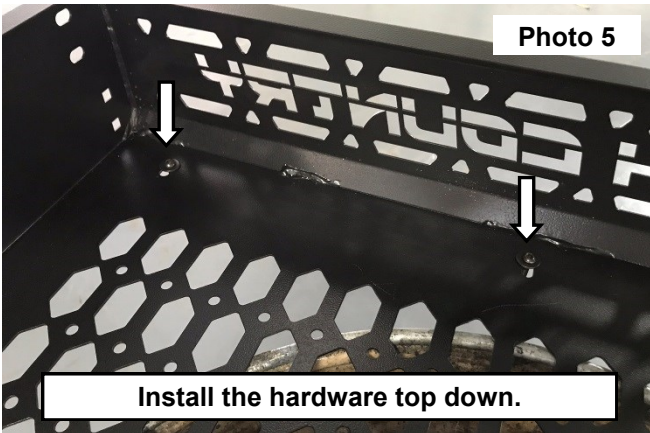

8. Support the cargo rack and install at the top of the roll cage on the UTV.
9. Secure the cargo rack using the factory mounts on the top rear of the roll cage. **See Photo 7.**
10. Secure the cargo rack using (2) of the supplied 8mm x 25mm button head allen bolts and (2) 8mm flat washers into the top slotted holes, inside the cargo rack, to the roll cage on each side of the UTV. Tighten using a 5mm allen wrench. **See Photo 8.**

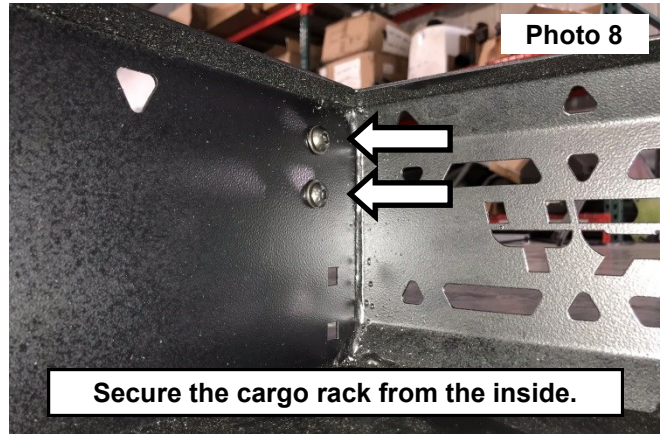

11. Adjust the cargo rack to the desired look and tighten the gusset to the cargo rack. Use a 5mm allen wrench and a 13mm socket. **See Photo 9.**
12. Using the gusset as a template, transfer the hole from the bottom of the gusset into the roll cage support using a 5/16" drill bit. **See Photo 10.**

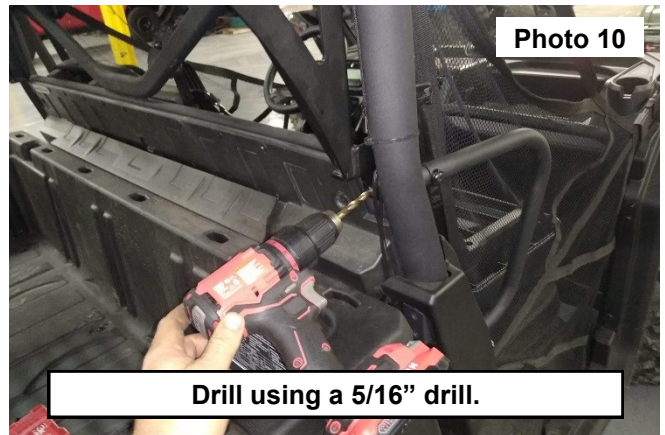

13. Secure the gusset to the cage using (1) of the supplied 8mm x 25mm button head bolt, (2) 8mm flat washers and (1) 8mm nylock nut. Tighten using a 5mm allen wrench and a 13mm wrench on the nut. **See Photos 11 and 12.**
14. Repeat steps 11-12 on the opposite side.

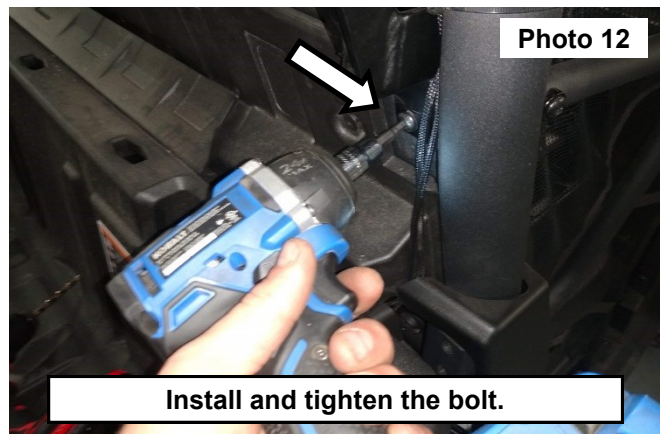
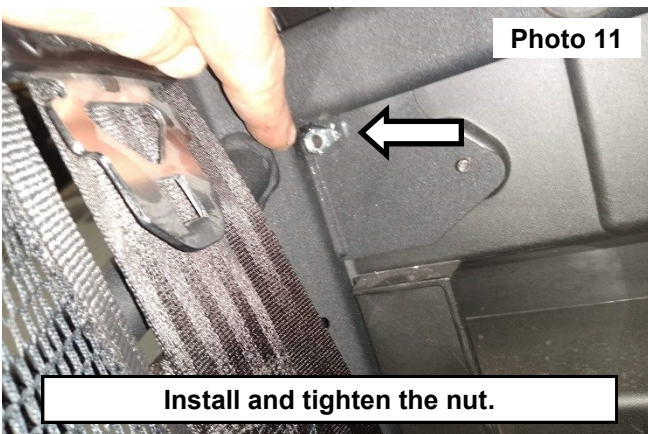



By purchasing any item sold by Rough Country, LLC, the buyer expressly warrants that he/she is in compliance with all applicable, State, and Local laws and regulations regarding the purchase, ownership, and use of the item. It shall be the buyers responsibility to comply with all Federal, State and Local laws governing the sales of any items listed, illustrated or sold. The buyer expressly agrees to indemnify and hold harmless Rough Country, LLC for all claims resulting directly or indirectly from the purchase, ownership, or use of the items.

