

## HONDA 2020 TALON Whip Mount

**Thank you for choosing Rough Country for all your vehicle needs.**

Please read instructions before beginning installation. Check the kit hardware against the kit contents shown below. Be sure you have all needed parts and know where they go.

If question exist, please call us @1-800-222-7023. We will be happy to answer any questions concerning this product.

Check all fasteners for proper torque. Check to ensure for adequate clearance between all components.

Periodically check all hardware for tightness.

**KIT CONTENTS:**  
Whip Mounts x2  
Backing Plates x2

**TOOLS NEEDED:**  
Drill Motor  
1/4" Bit  
4mm Allen Wrench  
10mm Wrench or Socket

**HARDWARE INCLUDED:**  
6mm-1.0 x 20mm Button Head Bolts x4  
6mm-1.0 Nylock Nuts x4



### Torque Specs:

Size	Grade 5	Grade 8	Size	Class 8.8	Class 10.9
5/16"	15 ft/lbs	20ft/lbs	6MM	5ft/lbs	9ft/lbs
3/8"	30 ft/lbs	35ft/lbs	8MM	18ft/lbs	23ft/lbs
7/16"	45 ft/lbs	60ft/lbs	10MM	32ft/lbs	45ft/lbs
1/2"	65 ft/lbs	90ft/lbs	12MM	55ft/lbs	75ft/lbs
9/16"	95 ft/lbs	130ft/lbs	14MM	85ft/lbs	120ft/lbs
5/8"	135ft/lbs	175ft/lbs	16MM	130ft/lbs	165ft/lbs
3/4"	185ft/lbs	280ft/lbs	18MM	170ft/lbs	240ft/lbs



## INSTALLATION INSTRUCTIONS

1. Locate the desired position of the whip mount bracket. **See Photo 1.**
2. Before drilling holes to mount the bracket. Check the opposite side of the location for clearance. **See Photo 2.**



3. Using the whip mount bracket as a template drill the (4) holes using a 1/4" bit. **See Photo 3.**
4. Install the whip mount bracket using (4) supplied 6mm-1.0 x 20mm button head bolts. **See Photo 4.**

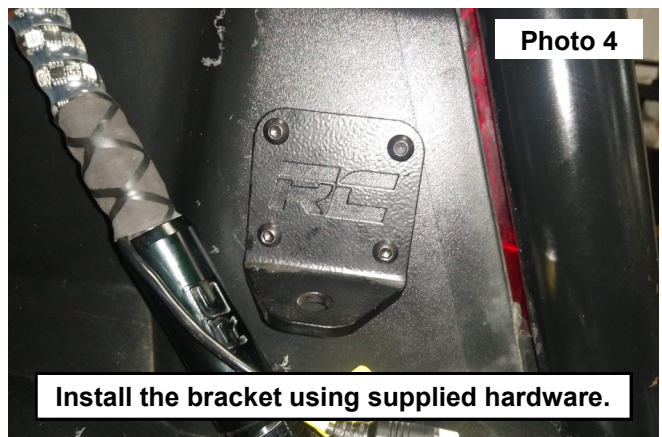
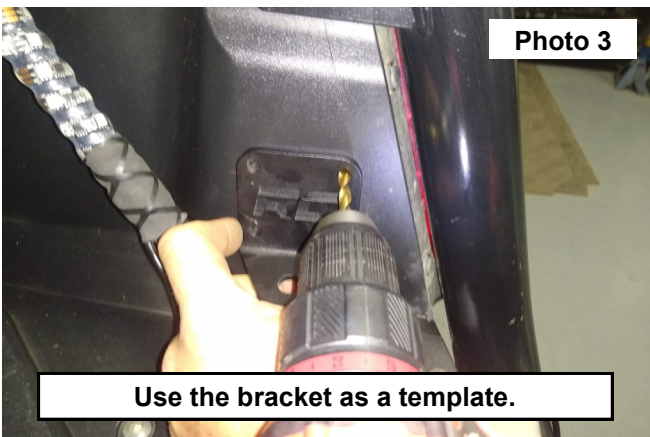

5. Install the backing plate onto the (4) bolts. **See Photo 5.**
6. Secure the assembly using (4) of the supplied 6mm-1.0 nylock nuts. **See Photo 6.**
7. Tighten the hardware using a 4mm allen wrench and a 10mm socket.
8. Install the whip light to the mounts.
9. Repeat steps 1-8 on the opposite side of the UTV.
10. Connect the supplied wiring harness to the whip and to the UTV power supply.



By purchasing any item sold by Rough Country, LLC, the buyer expressly warrants that he/she is in compliance with all applicable, State, and Local laws and regulations regarding the purchase, ownership, and use of the item. It shall be the buyers responsibility to comply with all Federal, State and Local laws governing the sales of any items listed, illustrated or sold. The buyer expressly agrees to indemnify and hold harmless Rough Country, LLC for all claims resulting directly or indirectly from the purchase, ownership, or use of the items.

