

START HERE The ZROADZ Series Grilles comes into 2 different configurations. One style features the LED Light Bar mounting hidden on the backside, while the other style has exposed mounting provisions on the face side of the grille. Please note this and identify your ZROADZ Grille Series configuration and follow the instruction version that corresponds with your grille.

GRILLE CONFIGURATION STYLE 1

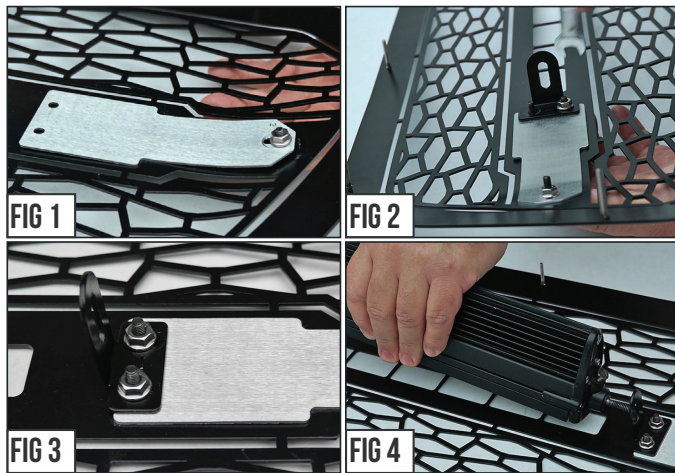

STEP 1 Lay out your parts. From the backside of the grille, put into place the ZROADZ Logo Backing Plate.



STEP 2 Put into place one of the Bracket Tabs and secure with provided Hardware as seen in Fig. # 2-4 and then from the backside of grille position LED Light Bar.

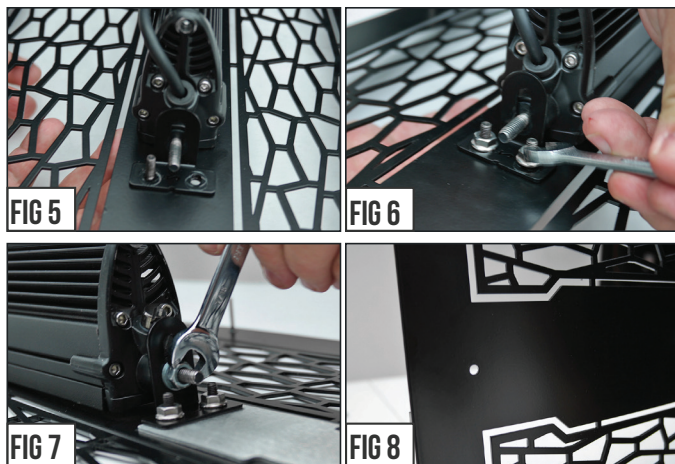

STEP 3 With LED Light placement set, put into position the remaining bracket and the finally tighten LED and all Mounting Brackets into their final secured position.

GRILLE CONFIGURATION STYLE 2

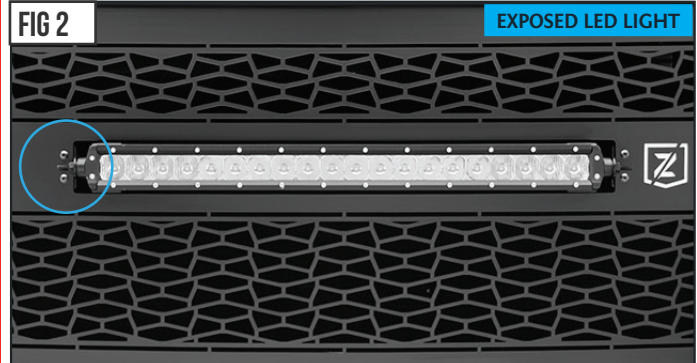

STEP 1 Lay out your parts. From the backside of the grille, put into place the ZROADZ Logo Backing Plate.

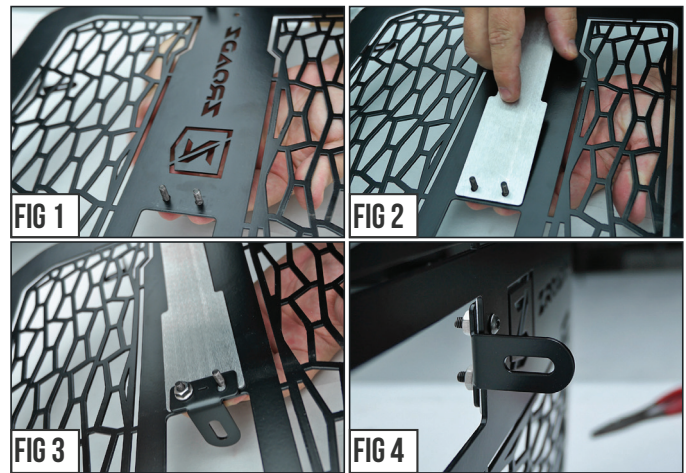

STEP 2 Put into place one of the Bracket Tabs and secure with provided Hardware as seen in Fig. # 1-4.

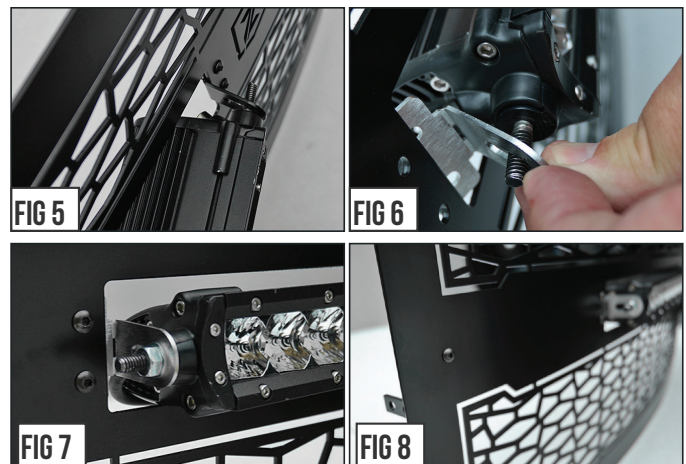

STEP 3 From the face side of grille slip the LED Light bar into place. On the opposite side, position the remaining bracket and finally tighten LED and Brackets into position.

STEP 4 There is a final step for both styles of ZROADZ Grilles. See both of the Figure #8 Images and note that there is an exposed hole. Use the Provided Hardware Button Head Screw and fill the hole and tightened down with Nut. This will create symmetrical look from side to side.

GRILLE ASSEMBLY - COMPLETE

Z312111
2015 GMC Sierra
2500/3500 HD



Z312111
2015 GMC Sierra
2500/3500 HD

2015 GMC Sierra 2500/ 3500 HD ZROADZ Series LED Grille Insert

TOOLS REQUIRED:

Flat Head Screwdriver
Phillips Screwdriver
Cutting Wheel
10mm Socket
Ratchet & Extensions
3/6" Drill Bit
Drill

PARTS LIST

(8) - #8 screw 3/4"
(8) - #8 Flat Nuts
(2) - Bracket Mounts

NOTE:

- We recommend painting all areas exposed behind grille black prior to installing for best results.

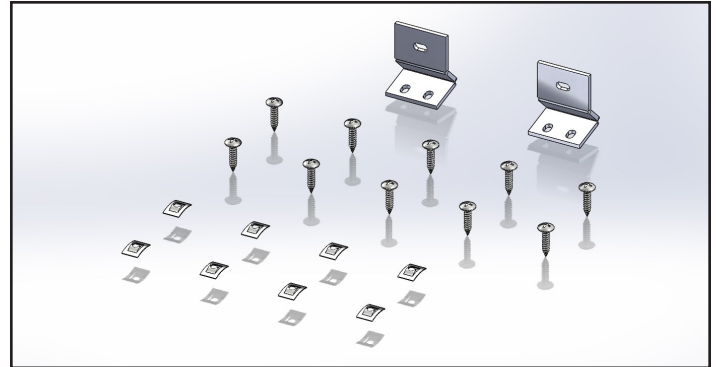

PLEASE READ AND UNDERSTAND ALL INSTRUCTIONS BEFORE INSTALLATION. Auto makers offer varied models to each vehicle and occasionally manufacture more than one body style of the same model. To assure your part is correct; our tech department can be contacted at tech@trexbillet.com to verify fitment or assist with tech questions. All other inquires can be directed to info@trexbillet.com. In the event you do not have internet access please call 1-800-287-5900.

Step 1

Open hood and remove the 12 plastic push clips securing the plastic radiator shroud to the radiator core. Carefully use a flat head screwdriver to release the clip up, you can now remove the clips. Once all clips have been removed the plastic radiator shroud can be removed. (Fig 1)



Step 2

Using your 10mm socket and ratchet remove the four (4) 10mm bolts securing the upper grille assembly to the radiator support. (Fig 2)

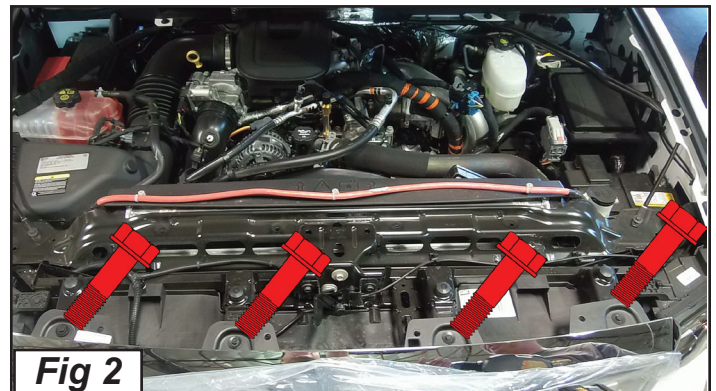



Step 3

Gently lift the top of grille assembly up while pulling back at the same time. Depress the four (4) release tabs located on the inside of the factory grille assembly with your flat head screwdriver. Firmly grasp the grille pulling away from the vehicle to remove it. (Fig 3)

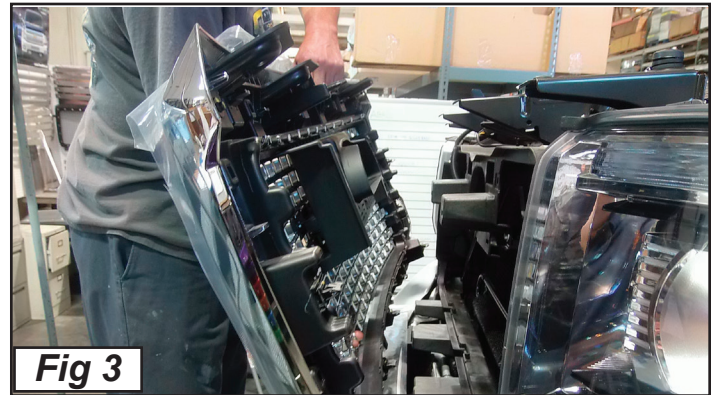

Step 4

Using a cutting wheel carefully cut away the center section of the grille assembly. Afterwards use a file or sandpaper to clean up any sharp or jagged edges. (Fig 4)

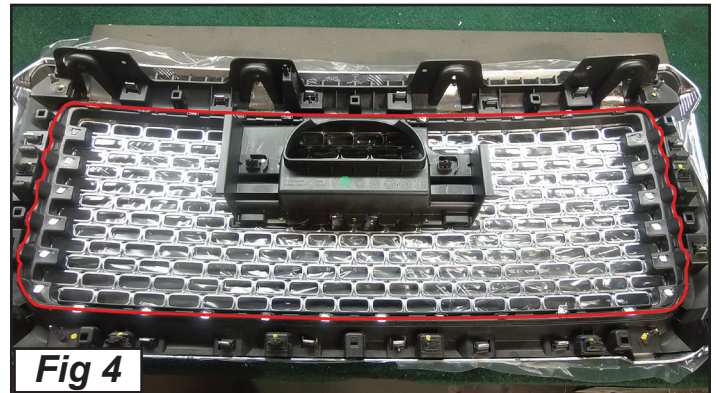

Step 5

Flip grille face down and place billet grille into grille opening. Align the tabs to the inner grille shell. Carefully drill a 3/16" hole, use the pre drilled holes on the grille tabs as guides . (Fig 5)

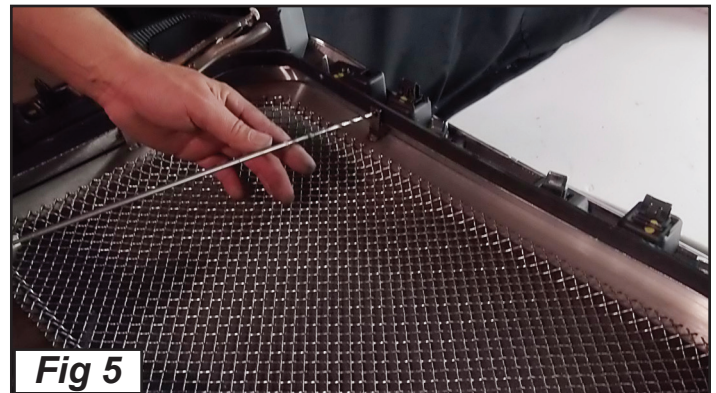

Z312111
2015 GMC Sierra
2500/3500 HD



Z312111
2015 GMC Sierra
2500/3500 HD

Step 6 “DENALI HD ONLY”

Secure the grille assembly with the screws and U nuts.
(Fig 6)

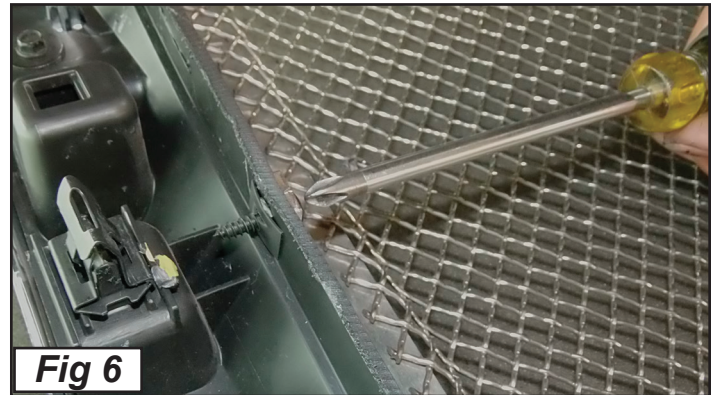

Step 6 “STANDARD HD”

Secure the grille assembly with the screws and U nuts.
The outer tabs use the grille brackets and additional
screws secure to the inner grille shell as shown. (Fig 6)



Step 7

Your installation is now complete. Reattach the grille/
bumper assembly back to the vehicle in reverse order
of removal. Make sure you reconnect all disconnected
wiring harness and reattach all clips and screws. Wire
the LED Light Bar via our optional wiring harness kit
(part# 639HAR1) or custom wiring harness. Light bars
are installed flush with the grille from the factory. This
may or may not be ideal for each light depending on
the configuration of your vehicle and its options and
or modifications. To adjust the angle of your Light Bar,
rotate the Light Bar to adjust the angle, then tighten
the hardware once the desired angle is achieved
(please be careful not to over tighten the mounting
hardware or scratch the finish of the grille). It is best to
adjust the angle with the vehicle on level ground with
lights facing a wall, garage door or other solid barrier.
We recommend checking from a distance of 25'. (Fig 7)

