

ROUGH COUNTRY

SUSPENSION SYSTEMS®

FORD 2021 Bronco Sasquatch 2" Lift Kit

Thank you for choosing Rough Country for all your vehicle needs.

Rough Country recommends a certified technician install this system. In addition to these instructions, professional knowledge of disassemble/reassembly procedures as well as post installation checks must be known. Attempts to install this system without this knowledge and expertise may jeopardize the integrity and/or operating safety of the vehicle.

Please read instructions before beginning installation. Check the kit hardware against the parts list. Be sure you have all needed parts and know where they go. Also please review tools needed list and make sure you have needed tools. If question exist, please call us @1-800-222-7023. We will be happy to answer any questions concerning this product. Check all fasteners for proper torque. Check to ensure for adequate clearance between all components. Periodically check all hardware for tightness.

PRODUCT USE INFORMATION

▲WARNING The taller a vehicle is, the easier it will roll. We strongly recommend, because of rollover possibility that seat belts and shoulder harnesses should be worn at all times. Avoid situations where a side rollover may occur.

▲WARNING Generally, braking performance and capability are decreased when larger/heavier tires and wheels are used. Take this into consideration while driving. Do not add, alter, or fabricate any factory or after-market parts to increase vehicle height over the intended height of the Rough Country product purchased. Mixing component brands is not recommended.

Rough Country makes no claims regarding lifting devices and excludes any and all implied claims. We will not be responsible for any product that is altered. If questions exist we will be happy to answer them concerning the design, function, and correct use of our products.

The suspension system was developed using a 35 x 12.5 tires with 17 x 8.5 wheel with 0mm offset. The lifts were designed to lift the front to level the vehicle. Due to manufacturing, dimension variances, and inflation all tire and wheel combinations should be tested prior to installation on all oversized / wider then stock tires.

▲NOTICE DEALER AND VEHICLE OWNER

Any vehicle equipped with any Rough Country product should have a "Warning to Driver" decal installed on the inside of the windshield or on the vehicle's dash. The decal should act as a constant reminder for whoever is operating the vehicle of its unique handling characteristics.

Torque Specs:

Size	Grade 5	Grade 8	Size	Class 8.8	Class 10.9
5/16"	15 ft/lbs	20ft/lbs	6MM	5ft/lbs	9ft/lbs
3/8"	30 ft/lbs	35ft/lbs	8MM	18ft/lbs	23ft/lbs
7/16"	45 ft/lbs	60ft/lbs	10MM	32ft/lbs	45ft/lbs
1/2"	65 ft/lbs	90ft/lbs	12MM	55ft/lbs	75ft/lbs
9/16"	95 ft/lbs	130ft/lbs	14MM	85ft/lbs	120ft/lbs
5/8"	135ft/lbs	175ft/lbs	16MM	130ft/lbs	165ft/lbs
3/4"	185ft/lbs	280ft/lbs	18MM	170ft/lbs	240ft/lbs

Alignment Specs

Front

Caster	3.18° ± 0.60°
Camber	0.12° ± 0.50°
Toe	0.1° ± 0.15°



Kit Contents:

Dr Side Control Arm x1
 Pass Side Control Arm x1
 Bushing Spacers x4
 Strut Spacers x4
 Rear Track Bar Bracket x1
 Dr Side Diff Drop x1
 Pass Side Diff Drop Washers x3
 Rear Brake Line Brackets x2
 Ball Joint Cap x2

Tools Needed:

8mm Socket/Wrench
 10mm Socket/Wrench
 13mm Socket/Wrench
 15mm Socket/Wrench
 17mm Socket/Wrench
 18mm Socket/Wrench
 21mm Socket/Wrench
 24mm Socket/Wrench
 36mm Socket/Wrench
 9/16" Socket/Wrench
 15/16" Socket/Wrench
 1-1/16" Socket/Wrench
 Screw Driver
 Drill
 13/32" Drill Bit
 Coil Compressor
 Sawzall

Hardware Included:

5/8" x 4" Bolt x1
 5/8" Flat Washers x2
 5/8" Lock Nut x1
 3/8" x 1-1/4" Bolt x1
 3/8" Flat Washers x2
 3/8" Lock Nut x1
 5/16" x 3/4" Bolts x2
 5/16" Flat Washers x2
 5/16" Flange Nut x2
 10mm x 85mm Bolt x1
 10mm Serrated Flange Nuts x12
 16MM Lock Nut x2
 16MM Flat Washers x2
 Ball Joint Hardware Bag x2



FRONT INSTALLATION INSTRUCTIONS

1. Jack up the front of the vehicle and place on jack stands. Remove the front wheels.
2. Remove the skid plates using a 15mm socket/wrench. **See Photo 1 and Photo 2.**

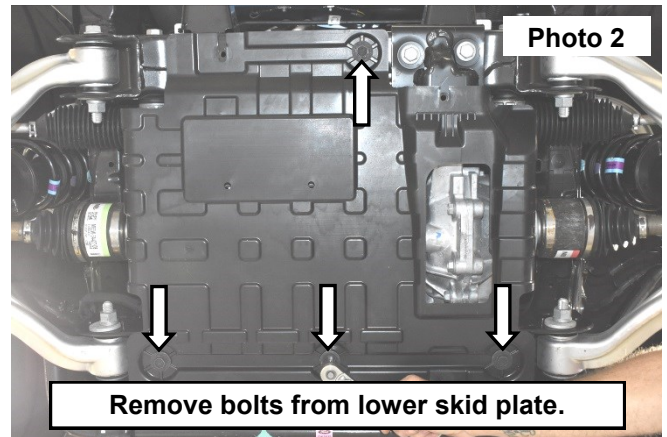
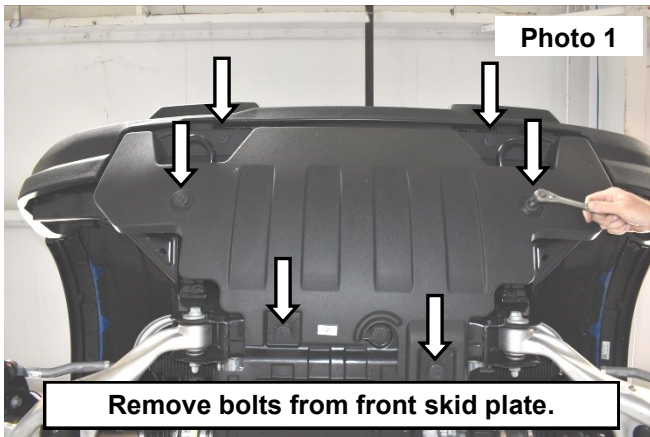

3. Unplug the rack and pinion. **See Photo 3.**
4. Remove the tie rod end using a 21mm socket/wrench. Strike the knuckle with a hammer if needed to remove the tie rod end. **See Photo 4 and Photo 5.**

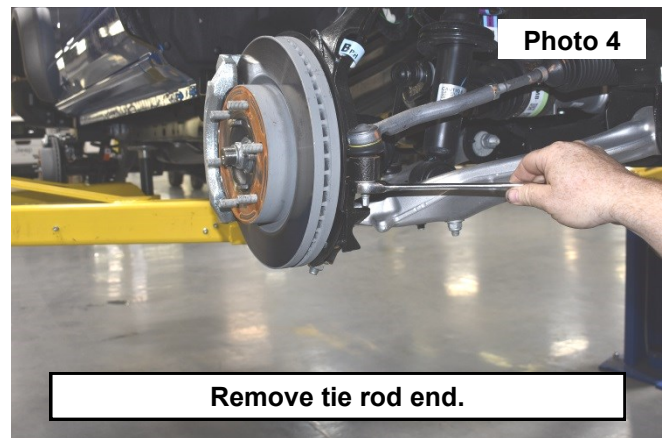
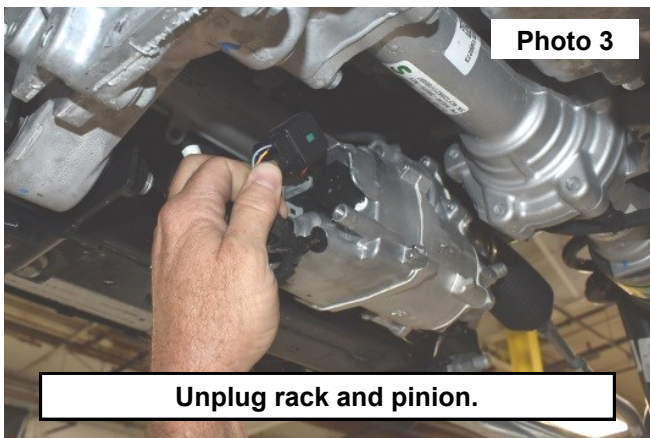

5. Remove the ABS wire and brake line from the knuckle using a 10mm socket/wrench. **See Photo 6.**

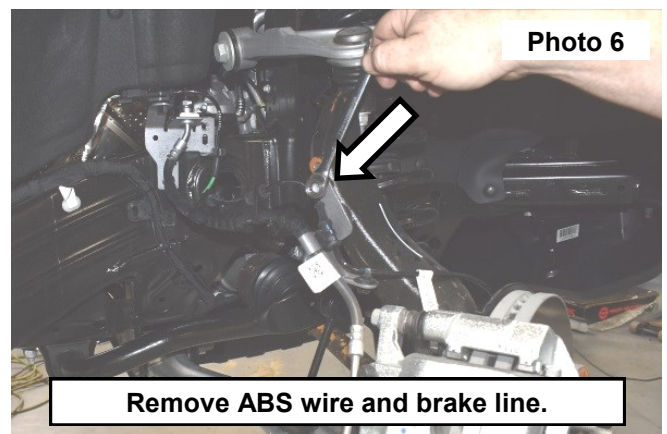
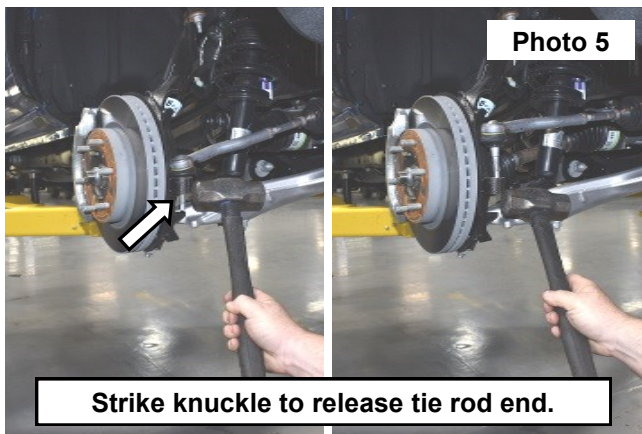

6. Remove upper ball joint just using an 18mm socket/wrench. Strike knuckle with a hammer if needed. **See Photo 7.**
7. Remove the lower sway bar nut using a 21mm socket/wrench. **See Photo 8.**

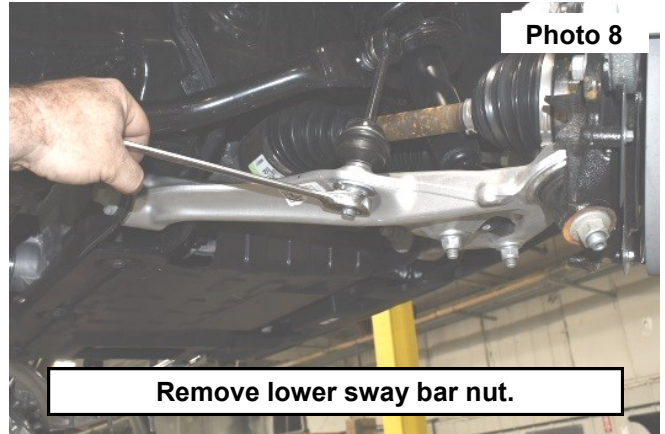
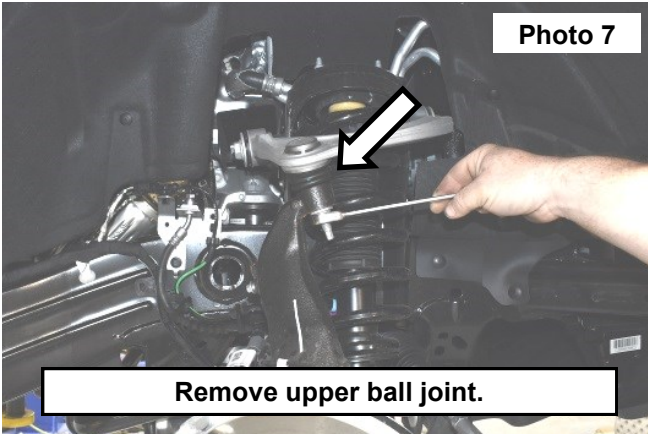

8. Remove the lower strut bolts using an 18mm socket/wrench. **See Photo 9.**
9. Remove the upper strut nuts using a 15mm socket/wrench. **See Photo 10.**

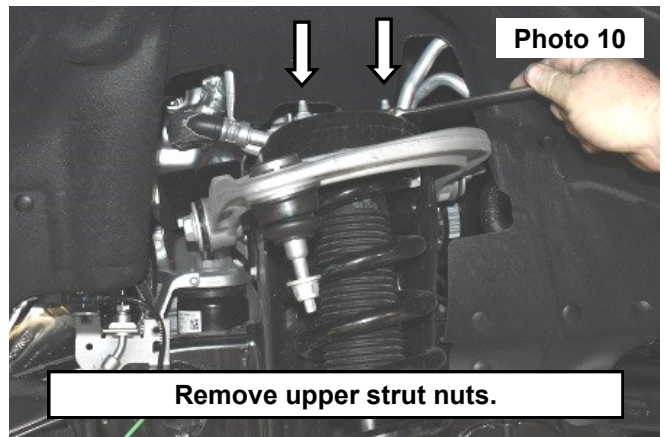
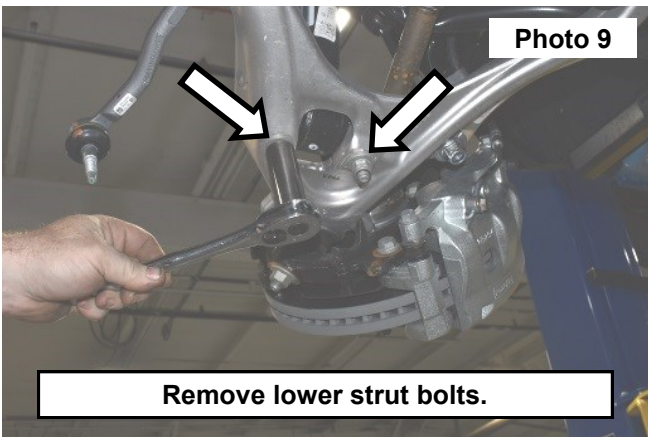

10. Remove the axle nut using a 36mm socket/wrench. Strike with hammer to loosen if needed. **See Photo 11.**
11. Remove the strut from the vehicle. **See Photo 12.**

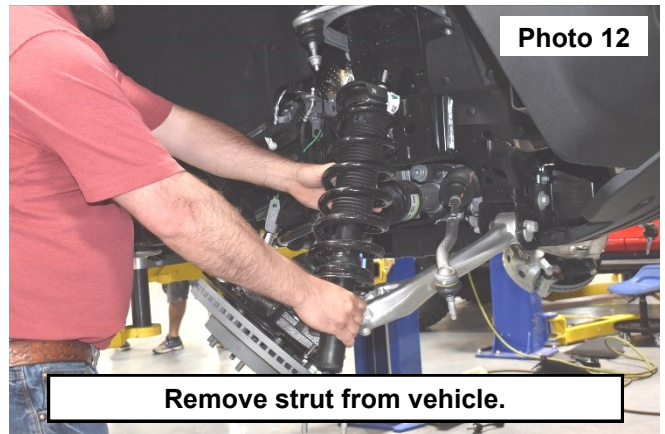
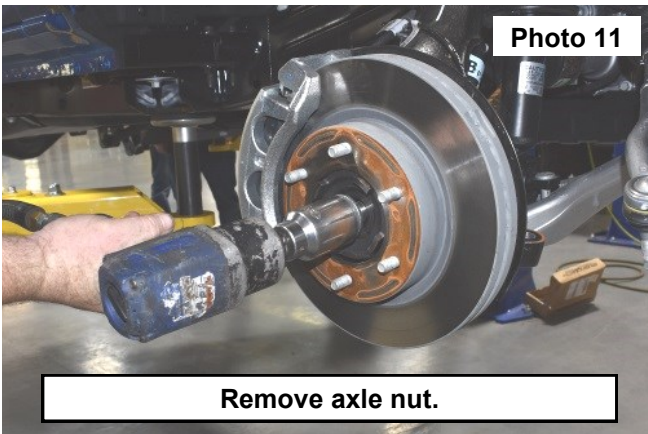

12. Remove the roll pin from strut. **See Photo 13.**

13. On the Passenger side, remove the heat shield using an 8mm socket/wrench. **See Photo 14.**

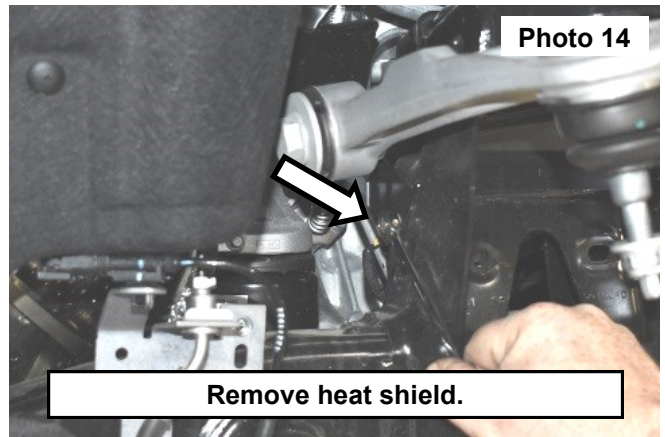
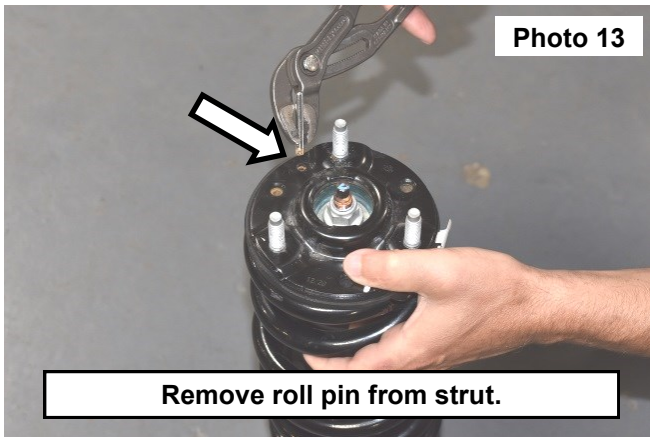

14. On the Passenger side, remove the upper control arm using a 21mm and 24mm socket/wrench. **See Photo 15.**

15. On the driver side, the steering shaft will have to be disconnected to be able to remove the bolt. Remove the plastic clip from fender well using a screw driver. Lock the steering wheel but make sure the bolt is accessible. Using a 10mm socket remove the pinch bolt from shaft and separate. **See Photo 16 and Photo 17.**

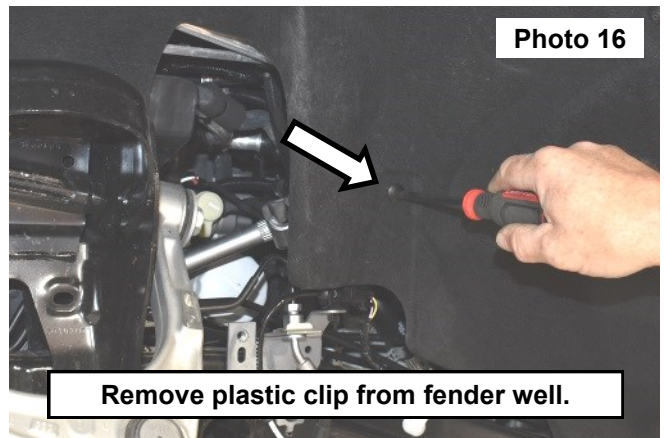
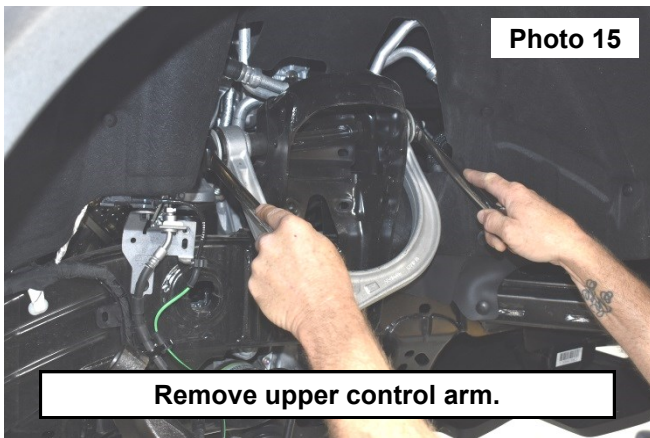

16. Remove the driver side upper control arm using a 21mm and 24mm socket/wrench. **See Photo 18.**

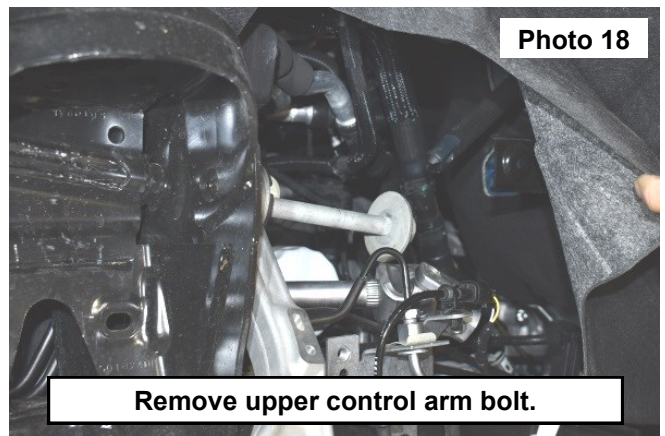
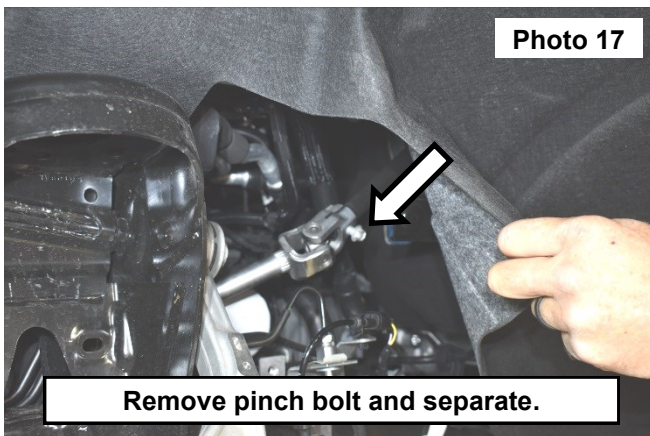

17. Grind down the inside stud to the top of the threads to give clearance for the strut spacer. **See Photo 19.**

18. Install strut spacer to strut using stock hardware with the angle towards the cut stud. **See Photo 20.**

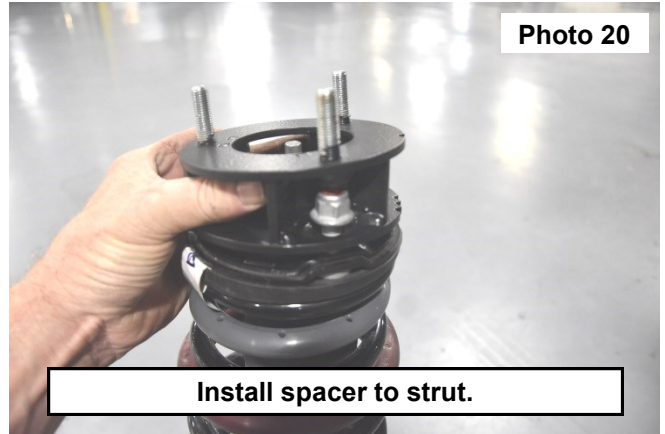
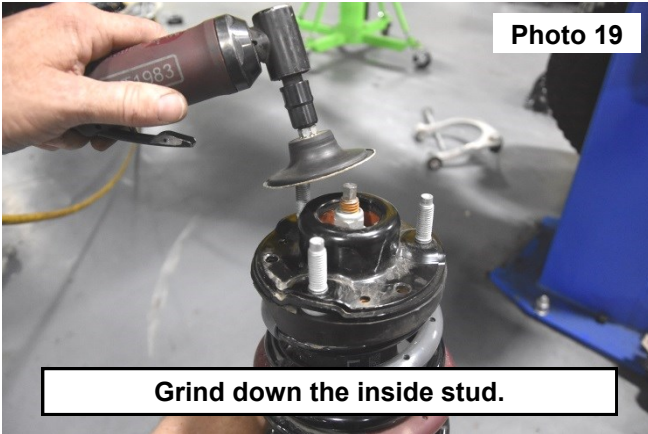

19. Reinstall the upper strut with the spacer to the vehicle with the supplied 10mm flange nuts using a 16mm socket/wrench. **See Photo 21.**

20. Install the new upper control arm using the stock hardware. **See Photo 22.**

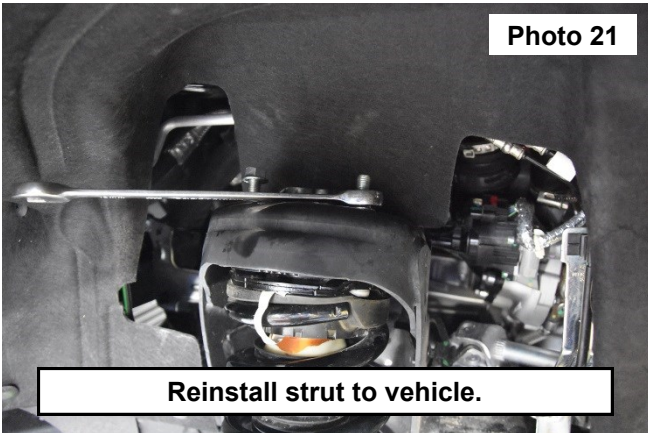

21. Support the front differential and remove the diff bracket using an 18mm and 21mm socket/wrench. **See Photo 23.**

22. Remove bolt from pass side supporting the axle. **See Photo 24.**

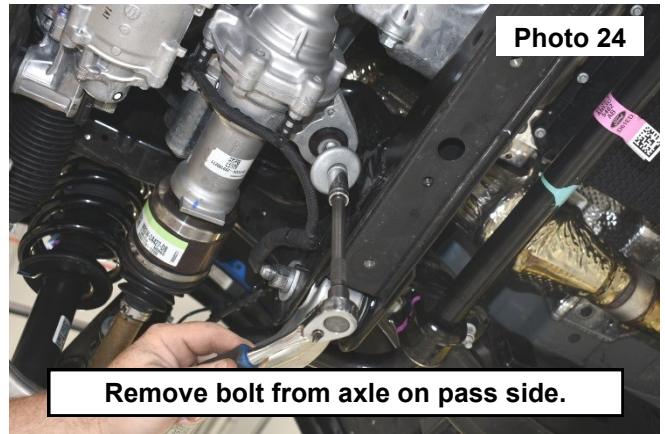
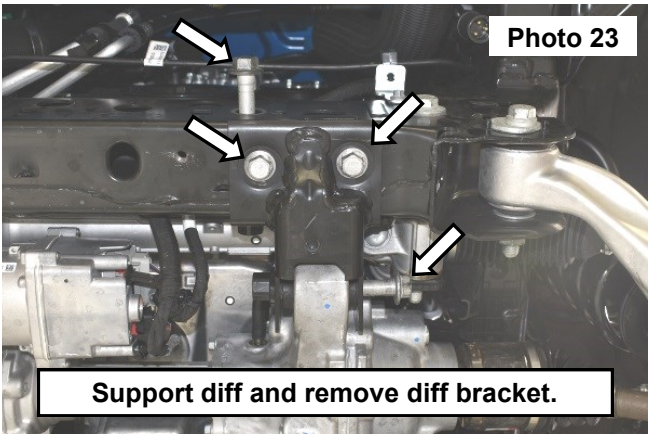

23. Install the new driver diff bracket using the stock hardware. **See Photo 25.**
 24. Install 2 passenger side spacers between the diff and upper diff mount and 1 passenger side spacer between the diff bushing and the diff mount use the supplied 10mm x 85mm bolt. Use a 17mm socket to tighten. **See Photo 26.**

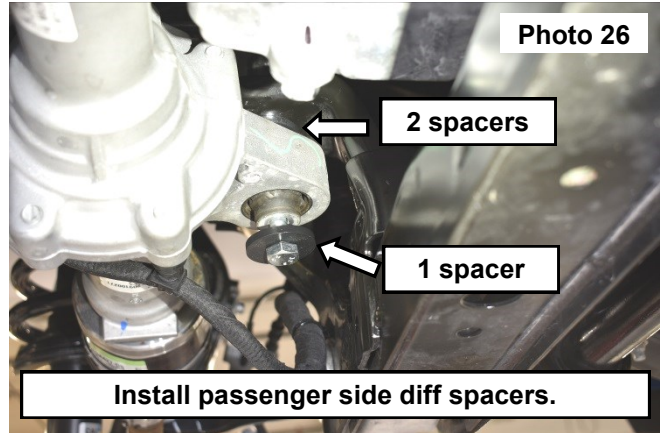
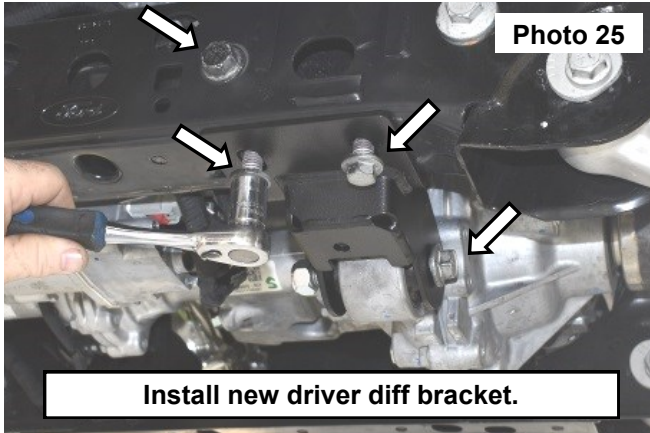

25. Mark the skid plate and cut for clearance of the new diff brackets using a Sawzall. **See Photo 27 and Photo 28.**

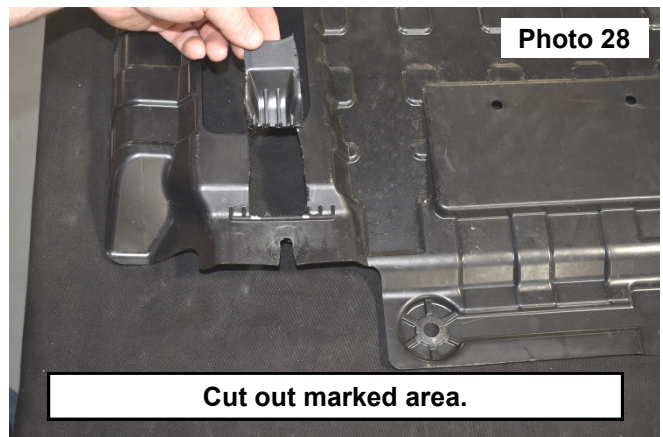
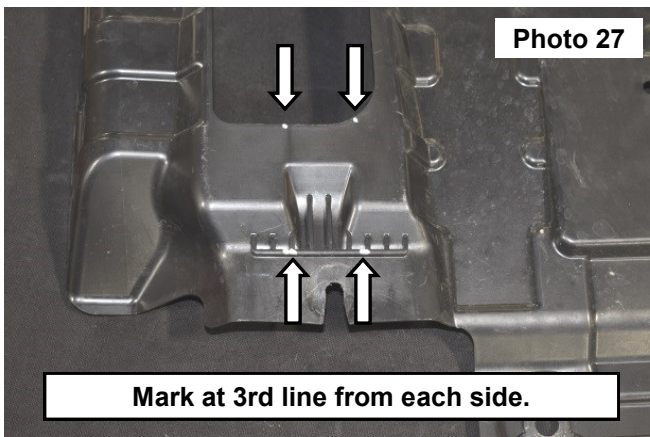

26. Reassemble the front suspension in reverse order of the disassembly.

▲ NOTICE Ball joints must be greased before use.

29. Put on wheels and lower.



REAR INSTALLATION INSTRUCTIONS

1. Jack up the rear of the vehicle and place on jack stands. Remove the rear wheels.
2. Remove the track bar using a 24mm socket/wrench. **See Photo 1.**
3. Support the axle and remove the lower strut bolt using a 1-1/16" socket/wrench. **See Photo 2.**

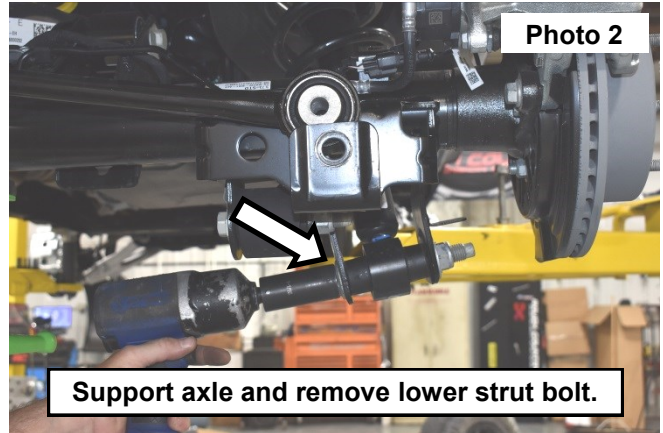
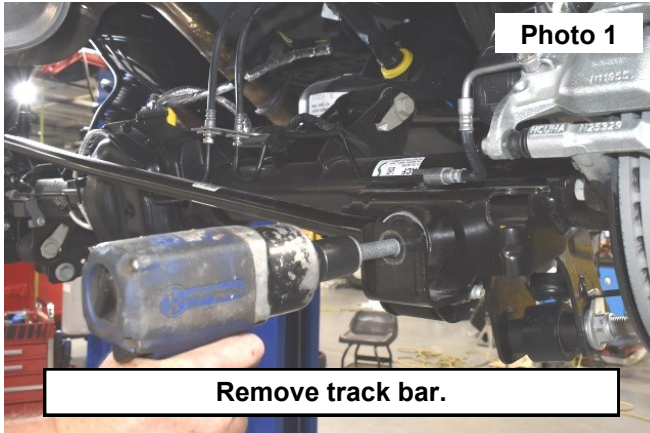

4. Remove the ABS/emergency wiring harness from the differential using an 8mm socket/wrench. **See Photo 3.**
5. Remove the clip holding the inner fender using a screw driver. **See Photo 4.**

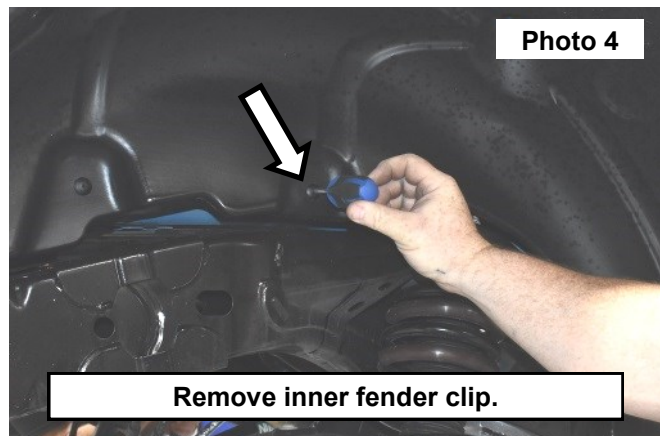
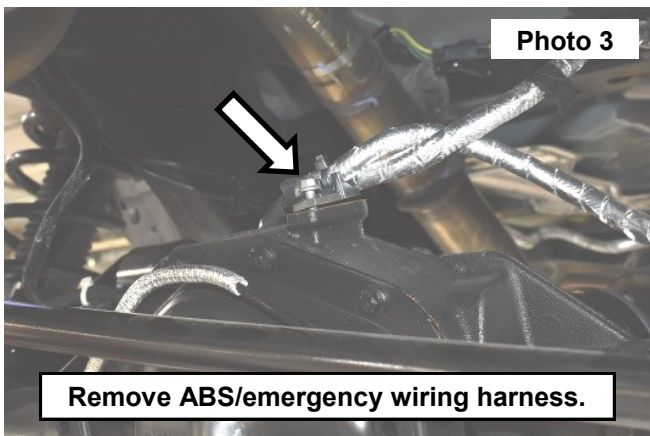

6. Remove the upper strut nuts using a 15mm wrench and remove strut from vehicle. **See Photo 5.**
7. Remove the roll pin from the strut. **See Photo 6.**

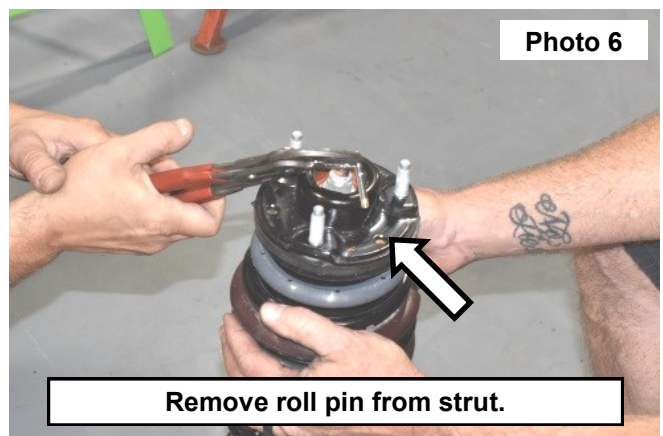
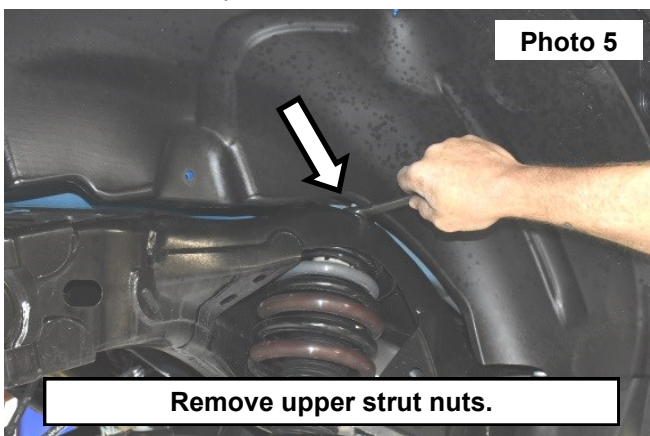

8. Grind down the front stud to the threads like the front strut and install spacer on the strut using stock hardware. **NOTE: Spacer needs to be angled with the tall side towards the rear. See Photo 7.**
9. Reinstall the strut with the spacer using the 10mm hardware and 17mm wrench. **See Photo 8.**

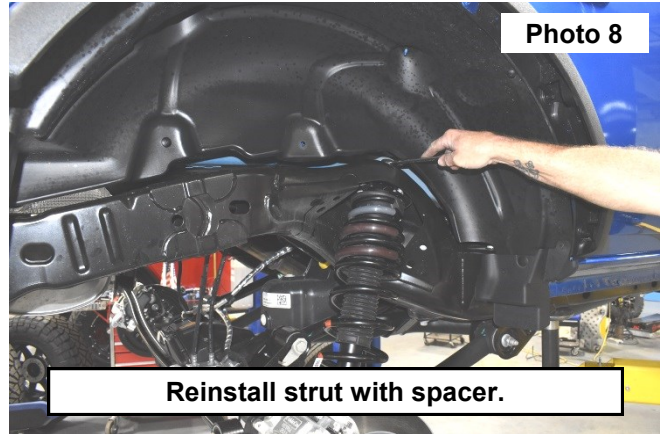
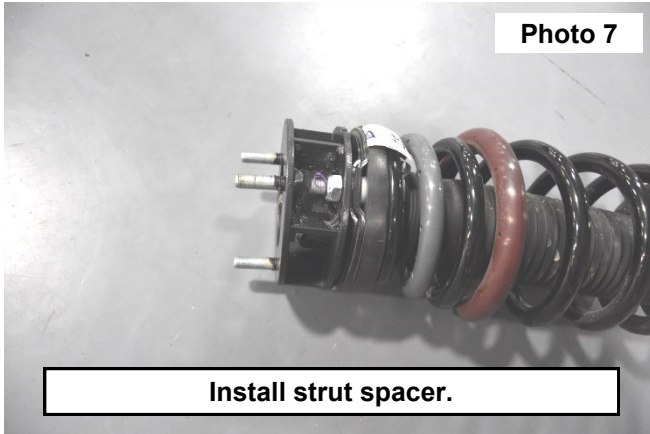

10. Remove the bolt from the brake line bracket behind track bar mount using a 10mm socket. **See Photo 9.**
11. Remove the bolt from the brake line bracket that is mounted near the rear diff using a 10mm socket. Remove brake line from clip. **See Photo 10.**

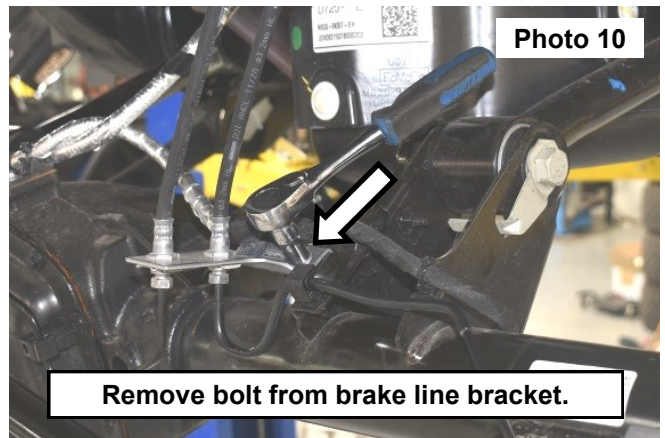
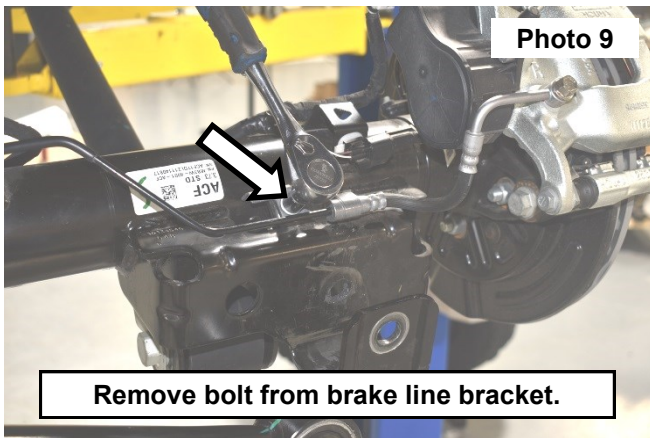

12. Install the brake line brackets using the stock bolts to mount to the axle and the supplied bolts, nuts, and washers to mount the brackets to the brake line. **See Photo 11 and Photo 12.**
13. Install the track bar drop bracket. **See Photo 13.**

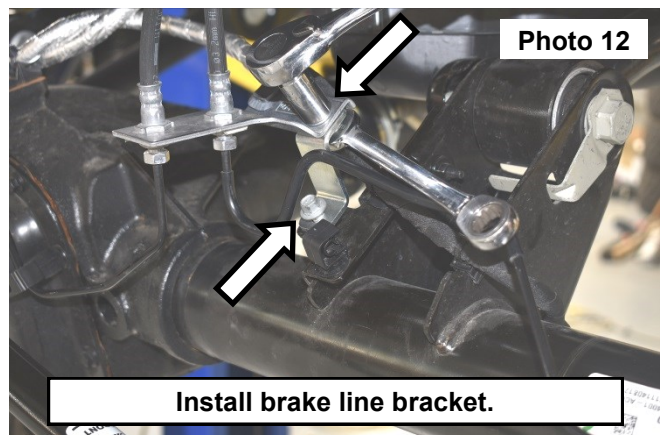
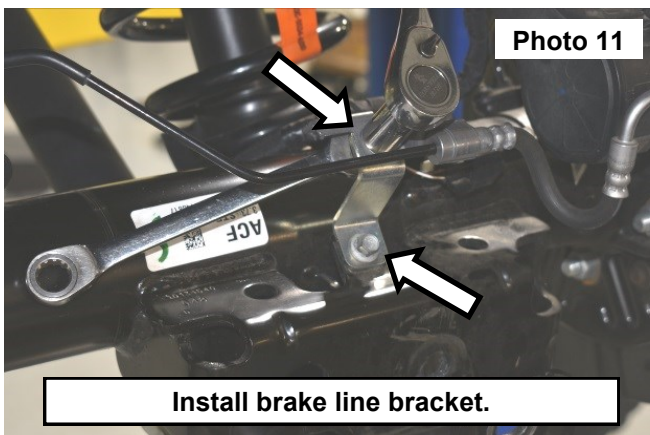

14. Mark the axel through the hole in the drop bracket. **See Photo 14.**

15. Remove bracket and drill a hole where marked using a 13/32" drill bit. **See Photo 15.**

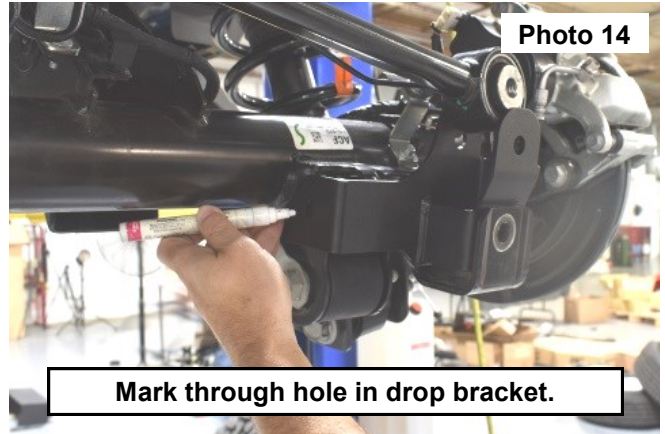
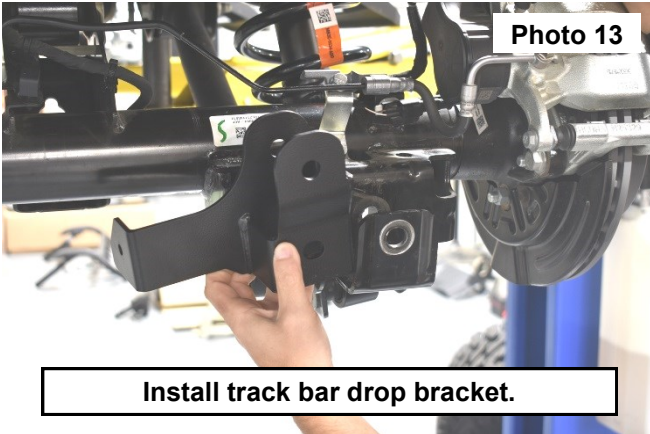

16. Reinstall the track bar drop bracket using the stock bolt. **See Photo 16.**

17. Install the 3/8" hardware in drilled hole to the drop bracket using two 9/16" socket/wrenches. **See Photo 17.**

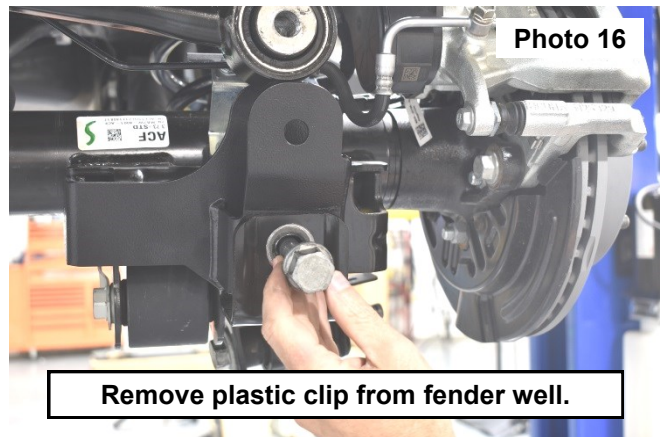
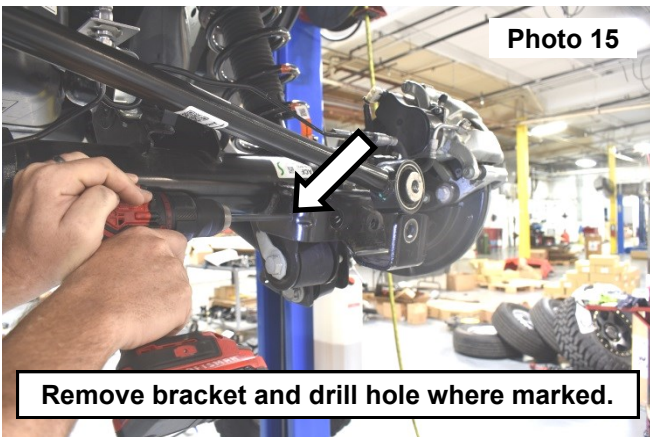

18. Install the track bar to the drop bracket using the 5/8" hardware and 15/16" socket/wrench. **See Photo 18.**

19. Reassemble the rear suspension in reverse order of the disassembly.

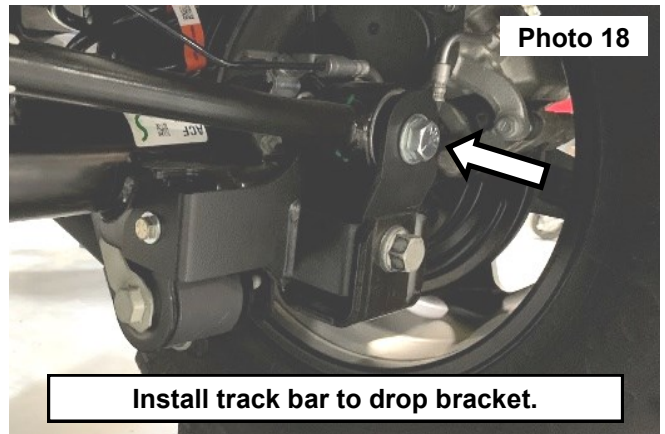
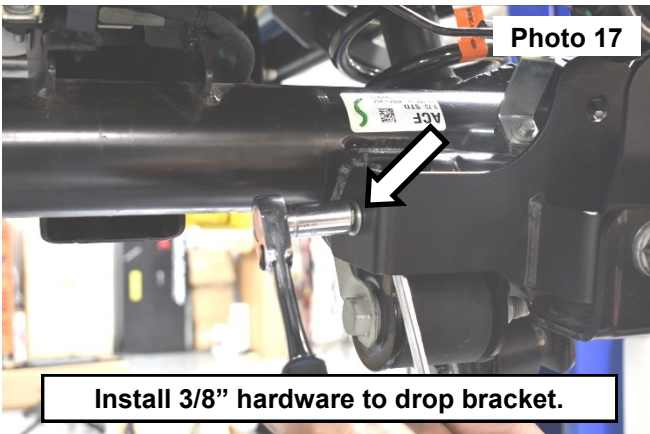

20. Put on wheels and lower.



By purchasing any item sold by Rough Country, LLC, the buyer expressly warrants that he/she is in compliance with all applicable, State, and Local laws and regulations regarding the purchase, ownership, and use of the item. It shall be the buyers responsibility to comply with all Federal, State and Local laws governing the sales of any items listed, illustrated or sold. The buyer expressly agrees to indemnify and hold harmless Rough Country, LLC for all claims resulting directly or indirectly from the purchase, ownership, or use of the items.

