

ROUGH COUNTRY

SUSPENSION SYSTEMS®

FORD 2005-16 F-250/F-350 Rear Air Bag Kit

Thank you for choosing Rough Country for all your vehicle needs.

Please read instructions before beginning installation. Check the kit hardware against the kit contents shown below. Be sure you have all needed parts and know where they go.

If question exist, please call us @1-800-222-7023. We will be happy to answer any questions concerning this product.

Check all fasteners for proper torque. Check to ensure for adequate clearance between all components.

Periodically check all hardware for tightness.

Kit Contents:

Air Springs x2
 Dr Upper Air Spring Mount x1
 Pass Upper Air Spring Mount x1
 Upper Air Spring Spacers x6
 Emission Line Bracket x1
 Lower Air Spring Mounts x2
 Lower Air Spring Mounts Top x2
 Lower Straps x2
 Heat Shield x1

Tools Needed:

3/8" Socket/Wrench
 9/16" Socket/Wrench
 3/4" Socket/Wrench

Hardware Included:

1/4" x 1" Hex Bolts x2
 1/4" Flat Washers x4
 1/4" Lock Nuts x2
 3/8" x 4" Carriage Bolts x4
 3/8" x 2" Carriage Bolts x2
 3/8" x 1" Hex Bolts x20
 3/8" Lock Washers x8
 3/8" Flat Washers x20
 3/8" Flange Lock Nuts x16
 1/2" x 3-1/2" Hex Bolts (for gooseneck)
 1/2" x 1-1/2" Hex Bolts (non-gooseneck)
 1/2" Lock Nuts x2
 1/2" Flat Washers x8
 Nuts x2
 Zip Ties x6
 Hose Clamps x2
 Loop Clamp x1



Torque Specs:

Size	Grade 5	Grade 8	Size	Class 8.8	Class 10.9
5/16"	15 ft/lbs	20ft/lbs	6MM	5ft/lbs	9ft/lbs
3/8"	30 ft/lbs	35ft/lbs	8MM	18ft/lbs	23ft/lbs
7/16"	45 ft/lbs	60ft/lbs	10MM	32ft/lbs	45ft/lbs
1/2"	65 ft/lbs	90ft/lbs	12MM	55ft/lbs	75ft/lbs
9/16"	95 ft/lbs	130ft/lbs	14MM	85ft/lbs	120ft/lbs
5/8"	135ft/lbs	175ft/lbs	16MM	130ft/lbs	165ft/lbs
3/4"	185ft/lbs	280ft/lbs	18MM	170ft/lbs	240ft/lbs



INSTALLATION INSTRUCTIONS

1. Jack up the rear of the vehicle and place on jack stands. Remove the rear wheels.
2. Install the 3/8" x 2" carriage bolts in the bottom of both upper air spring mounts. **See Photo 1.**
3. Install the pass side upper air spring mount on the air bag with 3/8" x 1" bolts, lock washers, and flat washers using a 9/16" socket/wrench. Install the 90° fitting in the air bag. **Note the bolt pattern for the 1" bolts. See Photo 2.**

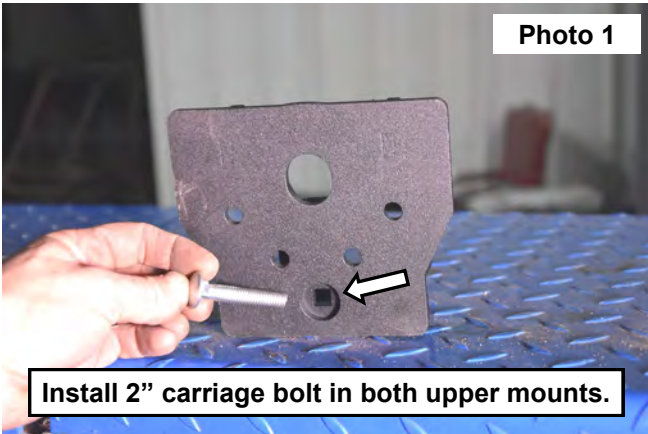

4. Install the driver side upper air spring mount on the air bag with 3/8" x 1" bolts, lock washers, and flat washers using a 9/16" socket/wrench. Install the 90° fitting in the air bag. **See Photo 3.**
5. Install the emission line bracket on the driver side air spring mount with 1/4" x 1" bolts, nuts, and washers using two 3/8" sockets/wrenches. **See Photo 4.**

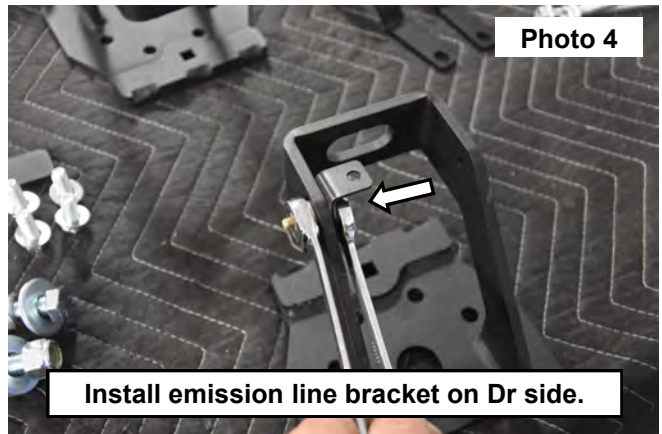
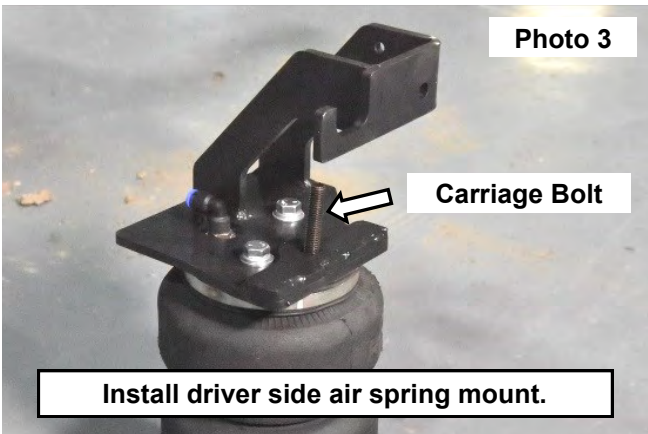

6. Install 3 upper air spring spacers on each mount over the carriage bolts. **See Photo 5.**
7. Install the air bag to the lower mounting using the supplied 3/8" x 1" bolts, lock washers, and flat washers using a 9/16" socket/wrench. **Note the bolt pattern for Driver and Passenger sides. See Photo 6.**

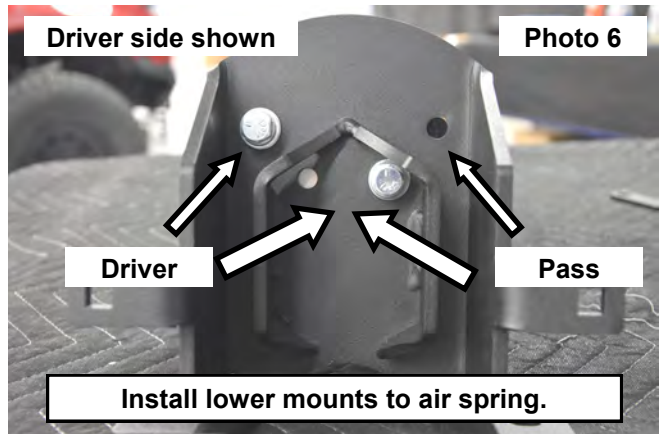

8. Remove the stock bump stop using a 15mm wrench. **See Photo 7.**
9. Place the air spring assembly on the extension from the block over the axle . **See Photo 8 and Photo 9.**



10. Install the air springs to the frame with the supplied 1/2" x 1-1/2" bolts (or 1/2" x 3-1/2" bolts for gooseneck hitch), lock nuts, and washers using a 3/4" socket/wrench. **See Photo 10.**

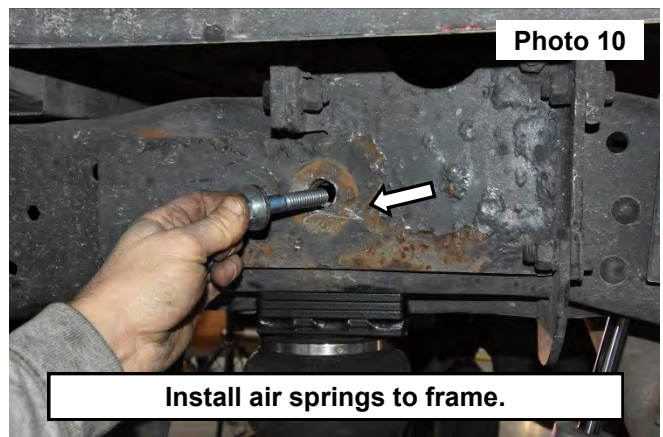

11. Install the lower air spring straps with the supplied 3/8" x 4" carriage bolts and flange nuts using a 9/16" wrench. **See Photo 11.**
12. Install the supplied U-bolts around the stock U-bolts to the air spring lower mount using 3/8" flange nuts and 9/16" wrench. **See Photo 12.**

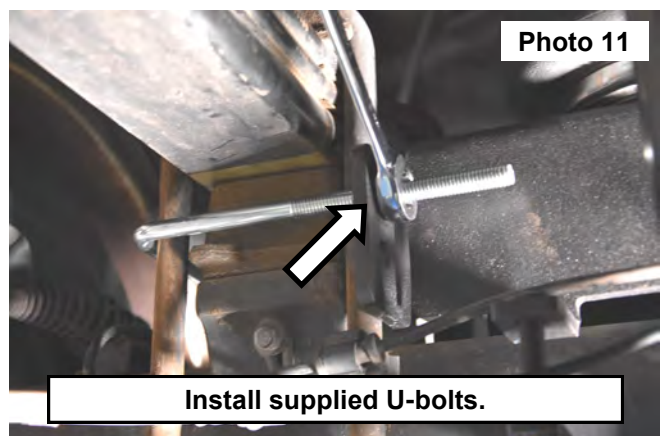
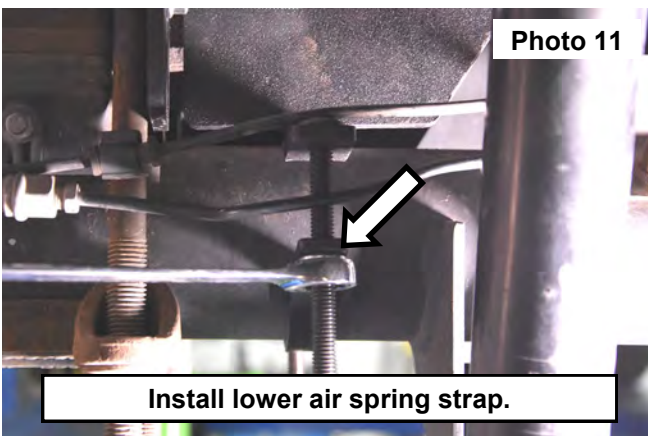

13. Remove the license plate screws. **See Photo 13.**
14. Install inflation valves in the stock screw locations. **See Photo 14.**

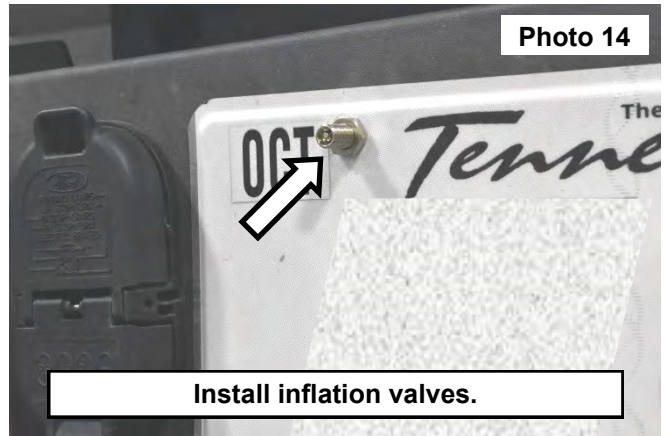
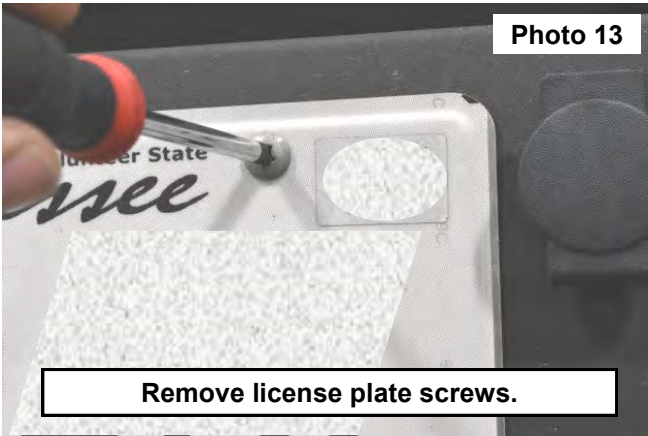

15. Install the supplied 1/4" DOT air line in the inflation valve and 90° fitting. **See Photo 15.**
NOTE: Max/Min for Airbags is 5-100 psi.
16. Install the loop clamp to the lower mount to secure the brake line using the supplied 1/4" x 1" bolts, nuts, and washers using a 3/8" socket/wrench. **See Photo 16.**

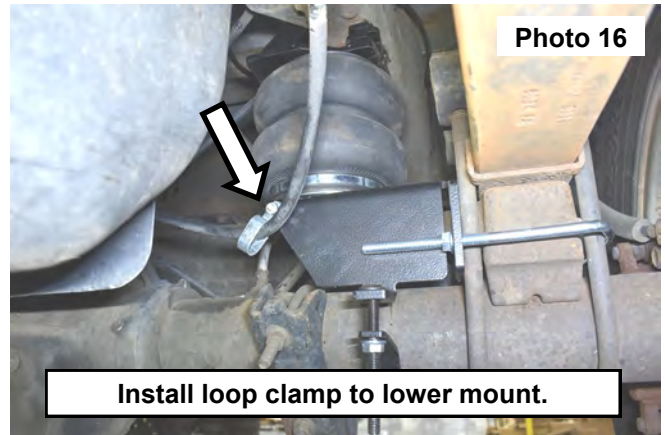

17. Use zip ties to secure excess air line.
18. Put on wheels and lower.



By purchasing any item sold by Rough Country, LLC, the buyer expressly warrants that he/she is in compliance with all applicable, State, and Local laws and regulations regarding the purchase, ownership, and use of the item. It shall be the buyers responsibility to comply with all Federal, State and Local laws governing the sales of any items listed, illustrated or sold. The buyer expressly agrees to indemnify and hold harmless Rough Country, LLC for all claims resulting directly or indirectly from the purchase, ownership, or use of the items.

