

## FORD 2015-22 Electric Step

Thank you for choosing Rough Country for all of your suspension needs.

Rough Country recommends that a certified technician install this system. In addition to these instructions, professional knowledge of disassemble/reassembly procedures as well as post installation checks must be known. Attempts to install this system without this knowledge and expertise may jeopardize the integrity and/or operating safety of the vehicle. Please read all the instructions before beginning the installation. Check the kit hardware against the "Kit Contents" list below. If question exist, please call us @1-800-222-7023. We will be happy to answer any questions concerning this product. Check all fasteners for proper torque. Check to ensure for adequate clearance between all components. Check and retighten wheels at 50 miles and again at 500 miles. Periodically check all hardware for tightness. Be sure you have all the needed parts and understand where they go. Also, please review the "Tools Needed" list to be certain you have the necessary tools to complete the installation.

### TOOLS NEEDED:

Wheel Chocks  
13mm wrench/socket  
15mm wrench/socket  
5mm Allen Wrench  
Side Snips  
Plastic Mold Tools  
6mm socket  
10mm wrench/socket

### KIT CONTENTS:

Step Brackets/Actuators x 4  
Electric E Board x 2  
E Board Wiring Harness x1  
E Board Lights x4  
Magnetic Door Triggers x4



### Step Installation

1. Park your vehicle on a clean flat surface, engage the parking brake and block the rear tires.
2. **Save all hardware removed from the vehicle unless otherwise noted.**
3. Open the hood and disconnect the negative terminal on the battery.
4. If vehicle is currently equipped with steps, remove using a 13mm wrench or socket. Ensure that any wiring that may be connected to the factory step is unhooked before trying to remove.
5. Install the supplied E-Board step bracket/actuators in the forward most and rear most positions of the body using the supplied 13mm flat washer, lock washer, and nut. Do not fully tighten at this time. **Photo 1 / 2**

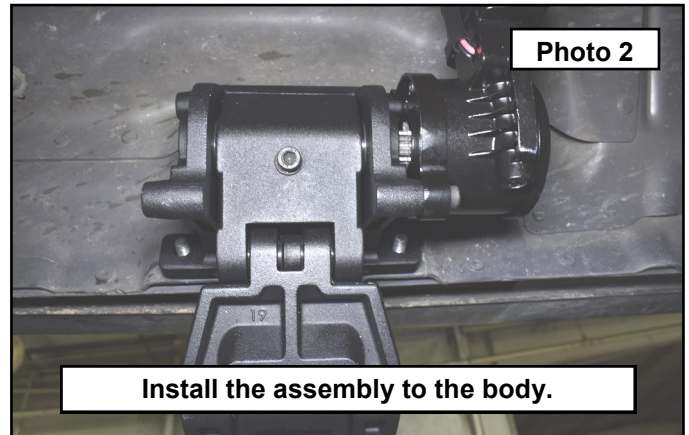
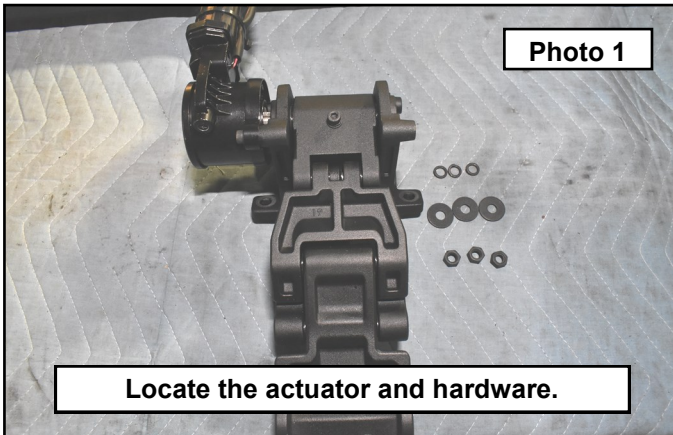

6. Ensure that the bracket/actuator motor is facing inward toward the center of the vehicle. **Photo 3 / 4**

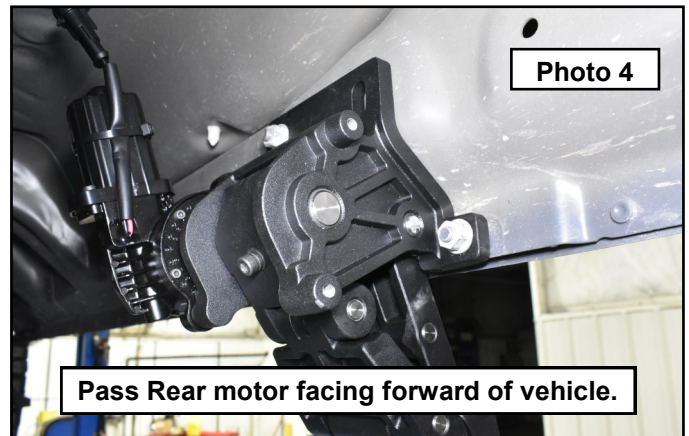
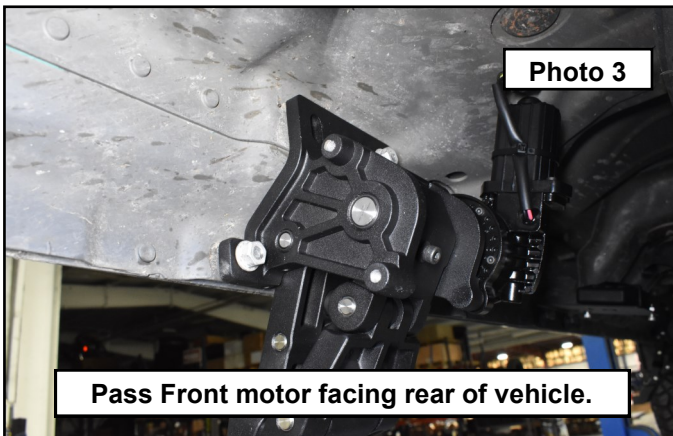

7. Using the supplied 13mm flat washer, lock washers, and nuts to install the electronic module controller on the passenger side of the vehicle using the middle position studs. **Photo 5 / 6**

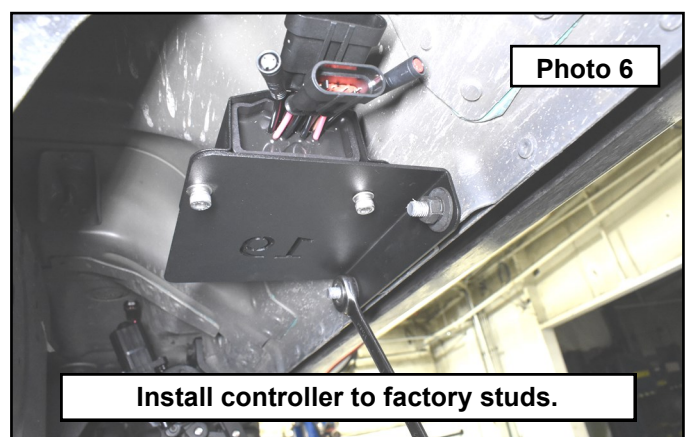
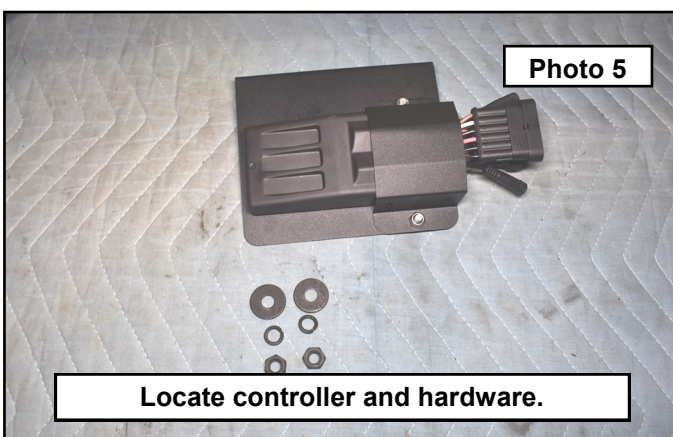



8. Connect the corresponding electrical connectors of the main harness to the controller. **Photo 7 / 8**

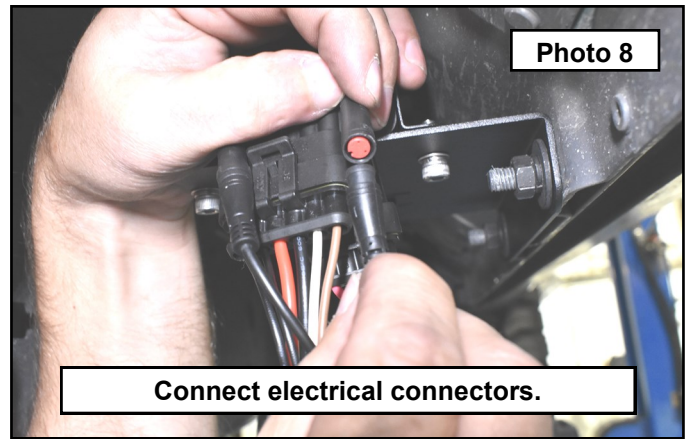
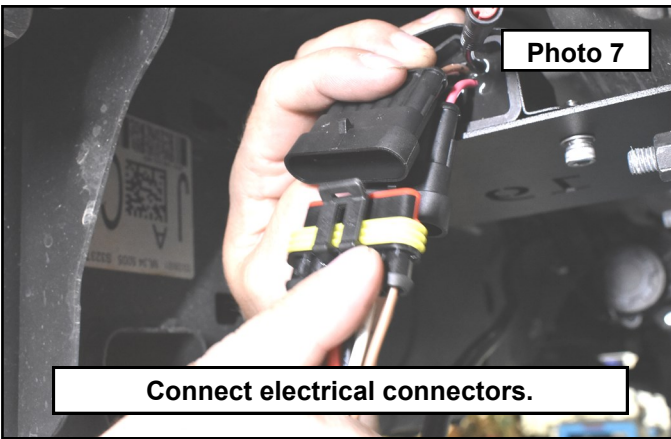

9. Connect the passenger side actuators using the shorter side of the harness. **Photo 9**  
10. Route the longer side of the harness through the frame to the driver side. **Photo 10**

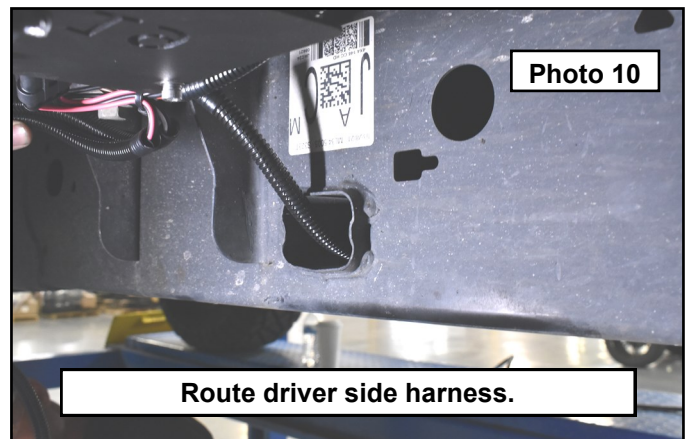
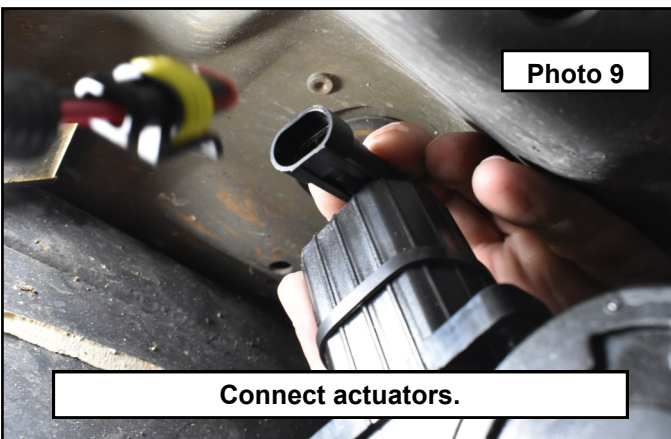

11. Connect the driver side actuators. **Photo 11**  
12. Inside the cab remove the step panels at all 4 doors by pulling up and away from the floor. **Photo 12**

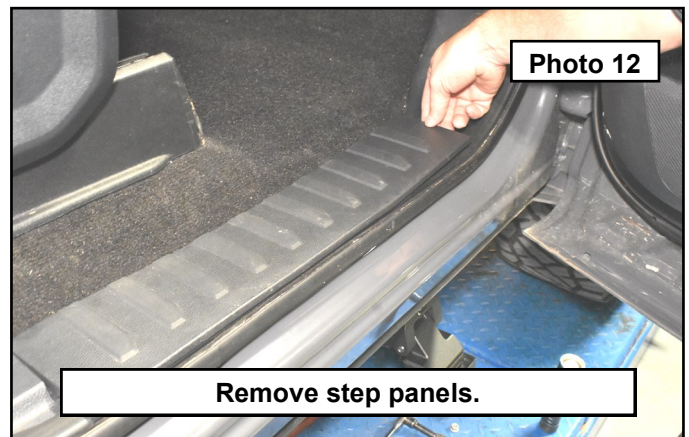
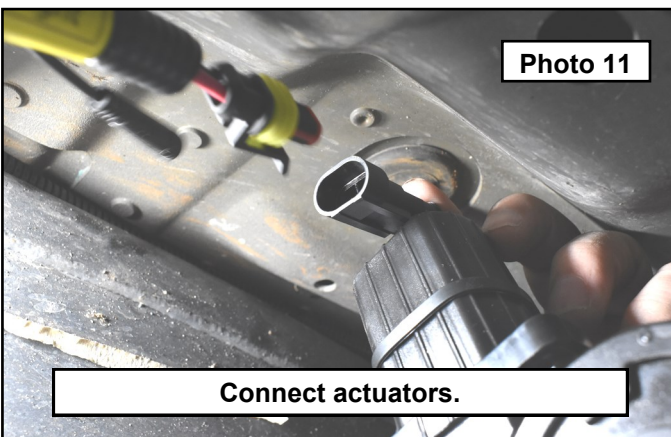

13. Remove the front kick panels by pulling up and away from the floor. **Photo 13**

14. Remove the B pillar panels at the back doors by pulling away from the body. **Photo 14**

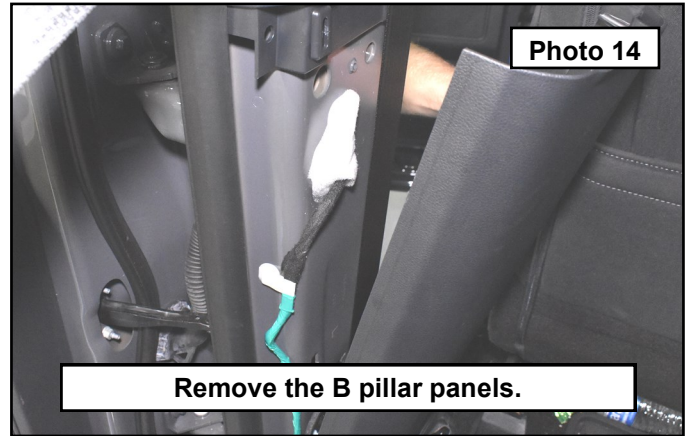
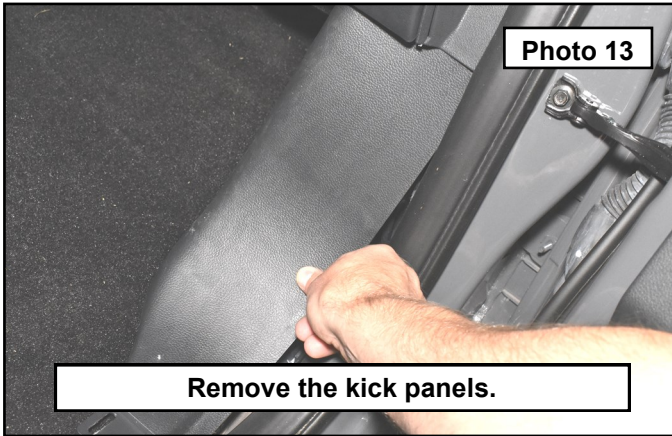

15. Locate the rubber plug under the passenger side front floor panel. Make a small cut into the plug and pass the wires into the cab of the vehicle. You will need to lift the carpet up to gain access. **Photo 15**

16. Pull the door signal wires through the rubber plug into the cab. **Photo 16**

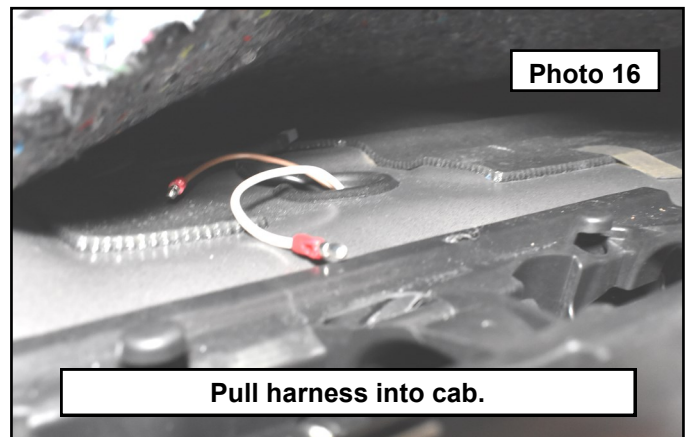
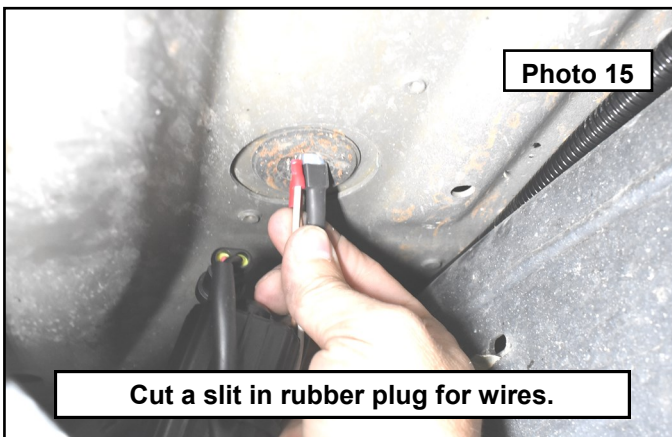

17. Remove the center console kick panels using a 6mm socket. Route the white trigger wire under the front edge of the carpet and through the center console to the driver side. Route the brown wire to the passenger side B pillar. **Photo 17 / 18**

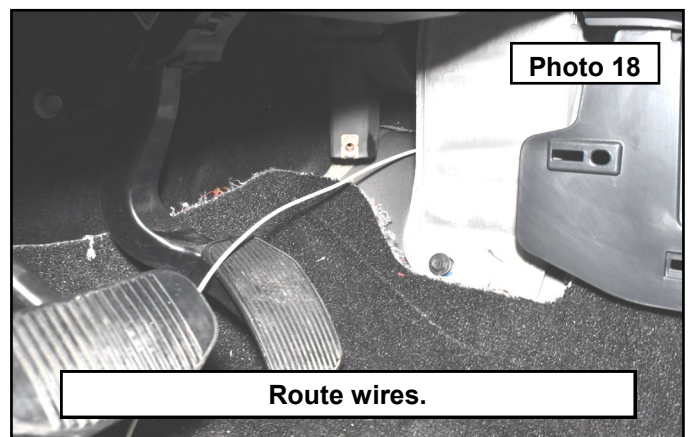



18. Route the white trigger wire under the carpet to the driver side B pillar. Route the switch to a location of your choice. This allows you access to turn the steps on or off if needed. **Photo 19**
19. Once you have the trigger wires routed to the B pillars on both sides of the vehicle, connect one side of the magnetic sensor using the provided butt connectors. Repeat for both sides of the vehicle. **Photo 20.**

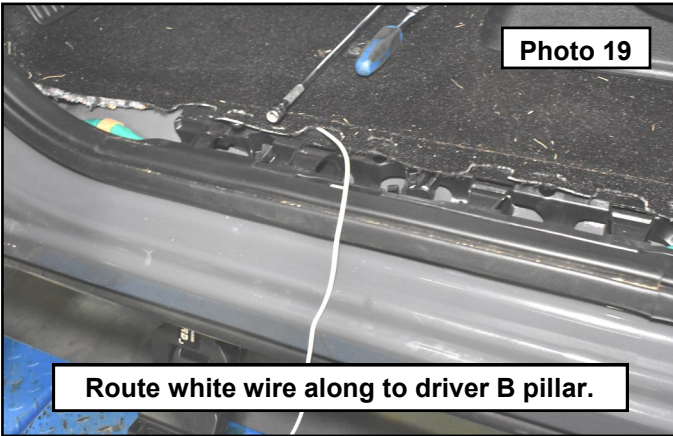

Route white wire along to driver B pillar.

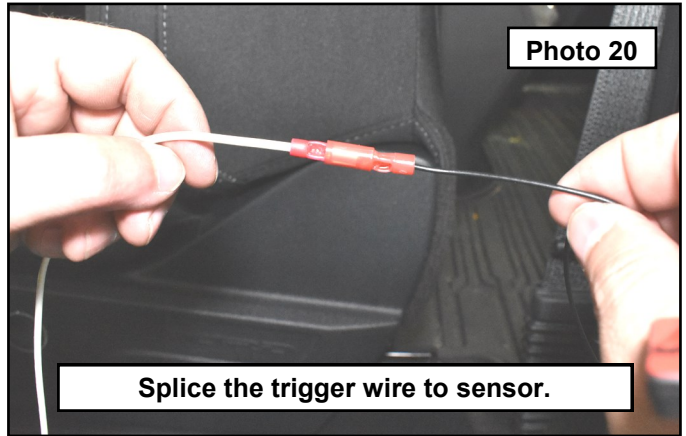

Splice the trigger wire to sensor.

20. Locate a good grounding bolt in the B pillar for the other end of the sensors. Repeat for both sides of the vehicle. **Photo 21**
21. Pass one of the sensors behind the rubber edge molding to the front door jamb. Peel off the double sided tape and stick to the door jamb as shown. Replace the rubber edge molding making sure to not cut the wires. Repeat the process for the passenger side. **Photo 22**

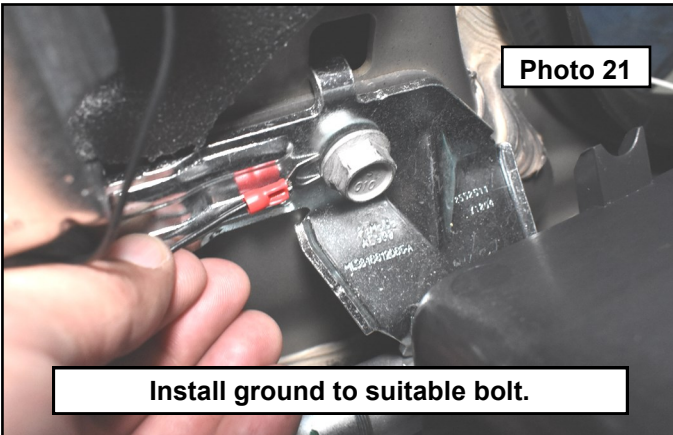

Install ground to suitable bolt.

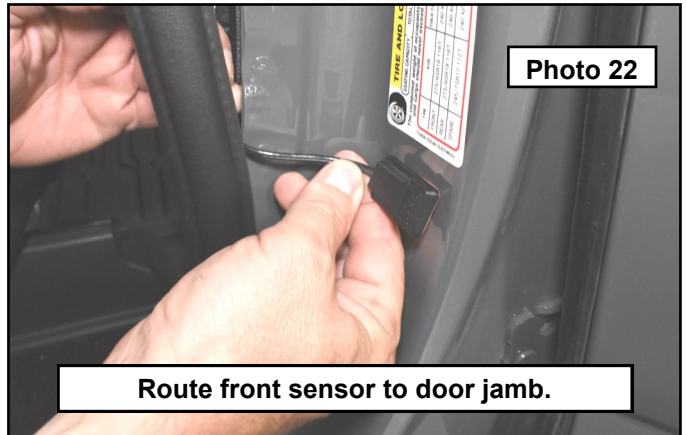

Route front sensor to door jamb.

22. Route the rear sensors behind the rubber edge molding as you did for the front sensor and place trigger as shown. Repeat for both sides of the vehicle. **Photo 23**
23. The magnets provided can be fastened to the door at this time. These will need to be installed in such a way that the magnet will hover over the trigger pad when the door is opened. Using a measuring tape measure down from where you installed the sensors and place the magnet on the door in the same approximate location. Do not peel the tape back all the way at this time as you may need to play with the magnet location to get just right in the next steps. **Photo 24**

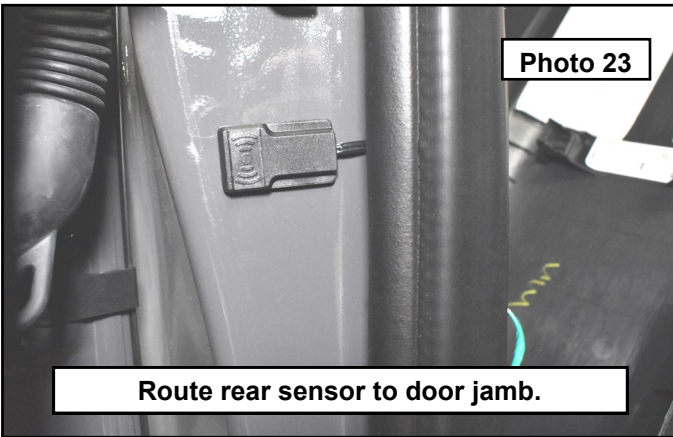

Route rear sensor to door jamb.

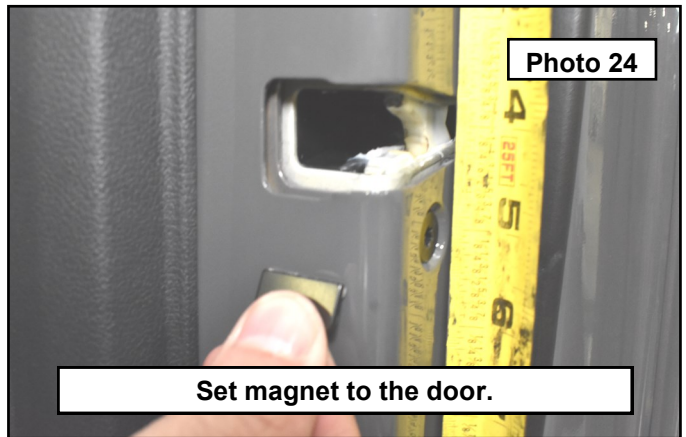

Set magnet to the door.

24. Reinstall all of the step, kicker and B pillar panels. You can use a pry tool to pull the rubber molding back over the top of the panels as you go. **Photo 25 / 26**

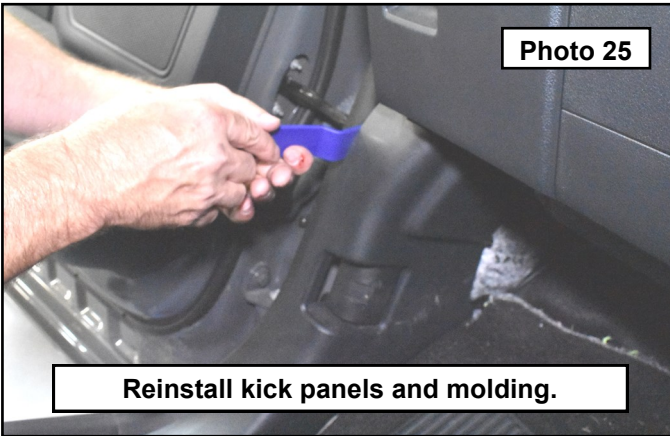

25. Install the E-Board onto the bracket actuator using the supplied 5mm socket head bolts. The aluminum sliders on the E-Board can be positioned into the block hasp of the bracket and the bolts installed. Leave the bolts loose so the board can be slid into the desired position. Stand back from the vehicle and make sure the step is in the best position front to back so that when it is retracted it will not hit the front fender. Once in position, tighten the bolts down using a 5mm hex wrench. Repeat for opposite side of the vehicle. **Photo 27 / 28**

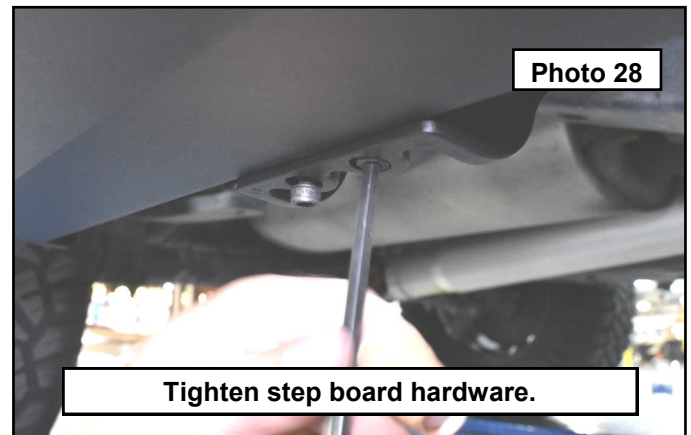
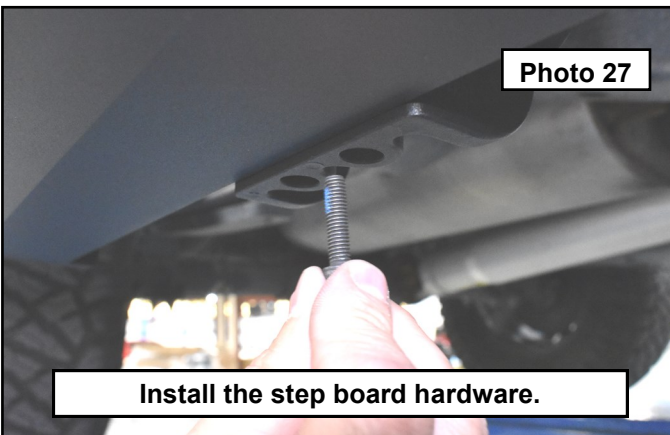

26. Once the step boards are installed, tighten the actuator hardware. **Photo 29 / 30**

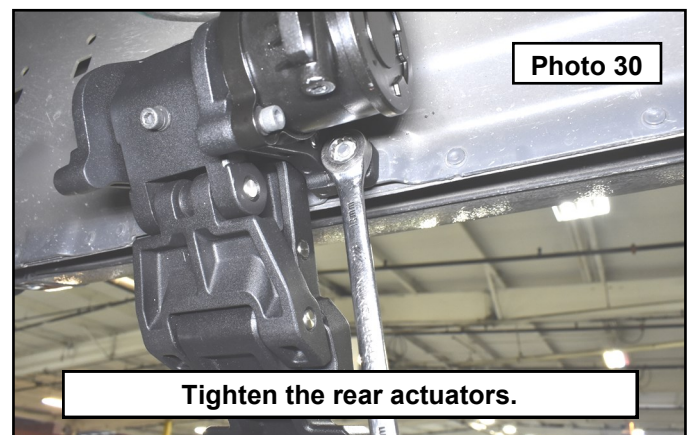
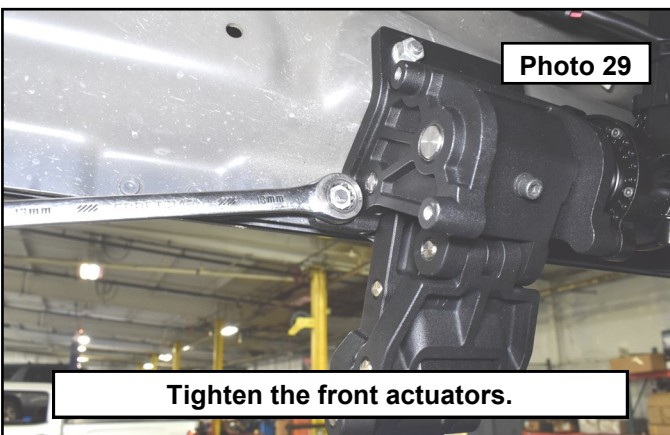



27. The step kick includes entry lights. These are installed close to the area where you will be stepping down onto the board. Once this location is found, clean the surface of the body and stick the lights in place by peeling the backing off the double sided tape and pressing firmly onto the body. Connect the lights to their harnesses. **Photo 31 / 32**



28. Under the vehicle, route the positive and negative side of the harness up the passenger frame rail and into the engine bay. Use the provided zip ties to tuck all of the harness up and out of the way. **Photo 33 / 34**

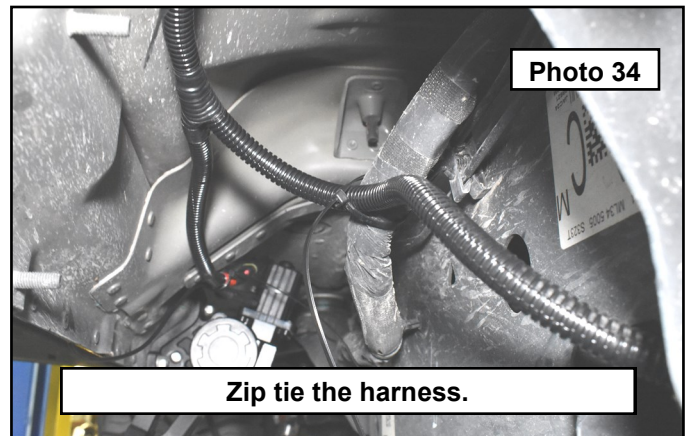
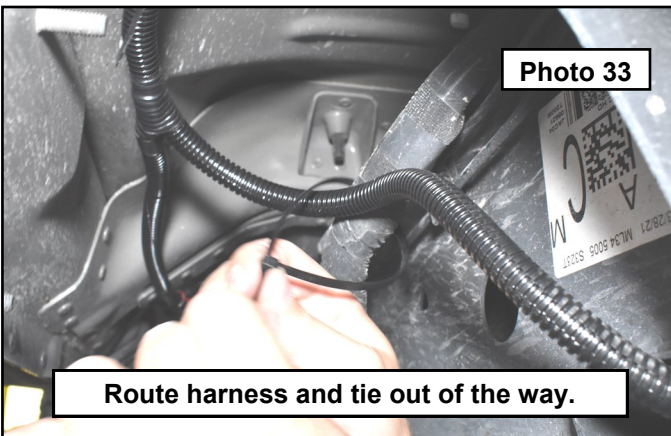

29. Connect the positive and negative wires of the harness to respective positions on the battery. With all of the doors closed and the switch in the on position, open one door at a time to see if the steps are activating. If the step does not drop down or go into the parked position, you will need to adjust the magnet at that door until the step activates. You may need to mess with this multiple times to get the steps working just right. At the time that you do get everything working properly, mark the location of the magnet and remove. Peel the double sided tape protective cover off completely and reinstall to the marked location. Do this for all magnets.

By purchasing any item sold by Rough Country, LLC, the buyer expressly warrants that he/she is in compliance with all applicable , State, and Local laws and regulations regarding the purchase, ownership, and use of the item. It shall be the buyers responsibility to comply with all Federal, State and Local laws governing the sales of any items listed, illustrated or sold. The buyer expressly agrees to indemnify and hold harmless Rough Country, LLC for all claims resulting directly or indirectly from the purchase, ownership, or use of the items.