

ROUGH COUNTRY

SUSPENSION SYSTEMS®

2022 - Up Tundra Hidden Winch

Thank you for choosing Rough Country for all of your suspension needs.

Rough Country recommends that a certified technician install this system. In addition to these instructions, professional knowledge of disassemble/reassembly procedures as well as post installation checks must be known. Attempts to install this system without this knowledge and expertise may jeopardize the integrity and/or operating safety of the vehicle. Please read all the instructions before beginning the installation. Check the kit hardware against the "Kit Contents" list below. If question exist, please call us @1-800-222-7023. We will be happy to answer any questions concerning this product. Check all fasteners for proper torque. Check to ensure for adequate clearance between all components. Check and retighten wheels at 50 miles and again at 500 miles. Periodically check all hardware for tightness. Be sure you have all the needed parts and understand where they go. Also, please review the "Tools Needed" list to be certain you have the necessary tools to complete the installation.

PRODUCT USE INFORMATION

▲WARNING As a general rule, the taller a vehicle is the easier it will roll. We strongly recommend that seat belts and shoulder harnesses be worn at all times. Braking performance and capabilities are decreased when significantly larger/heavier tires and wheels are used. Do not add, alter, or fabricate any factory or after-market parts which increase vehicle height over the intended height of the Rough Country product purchased. Rough Country makes no claims regarding lifting devices and excludes any and all implied claims. We will not be responsible for any product that is altered.

NOTICE TO DEALER AND VEHICLE OWNER

▲NOTICE Any vehicle equipped with any Rough country product must have the "Warning to Driver" decal installed on the sun visor or dash. The decal is to act as a constant reminder for whoever is operating the vehicle of its unique handling characteristics. **INSTALLING DEALER**—It is your responsibility to install the warning decal and to forward these installation instructions on too the vehicle owner for review and to be kept in the vehicle for its service life.



2022 - Up Tundra Hidden Winch

TOOLS NEEDED:

Wheel Chocks
Plastic Pry Tool
Small Pry Tool
Cutting Tools
Sand Paper
File

Metric Wrench/Socket

10mm
17mm
18mm
19mm

KIT CONTENTS:

Winch Tray (1)
Fairlead Mounting Plate (1)
D-ring Mounting Plate (2)
D-ring Spacer Plate (4)
Driver Wing (1)
Pass Wing (1)
Forged D-ring mount (2)

HARDWARE INCLUDED:

12mm x 35mm Bolt (22)
12mm x 45mm Bolt (8)
12mm x 25mm Button Head Bolt (2)
12mm Flange Nut (30)
12mm Washer (40)
6mm x 20mm Bolt (4)
6mm Nut (4)
6mm Washer (8)
#8 Socket Head Bolt (2)
#8 Nut (2)
Zip Ties (10)

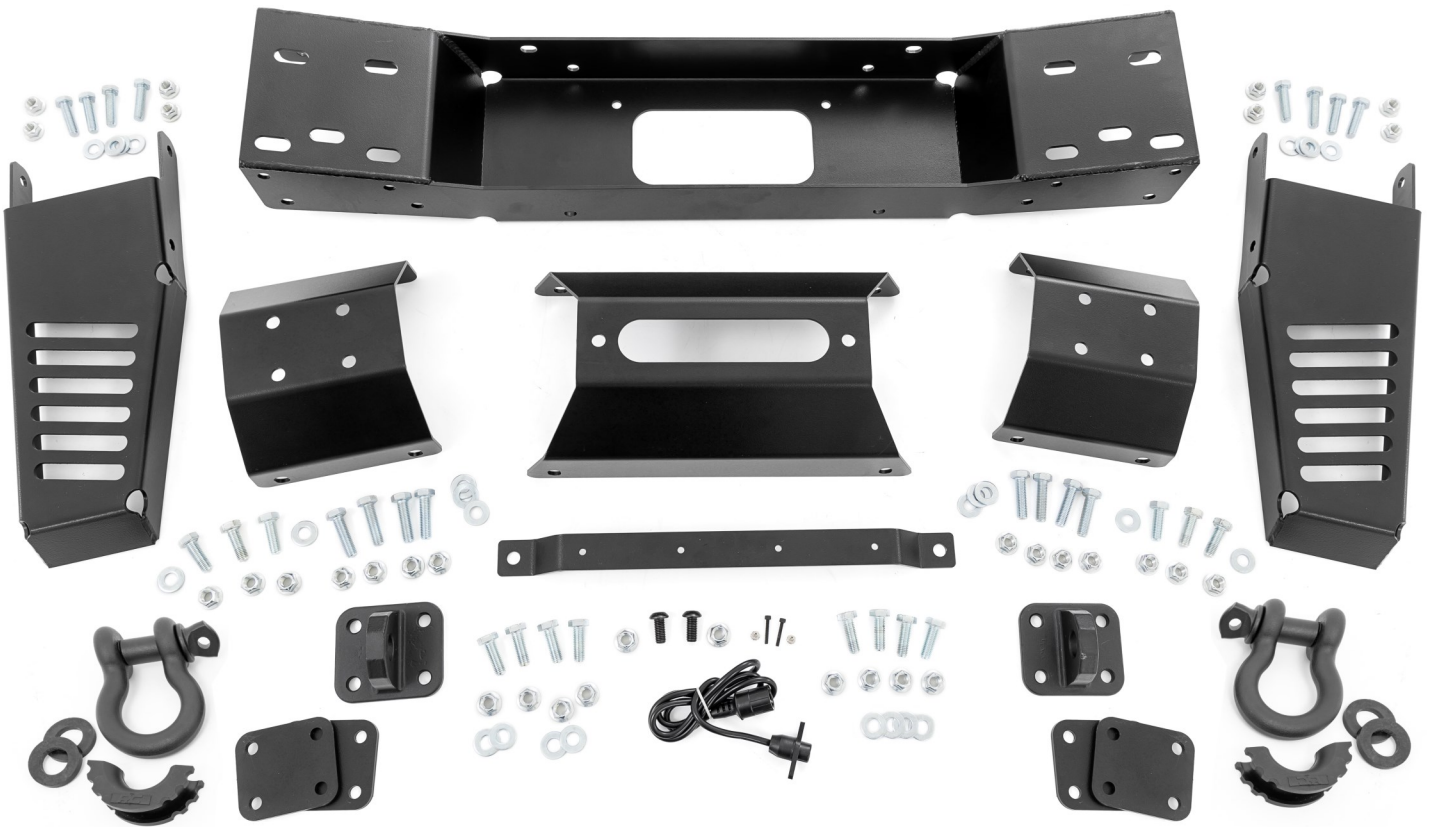

Hidden Winch Installation

1. Park your vehicle on a clean flat surface, engage the parking brake and block the rear tires.
2. **Save all hardware removed from the vehicle unless otherwise noted.**
3. Open the hood and disconnect the negative terminal on the battery.
4. The entire front will be removed from the vehicle. Have a suitable place set up to hold the front fascia once it is removed from the vehicle. You will be setting this face down to start cutting the pieces necessary to install the new hidden winch / internal bumper structure so a blanket or other protective cover is advised. **Photo 1**
5. Locate the 4 upper mounts of the grill under the hood. **Photo 2**

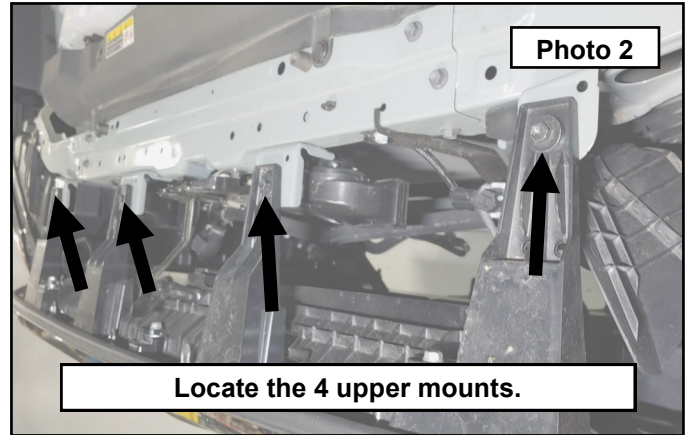

6. Remove the upper mounts using a 10mm socket. **Photo 3**
7. At each side of the grill there are electrical connectors for various electrical components in the grill. **Photo 4**

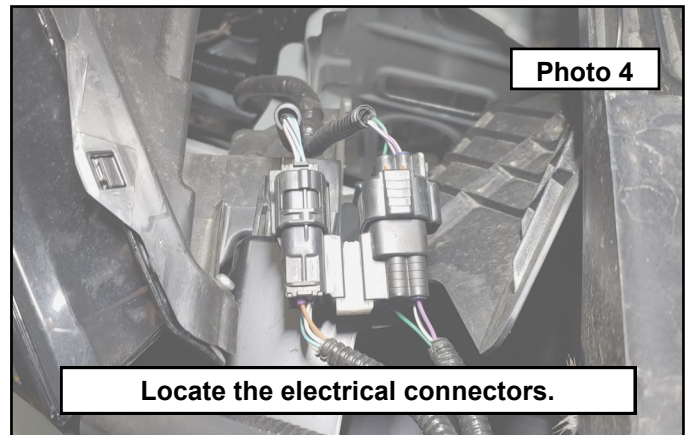

8. Disconnect the electrical connectors on the passenger and driver side and let hang out of the way. **Photo 5 / 6**

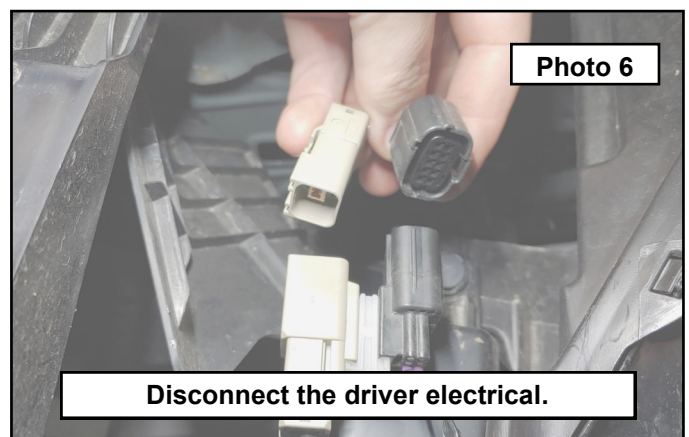
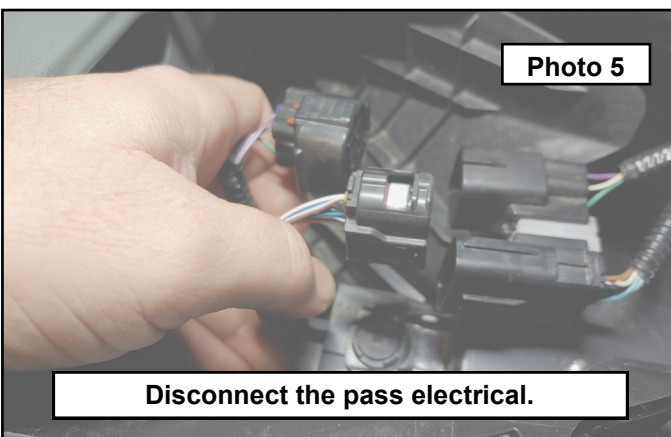

9. Use a small pry tool to pop the top of the plastic push pins up located under the electrical connections previously disconnected. Once the top is popped up, remove the push pin and set aside. **Photo 7 / 8**

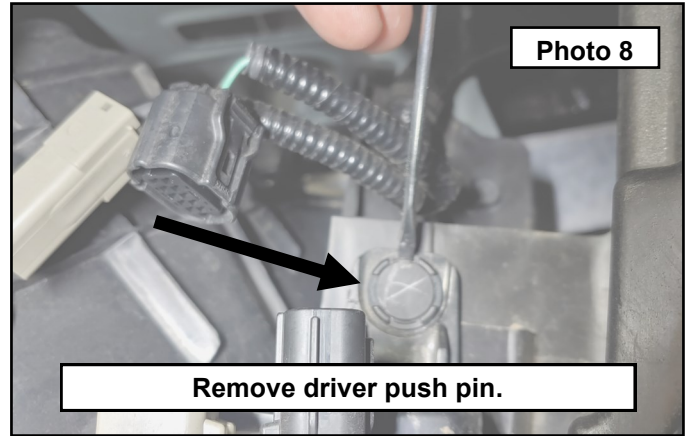
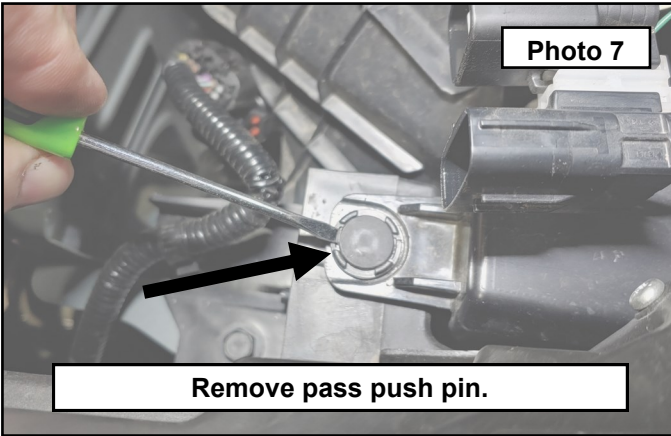

10. Front camera equipped vehicles will need to disconnect the electrical connector. **Photo 9 / 10**

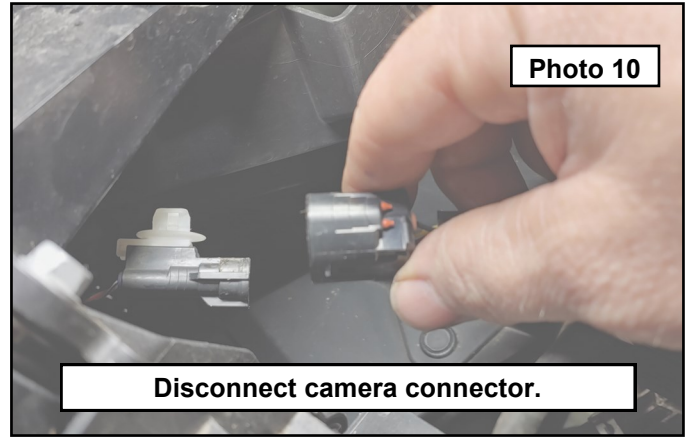
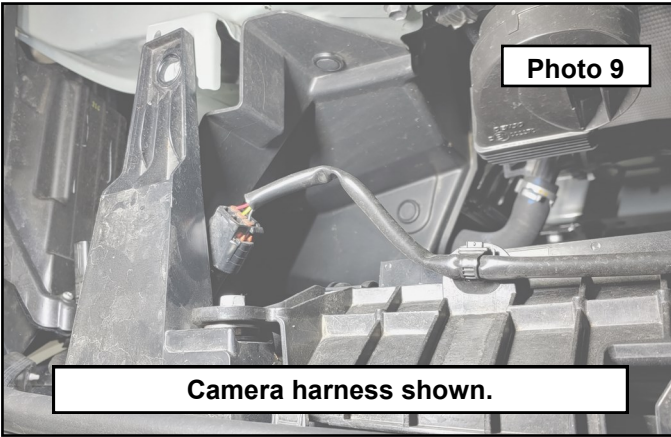

11. Working inside each wheel well, remove the hardware holding the fender flare to the bumper cover using a 10mm socket. **Photo 11**
12. Under the bumper, remove the bolts holding the inner wheel liner to the bumper cover using a 10mm socket. **Photo 12**

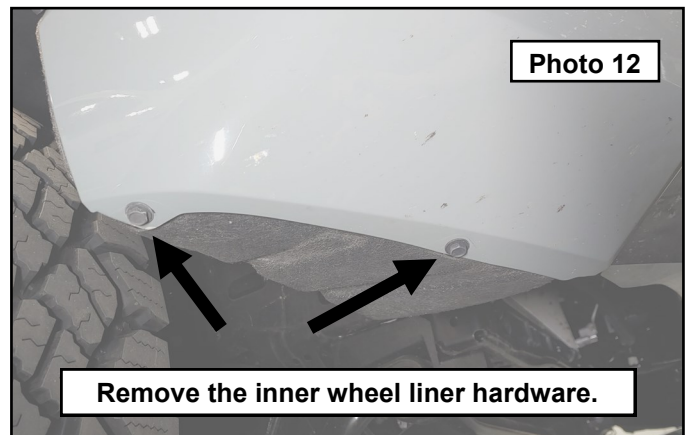
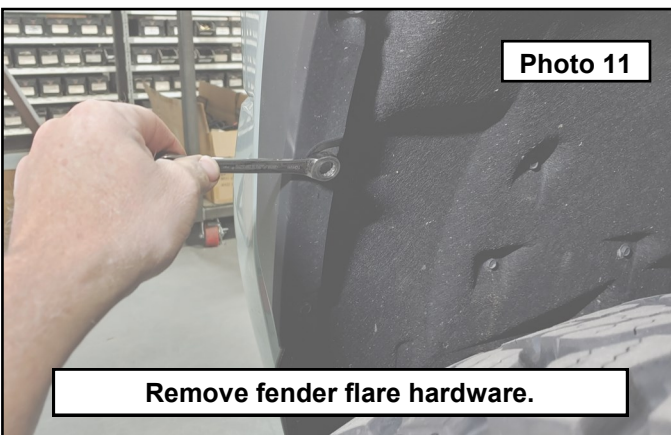

13. Under the bumper cover locate the 4 mounting tabs. Remove all the mounting hardware using a 10mm socket. **Photo 13 / 14**

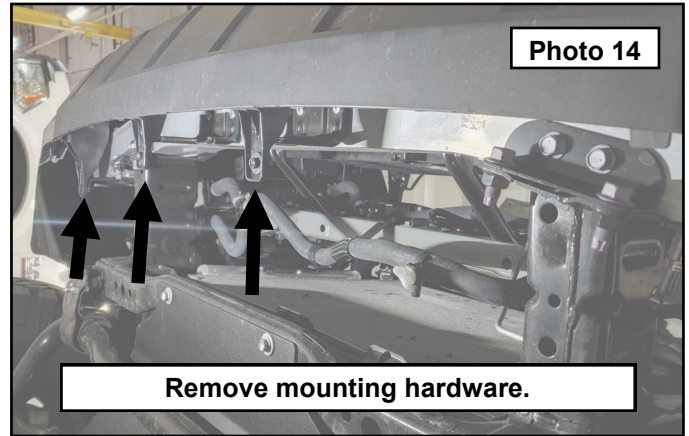
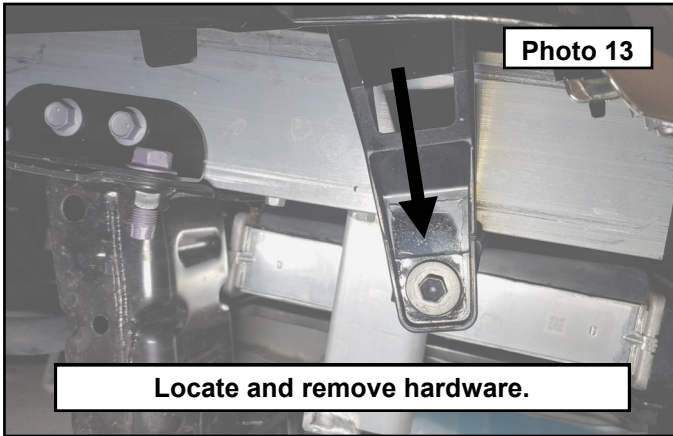

14. Use a plastic pry tool to release the fender flare from the bumper cover. **Photo 15**

15. Gently pull the bumper cover out and away from the fender to release it from its clips. Be careful to not break the mounting tab attached to the fender. **Photo 16**

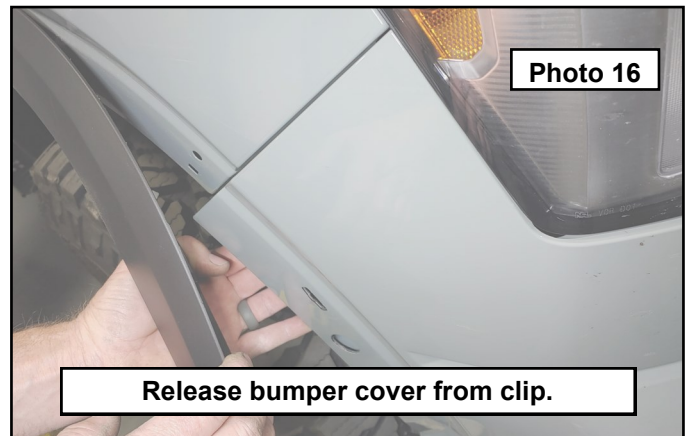
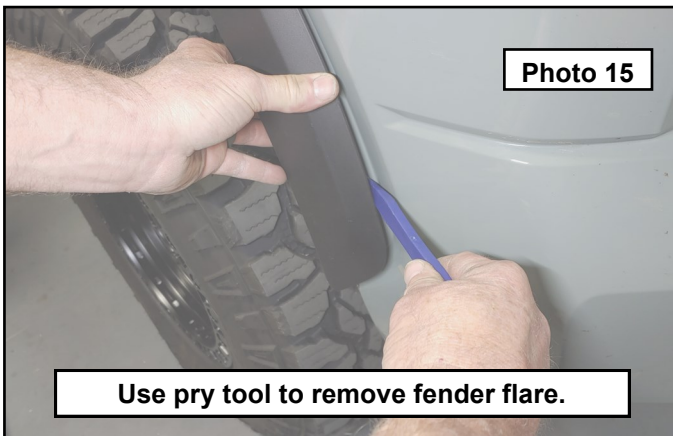

16. Continue to pull the bumper cover out and away from the fender and away from the headlight. Once this is done on one side, repeat the process for the opposite side. It is advised to use an assistant to hold the bumper cover off the vehicle while you pull the opposite side. **Photo 17**

17. Once both sides are released from their clips, pull the front fascia straight off the core support. Set onto a protected surface to keep from scratching the paint. **Photo 18**

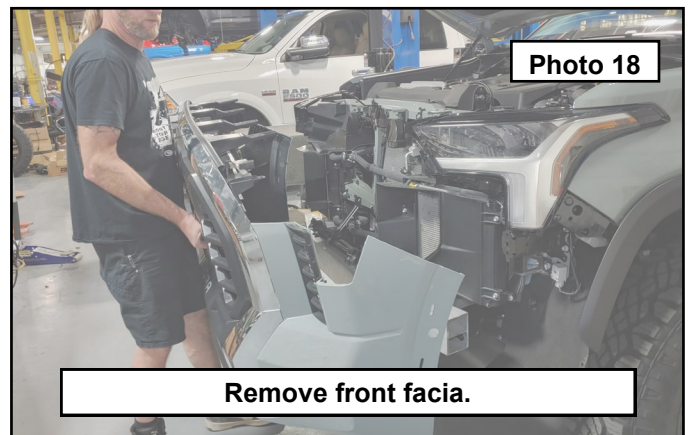

18. Remove the inner bumper to frame hardware using a 17mm wrench. There will be two forward facing bolts under each side of the bumper and two upper facing bolts on top of the bumper. **Photo 19 / 20**

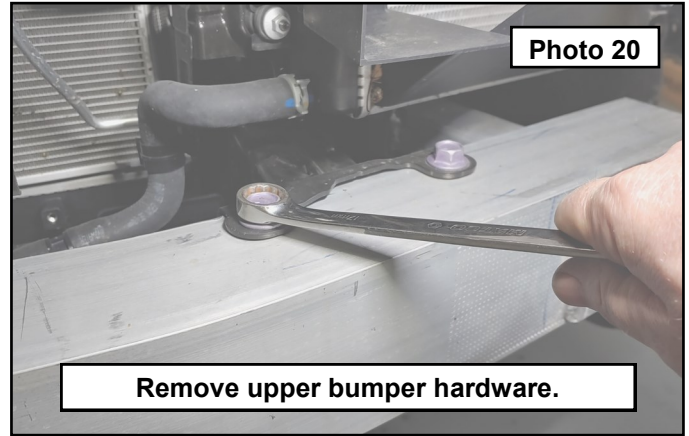
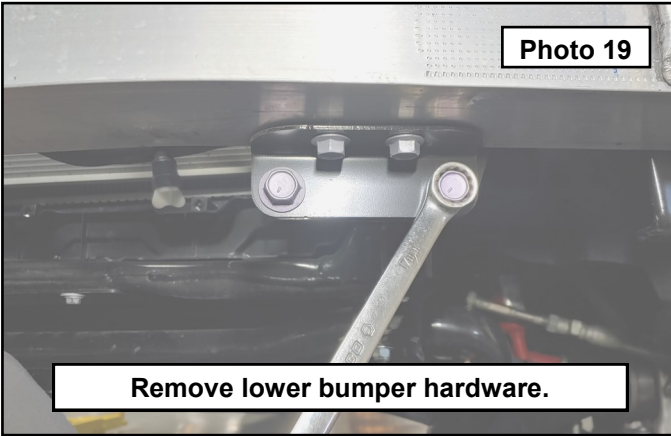

19. Remove the inner bumper from the frame rails and discard. You will not be reusing this piece. **Photo 21 / 22**

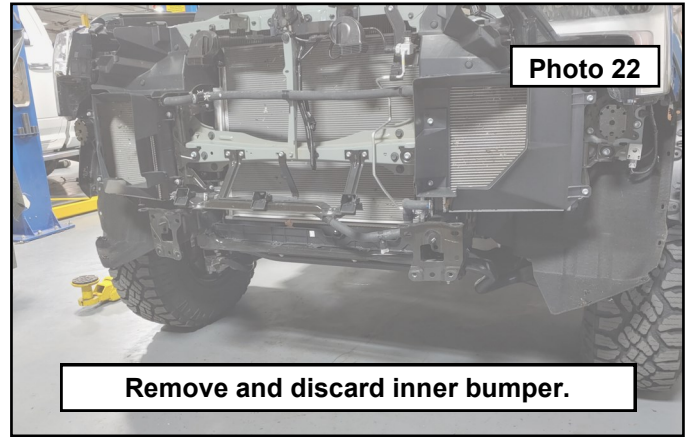
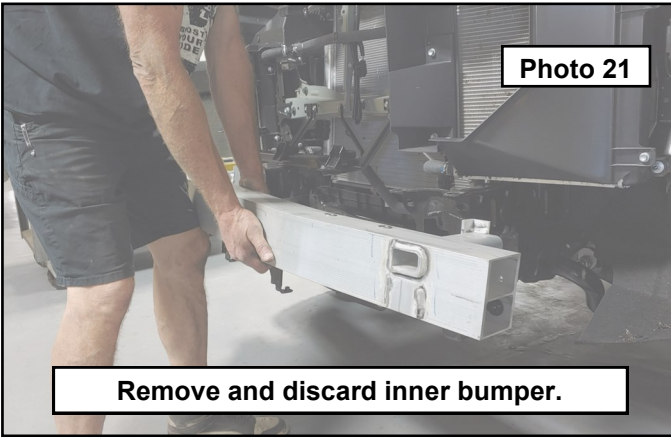

20. Remove the center facia support using a 10mm socket. You will be reinstalling in a later step, so set aside. **Photo 23 / 24**

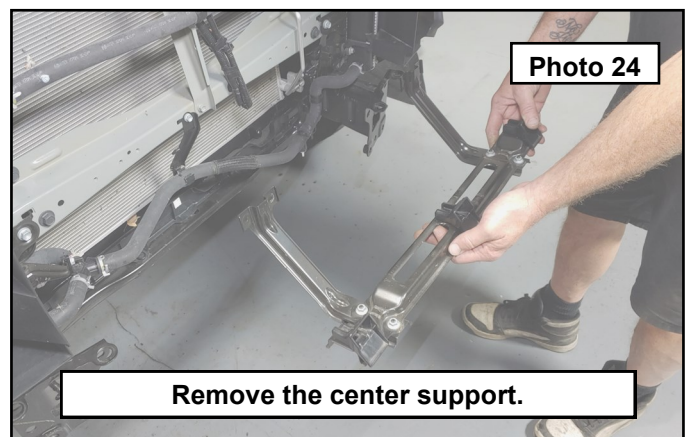
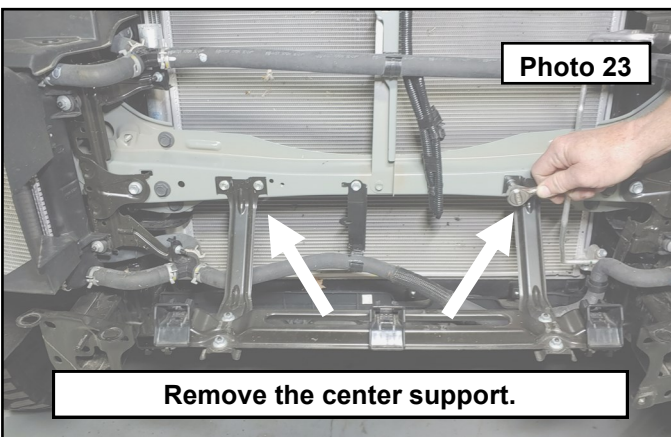

21. Move to the front facia and locate the harness that runs across the bottom edge under the air deflector assembly. Use a pry tool to remove all the mounting clips across the facia. **Photo 25 / 26**

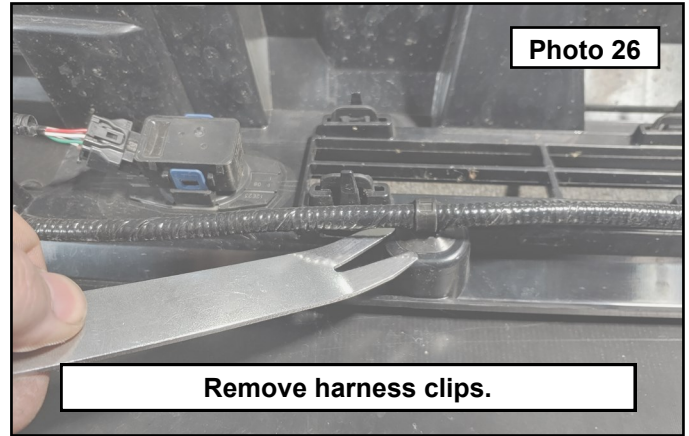
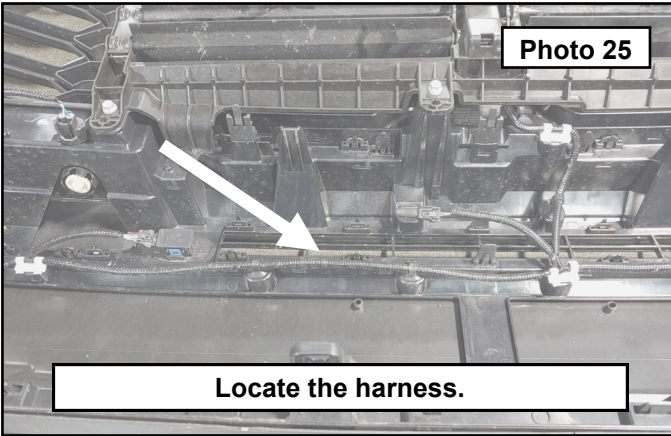

22. Use a pair of cutters and remove the clips from the harness. **Photo 27**

23. Locate the harness as shown above the grill opening and zip tie to the grill clips. **Photo 28**

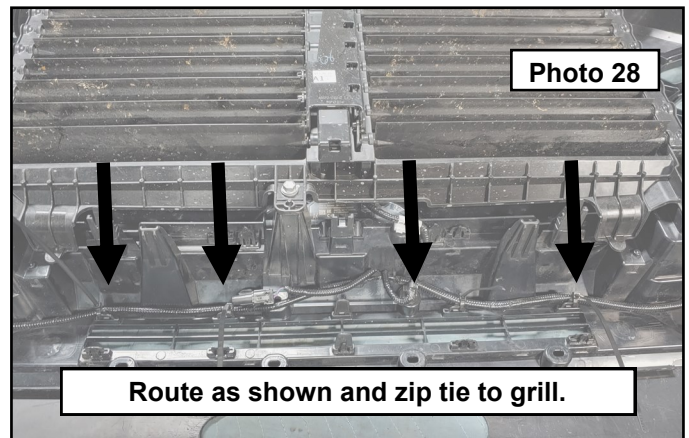
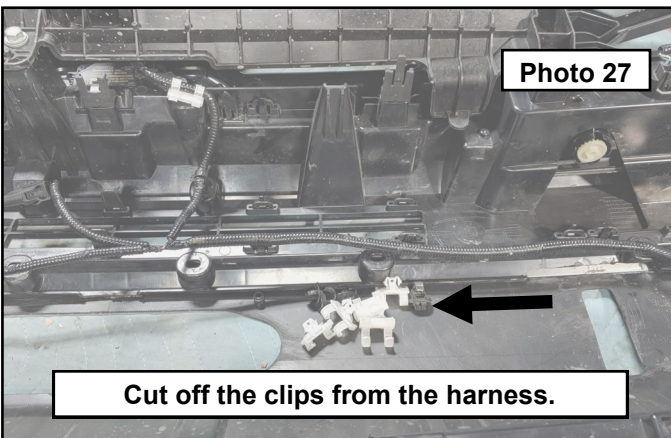

24. With the harness pushed up and out of the way, mark the inner structure where shown in three spots. This inner structure gets cut out and removed. **Photo 29**

25. Use a suitable cutting tool (air body saw shown) cut along the marks made. Do not cut through the outer skin of the center cover. **Photo 30**

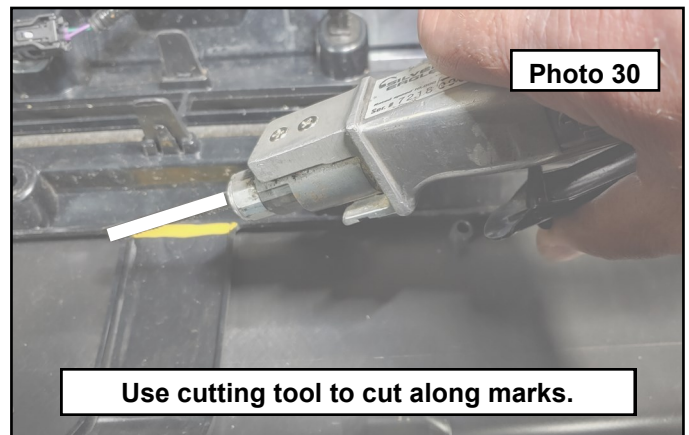
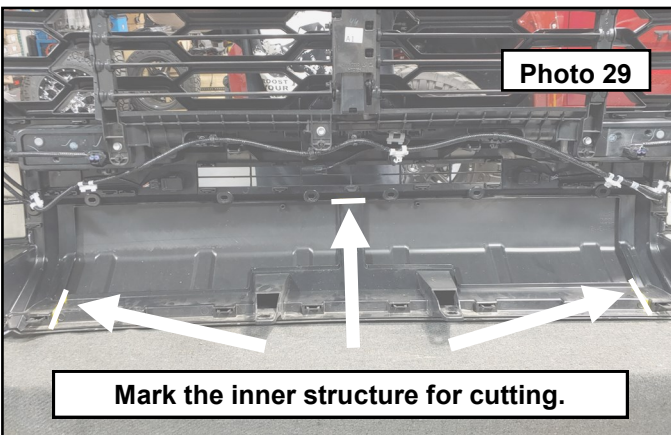

26. Continue with cutting along the marks made. Do not cut through the outer skin of the center cover. **Photo 31**
27. Once you have cut the marks all the way through, remove the inner structure from the outer cover by pressing in the plastic retaining clips and pulling off the center skin. **Photo 32**

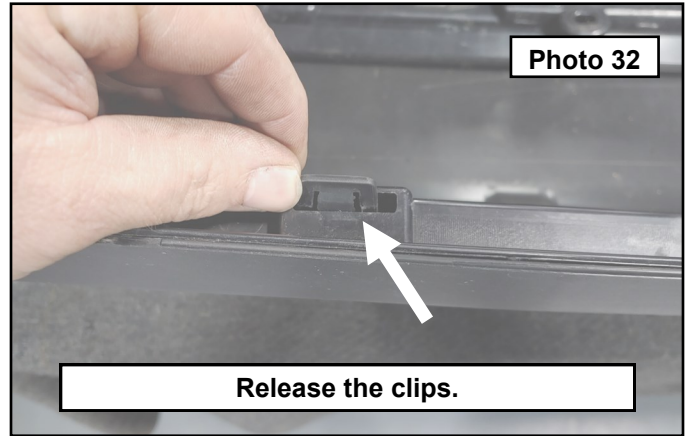

28. Remove the inner structure and discard. Sand any burrs smooth. **Photo 33 / 34**

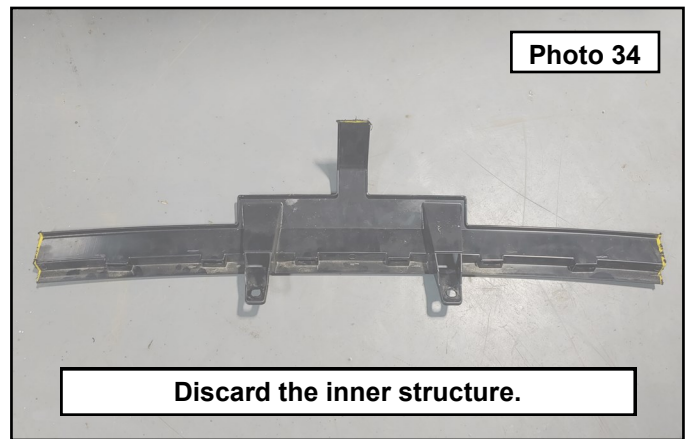
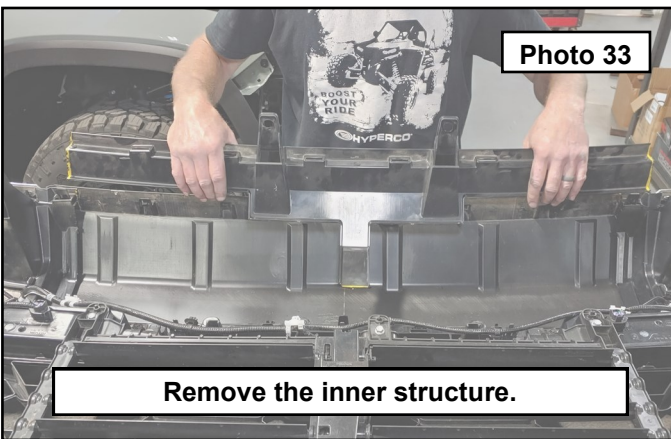

29. Cut off all of the exposed tabs from the center skin. **Photo 35**
30. Use your cutting tool to cut these tabs flush with the center skin. Sand any remaining burrs smooth with the surface of the skin. **Photo 36**

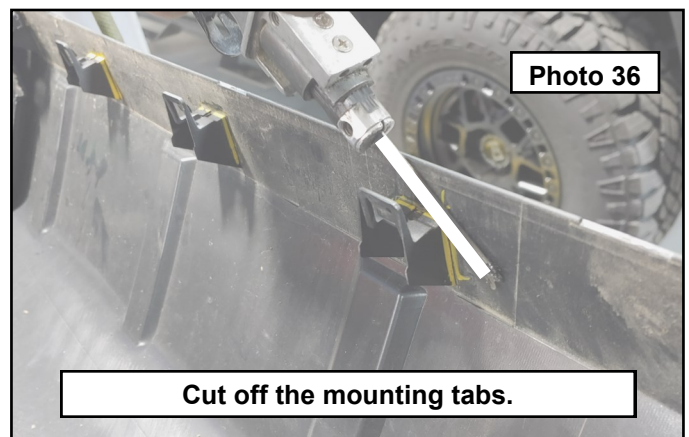
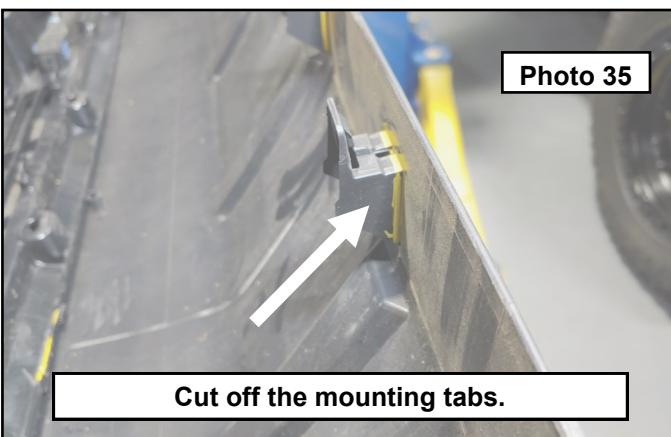

31. Mark around the two remaining large lower mounting tabs at both ends of the internal structure. **Photo 37**
 32. Cut off the mounts even with the inner structure. Sand any burrs smooth. **Photo 38**

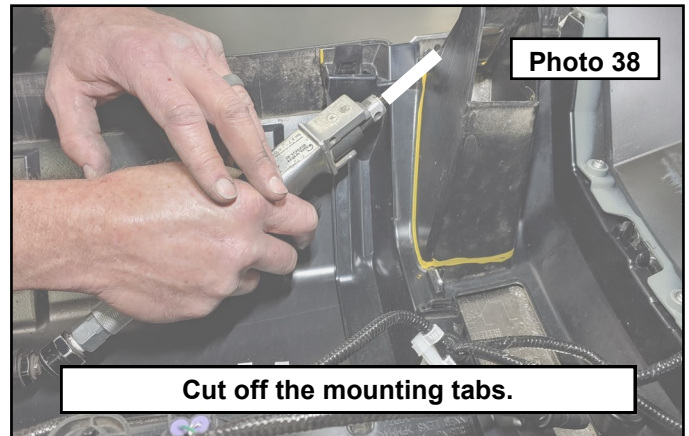
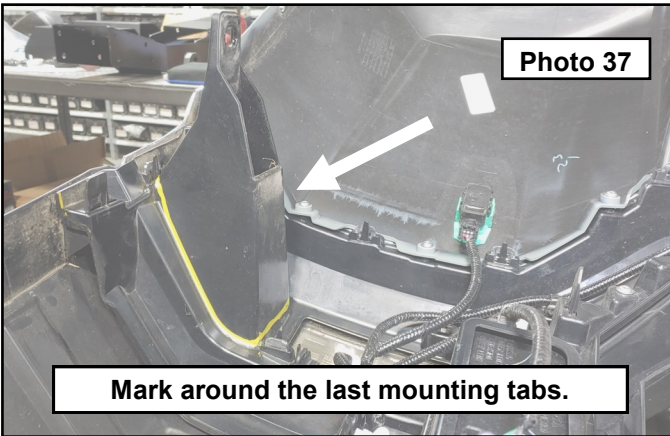

33. Locate the winch tray and fairlead mounting plate. **Photo 39**
 34. Install the fairlead mounting plate to the winch tray using the provided 12mm x 35mm bolts, washer, and flange nuts. Install each bolt with one washer so that the head is on the outside of the fairlead mount and the nut is on the inside of the winch tray. **Photo 40**

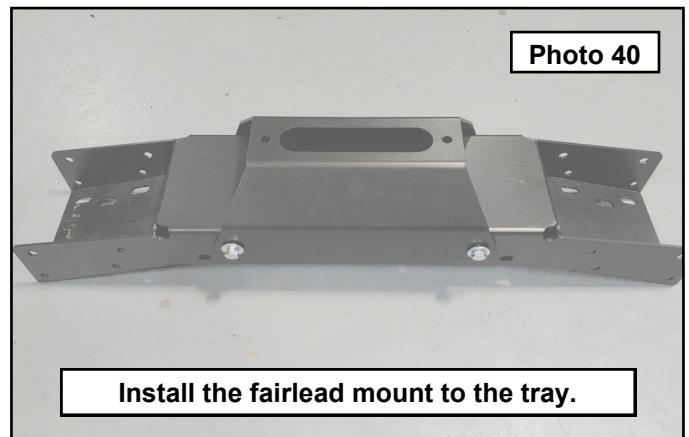
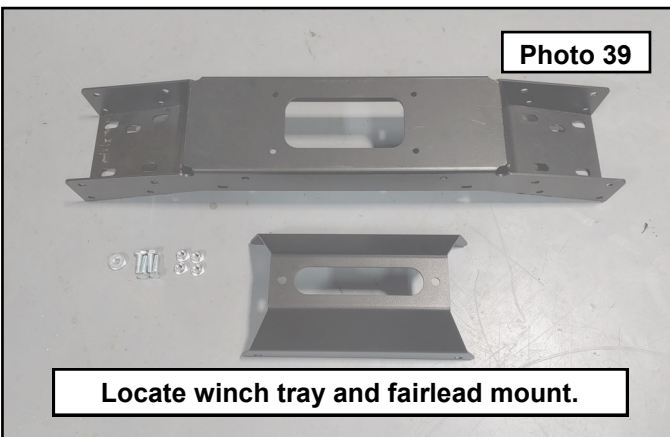

35. Install the winch tray to the frame rails using the factory bolts and provided 12mm washer in the forward locations, and provided 12mm x 35mm bolts, washers, and flange nuts in the upper mounting locations. Install so that the head of the 12mm bolt and washer are on the inside of the pocket and nuts are on top of the frame rail. **Photo 41**
 36. Adjust the winch tray in the frame rails so that the fairlead opening is centered between the frame rails and only snug the frame hardware. This assembly will be removed in a later step to install the winch and final install. **Photo 42**

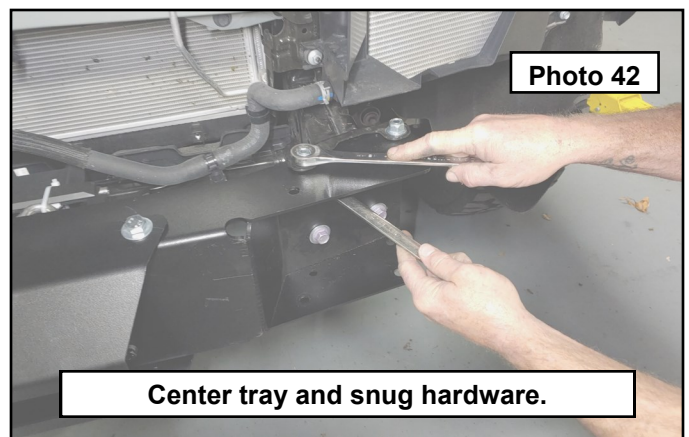
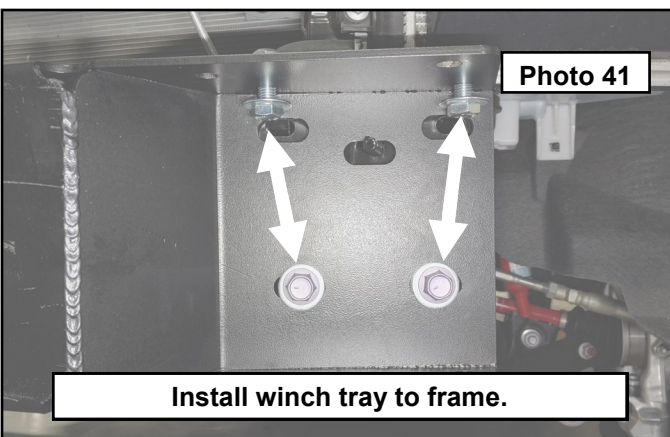

- 37. Pull the fairlead mount as far forward as possible and torque to 45 ft-lbs. **Photo 43**
- 38. Install D-ring mounting plate to the winch tray using the provided 12mm x 35mm bolts, washers, and flange nuts. Snug the hardware up. **Photo 44**

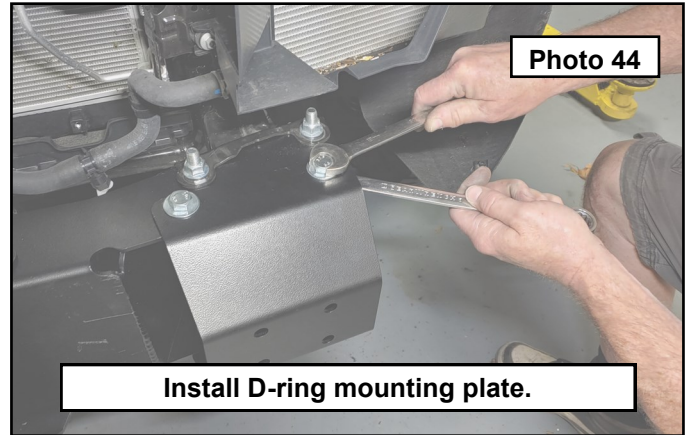
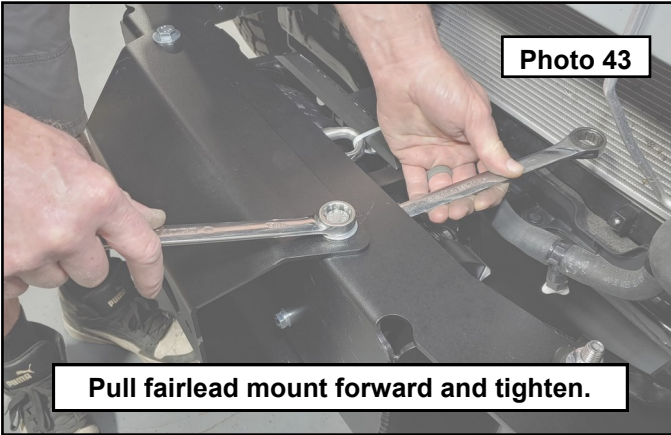

- 39. Repeat the process for the opposite side tow hook mounting plate. **Photo 45**
- 40. Mark around the frame mount and the tow hook mounting plate onto the winch tray. These marks are used to line the parts back up to insure fitment into the bumper cover in later steps. **Photo 46**

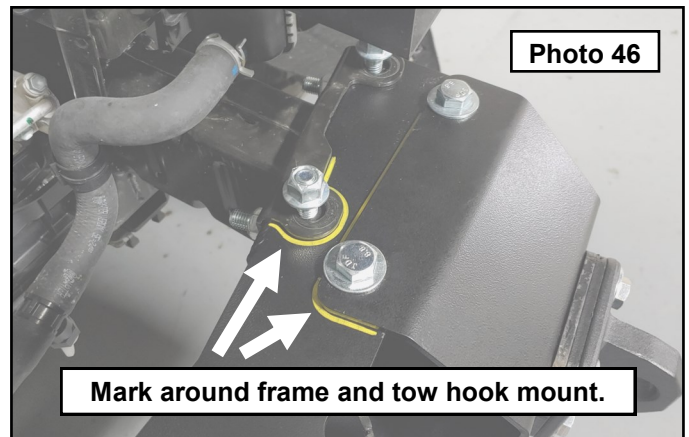
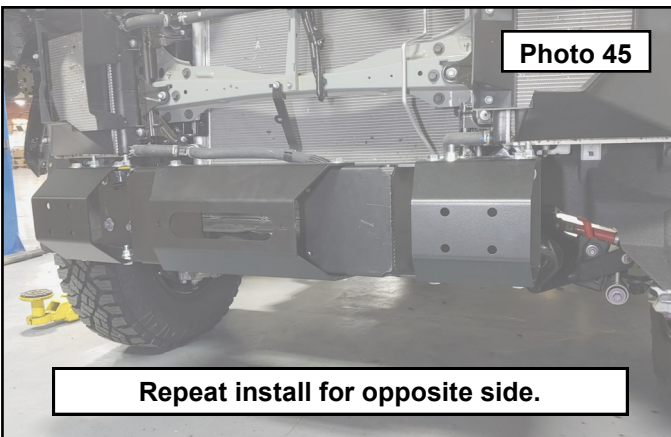

- 41. Reinstall the front fascia to the core support using two of the upper mounting bolts to hold in place and snapping the area under the headlight. Do not have to snap the sides into the fenders as the fascia will be removed after marking the locations to cut out for the hidden winch on the backside of the center skin. **Photo 47**
- 42. Crawl under the vehicle and look through the winch tray, use a marker to trace the mounting hole locations for the fairlead. **Photo 48**

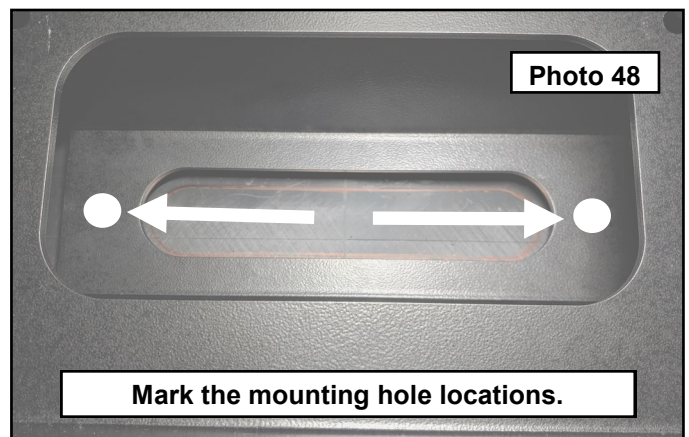
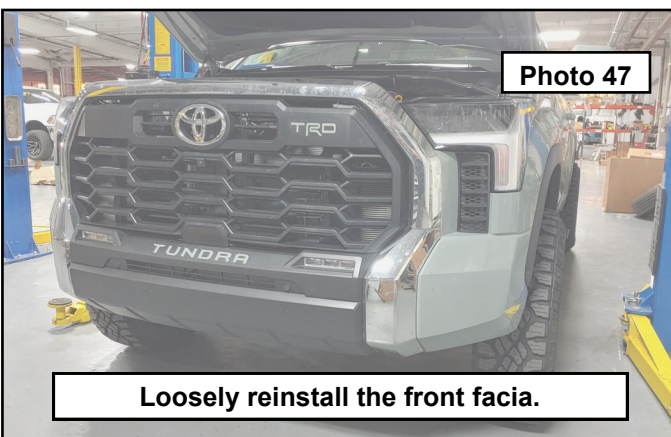

43. Mark the mounting hole locations for the D-ring mounts if installing the external D-rings. This is optional based on personal preferences. **Photo 49**
44. Remove the front facia and set onto the work surface. Lay the Hawes fairlead from the winch kit box onto the marked hole locations and trace around the outer perimeter. **Photo 50**

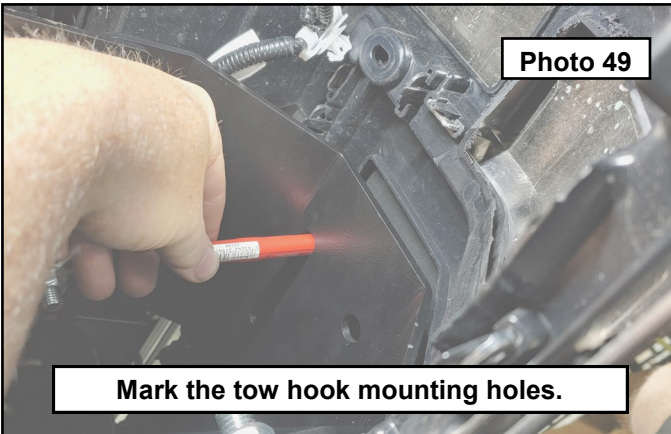

45. Use the cutting tool to remove the marked perimeter of the fairlead. It is advised to cut to the inside of the line so you can “sneak up” to the line with a sander or file and then test fit the fairlead. Sand any burrs smooth. **Photo 51**
46. Lay the Forged D-ring mounts over the marked hole locations. The top edge of the mount lines up with the top edge of the inner structure and the side of the extrusion will line up with the start of the raised indentation in the skin. See arrows. **Photo 52**

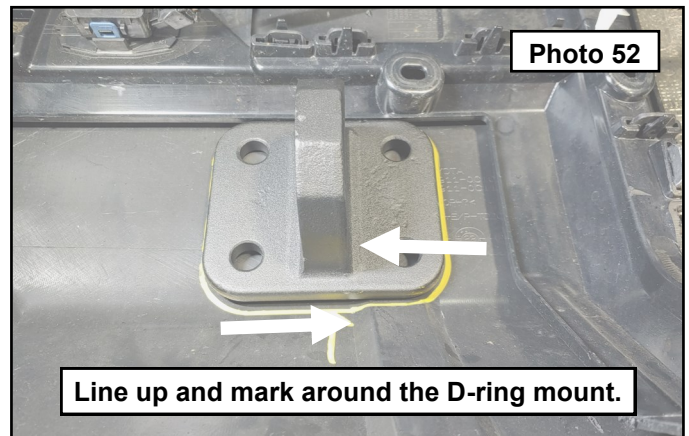
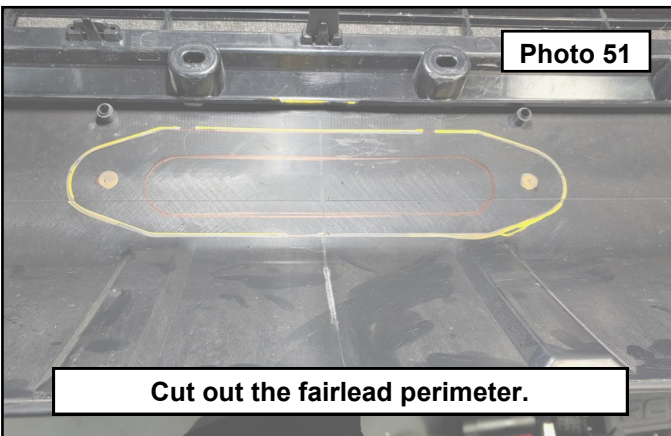

47. Trace around the outside perimeter of the D-ring mount. Draw a rectangle that matches the extrusion of the D-ring mount. Only cut out the rectangle for a clean finished look. **Photo 53**
48. Drill out the 4 corners of the rectangle to use as starter points for the cutting tool. Use the cutting tool to remove the marked rectangle. It is advised to cut to the inside of the line so you can “sneak up” to the line with a sander or file and then test fit the D-ring mount. **Photo 54**

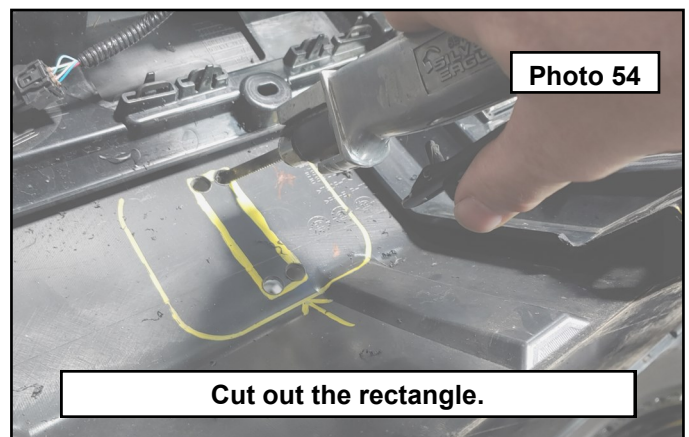
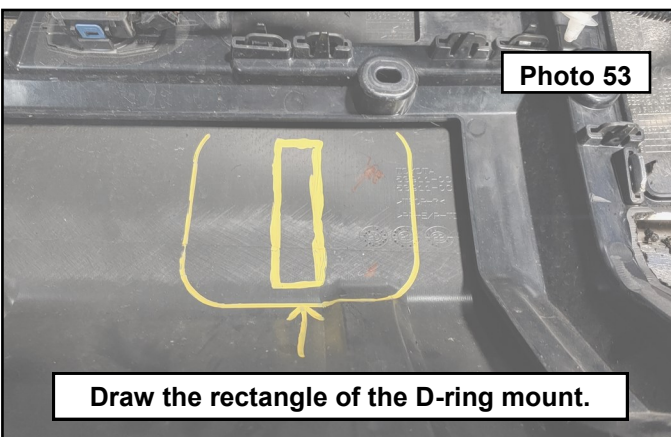

49. Remove the winch tray assembly from the frame. Set the winch upside down onto the control box. Install the negative cable and the square nuts to the winch. **Photo 55**
50. Install the winch tray to the winch using the provided hardware from the winch kit. Make sure the free spool handle is located on the driver side of the winch tray. **Photo 56**

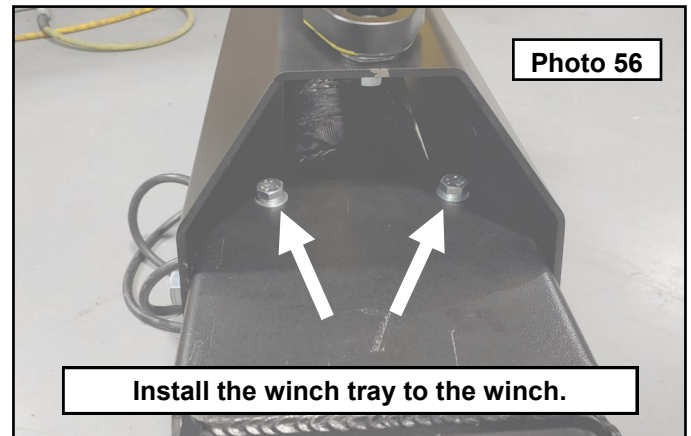
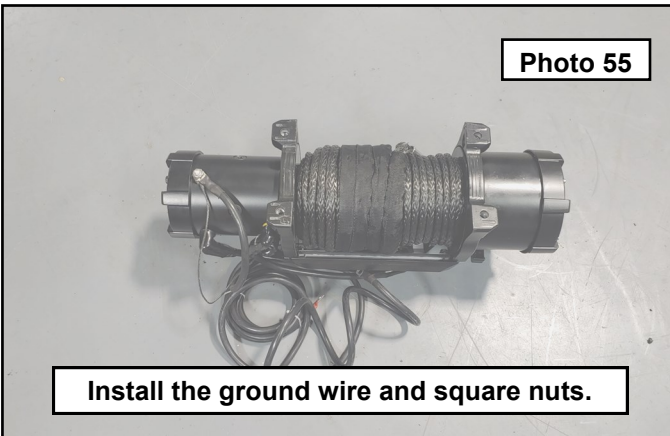

51. Install the forged D-ring mounts to the assembly with two 1/4" thick spacer plates under each mount using the provided 12mm x 45mm bolts, washers and flange nut. **Photo 57 / 58**

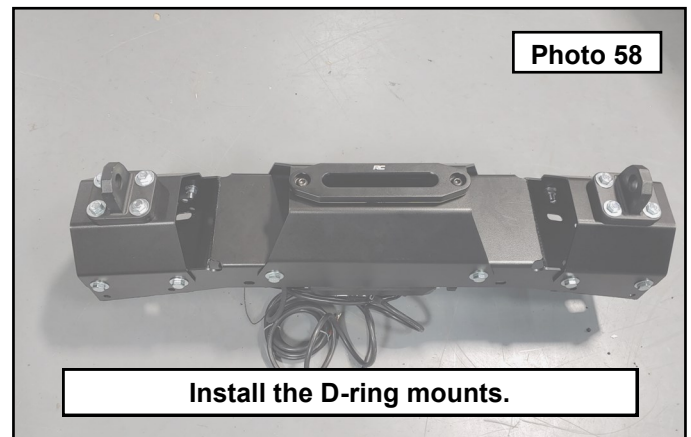
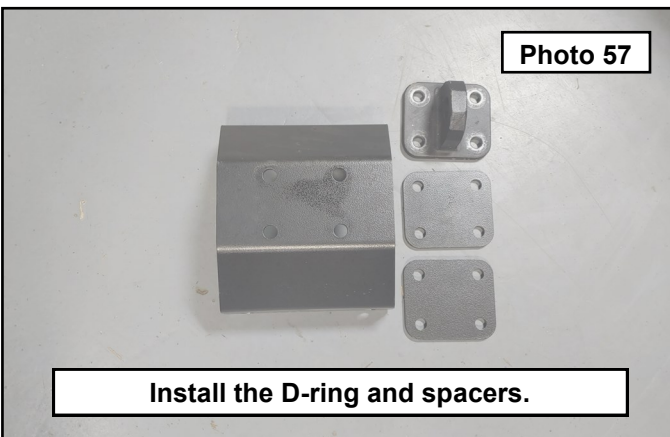

52. Remove the D-ring mounting plates in preparation for the wing install. Reinstall the winch tray assembly to the frame rails. Install all the previously removed hardware but leave loose. Install two 12mm x 35mm bolts, washers, and flange nuts to the upper forward facing bolt locations on both sides. The head of the bolt will need to be installed to the front of the vehicle. Once all bolts are installed, line the winch tray to the frame rails using the marks made previously so that it is in the same place as before. Torque the hardware to 45 ft-lbs. **Photo 59**
53. Install the driver and passenger wings into the winch tray. Line the wings up with the D-ring mounting plate holes. **Photo 60**

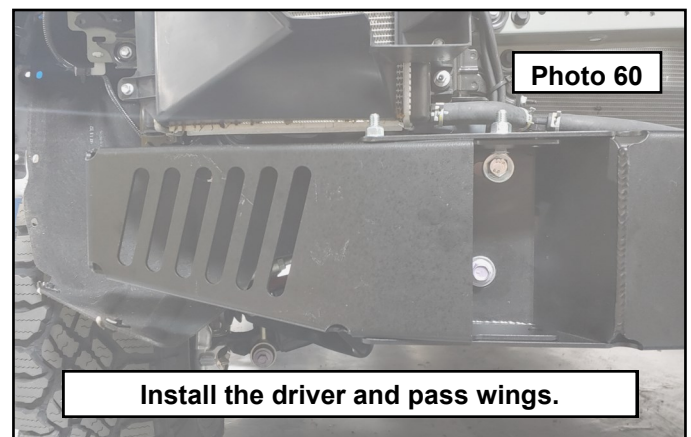
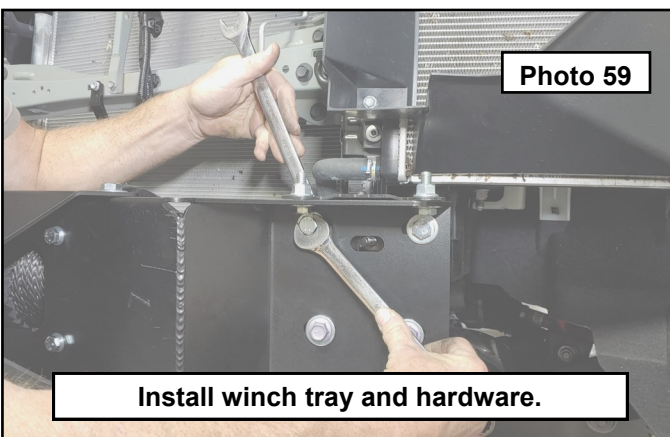

54. Reinstall the D-ring mounting plates to the winch tray using the previously removed hardware and marks to line up in the same spot as before. Torque all hardware to 45 ft-lbs. **Photo 61 / 62**

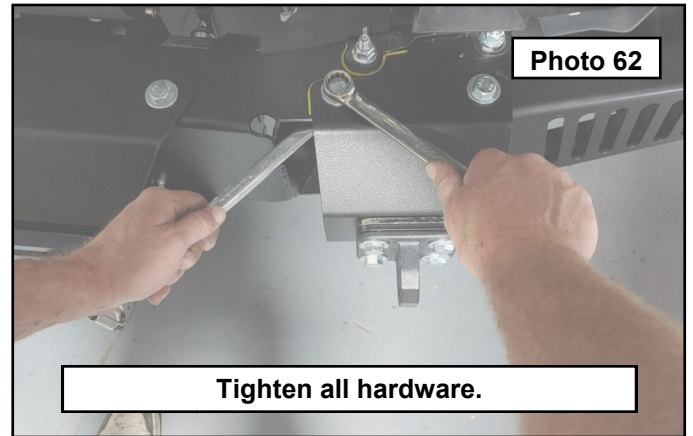
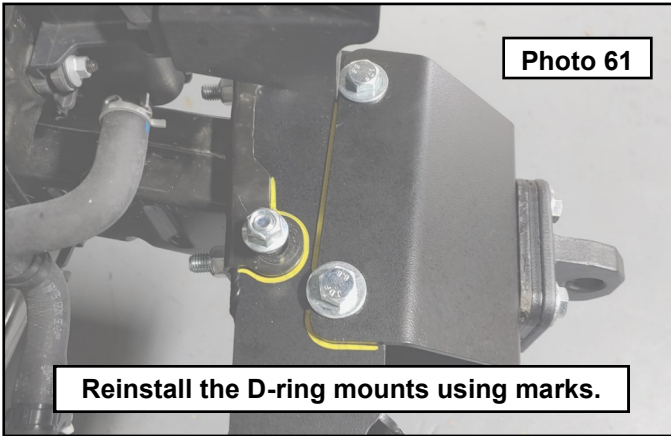

55. Run the winch rope through the opening in the winch tray. Install the fairlead using the provided 12mm Black Button Head bolts included in the kit and the 12mm standard nuts from the winch hardware bag. There will be left over washers in the kit that can be used as fine tune spacers between the fairlead and mounting plate to adjust fitment through the bumper cover. **Photo 63**

56. Run the winch electrical up the passenger side core support and into the engine bay. **Photo 64**

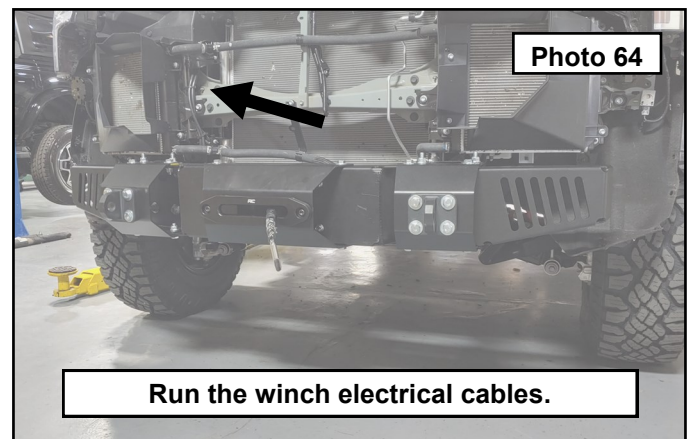
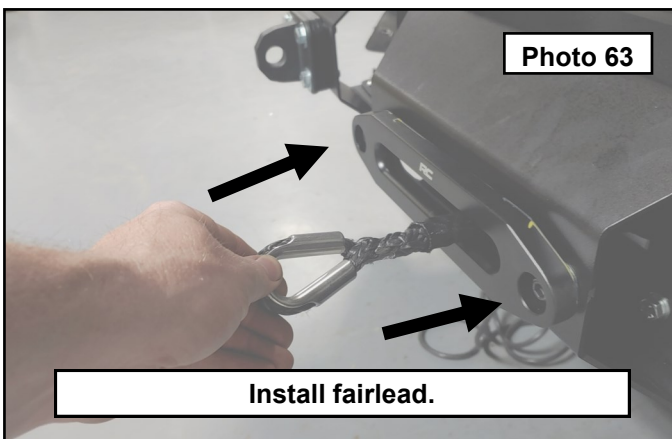

57. Under the winch tray, install the lower bumper mount using the provided 12mm x 35mm bolts, washer, and flange nuts. **Photo 65**

58. Reinstall the grill center support using the factory hardware. **Photo 66**

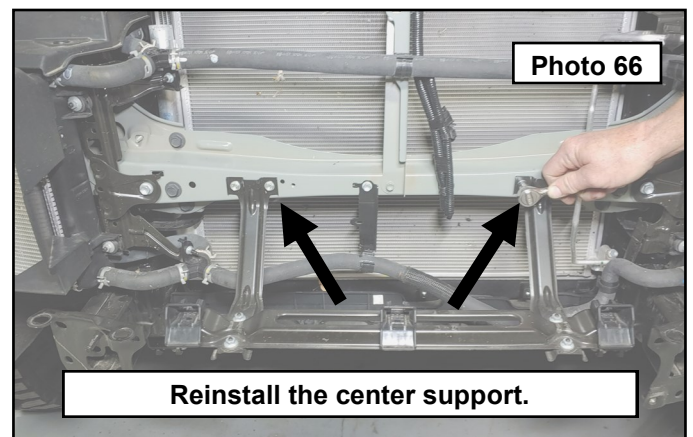
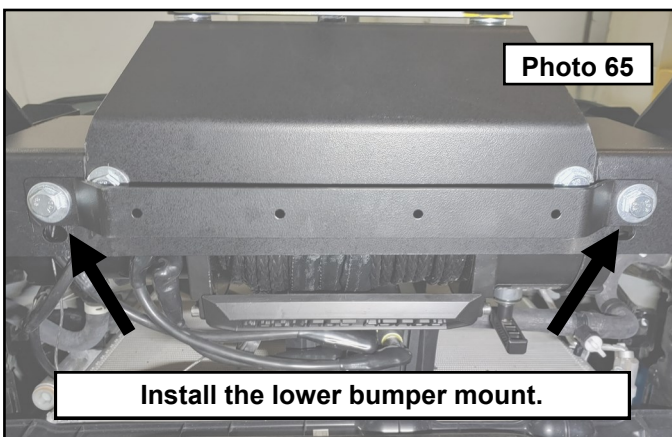

59. Reinstall the front fascia while making sure your cut outs line up with the hidden winch kit. Adjust as necessary (final trimming may need to be done to have fitment satisfactory). Once this is established, reinstall the front fascia completely using the factory hardware and snapping in all the clips around the headlights, fender, and center support. Reconnect all electrical connectors. Photo 67

60. Install the D-rings of choice. The D-rings may touch the front plastic. Photo 68

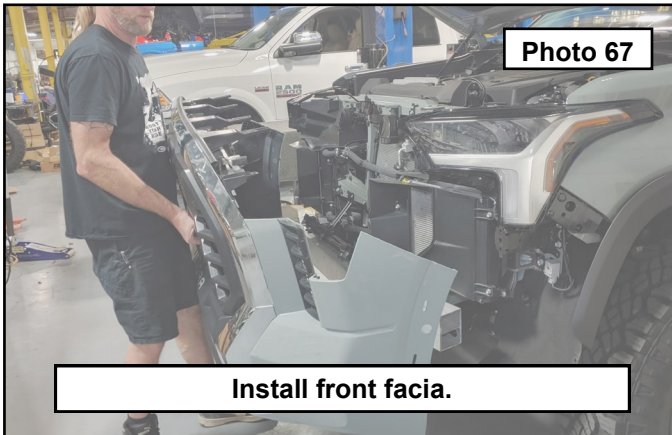

61. Once the front fascia is completely installed, go under the vehicle to install the bumper to the lower bumper mount on the winch kit. Push the plastic up to the mount and mark the 4 holes needed to drill for mounting. Photo 69

62. Use a drill with a 1/4" bit to drill out the marked locations. Photo 70

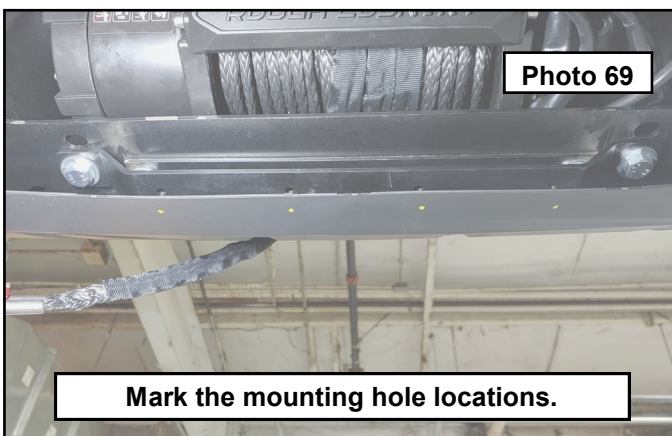

63. Install the bumper to the mount using the provided 6mm button head bolts, washers and locking nuts. Photo 71

64. The kit comes with an extension for the winch controls. This is universally mounted so find a spot that is suitable for access. This shows installing into the core support guard on the passenger side of the vehicle. Photo 72

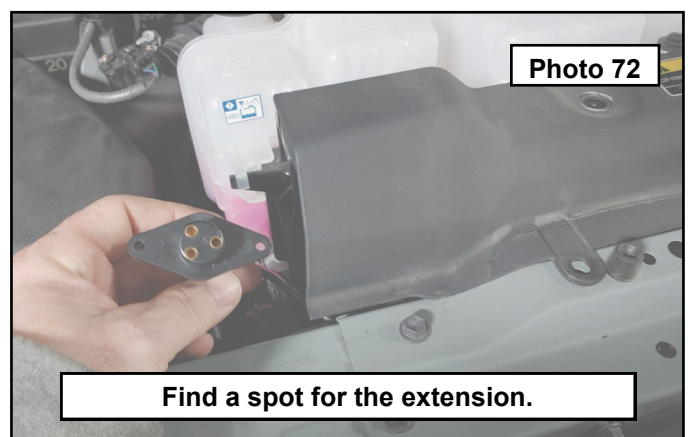

65. Remove the cover from the extension. Use the cover to mark the holes needed to install the extension housing to the plastic cover. Make the center hole larger than the outer cover by a small amount so that it will sit down onto the extension housing properly. Photo 73
66. Use a cutting tool and/or drill to cut/drill out the marked area. Photo 73

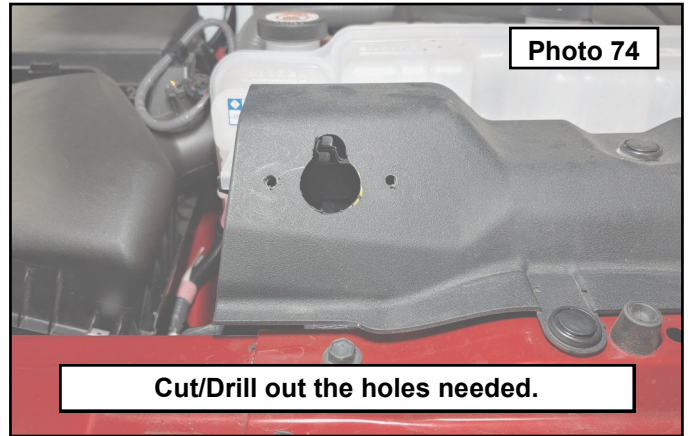
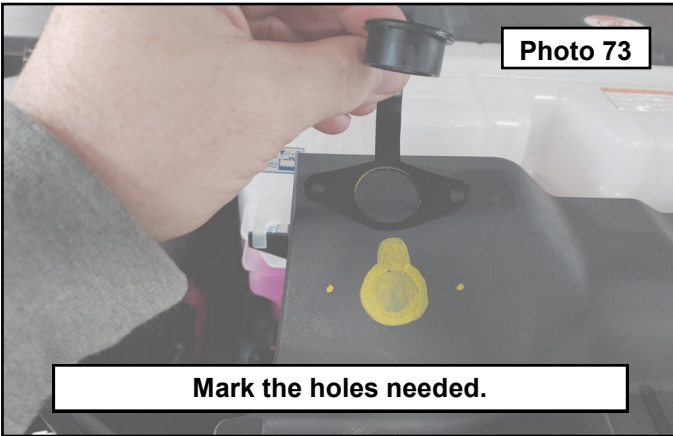

67. Install the cover between the extension housing and location of install using the provided 3mm socket head bolts and nuts. Plug the extension into the winch control box and zip tie the harness out of the way. Photo 75 / 76

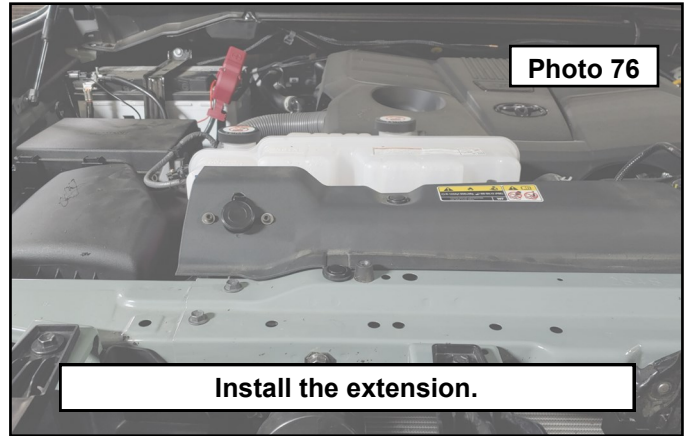
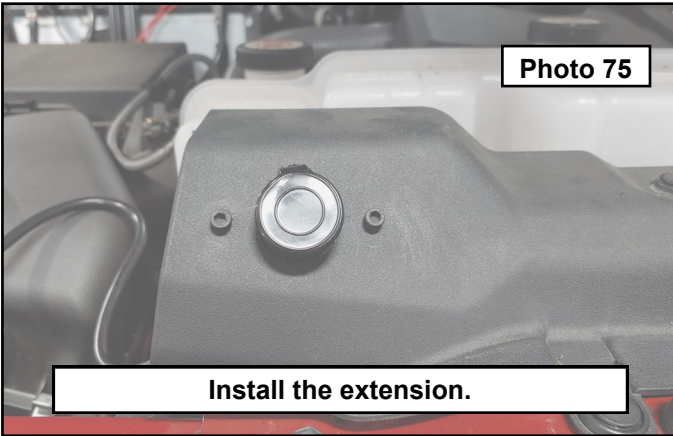

68. Alternate location for install shown. Photo 77

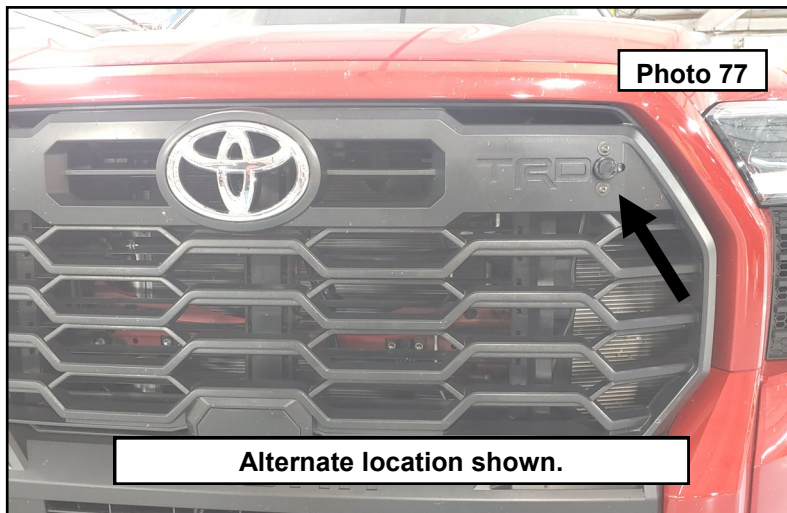

By purchasing any item sold by Rough Country, LLC, the buyer expressly warrants that he/she is in compliance with all applicable , State, and Local laws and regulations regarding the purchase, ownership, and use of the item. It shall be the buyers responsibility to comply with all Federal, State and Local laws governing the sales of any items listed, illustrated or sold. The buyer expressly agrees to indemnify and hold harmless Rough Country, LLC for all claims resulting directly or indirectly from the purchase, ownership, or use of the items.