

270° AWNING

Thank you for choosing Rough Country for all your vehicle needs.

Please read instructions before beginning installation. Check the kit hardware against the kit contents shown below. Be sure you have all needed parts and know where they go.

If question exist, please call us @1-800-222-7023. We will be happy to answer any questions concerning this product.

Check all fasteners for proper torque. Check to ensure for adequate clearance between all components.

Periodically check all hardware for tightness.

▲ NOTICE This product is designed to work with the Rough Country bed rack system.

▲ NOTICE If Rough Country bed rack is already installed, some disassembly is required.

▲ NOTICE If a tent is installed, the tent may need to move to passenger side for clearance.

KIT CONTENTS:

Awning
Brackets x2
Stakes x3
Guy Line x3
Ratcheting Rope

Hardware Included:

Flag Washer x2
8mm x 20mm Bolt x8
8mm x 55mm Bolt x8
8mm Lock Nuts x16
8mm x 20mm Button Head Bolt x4
8mm Black Lock Nut x4
8mm Black Flat Washer x4
8mm Black Lock Washer x4

TOOLS REQUIRED:

10mm Wrench (included)
13mm Wrench (included)
5mm Allen Wrench

Torque Specs:

Size	Grade 5	Grade 8	Size	Class 8.8	Class 10.9
5/16"	15 ft/lbs	20ft/lbs	6MM	5ft/lbs	9ft/lbs
3/8"	30 ft/lbs	35ft/lbs	8MM	18ft/lbs	23ft/lbs
7/16"	45 ft/lbs	60ft/lbs	10MM	32ft/lbs	45ft/lbs
1/2"	65 ft/lbs	90ft/lbs	12MM	55ft/lbs	75ft/lbs
9/16"	95 ft/lbs	130ft/lbs	14MM	85ft/lbs	120ft/lbs
5/8"	135ft/lbs	175ft/lbs	16MM	130ft/lbs	165ft/lbs
3/4"	185ft/lbs	280ft/lbs	18MM	170ft/lbs	240ft/lbs



INSTALLATION INSTRUCTIONS

1. If Rough Country bed rack is already installed, remove the two bolts securing the cross member to the driver side corner pieces. Retain hardware for reuse. Remove plastic end cap. **See Photo 1.**
2. Place bracket on driver side corner piece and align the slots with the four holes. Use the 8mm hardware from the bed rack kit to secure the inner bracket slot. Tighten with a 5mm Allen wrench. **See Photo 2.**

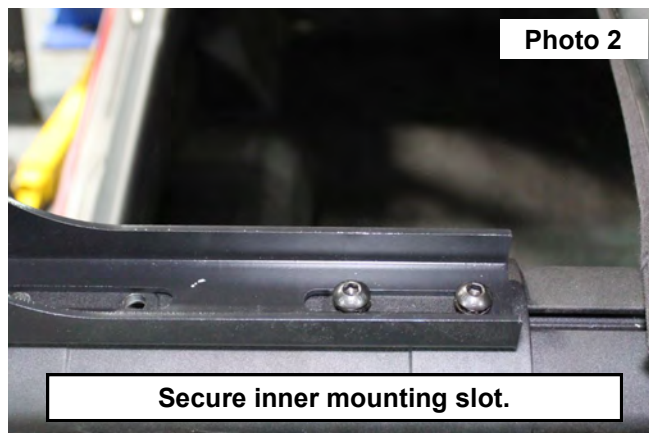
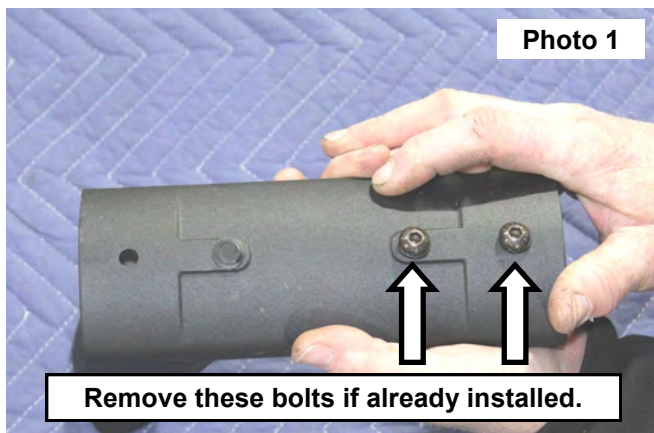

3. Use two (2) of the supplied 8mm black oxide bolts, flat washers, lock washers, and lock nuts to secure the outer bracket slot to the corner piece. Tighten with a 13mm wrench and 5mm Allen wrench. **See Photo 3.**
4. Repeat for other bracket/corner piece on the driver side.
5. Reinstall plastic cover caps. **See Photo 4.**

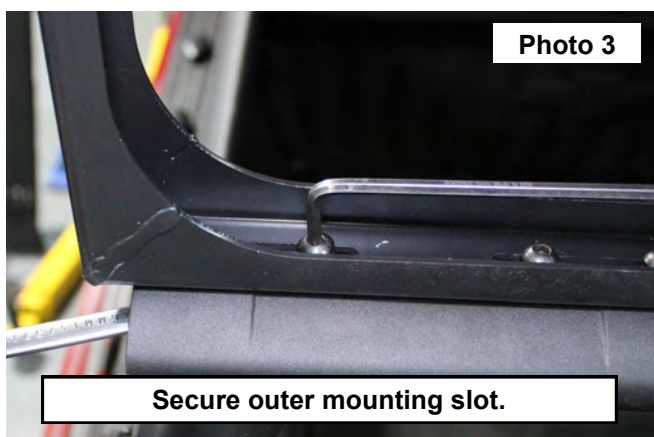

6. Slide eight (8) 8mm x 20mm stainless bolts into the track of the awning. Two bolts will go in each track. **See Photo 5.**
7. Align the bolts with the holes of the awning brackets and secure with the supplied 8mm stainless lock nuts. Slide the awning towards or away from cab as needed to get proper fitment. Tighten with a 13mm wrench. **See Photo 6.**

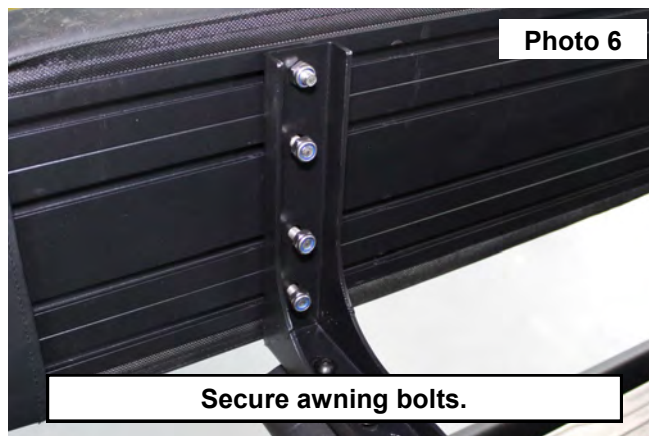
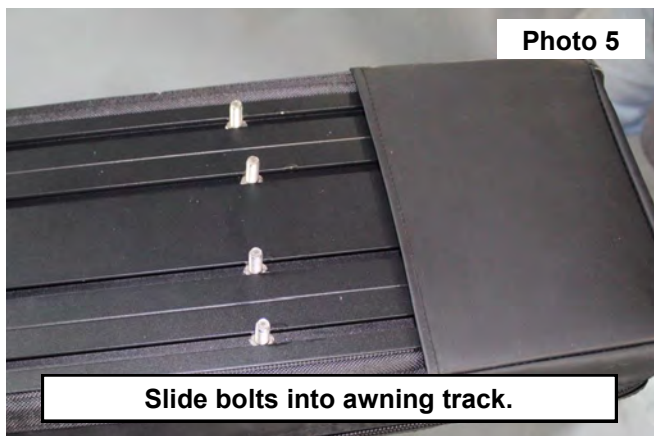

AWNING SETUP

1. Unzip the awning bag and fold bag over the top. Release the Velcro straps. **See Photo 1.**
2. Walk the awning around to unfold it completely. **See Photo 2.**



3. Attach the ratchet rope block end to the last loop of the awning. **NOTE:** Loop will be on the section shown in the previous photo. **See Photo 3.**
4. Secure the free end of the ratchet rope to a suitable location on the bed rack or vehicle. Tighten rope to desired tension. **See Photo 4.**

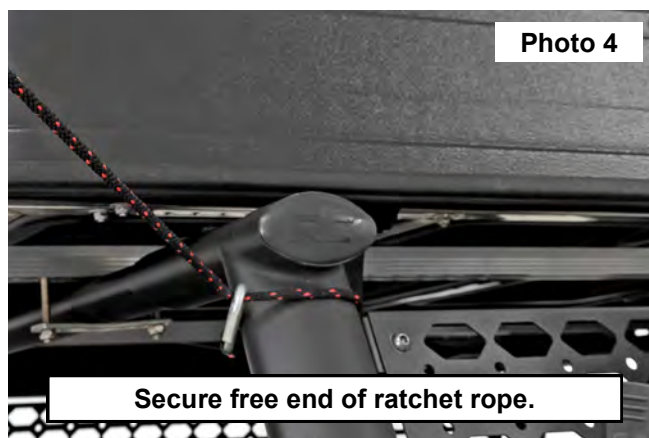

5. Release the Velcro loop holding the support pole up. **See Photo 5.**
6. Let the pole swing down. Twist the bottom pole counterclockwise to loosen the pole in order to set the height. Once desired height is reached, twist pole clockwise to tighten.
7. Feed guy lines through the loops. Secure guy lines to the included stakes and set the stakes in the ground. **See Photo 6.**

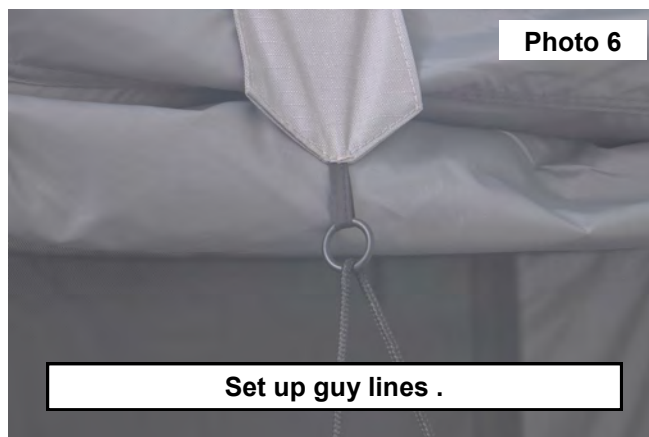
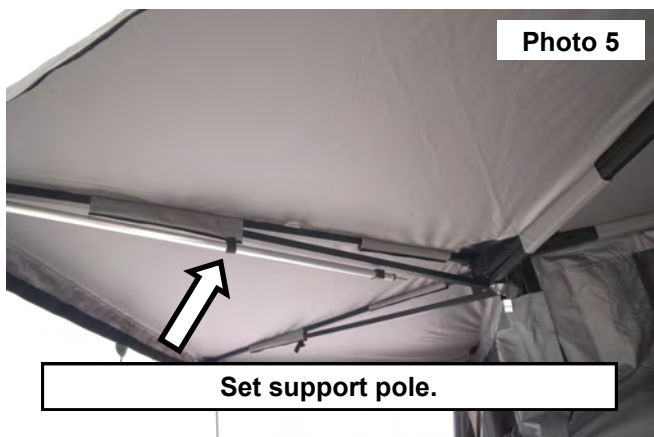

By purchasing any item sold by Rough Country, LLC, the buyer expressly warrants that he/she is in compliance with all applicable, State, and Local laws and regulations regarding the purchase, ownership, and use of the item. It shall be the buyers responsibility to comply with all Federal, State and Local laws governing the sales of any items listed, illustrated or sold. The buyer expressly agrees to indemnify and hold harmless Rough Country, LLC for all claims resulting directly or indirectly from the purchase, ownership, or use of the items.

