

**SHOP BY VEHICLE**

0

# INSTALL INSTRUCTIONS FOR 75-5074

**PRINT**

## BEFORE YOU START

This intake kit may not fit with the following Aftermarket Parts installed:

Body Lift or Lowering Kit

Custom Hood

Throttle Body Upgrade

- Please read the entire product guide before proceeding.
- Ensure all parts are present.
- If you are missing any of the components, call our customer support at (909) 947-0015.
- Do not work on your vehicle while the engine is hot.
- Make sure the engine is turned off and the vehicle is in Park or the Parking Brake is set.

## REQUIRED TOOLS

- 8mm, 10mm, 13mm Wrench & Socket
- Pin Removal Tool or Flat Blade Screwdriver
- 7/16" Wrench and Socket
- 5/16" Nut Driver or Flat Blade Screwdriver
- Phillips Screwdriver
- 1 Set of Torx Wrenches & Allen Wrenches
- 1 Pair of Pliers or similar tool



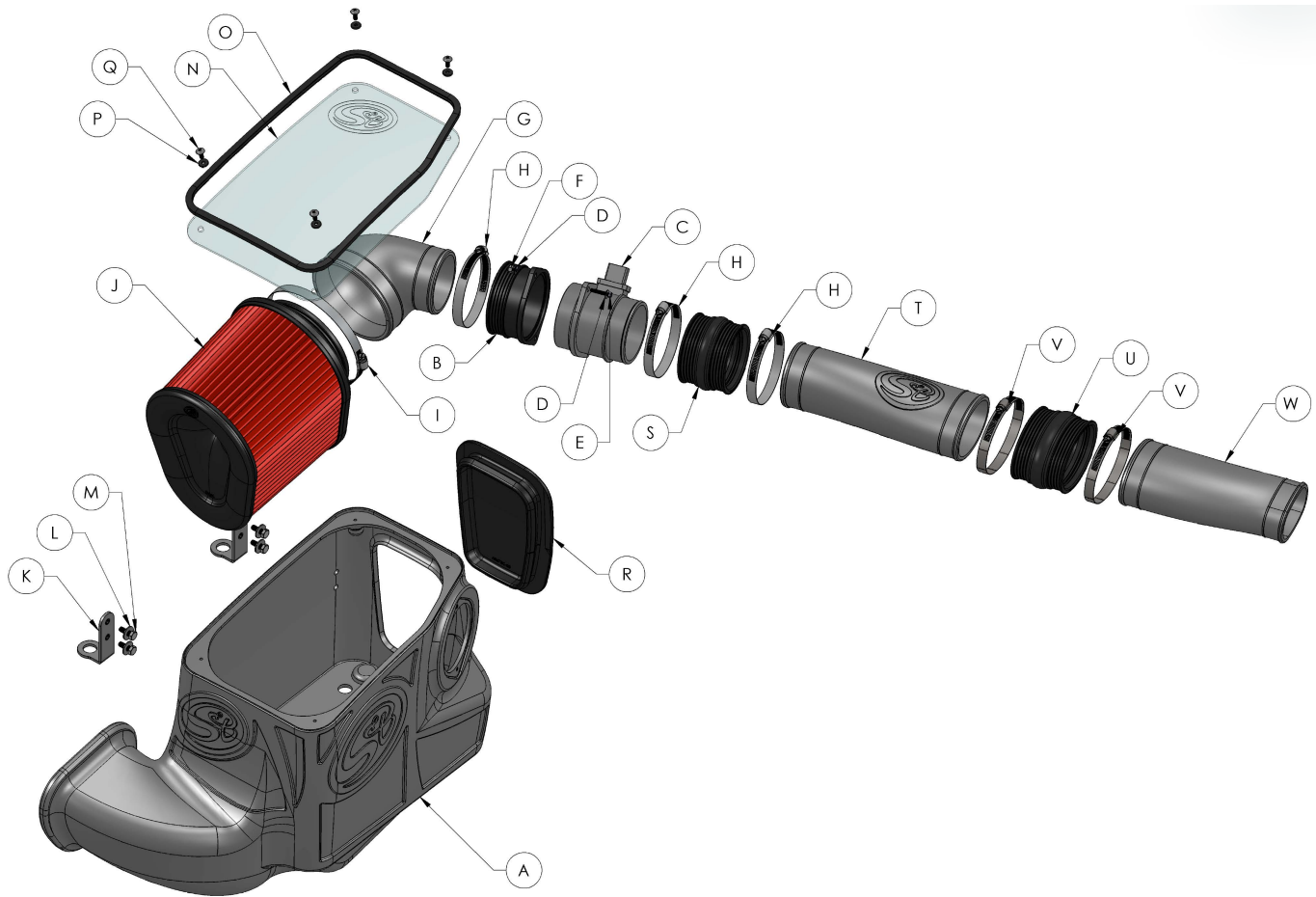

ITEM	QTY.	DESCRIPTION	P/N
A	1	Intake Box	AL1228B-00
B	1	MAF Adapter	AI1672C-00
C	1	Factory MAF	
D	4	3/16" Washer	AI1698-00
E	2	8-32 Screw	AI1697-00
F	2	Locknut 8-32	AI1699-00
G	1	Filter Adapter	AL1228A-00
H	3	Hose Clamp #52	AG1007-00
I	1	Hose Clamp #88	AG1011-00
J	1	S&B Air Filter	KF-1061
K	2	Mounting Bracket, Air Box	AI1677-00
L	4	Washer 1/4"	AI1073-00
M	4	Screw 1/4-20	AI1068-00
N	1	Box Lid	AI1675-00

ITEM	QTY.	DESCRIPTION	P/N
O	1	Lid Seal	AI1636-04
P	4	Washer#10	AI1540-00
Q	4	Screw 10-24	AI1539-00
R	1	Box Plug	AI1673C-00
S	1	Hump Coupler 3" x 2.5"	AI1601C-00
T	1	Long Tube	AL1228L-00
U	1	Hump Coupler 3.5" x 2.75"	AI1321C-00
V	2	Hose Clamp #60	AG1008-00
W	1	Short Tube	AL1228S-00

## STEP 1

With the ignition switched off and the parking brake set, disconnect the negative battery cable on the passenger side.

**IMPORTANT:** Failure to disconnect the battery for a minimum of 2 hours may cause the Check Engine Light to illuminate upon completion of the installation or subsequent operation. **DO NOT SKIP THIS STEP!**

## STEP 2

Remove the factory engine cover by pulling up and out.



## STEP 3

Disconnect the MAF sensor harness by pulling out the red latch and pushing down on the release button and pulling out.



## STEP 4

Use a 5/16" nut driver to loosen the hose clamp on the MAF.





## STEP 5

Pull the tube off the MAF and pull away.



## STEP 6

Use a 5/16" nut driver to loosen the hose clamp on the turbo inlet.



## STEP 7

Remove the complete tube assembly from the vehicle.



## STEP 8

Remove the lid by first removing the latches on the side of the factory airbox.



## STEP 9

Remove the airbox lid by lifting up and out.



## STEP 10

Remove the stock air filter.



## STEP 11

Remove the harness that is attached to the side of the stock airbox.





## STEP 12

Remove the stock airbox by pulling up and out.



## STEP 13

Remove the two factory grommets on the bottom of the factory airbox.



### STEP 13 (IMAGE 2)



### STEP 14

Install both grommets on the bottom of the S&B airbox.



### STEP 15

Remove the grommets from the factory airbox side tabs.



## STEP 16

Push both grommets into part (K) Mounting Brackets. Put brackets to the side which will be used later in the install.

**Note:** Placement of the grommet in the bracket is with the large end facing downward.



## STEP 17

Remove the factory MAF from the factory lid using a T-30 Torx.



## STEP 18



Also, remove the rubber O-ring from the factory MAF.



## STEP 19

Install the MAF Adapter (B) into the S&B airbox (A). Make sure it is aligned properly.

## STEP 20

Install the factory MAF into the MAF Adapter in the S&B airbox. This is designed to be a tight fit and may take some effort, carefully align the MAF Sensor to the Adapter.



## STEP 21

Make sure the MAF is aligned properly and that the flanges meet together.



## STEP 22

Use the provided hardware (D, E, F) to mount the factory MAF onto the S&B airbox.

## STEP 23

Assemble the S&B tube by connecting both the S&B Short Tube (W) and Long Tube (T) using the Hump Coupler (U) and the provided Hose Clamps (V). Also, install Coupler (S) on the end with Hose Clamps (H).

## STEP 24

Install the Filter Adapter (G) onto the S&B Air Filter (J). Use a screwdriver to lineup the S&B logo on the filter straight with the (-) on the part number of the Adapter.

## STEP 25

Once aligned tighten down the down clamp.

## STEP 26

Install the Hose Clamp (H) onto the MAF Adapter (B).

## **STEP 27**

Install both Mounting Brackets (K) with grommets inside the vehicle on the plastic post.

## **STEP 28**

Install the S&B airbox, make sure the bottom grommets align with the factory plastic post underneath.

## **STEP 29**

Use the provided hardware (**L** & **M**) to attach the S&B airbox to the brackets.



## STEP 30

Reconnect the factory harness to the MAF.

## STEP 31

Install the S&B tube assembly and connect to the factory turbo inlet and tighten the hose clamp.

**[HTTPS://WWW.SBFILTERS.COM/75-5074INSTALL#:~:TEXT=THE%20HOSE%20CLAMP.-,STEP%2032,-SLIDE%20THE%20COUPLER](https://www.sbfilters.com/75-5074install#:~:text=the%20hose%20clamp,-,step%2032,-slide%20the%20coupler)**

Slide the coupler towards the S&B airbox over the MAF. Tighten down the hose clamp and make sure the tube is aligned properly.

## STEP 33

Install the provided Lid Seal (O) onto the S&B Lid (N).

## STEP 34

Install the S&B Filter with Adapter and tighten down Hose Clamp (H) on the MAF Adapter.

**Note:** Make sure the Filter Adapter is fully inserted into the MAF Adapter, also make sure the top of the filter is just under the top of the airbox.

## STEP 35

Install the Lid (N) onto the S&B airbox using the provided hardware (P & Q) and the install is complete. Please make sure all hose clamps and hardware are tightened.

## STEP 36

**Note:** The optional Box Plug (R) may be removed to provided maximum airflow when ambient engine heat is not a factor.



## WIN A FREE TOOL TRAY

---

Sign-up below to receive the latest on product launches, insider tips and more. You'll also be entered into a tool tray giveaway where we choose a new winner every week.

*Email Address*

**Sign Up**

