



4100 – 2019-PRESENT, MERCEDES SPRINTER VS30, FLOATING LIGHT MOUNT

Version 1.1

General Notes

- For the most up to date and current instructions, please visit our website at www.vancompass.com
- Please read all instructions thoroughly before starting installing Van Compass products.
- This is a bolt on light mount that can be installed with simple hand tools.
- These instructions document installation of this light mount on a 2019 2WD VS30 144" WB van and Baja Designs LP9 lights
- This light mount is rated to hold lights which weigh no more than 7 lbs / unit.
- This light mount can be completely removed and the vehicle can easily be returned back to stock with no signs of modification.
- **NOTE: This light mount is NOT compatible on vans equipped with the HD factory rear A/C. The HD secondary A/C condenser and associated electric fans inhibit fitment on the vehicle.**
- **WIRING NOTES:** If installing Baja Design LP9 lights with the running light feature, we typically tie the running light into the low beam headlight on the left side of the vehicle. The yellow wire with the black stripe is the wire to splice into.

Parts List

4100 – 2019-PRESENT, MERCEDES SPRINTER VS30, FLOATING LIGHT MOUNT

- | | |
|------------------|--|
| • (1) 410001 | MERCEDES SPRINTER VS30, FLOATING LIGHT MOUNT |
| • (1) WF-M08 | M8 FLAT WASHER, THICK |
| • (2) HSM5-04-10 | HEX HEAD SHEET METAL SCREW, ¼ X 1.0" LONG |
| • (2) WFS-02 | ¼" FLAT WASHER |
| • (2) 410002 | MERCEDES SPRINTER VS30, FLOATING LIGHT MOUNT PRELOAD WEDGE |

Tools Needed

- Simple hand tools:
 - Basic wrench and socket set:
 - 13mm, 3/8", T25, T-30 Torx bit
- Automotive trim removal tool
- Long flat blade screwdriver

Approximate Installation Time

- 1-2 hours (Does not include time to wire the lights as this will vary depending on light mfg and personal preference)

Installation

- 1) Begin by opening the hood and locating the three torx head screws securing the grille to the core support. Use a T-25 Torx head socket and remove these three screws. See image below for reference.



- 2) With the upper part of the grille separated, gently pull the top of the grille back and locate the six tabs which secure the bottom of the grille to the van. The image below denotes the approximate location of the tabs.

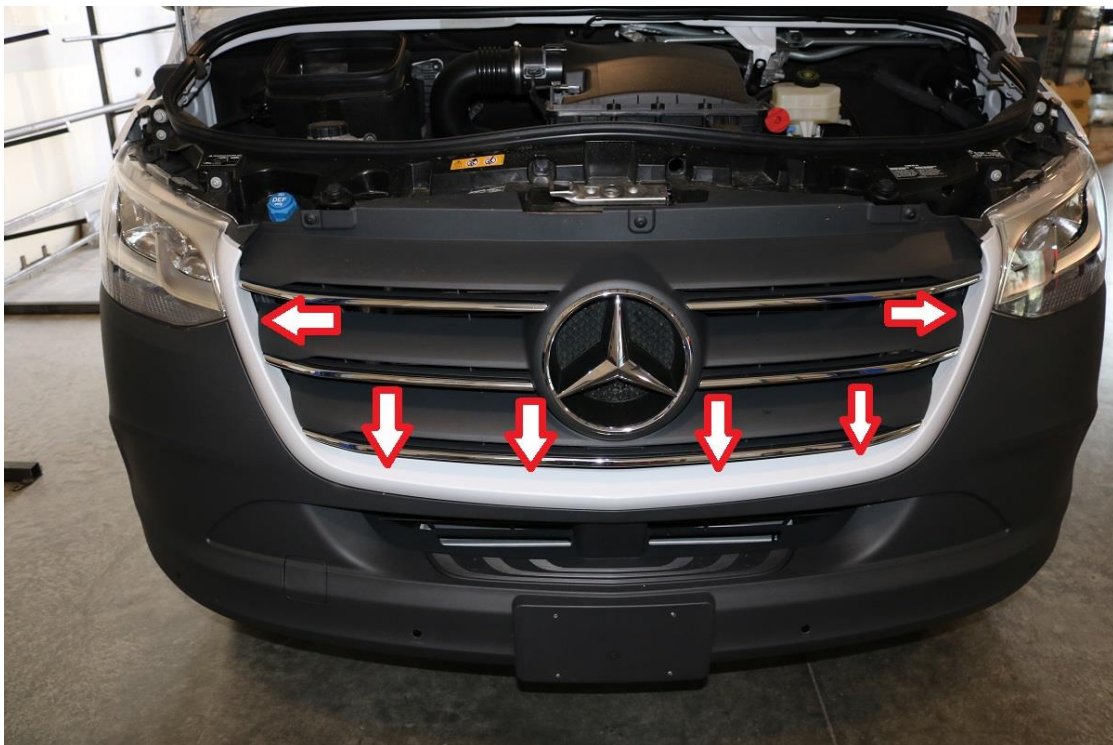

- 3) Once these tabs are located, push down on them and gently pull the bottom of the grille away from the van and it should come free from the vehicle. We have found a long flat nose screwdriver to work well as a tool to push down on the tabs.

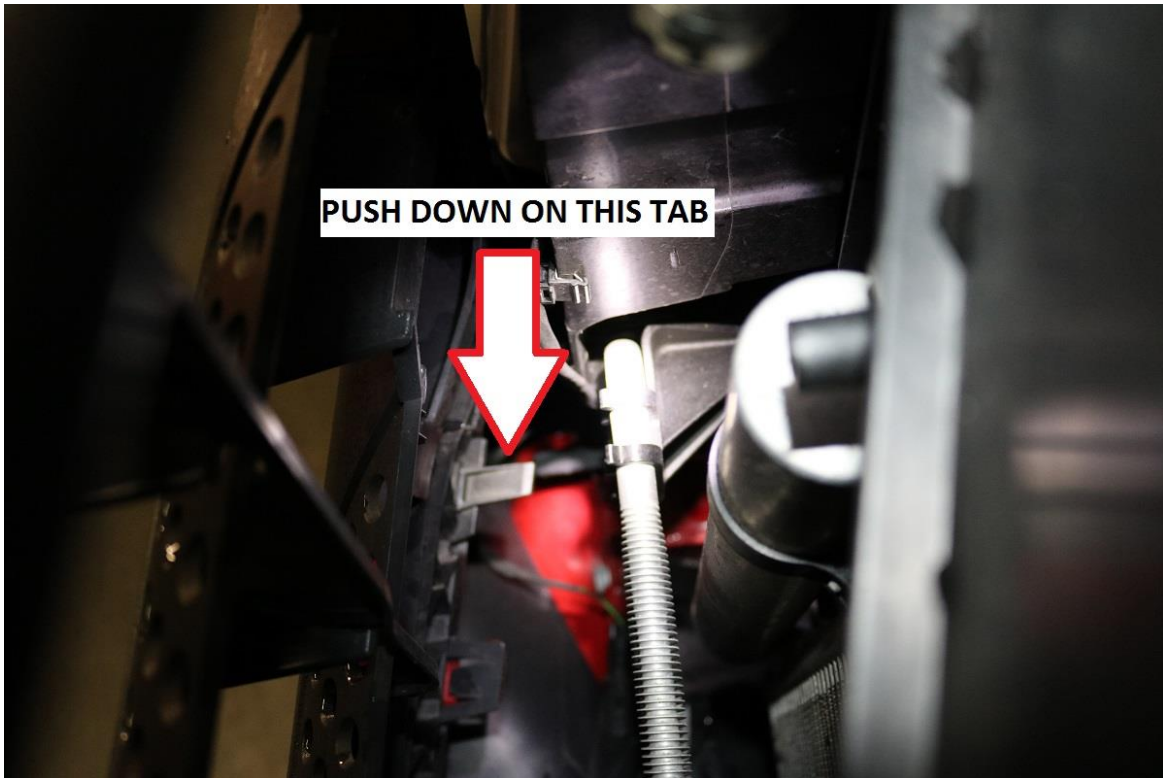

- 4) Set the grille aside once removed from the vehicle.
5) Next, locate and remove the four torx head bolts denoted in the image below using a T-30 torx bit for the red arrows and a T-25 torx bit for the yellow arrows.



- 6) On the driver side (left side of the vehicle), locate the horn and bolt securing the horn bracket to the vehicle.
 - a. On 2019-2022 models, use a 13mm socket to loosen the bolt and rotate it down slightly so it is below the mounting surface of the torx head bolt that will secure the floating light mount to the van.
 - b. On 2023+ AWD models, a small plastic tab prevents the horn from being rotated down. So use a 13mm socket and fully remove the bolt. Be careful not to drop it during removal.

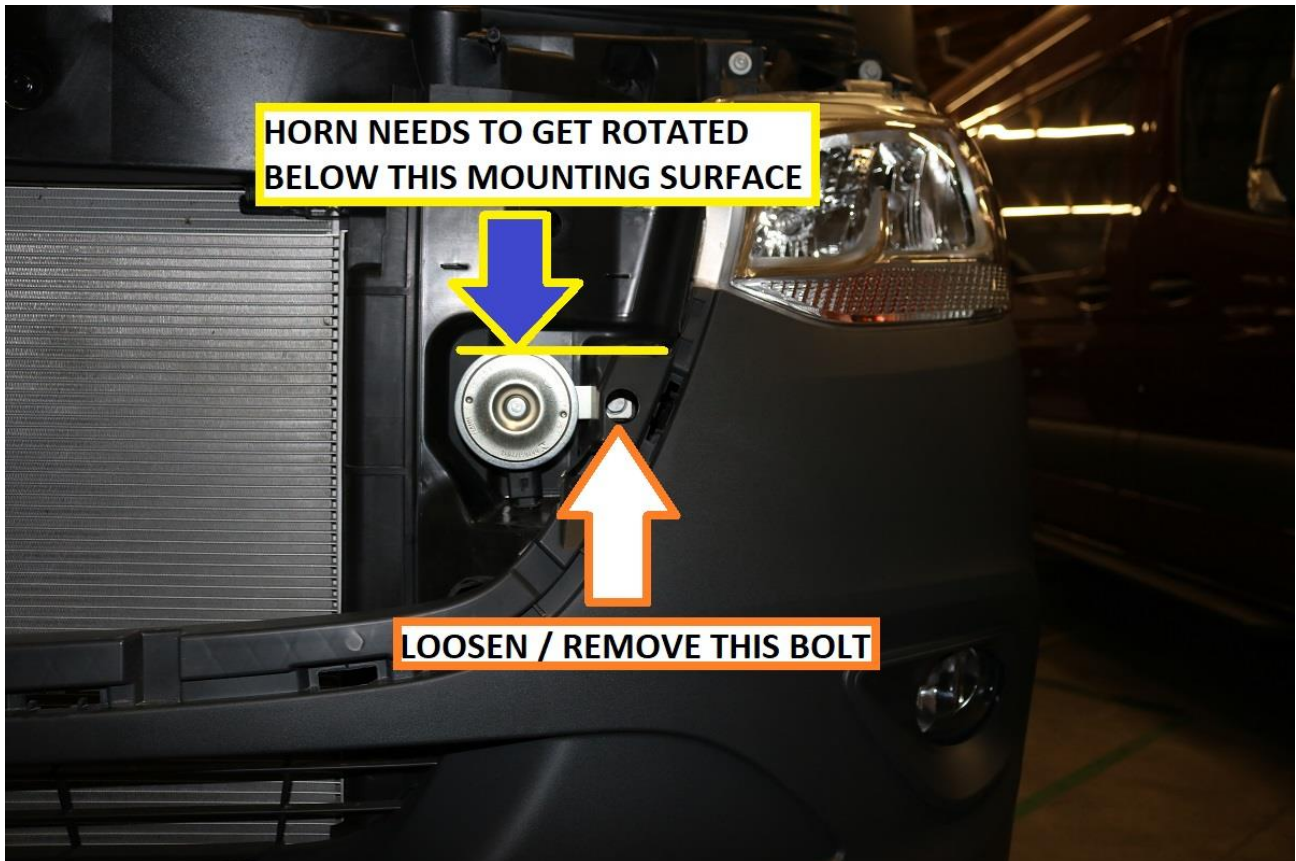

- 7) With the bolt removed, fit the included M8 thick washer under the horn bracket as shown and re-install the assembly.
 - a. Note, pull the front bumper fascia back to re-install horn with washer & bolt.



- 8) Use a 13mm socket & extension to snug the horn bracket mounting bolt. Rotate the horn down as far as it will go to ensure it is below the mounting surface described in Step 6.
 - a. Note, the wiring pigtail on the horn will sometimes prevent the horn itself from rotating down enough. If this is the case, use a 10mm wrench to loosen the nut securing the horn to the mounting bracket and rotate it so the wiring pigtail is no longer preventing the horn from being rotated clear.

- 9) Install the 410001 Floating Light Mount as shown below. Secure the light mount to the chassis with the same upper bolts removed in step 6 (T-25). For the outer bolts, do not re-install the OEM T-30 torx screws. Instead, use the new hex head sheet metal screws included. Use a washer under each bolt head.
- a. Snug all bolts securely without over tightening.



- 10) At this point, refer to the light manufacturer's installation instructions and run the wiring for lights.
- 11) Carefully re-install the grille in the reverse order of removal. Ensure there is enough slack in the light wiring to reach the lights before fully re-installing the grille.
- a. Reference steps 3 thru 1 in the instructions. The light tabs will protrude through the bottom slots of the grill.
- 12) Once the grill is back in place and fully installed, slide the included 410002 pre-load wedge onto the light tab as shown below. Slide forward enough to clear the mounting holes for the light.
- a. Make sure the forward hooks of the wedge grab the light tab.



13) At this point, install the lights and connect wiring. Once the lights are installed. Pull the preload wedge back to the point of contact with the nuts securing the lights to the mount. See image below for reference.

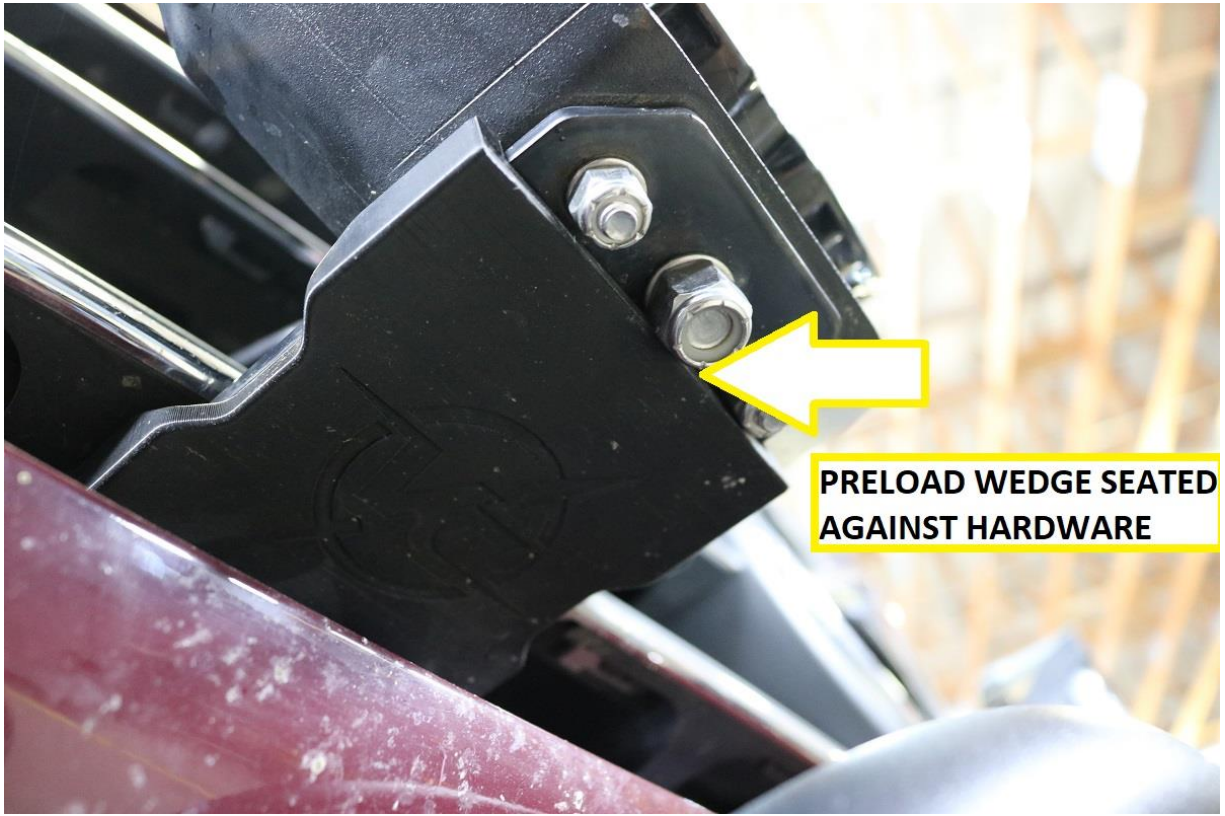

Installation is Complete

RELEASE OF LIABILITY

I, the customer, do hereby release and forever discharge Van Compass LLC, their agents, employees, successors and assigns, and their respective heirs, personal representatives, affiliates, successors and assigns, and any and all persons, firms or corporations liable or who might be claimed to be liable, whether or not herein named, from any and all claims, demands, damages, actions, causes of action or suits of any kind or nature whatsoever, whether known or unknown, fixed or contingent, which I now have or may hereafter have or claim to have, as a result of or in any way relating to the following: Parts sold & installed by Van Compass LLC or parts sold & installed by end-user; any parts sold online, any parts sold online or installed by a re-seller, any parts installed by an installation shop.

It is understood and agreed that this payment is made and received in full and complete settlement and satisfaction of the aforesaid actions, causes of action, claims and demands; that this Release contains the entire agreement between the parties; and that the terms of this Agreement are contractual and not merely a recital. Furthermore, this Release shall be binding upon the undersigned, and his respective heirs, executors, administrators, personal representatives, successors and assigns. This Release shall be subject to and governed by the laws of the State of Idaho.

PRODUCT SAFETY WARNING:

Van Compass LLC strongly recommends the installation of products be done by a certified mechanic. If this does not occur, be certain the person(s) installing the product read, understand and follow all instructions and warnings pertaining to the application before installation. Do not add, alter, or fabricate any factory or aftermarket parts to increase vehicle height over the intended height of the Van Compass LLC product purchased. Mixing component brands is not recommended.

Installation of suspension lift kits or any other lifting kits or devices will raise the center of gravity. For this reason, Van Compass LLC urges that extreme caution be used when encountering driving conditions which may cause vehicle imbalance. Furthermore, the driver's field of vision and judgment will not be as good due to the height of the vehicle. Due to the installation of larger tires, the speedometer will read slower than the actual speed being traveled and more distance will be required to stop the vehicle. It is the owner's responsibility to caution and warn any potential driver of the vehicle about these driving and handling conditions. Van Compass LLC will not be held liable or responsible for damages or personal injuries resulting from the use of lifting devices and or related products. The tires and rims should be changed to sufficiently increase the vehicle's total overall width and stability to help accommodate lifting devices.

Van Compass LLC aftermarket suspension products and accessories modify a vehicle for uses which exceed conditions anticipated by the vehicle manufacturer. The uses include the high performance demands required during off-road. These conditions vary in the degree of extremity and cannot be controlled by the vehicle or product manufacturer. If the components within the suspension system or accessories become worn due to frequent and/or extreme use, the safety and reliability of the vehicle is at risk. The maintenance of aftermarket equipment to ensure the vehicle occupants safety is entirely your responsibility. Do not purchase Van Compass LLC products unless you are willing to accept this responsibility. Do not install any Van Compass LLC suspension products or accessories unless you feel competent at installing the product without causing present or future injury to yourself or other vehicle occupants; seek an authorized installation center.

Most states have some type of law limiting vehicle height. The amount of lift allowed, and how the lift can be achieved, varies greatly. Several states offer exemptions for farm and commercial registered vehicles. It is the vehicle owner's responsibility to check state and local laws to ensure that their vehicle will be in compliance. Van Compass LLC reserves the right to make changes in design, materials and specifications as deemed necessary without prior notice and without assuming obligation to modify any product previously manufactured. Obligation or liabilities will not be assumed with respect to similar products previously advertised.

This Release of Liability and Product Safety Warning has been read and fully understood by the undersigned and has been explained to me.