

Jeep JT Cargo Rack MOLLE Panel

Thank you for choosing Rough Country for all your vehicle needs.

Please read instructions before beginning installation. Check the kit hardware against the kit contents shown below. Be sure you have all needed parts and know where they go.

If question exist, please call us @1-800-222-7023. We will be happy to answer any questions concerning this product. Check all fasteners for proper torque. Check to ensure for adequate clearance between all components. Periodically check all hardware for tightness.

KIT CONTENTS:

- Cargo Rack MOLLE Half Panel x2
- Bracket x8
- 10656BAG1

- 8mm Hammer Nut x8
- 8mm x 20mm Button Head Bolt x16
- 8mm Lock Nut x 8
- 8mm Flat Washer x16

TOOLS NEEDED:

- 5mm Allen Wrench or Socket
- 13mm Wrench or Socket
- Level

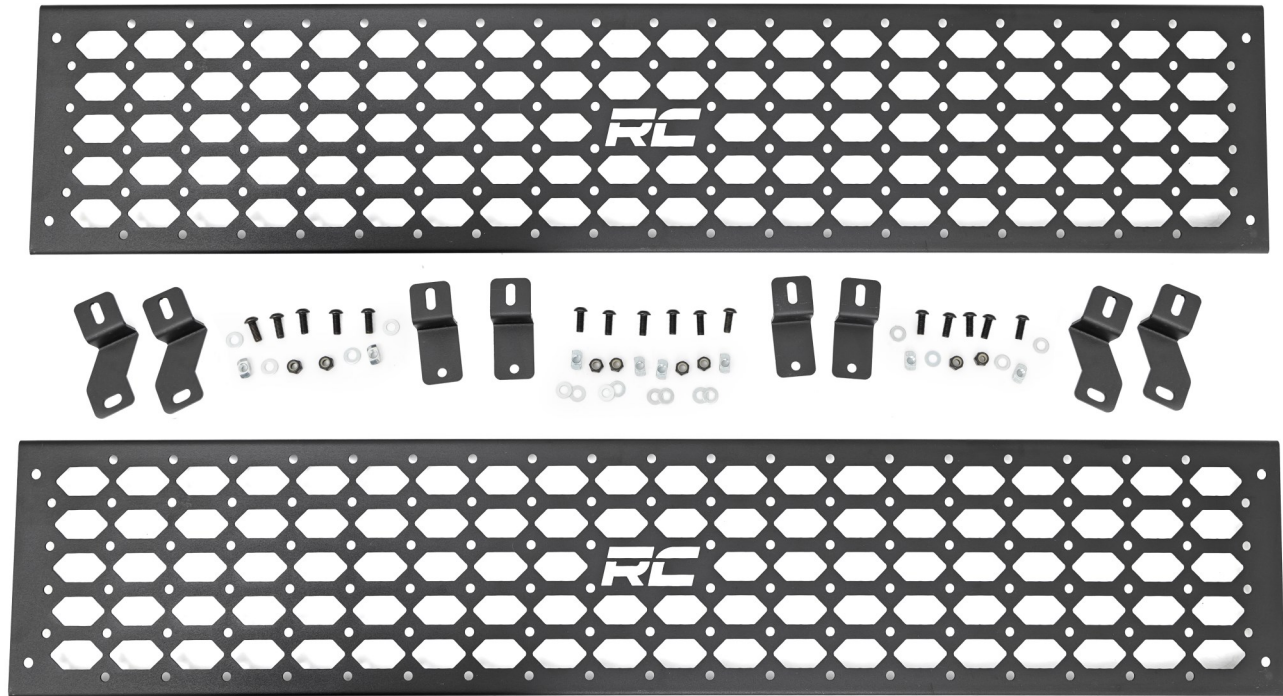

Torque Specs:

Size	Grade 5	Grade 8	Size	Class 8.8	Class 10.9
5/16"	15 ft/lbs	20ft/lbs	6MM	5ft/lbs	9ft/lbs
3/8"	30 ft/lbs	35ft/lbs	8MM	18ft/lbs	23ft/lbs
7/16"	45 ft/lbs	60ft/lbs	10MM	32ft/lbs	45ft/lbs
1/2"	65 ft/lbs	90ft/lbs	12MM	55ft/lbs	75ft/lbs
9/16"	95 ft/lbs	130ft/lbs	14MM	85ft/lbs	120ft/lbs
5/8"	135ft/lbs	175ft/lbs	16MM	130ft/lbs	165ft/lbs
3/4"	185ft/lbs	280ft/lbs	18MM	170ft/lbs	240ft/lbs



INSTALLATION INSTRUCTIONS

1. Assemble bracket with supplied 8mm x 20mm bolt, hammer nut, and washer. **See Photo 1.**
2. Install bracket into the vertical rack post and loosely tighten with 5mm Allen wrench. **See Photo 2.**
3. Repeat steps 1 and 2 for remaining three (3) straight brackets.

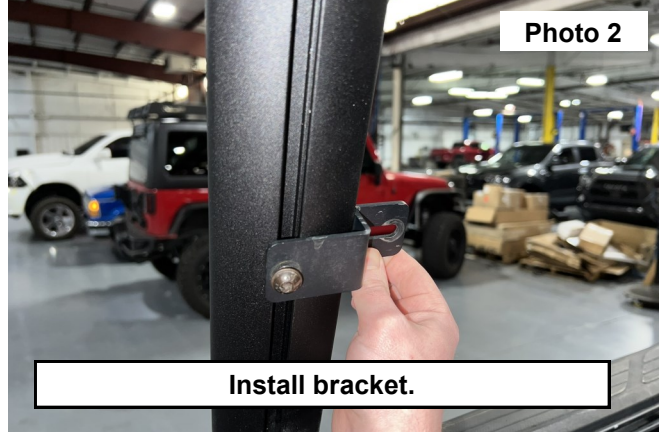
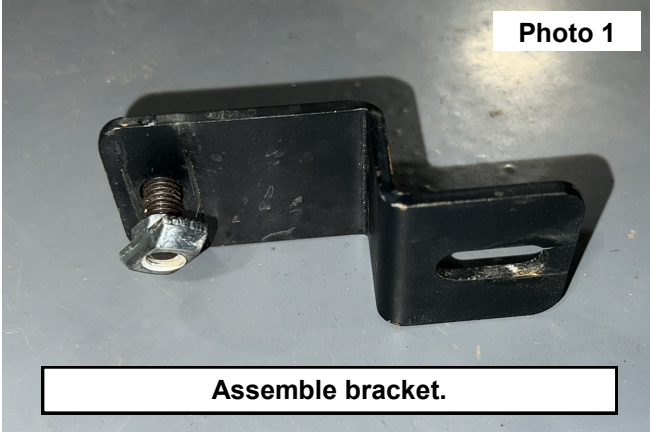

4. Using supplied 8mm flange nuts, washers, and 8mm x 20mm bolts, loosely fasten MOLLE panel to the four (4) corresponding brackets. Tighten with 5mm Allen wrench and 13mm wrench. **See Photo 3.**
5. Repeat Step 4 for other MOLLE panel.
6. Use a level to straighten MOLLE panel as needed. Tighten all fasteners

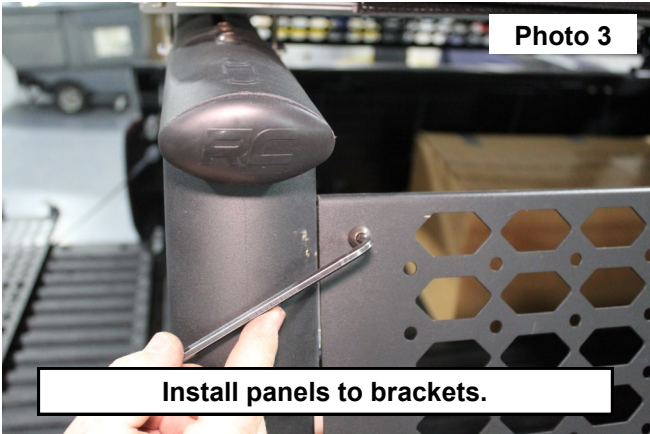

POST INSTALLATION INSTRUCTIONS

1. Check all fasteners for proper torque. Check to ensure for adequate clearance between all rotating, mobile, fixed, and heated members. Verify clearance between exhaust and brake lines, fuel lines, fuel tank, floorboards, and wiring harness.
2. All kit components must be retightened at 500 miles and then every 300 miles after installation. Periodically check all hardware for tightness.

By purchasing any item sold by Rough Country, LLC, the buyer expressly warrants that he/she is in compliance with all applicable, State, and Local laws and regulations regarding the purchase, ownership, and use of the item. It shall be the buyers responsibility to comply with all Federal, State and Local laws governing the sales of any items listed, illustrated or sold. The buyer expressly agrees to indemnify and hold harmless Rough Country, LLC for all claims resulting directly or indirectly from the purchase, ownership, or use of the items.

