



## **3026 – 2013-PRESENT, RAM PROMASTER, REAR 1.5” LIFT KIT**

Version 1.0

### General Notes

- For the most up to date and current instructions, please visit our website at [www.vancompass.com](http://www.vancompass.com)
- Please read all instructions thoroughly before starting installing Van Compass products.
- This is a bolt on lift kit that can be installed with basic hand tools.
- This lift kit is not compatible with the factory rear sway bar
- This suspension kit can be completely removed, allowing the vehicle to be returned back to stock configuration if desired.

### Parts List

#### **3026 – 2013-PRESENT, RAM PROMASTER, REAR LIFT BLOCK, 1.5” LIFT KIT**

- (2) 302601 REAR LIFT BLOCK, 1.5” LIFT
- (4) UBSQ-700-1150 70MM WIDE X 115MM LONG, SQ U-BOLT, M14-1.50
- (8) NNM14-1.50 M14-1.50 NYLOCK NUT
- (8) WFM14 M14 FLAT WASHER, YELLOW ZINC

### Tools Needed

- Quality jacks and 2 jack stands.
  - Optional – Automobile lift and screw jack or transmission jack
- Simple hand tools:
  - Torque Wrench
  - Basic wrench and socket set:
    - Metric sizes: 19mm 12-point, 22mm

### Approximate Installation Time

- Professional shop with automotive lift: 1-2 hours
- Driveway install with jack and jack stands: 2-3 hours

### Installation

- 1) Begin by safely supporting the vehicle so that the rear suspension can hang free. This can be done with an automobile lift or a quality jack and a pair of jack stands.
- 2) With the rear suspension hanging free, remove the rear wheels / tires.
- 3) We recommend installing one side as to prevent the rear axle from rotating during installation.

### 3026 Rear Lift Block Installation

- 4) Remove the rear lower shock bolt. Use a 19mm 12 point socket for removal.



- 5) Remove the upper shock bolt and remove the shock from the vehicle.

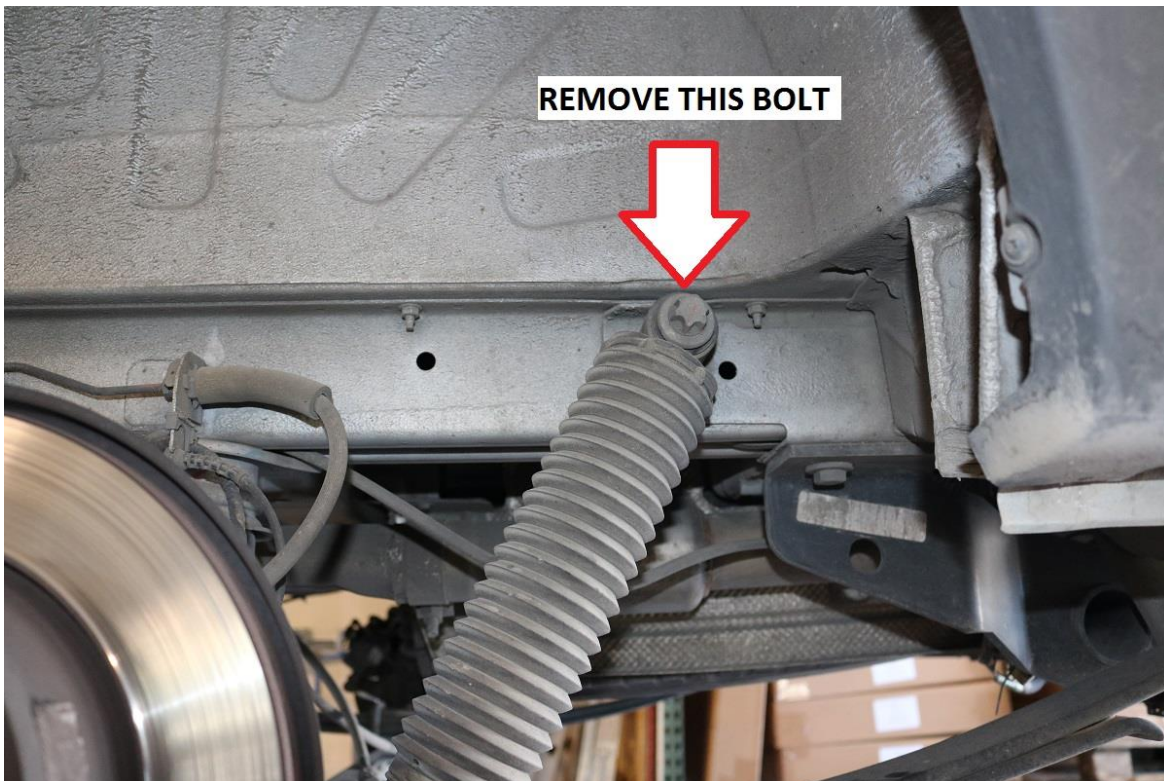

6) Separate the two wires shown in the image below from their respective mounting clips.

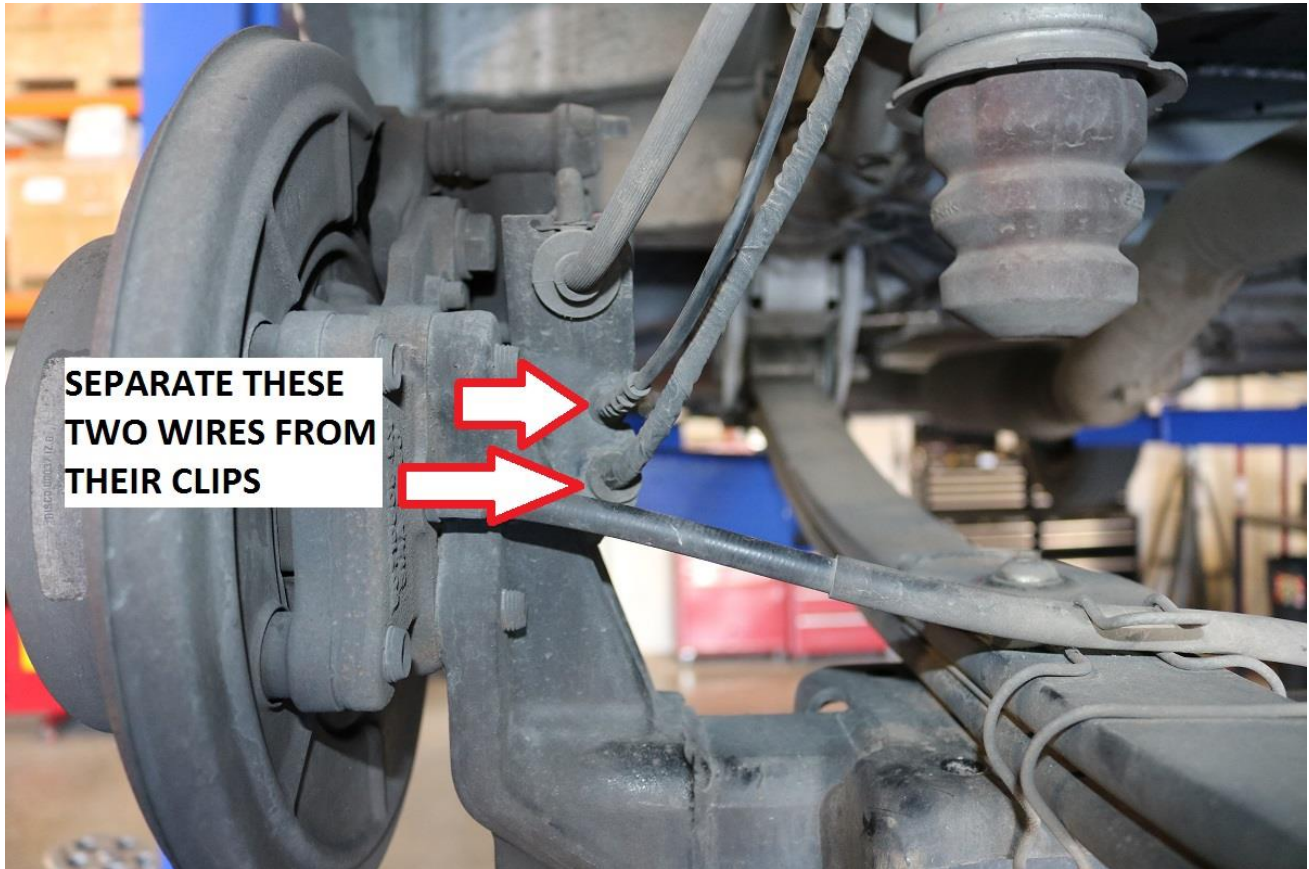

7) Cut the two zip ties securing the E-brake cable to the rear axle as shown below. Also, support the rear axle.

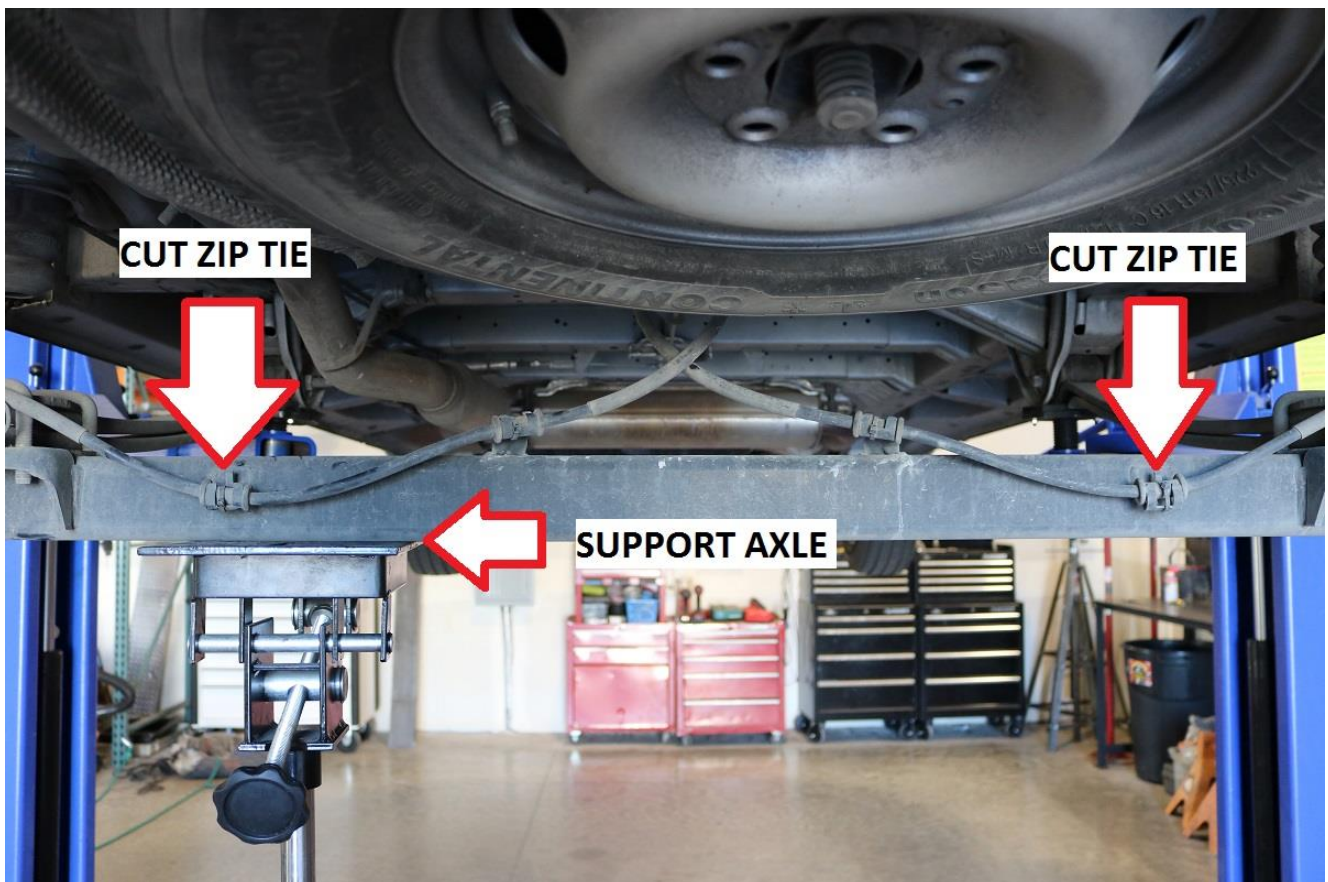

8) Remove the U-bolt nuts. Use a 22mm socket / wrench for removal. See photos below for clarity.

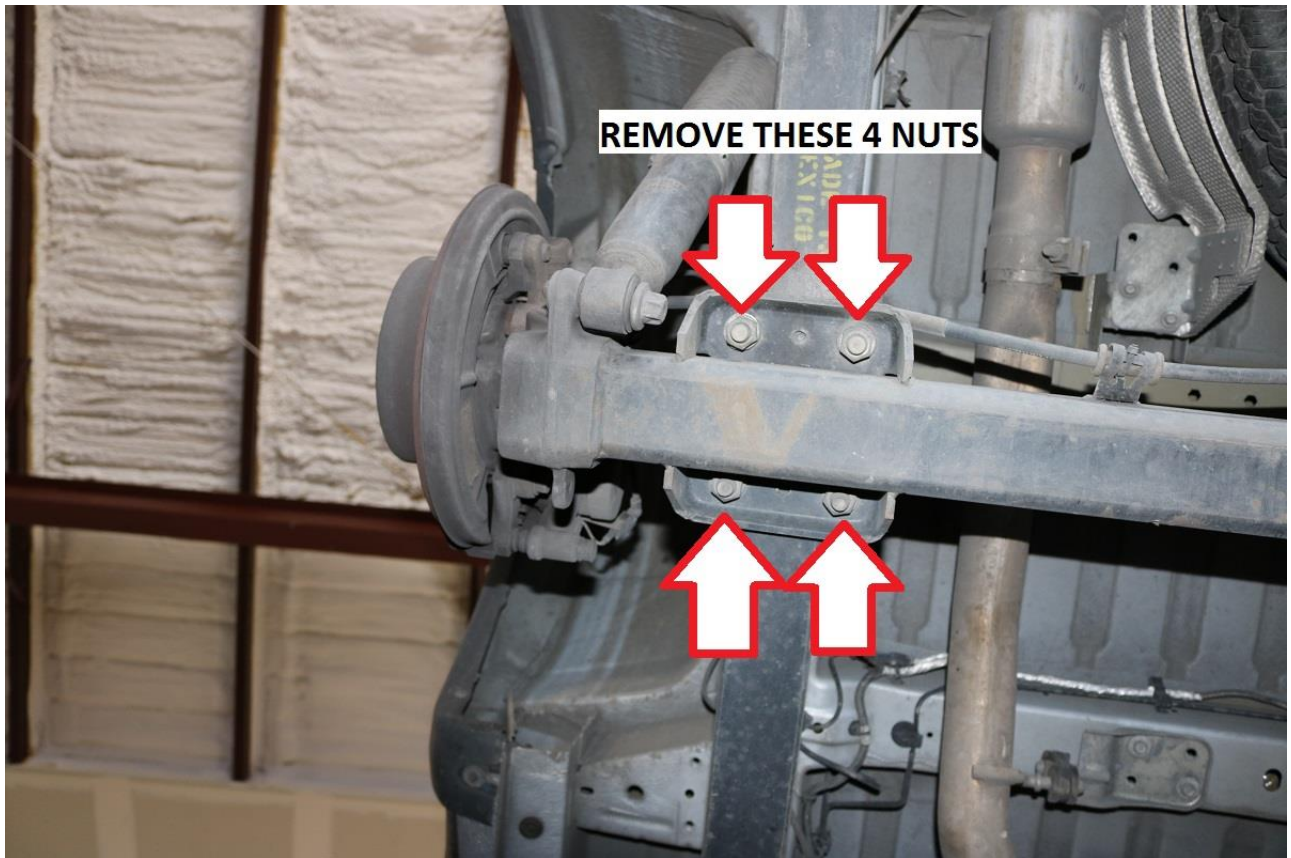

9) Remove the U-bolts and slowly lower the axle approximately 2.0" (60MM) or until the lift block can be placed between the axle and the leaf spring.

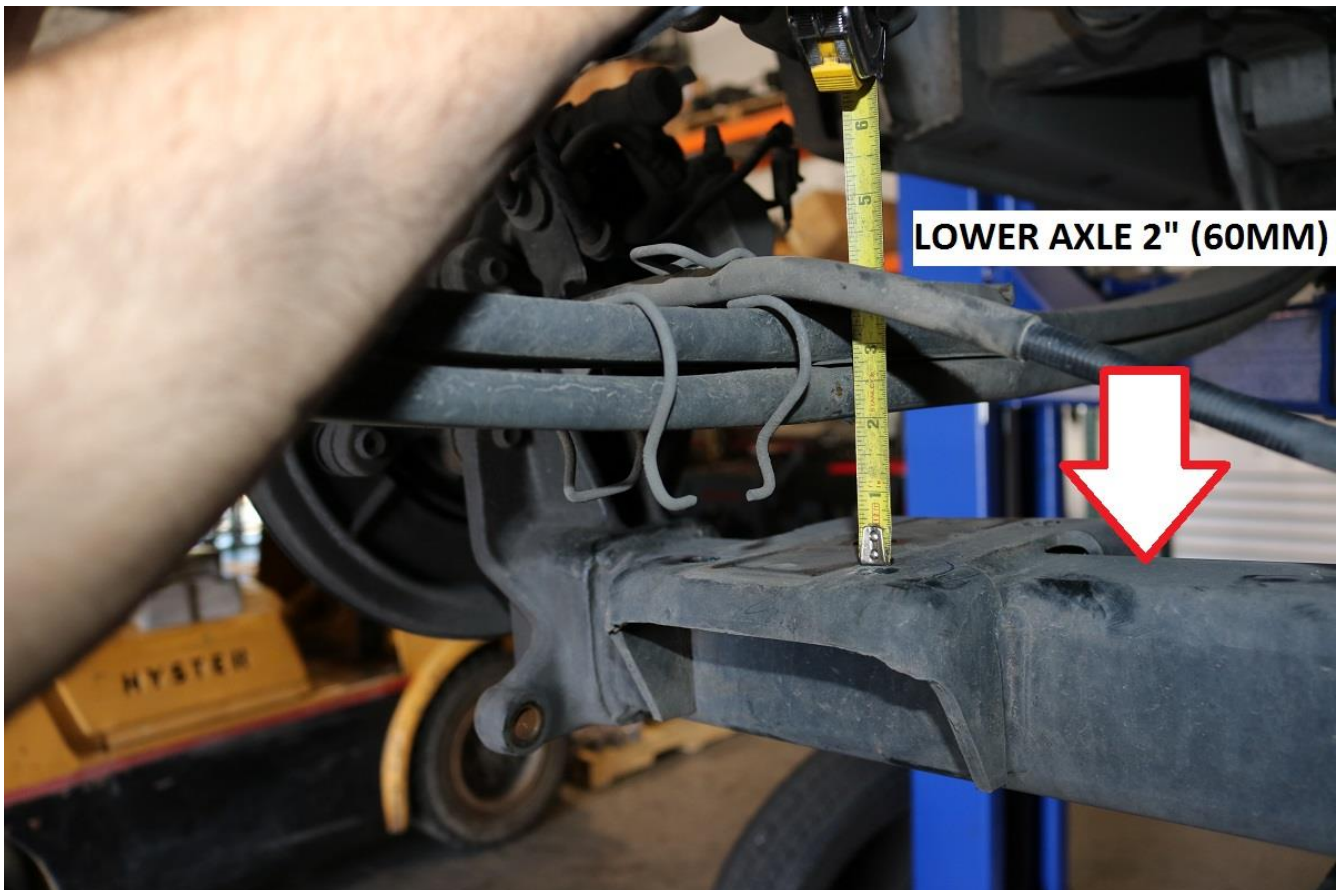

- 10) Install the lift block and new U-bolts included with the kit. Use a new M14-1.50 nylock nut and washer. Snug all bolts and repeat steps 4-9 on the passenger side.
- 11) Once both sides have been re-assembled, use a 22mm socket / wrench and torque U-bolts nuts to 99 ft-lbs (134 N.m).
- 12) Cut the upper zip tie securing the wiring shown near the bump stop. Once this zip tie is cut, re-secure the ABS and WSS wiring into their respective locations previously removed in step 6.



- 13) Re-secure the ABS wiring as shown below with a ziptie.
  - a. Repeat lift block installation on the opposite side of the vehicle.

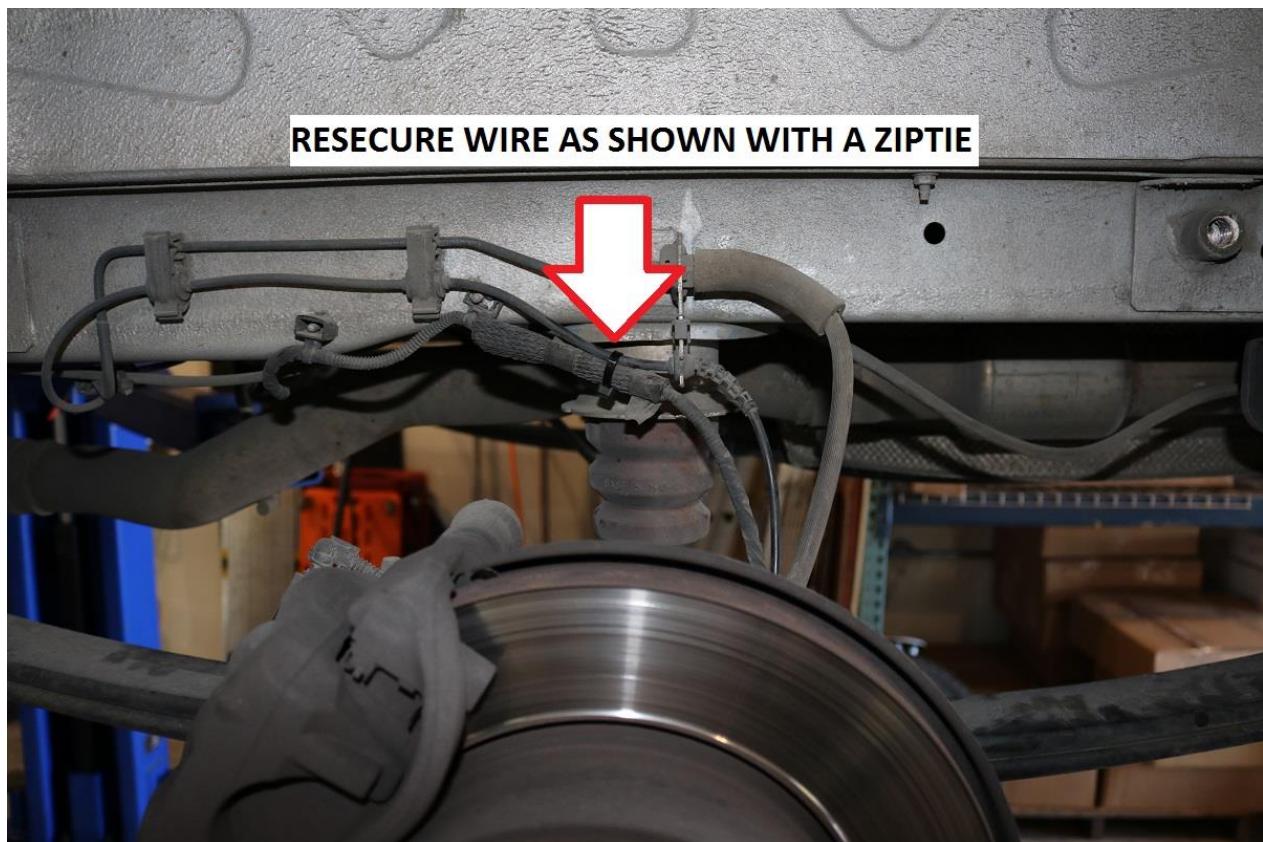

- 14) Re-install the rear shock in the same orientation as removed.
  - a. Install the upper bolt first. Snug the bolt using a 19mm 12 point socket.
  - b. Install the lower shock bolt. Snug the bolt using a 19mm 12 point socket / wrench.
- 15) Torque both upper and lower shock bolts to 80 ft-lbs (108 N.m)
- 16) Re-install wheels / tires and lower van to ground.
  - a. Torque specs for factory wheels / lug nuts are as follows; 146 ft-lbs (198 N.m)
- 17) Double check all torque specs after 100 miles of driving.

Installation is Complete

#### RELEASE OF LIABILITY

I, the customer, do hereby release and forever discharge Van Compass LLC, their agents, employees, successors and assigns, and their respective heirs, personal representatives, affiliates, successors and assigns, and any and all persons, firms or corporations liable or who might be claimed to be liable, whether or not herein named, from any and all claims, demands, damages, actions, causes of action or suits of any kind or nature whatsoever, whether known or unknown, fixed or contingent, which I now have or may hereafter have or claim to have, as a result of or in any way relating to the following: Parts sold & installed by Van Compass LLC or parts sold & installed by end-user; any parts sold online, any parts sold online or installed by a re-seller, any parts installed by an installation shop.

It is understood and agreed that this payment is made and received in full and complete settlement and satisfaction of the aforesaid actions, causes of action, claims and demands; that this Release contains the entire agreement between the parties; and that the terms of this Agreement are contractual and not merely a recital. Furthermore, this Release shall be binding upon the undersigned, and his respective heirs, executors,

administrators, personal representatives, successors and assigns. This Release shall be subject to and governed by the laws of the State of Idaho.

#### PRODUCT SAFETY WARNING:

Van Compass LLC strongly recommends the installation of products be done by a certified mechanic. If this does not occur, be certain the person(s) installing the product read, understand and follow all instructions and warnings pertaining to the application before installation. Do not add, alter, or fabricate any factory or aftermarket parts to increase vehicle height over the intended height of the Van Compass LLC product purchased. Mixing component brands is not recommended.

Installation of suspension lift kits or any other lifting kits or devices will raise the center of gravity. For this reason, Van Compass LLC urges that extreme caution be used when encountering driving conditions which may cause vehicle imbalance. Furthermore, the driver's field of vision and judgment will not be as good due to the height of the vehicle. Due to the installation of larger tires, the speedometer will read slower than the actual speed being traveled and more distance will be required to stop the vehicle. It is the owner's responsibility to caution and warn any potential driver of the vehicle about these driving and handling conditions. Van Compass LLC will not be held liable or responsible for damages or personal injuries resulting from the use of lifting devices and or related products. The tires and rims should be changed to sufficiently increase the vehicle's total overall width and stability to help accommodate lifting devices.

Van Compass LLC aftermarket suspension products and accessories modify a vehicle for uses which exceed conditions anticipated by the vehicle manufacturer. The uses include the high performance demands required during off-road. These conditions vary in the degree of extremity and cannot be controlled by the vehicle or product manufacturer. If the components within the suspension system or accessories become worn due to frequent and/or extreme use, the safety and reliability of the vehicle is at risk. The maintenance of aftermarket equipment to ensure the vehicle occupants safety is entirely your responsibility. Do not purchase Van Compass LLC products unless you are willing to accept this responsibility. Do not install any Van Compass LLC suspension products or accessories unless you feel competent at installing the product without causing present or future injury to yourself or other vehicle occupants; seek an authorized installation center.

Most states have some type of law limiting vehicle height. The amount of lift allowed, and how the lift can be achieved, varies greatly. Several states offer exemptions for farm and commercial registered vehicles. It is the vehicle owner's responsibility to check state and local laws to ensure that their vehicle will be in compliance. Van Compass LLC reserves the right to make changes in design, materials and specifications as deemed necessary without prior notice and without assuming obligation to modify any product previously manufactured. Obligation or liabilities will not be assumed with respect to similar products previously advertised.

This Release of Liability and Product Safety Warning has been read and fully understood by the undersigned and has been explained to me.