

ROUGH COUNTRY

SUSPENSION SYSTEMS®

24 TACOMA CREW CAB OVAL NERF STEP

Thank you for choosing Rough Country for all your vehicle needs.

Please read instructions before beginning installation. Check the kit hardware against the kit contents shown below. Be sure you have all needed parts and know where they go.

If question exist, please call us @1-800-222-7023. We will be happy to answer any questions concerning this product.

Check all fasteners for proper torque. Check to ensure for adequate clearance between all components.

Periodically check all hardware for tightness.

Kit Contents

2 - Oval Steps

1-Dr Fr Mounting Bracket

2-Dr Center / RR Mounting Bracket

1-Pass Fr Mounting Bracket

2-Pass Center/ RR Mounting Bracket

Hardware Included:

12-8mm x 25mm bolts

12-8mm x 30mm Bolts

12-8mm x 24mm Flat Washers

12-8mm Lock Washers

Tools Needed:

13mm Wrench / Socket



Torque Specs:

Size	Grade 5	Grade 8	Size	Class 8.8	Class 10.9
5/16"	15 ft/lbs	20ft/lbs	6MM	5ft/lbs	9ft/lbs
3/8"	30 ft/lbs	35ft/lbs	8MM	18ft/lbs	23ft/lbs
7/16"	45 ft/lbs	60ft/lbs	10MM	32ft/lbs	45ft/lbs
1/2"	65 ft/lbs	90ft/lbs	12MM	55ft/lbs	75ft/lbs
9/16"	95 ft/lbs	130ft/lbs	14MM	85ft/lbs	120ft/lbs
5/8"	135ft/lbs	175ft/lbs	16MM	130ft/lbs	165ft/lbs
3/4"	185ft/lbs	280ft/lbs	18MM	170ft/lbs	240ft/lbs



Bracket Orientation / Location



INSTALLATION INSTRUCTIONS

1. Before beginning installation, locate driver side brackets as shown in illustration above.
2. Install front driver side bracket in the factory location with supplied 8mm x 35mm bolts, nuts, and washers using a 13mm wrench. Do not fully tighten at this time. **See Photo 1.**
3. Install center driver side bracket as shown in **Photo 2** in the factory location with supplied 8mm x 35mm bolts, nuts, and washers using a 13mm wrench. Do not fully tighten at this time.

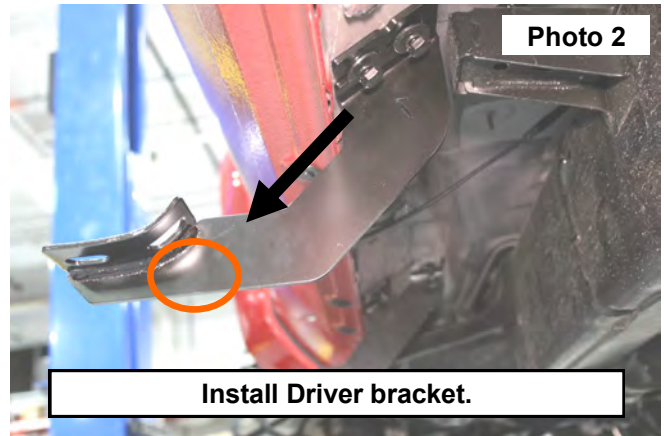
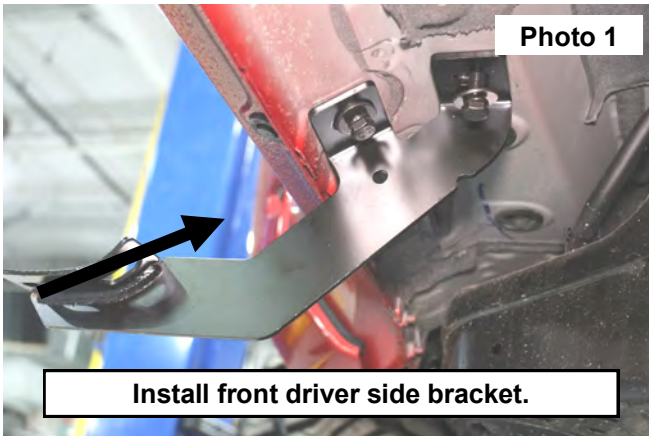

4. Install the rear Driver side brackets into the stock holes with the supplied 8mm x 35mm hardware. **See Photo 3.**
5. Install the oval steps on the brackets and secure to the brackets with the 8mm x 25mm bolts, flat washers and lock washers. Do not tighten until all hardware is installed. **See Photo 4.**
6. After all brackets and hardware has been installed, tighten all hardware using a 13mm wrench.
7. Repeat Steps 2-6 for passenger side.

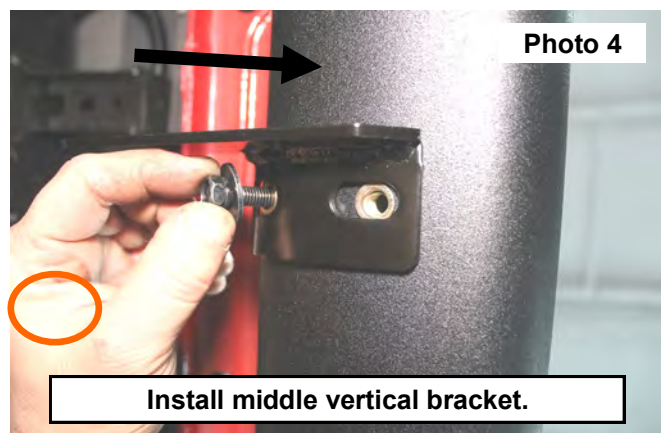
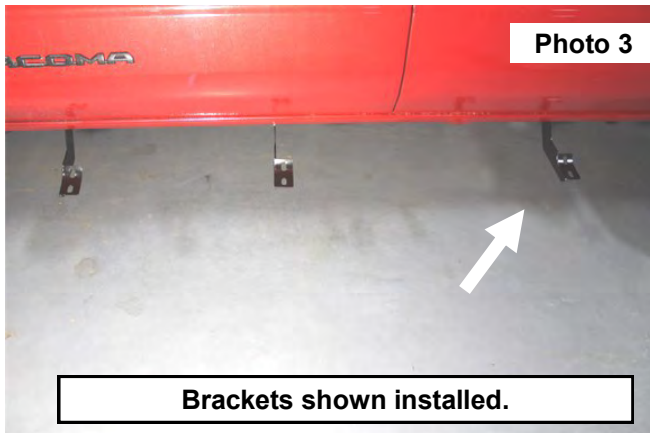

By purchasing any item sold by Rough Country, LLC, the buyer expressly warrants that he/she is in compliance with all applicable, State, and Local laws and regulations regarding the purchase, ownership, and use of the item. It shall be the buyers responsibility to comply with all Federal, State and Local laws governing the sales of any items listed, illustrated or sold. The buyer expressly agrees to indemnify and hold harmless Rough Country, LLC for all claims resulting directly or indirectly from the purchase, ownership, or use of the items.

