

# 2021+ FORD F150 XB LED TAIL LIGHTS INSTALL GUIDE

**WARNING:** By reading this document, you agree it is only to be used as an educational guide. Morimoto Lighting nor its dealers make guarantees on any finished results, nor are they to be held responsible for any damage, misuse, or personal injuries. If you are unable to clearly understand and adapt the information below, professional installation is recommended.

## PACKAGE CONTENTS



2X TAIL LIGHT ASSEMBLIES



2 X TYPE 1 ADAPTERS

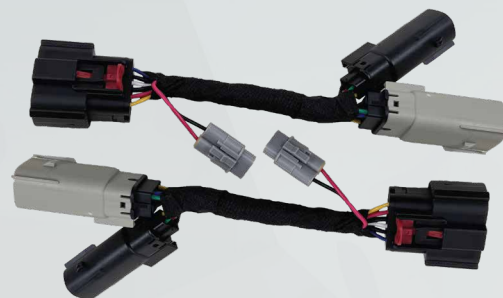

2 X TYPE 2 ADAPTERS

**IMPORTANT:** These tail lights will work properly in unison with headlights from Morimoto but otherwise if your vehicle is equipped with anything but OEM turn signals (full assemblies, LED bulbs, or otherwise) in the headlights or elsewhere: You may experience a hyper flash and/or problem with the turn signal on these tail lights. This is not a defect in the tail light, and is caused by un-matched impedance with your original vehicle settings.

# 2021+ FORD F150



## TABLE OF CONTENTS

OEM TAIL LIGHT IDENTIFIER, TERMINOLOGY . . . . .	PAGE 3
INSTALLATION PROCESS	
2021+ OEM LED, RAPTOR . . . . .	PAGE 4
2021+ INCANDESCENT WITH BLIS . . . . .	PAGE 8
2021+ INCANDESCENT WITHOUT BLIS . . . . .	PAGE 12
BOOST BAR LICENSE PLATE LIGHT (SOLD SEPARATELY) . . . . .	PAGE 14

## REQUIRED TOOLS

- RATCHET
- 8MM SOCKET
- T20 TORX BIT
- FLAT HEAD SCREWDRIVER OR TRIM REMOVAL TOOL
- PHILIPS HEAD SCREWDRIVER

# OEM TAIL LIGHT IDENTIFIER



2021+ OEM LED  
(PAGE 4)



2021+ OEM LED  
RAPTOR  
(PAGE 4)



2021+ INCANDESCENT  
WITH BLIS  
(PAGE 8)



2021+ INCANDESCENT  
WITHOUT BLIS  
(PAGE 12)

## TERMINOLOGY

### BLIS -BLIND SPOT INFORMATION SYSTEM

-IF YOU ARE UNSURE YOUR TRUCK HAS BLIS MODULES IN THE TAIL LIGHTS, SIMPLY CHECK THE SIDE OF THE TAIL LIGHT FOR THIS MARKING . . . . . ▶  
OR REFER TO THE PICTURES ABOVE.





# INSTALLATION PROCESS: 2021+ OEM LED



2021+ OEM LED  
(will require turn signal outage reprogramming  
see Page 7 Step 11)



2021+ OEM LED  
RAPTOR

1. Open your tailgate, remove the two (2) 8mm screws holding in the tail light (IMAGE 1). Pull the tail light out away from the truck to release it (IMAGE 2).

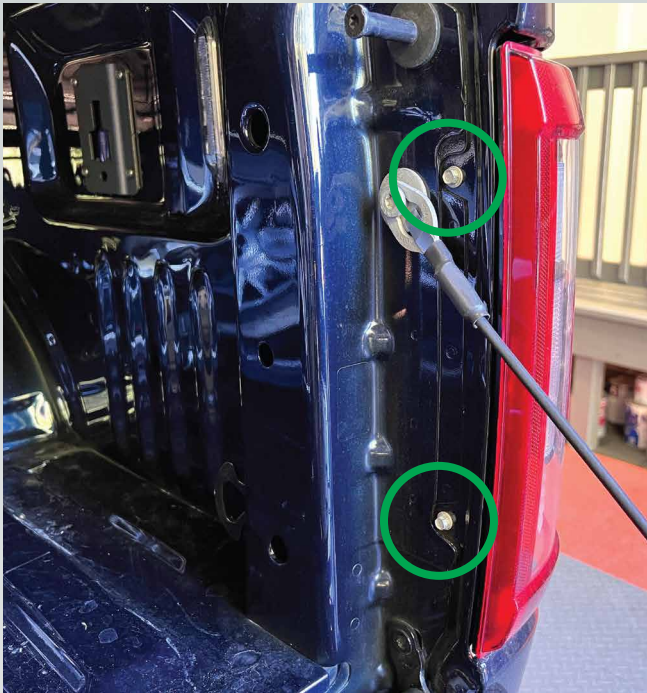

IMAGE 1



IMAGE 2



2. Disconnect the OEM connector (IMAGE 3) by pressing the release tab (#1), then slide the connector off the tail light (#2). Remove the four (4) T20 Torx screws holding the BLIS holder (IMAGE 4) and pull the BLIS holder away from the tail light housing to expose the BLIS module.

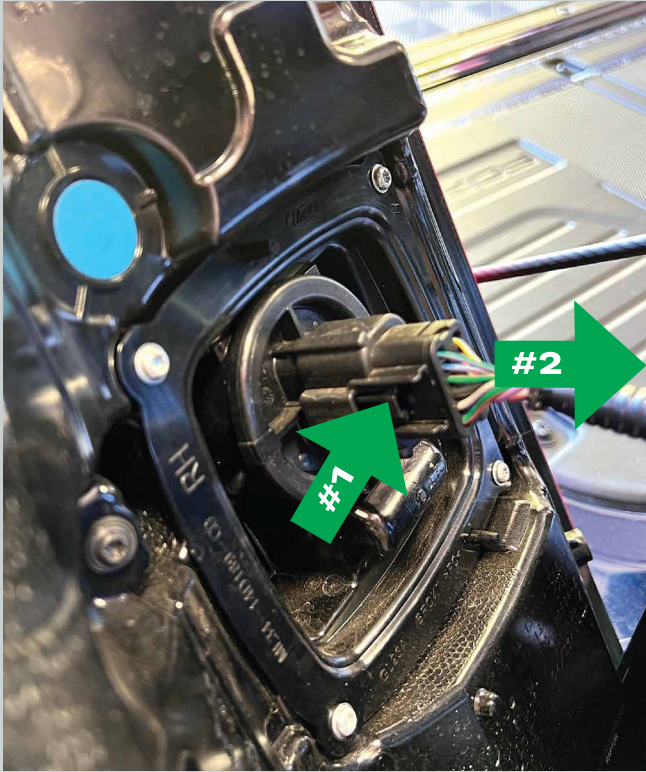

IMAGE 3

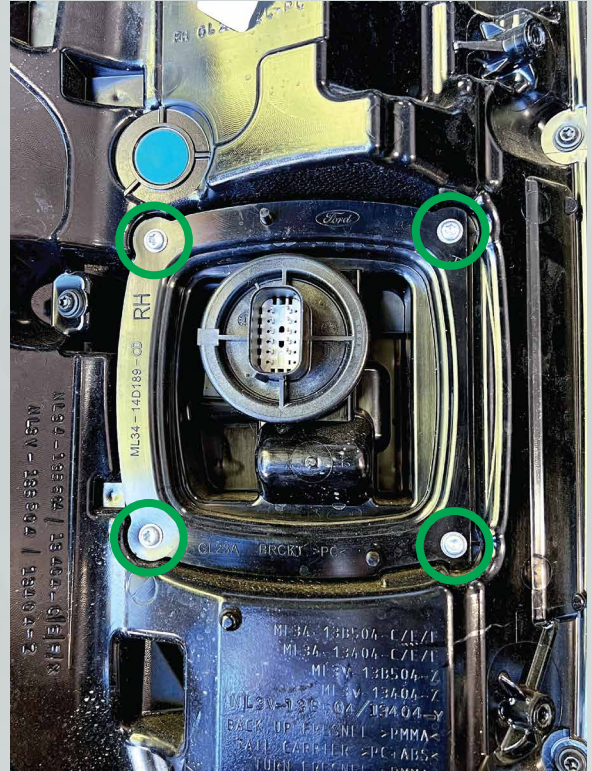

IMAGE 4

3. To remove the BLIS module (IMAGE 5), press down the two (2) release tabs (#1) then slide the BLIS module out (#2). Disconnect the BLIS module (IMAGE 6) by pressing the release clip (#1) and sliding the connector off (#2). Set your factory tail light off to the side.

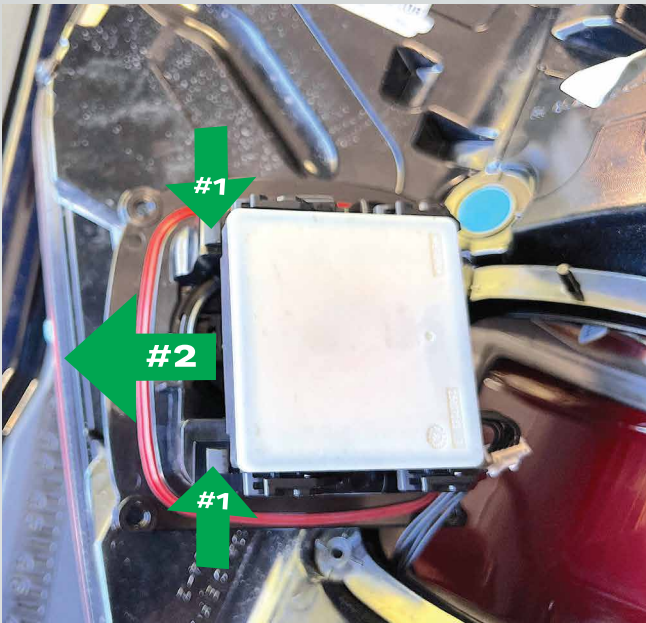

IMAGE 5

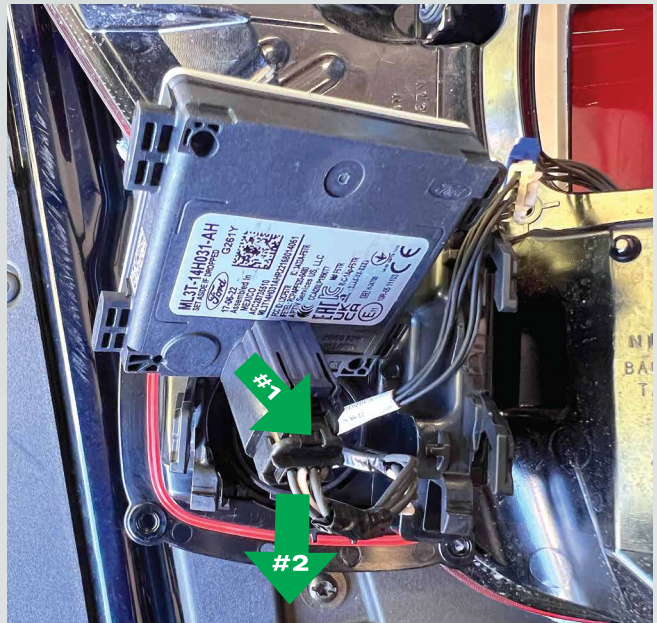

IMAGE 6



4. Grab your Morimoto tail light, remove the four (4) T20 Torx screws and remove the BLIS holder (IMAGE 7). Get your BLIS module, that you removed from your OEM tail light, and plug it in (IMAGE 8).



IMAGE 7

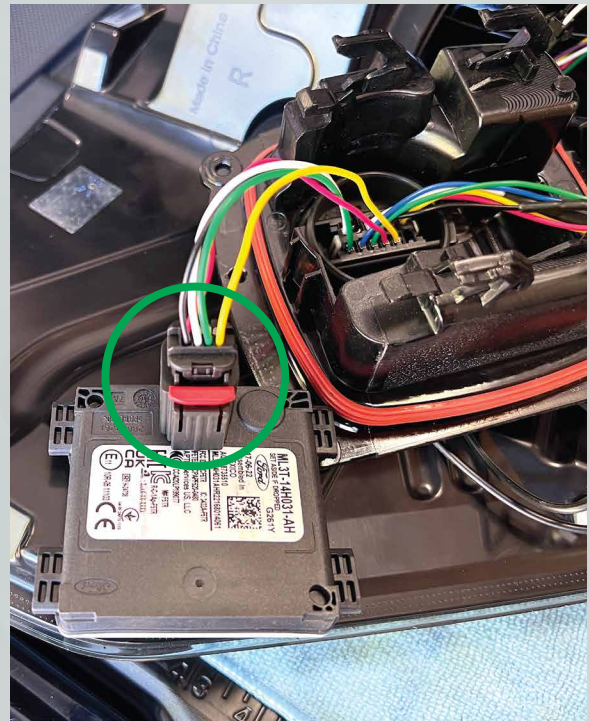

IMAGE 8

5. Install the BLIS module onto the BLIS holder by aligning the BLIS module into the plastic hooks, then slide the BLIS module until it locks in place (IMAGE 9). Before reinstalling the BLIS holder, make sure the black wires, inside of the tail light, are over to the sides so that they don't get pulled (IMAGE 10). Reinstall the BLIS holder (IMAGE 11). Hand tighten the four (4) T20 Torx bolts (IMAGE 11). Remove the two (2) philips head screws and remove the resistor (IMAGE 11).



IMAGE 9

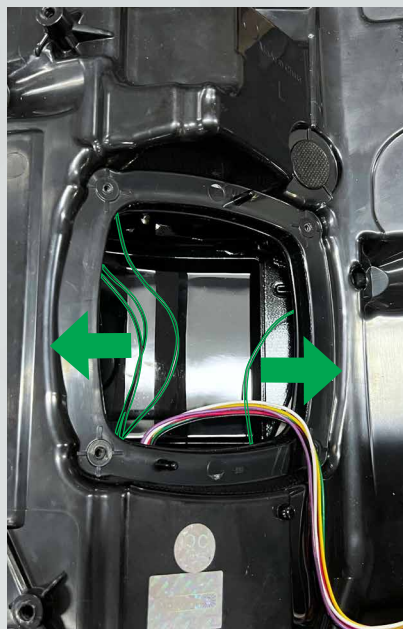

IMAGE 10

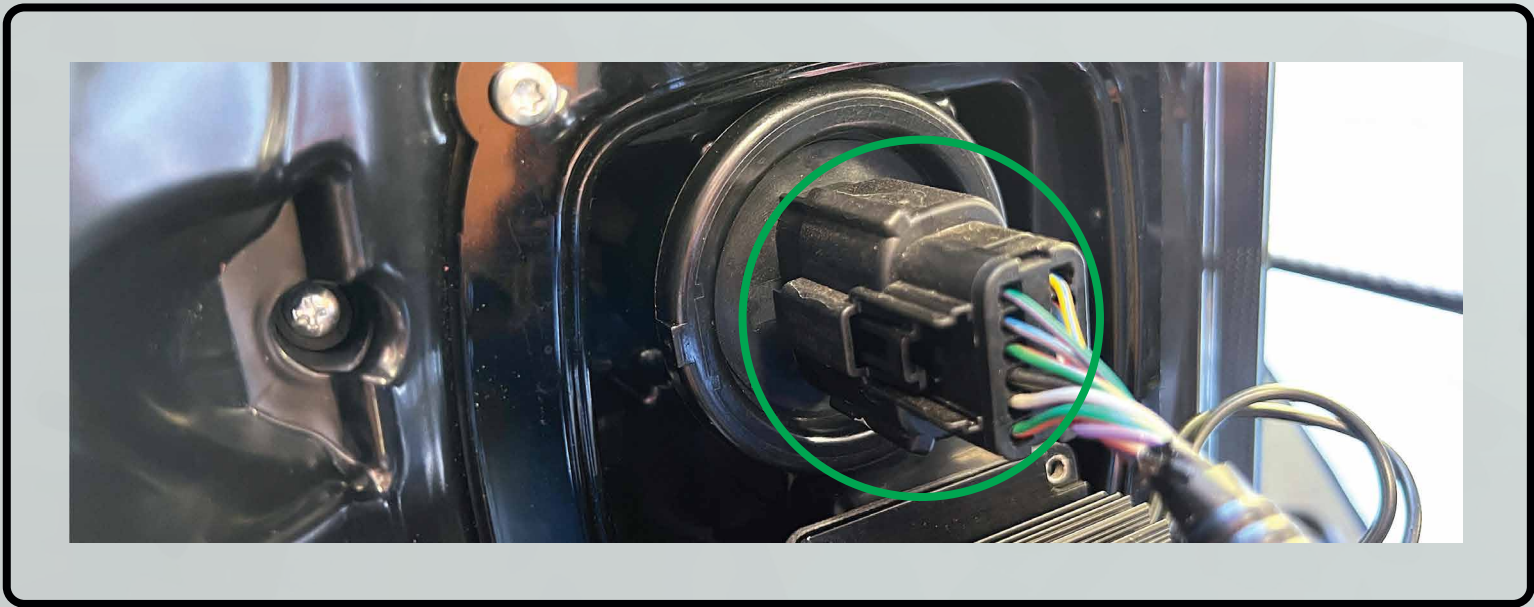

IMAGE 11

**DO NOT USE IMPACT DRIVER TO TIGHTEN BOLTS.**



6. Connect the truck harness to the tail light.



7. Install the tail light onto the truck. Secure it with the two (2) 8mm screws.

8. Repeat steps 1-7 on the other side of the truck.

9. For steps on installing the Boost Bar go to page #14.

10. Turn on the truck and go through all modes to confirm that all tail light functions work.

11. For 21+ OEM LED trucks (non raptor) this is how to eliminate the turn signal error. Plug in your Forscan cable to your truck and laptop. Open up the Forscan software. Click "Configuration and Programming". Then click "BdyCM Module configuration" (IMAGE 12). Then click "Rear LED Turn Outage" (#1), select "0-Disable" (#2), click the check mark to confirm your selection (#3), then click "write" (#4) (IMAGE 13).

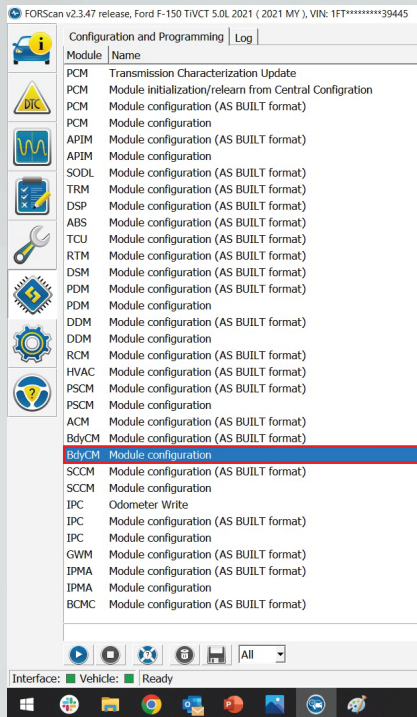

IMAGE 12

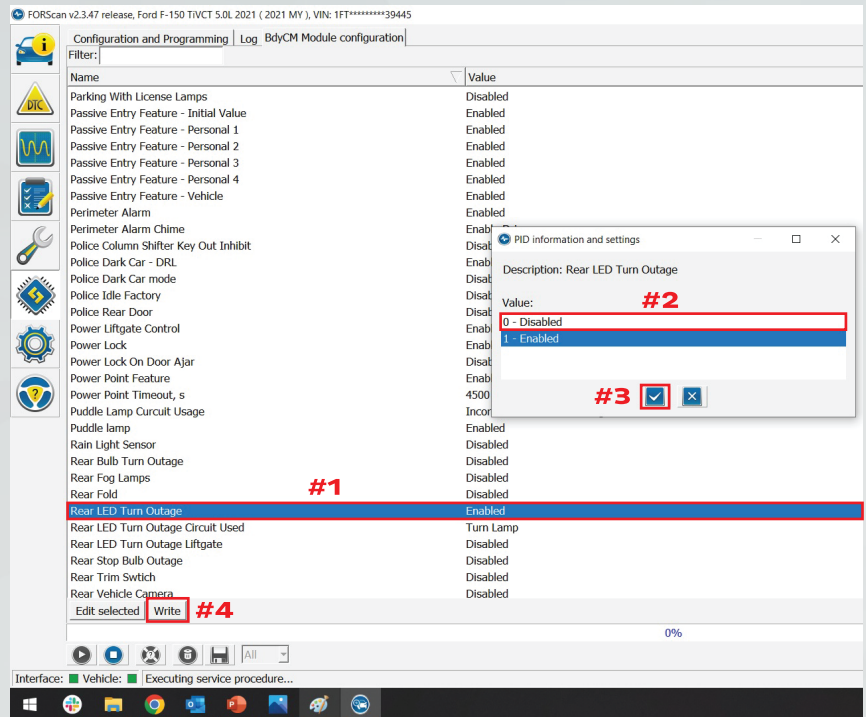

IMAGE 13

ENJOY YOUR NEW MORIMOTO TAIL LIGHTS

# INSTALLATION PROCESS: 2021+ INCANDESCENT WITH BLIS



2021+ INCANDESCENT WITH BLIS

1. Open your tailgate, remove the two (2) 8mm screws holding in the tail light (IMAGE 1). Pull the tail light out away from the truck to release it (IMAGE 2).

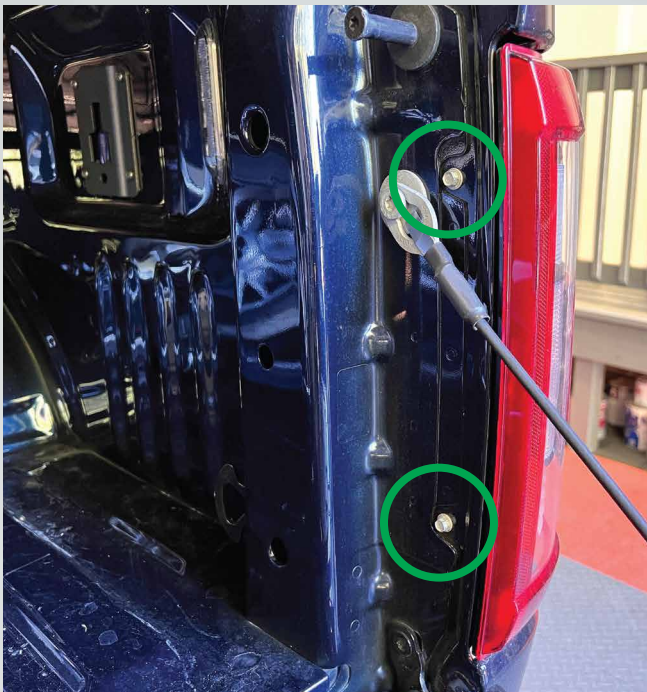

IMAGE 1

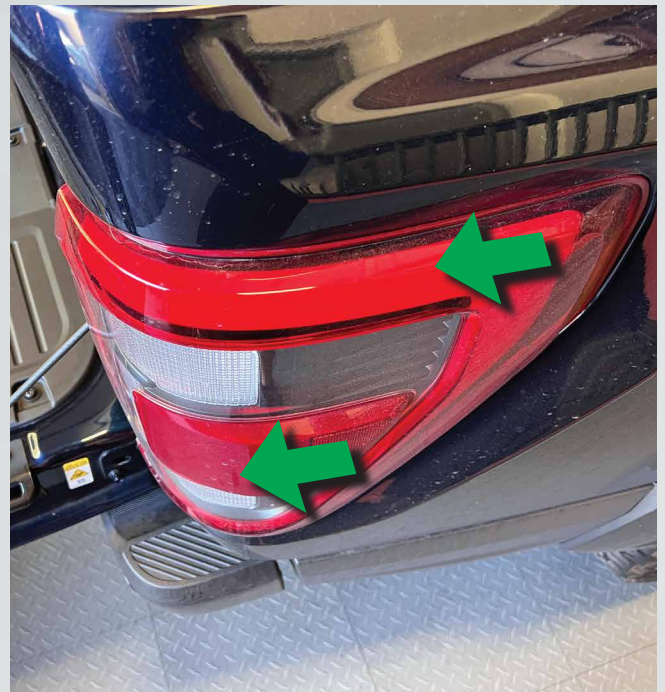

IMAGE 2



2. Disconnect the OEM connectors (IMAGE 3) by pressing the release tab (#1), then slide the connectors apart (#2). Remove the four (4) T20 Torx screws holding the BLIS holder (IMAGE 4) and pull the BLIS holder away from the tail light housing to expose the BLIS module.

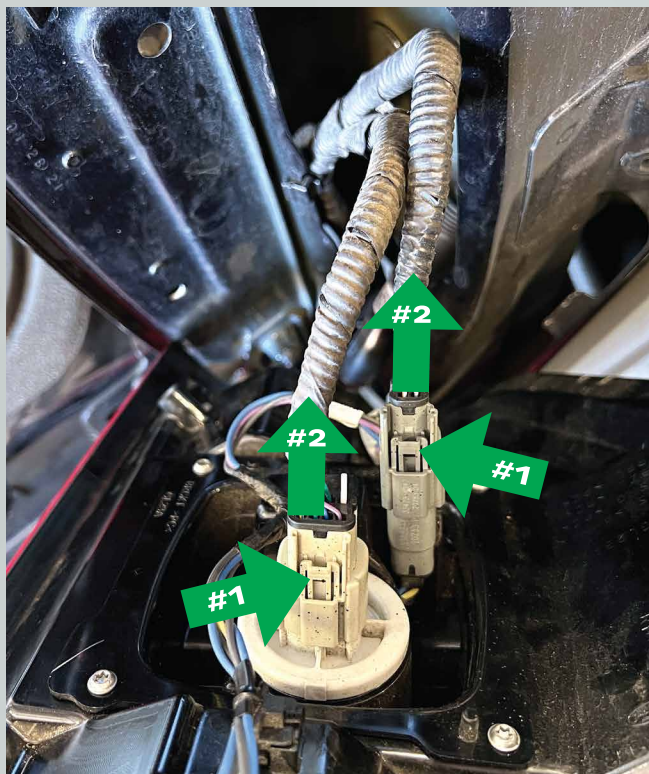

IMAGE 3



IMAGE 4

3. To remove the BLIS module (IMAGE 5), press down the two (2) release tabs (#1) then slide the BLIS module out (#2). Disconnect the BLIS module (IMAGE 6) by pressing the release clip (#1) and sliding the connector off (#2). Set your factory tail light off to the side.

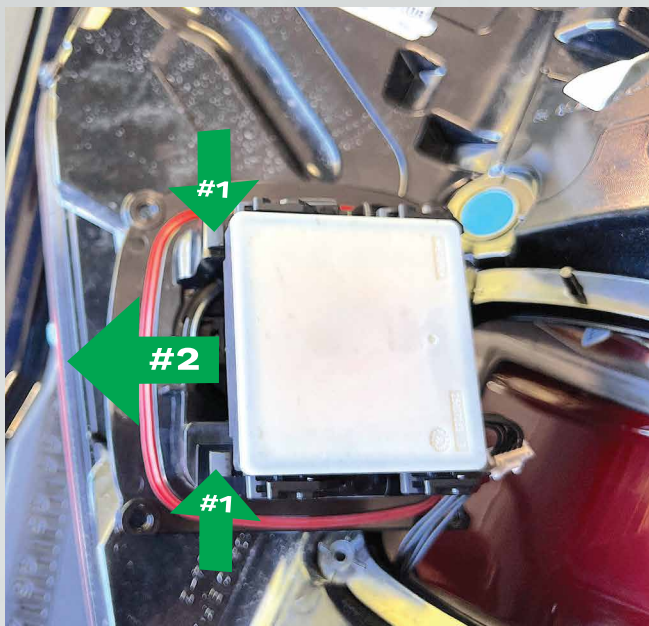

IMAGE 5



IMAGE 6



## DO NOT USE IMPACT DRIVER TO TIGHTEN BOLTS.

4. Grab your Morimoto tail light, remove the four (4) T20 Torx screws and remove the BLIS holder (IMAGE 7). Get your BLIS module, that you removed from your OEM tail light, and plug it in (IMAGE 8).



IMAGE 7

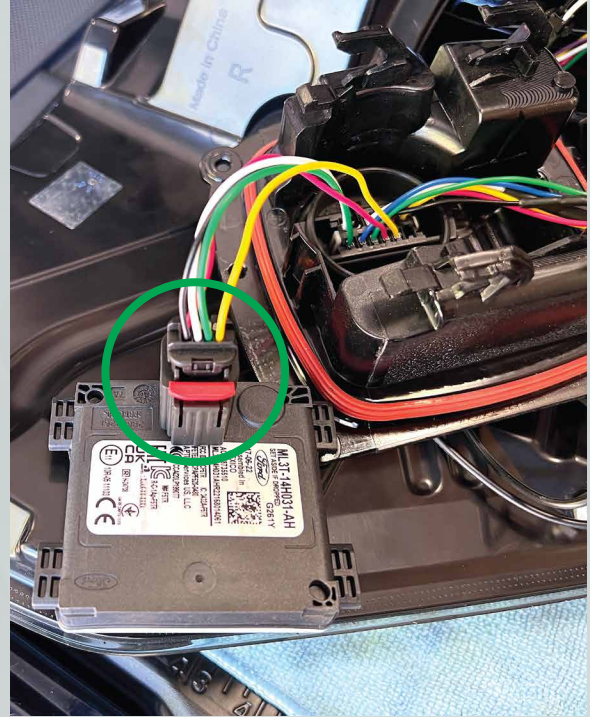

IMAGE 8

5. Install the BLIS module onto the BLIS holder by aligning the BLIS module into the plastic hooks, then slide the BLIS module until it locks in place (IMAGE 9). Before reinstalling the BLIS holder, make sure the black wires, inside of the tail light, are over to the sides so that they don't get pulled (IMAGE 10). Reinstall the BLIS holder into the housing, making sure the rubber seal isn't kinked. Hand tighten the four (4) T20 Torx bolts (IMAGE 11).



IMAGE 9

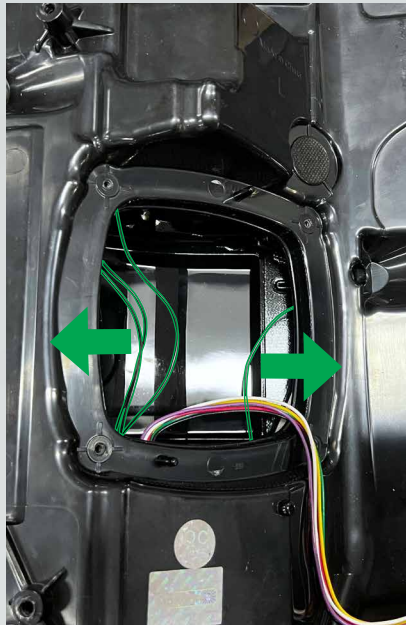

IMAGE 10

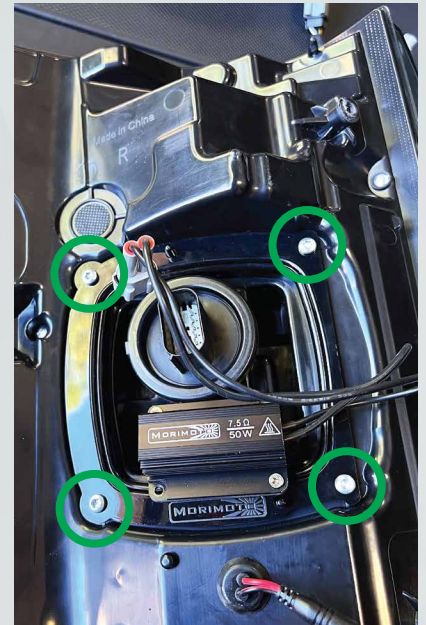
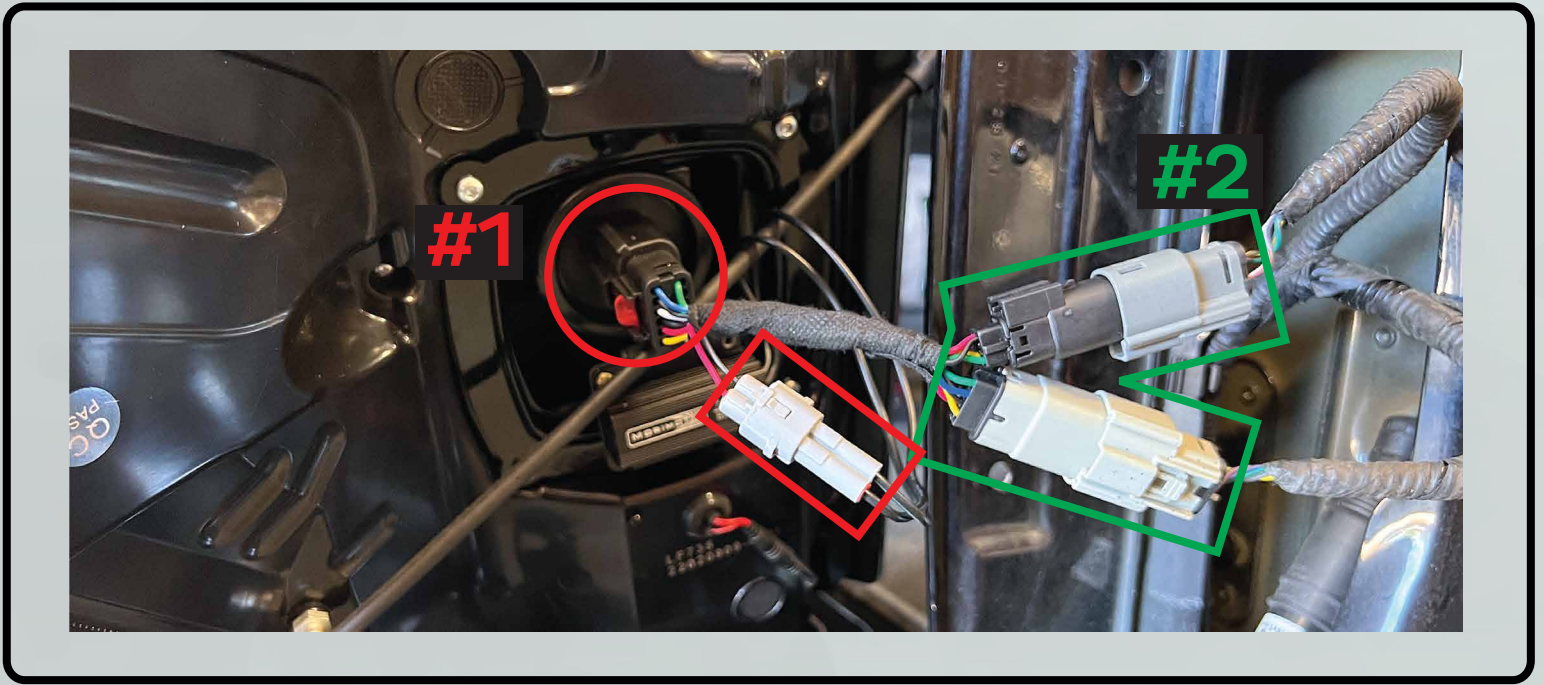

IMAGE 11

## DO NOT USE IMPACT DRIVER TO TIGHTEN BOLTS.



6. Plug in the Type 2 Adapter to the back of the tail light (#1). Also plug in the resistor to the Type 2 Adapter(#1). Connect the tail light harness to the truck harness(#2).



7. Install the tail light onto the truck. Secure it with the two (2) 8mm screws.

8. Repeat steps 1-7 on the other side of the truck.

9. For steps on installing the Boost Bar go to page #14.

10. Turn on the truck and go through all modes to confirm that all tail light functions work.

**ENJOY YOUR NEW MORIMOTO TAIL LIGHTS**

# INSTALLATION PROCESS: 2021+ INCANDESCENT WITHOUT BLIS



2021+ INCANDESCENT WITHOUT BLIS

1. Open your tailgate, remove the two (2) 8mm screws holding in the tail light (IMAGE 1). Pull the tail light out away from the truck to release it (IMAGE 2).

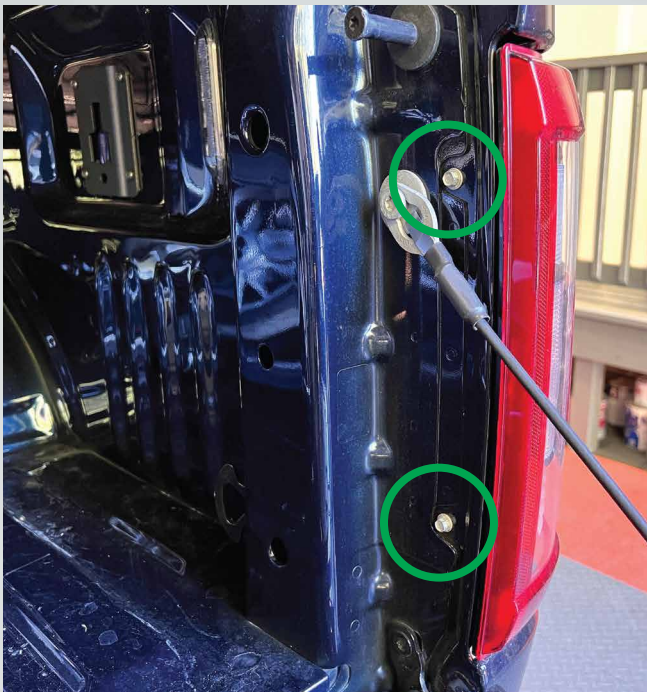

IMAGE 1



IMAGE 2



2. Disconnect the OEM connector (IMAGE 3) by pressing the release tab (#1), then slide the connector off the tail light (#2). Grab your Morimoto tail light, plug in the Type 1 Adapter to the back of the tail light (IMAGE 4). Also plug in the resistor to the Type 1 Adapter.

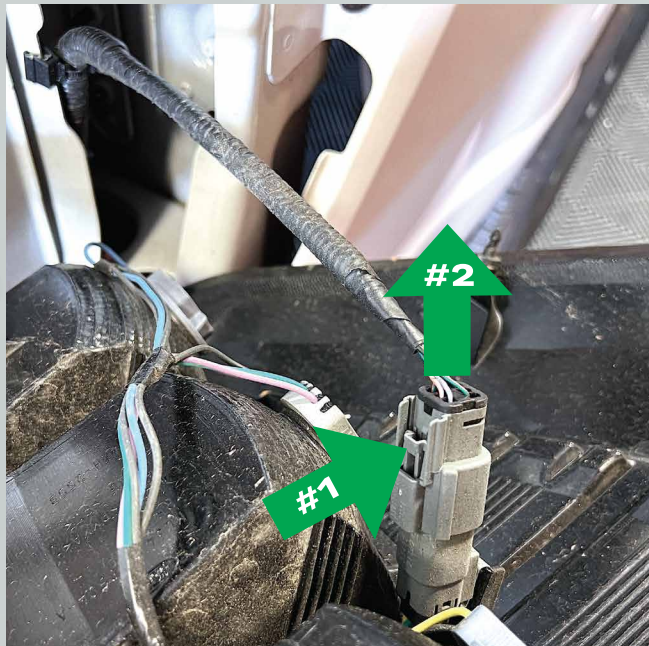

IMAGE 3

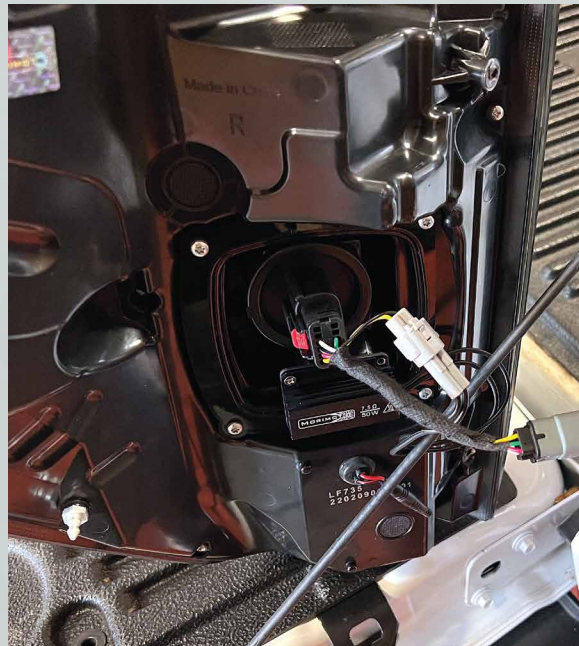
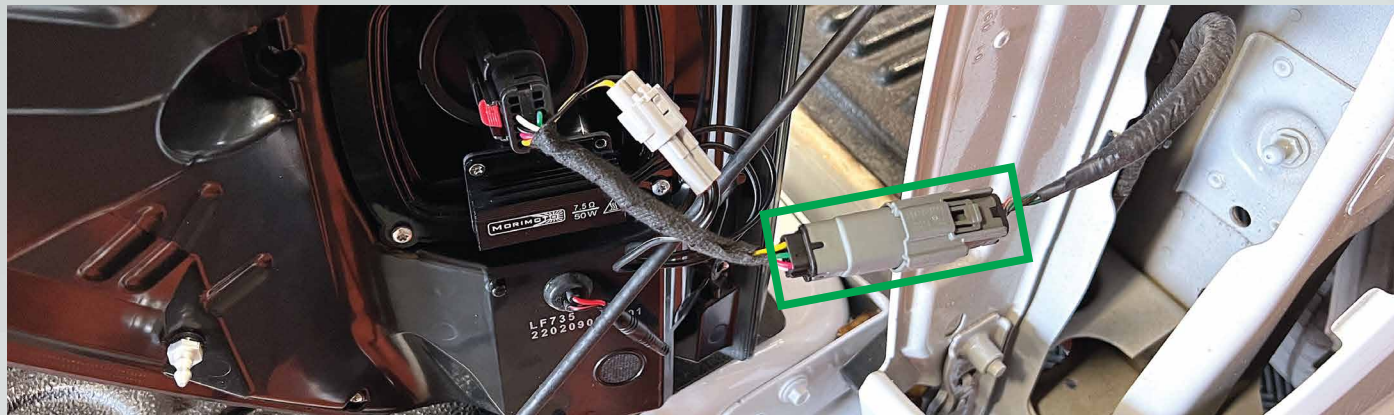

IMAGE 4

3. Connect the tail light harness to the truck harness.



7. Install the tail light onto the truck. Secure it with the two (2) 8mm screws.

8. Repeat steps 1-7 on the other side of the truck.

9. For steps on installing the Boost Bar go to page #14.

10. Turn on the truck and go through all modes to confirm that all tail light functions work.

**ENJOY YOUR NEW MORIMOTO TAIL LIGHTS**

(SOLD SEPARATELY)



# BOOST BAR LICENSE PLATE LIGHT INSTALL GUIDE

**WARNING:** By reading this document, you agree it is only to be used as an educational guide. Morimoto Lighting nor its dealers make guarantees on any finished results, nor are they to be held responsible for any damage, misuse, or personal injuries. If you are unable to clearly understand and adapt the information below, professional installation is recommended.

## PACKAGE CONTENTS

- 1x Boost Bar License Plate Light
- 1x Input Pigtail (not needed in this application)
- 1x Double Wire T-Tap (not needed in this application)

## TOOLS REQUIRED

- Wire Cutters
- Zip Ties
- 1/4" Drill Bit
- Drill

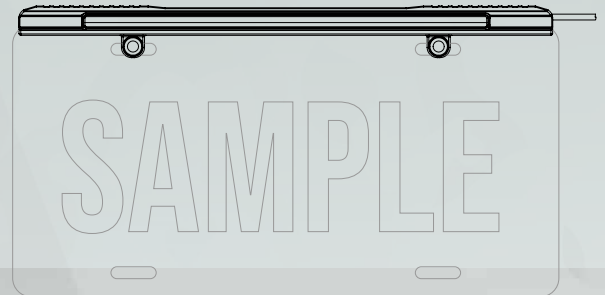



# INSTALLATION PROCESS

## BOOST BAR

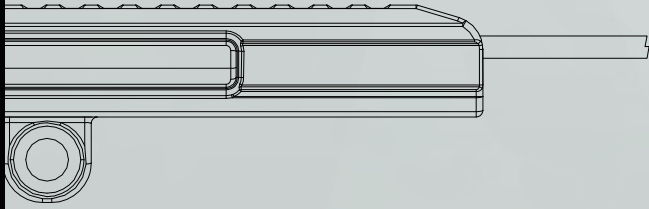

1. Remove your license plate and bolt in the Boost Bar. Mark on the bumper where the wire needs to go through.



2. Drill a 1/4" hole in your bumper and pass the wiring through. and reinstall your license plate with Boost Bar.



3. Run the wiring behind the bumper along the top, and secure using zip ties.



4. Run the wiring up through the tail light hole and plug into your RIGHT Morimoto tail light. Secure remaining wiring with zip ties.



## DIRECT CONNECTION TO RIGHT MORIMOTO XB LED TAIL LIGHTS

