

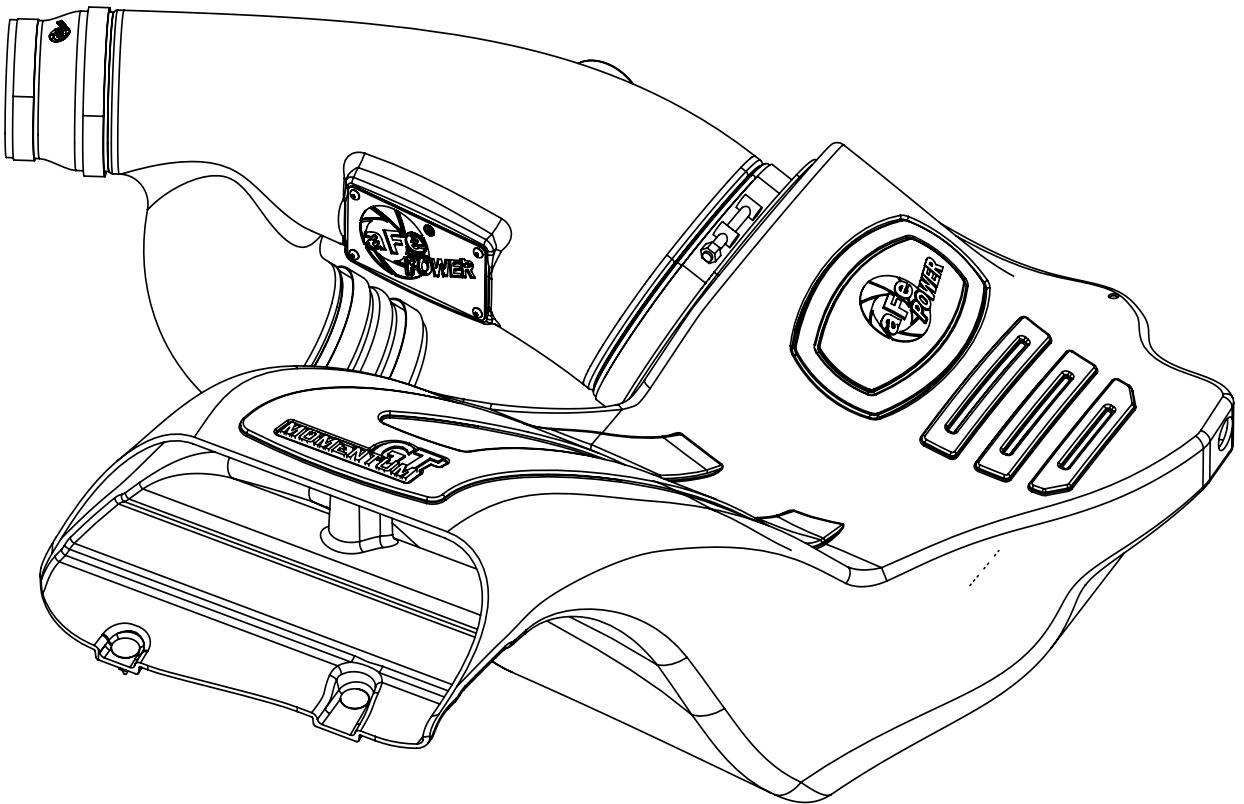

**GT**  
**MOMENTUM™**



## advanced FLOW engineering

Cold Air Intake System

Instruction Manual P/N: 51-73112-1 / 54-73112-1 / 75-73112-1

Make: Ford Model: F-150 Year: 2015-2024 Engine: V6-2.7L (tt) EcoBoost

Make: Ford Model: F-150 Year: 2015-2016 Engine: V6-3.5L (tt) EcoBoost



- Please read the entire instruction manual before proceeding.
- Ensure all components listed are present.
- If you are missing any of the components, call customer support at 951-493-7185.
- Ensure you have all necessary tools before proceeding.
- Do not attempt to work on your vehicle when the engine is hot.
- Retain factory parts for future use.

Label	Qty.	Description	Part Number
A1	1	Air Filter (Pro DRY S)	21-91092
A2	1	Air Filter (Pro 5R)	24-91092
A3	1	Air Filter (Pro-GUARD 7)	72-91092
B	1	Seal, Trim (15.5")	05-00072
C	1	Fitting, Air Temp Sensor	05-01454
D	1	Tube	05-73112B1
E	1	Housing	05-73112B2
F	1	Coupling, Silicone Reducer	05-01331
G	1	Coupling, Silicone Hump	05-01332
H	2	Clamp 2-1/2" - 4-1/2"	03-50006
I	1	Clamp 2-13/16" - 3-3/4"	03-50008
J	1	Clamp, 2-5/16" - 3-1/4"	03-50019
K	2	Retainer Clip	03-50616
L	1	Grommet	03-50167
M	1	Vent Insert (For V6-3.5L (tt) only)	05-01405

**Product covered by one or more of the following patents:** 11125150, 11603792, 10648404, 9440175, 10252202, 10532304, 11219850, 11331607, 11376536, 11135538, 11745129

Warranty Information available at: <https://afepower.com/contact#warranty>

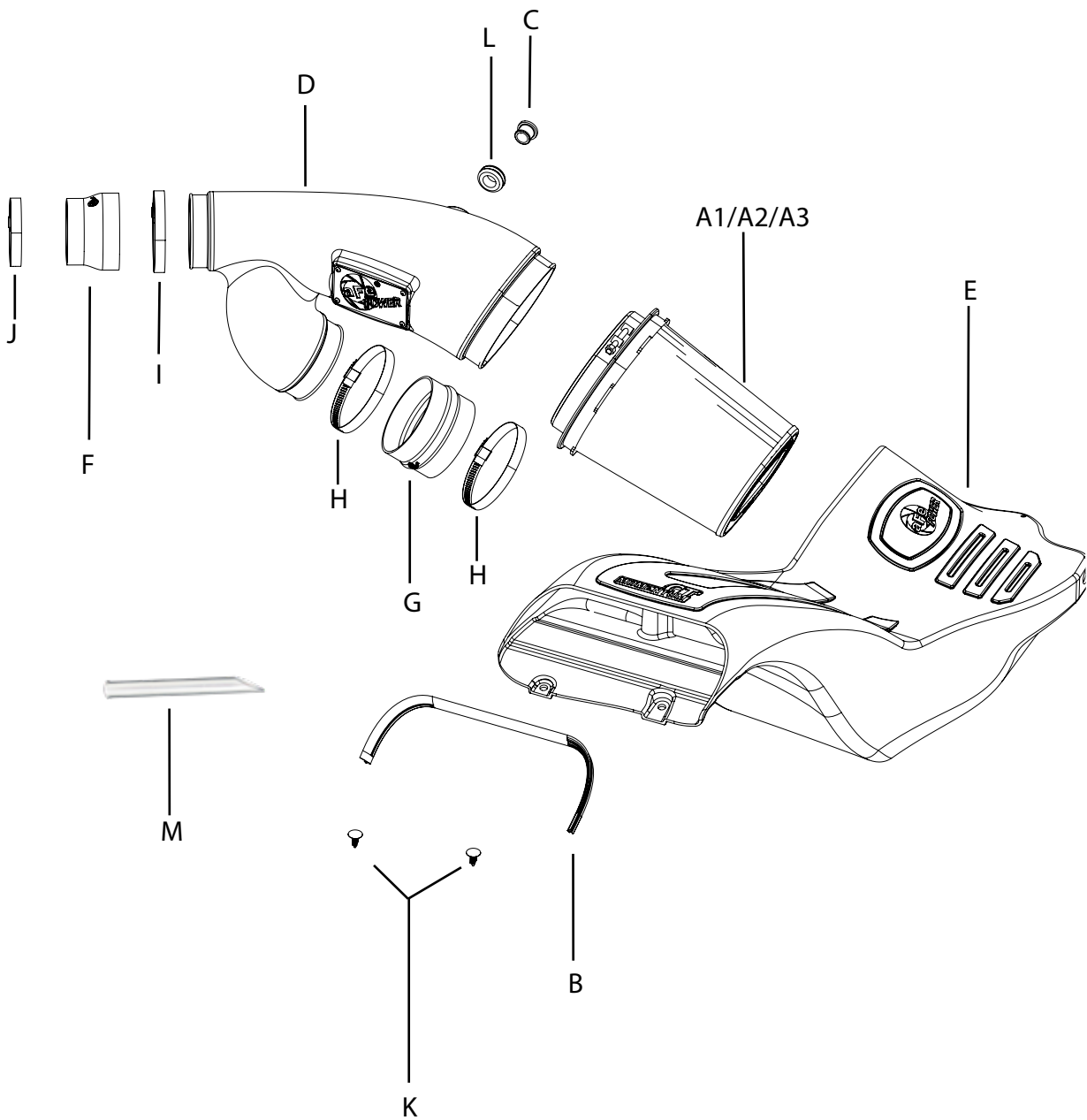

**Figure A****Figure 1**

Refer to Figure A for Steps 1-3

Step 1: Rotate ① temperature sensor counter clockwise then pull it out of the tube.

Disconnect the ② wire harness clip from the air box.

Step 2: Untighten the three ③ clamps on the air intake tube. Pull the tube out of the truck.

Step 3: Remove the screw ④ and the two plastic rivets ⑤ securing the housing, then pull the factory air box out of the truck



Figure B

Refer to Figure B for Steps 4-5

Step 4: Transfer the grommet ⑥ from the factory air box to the aFe air box.

Step 5: Install the furnished seal trim ⑦ on the top edge of the aFe housing.



Refer to Figure C for Step 6-8

Step 6: Install the aFe housing into the truck by pushing it into the factory mounting grommets.

Step 7: Re-install the factory screw (8) removed in step 3, inside the aFe housing.

Step 8: Secure the housing with the two furnished plastic rivets (9).



Figure D

Refer to Figure D for Step 9

Step 9: Slide aFe filter inside the housing and push it in until it locks.



Figure E

Refer to Figure E for Step 14

Step 10: Install grommet into hole in aFe tube then push the aluminum fitting in it.

Step 11: Install couplings and clamps onto tube ends. Do not tighten clamps yet.





Figure 2



Figure F

Refer to Figure F for Steps 12-14

Step 12: Install the aFe tube in the truck by sliding the couplings over the factory tube then the tube end into aFe filter.

Step 13: Align tube correctly then tighten all clamps.

Step 14: Secure the temperature sensor into the aluminum fitting by turning clockwise.  
Clip the harness into the small holes⑩on the aFe housing.



Figure G

Refer to Figure G for Step 15

Step 15: Make sure all clamps and screws are tight. Remove plastic film from aFe window.

Proceed to the following pages for vent insert on 2016 models.

## Vent insert installation:

INSTALL



Figure H

Refer to [Figure H for Step 16](#) ( For V6-3.5L (tt) only, not necessary on V6-2.7L (tt) )

(These procedures should be done with the inlet tubes installed on the engine. It is shown off the vehicle for better illustration.)

Step 16: Locate the o.e. plastic tube feeding the driver's side turbo inlet.



Refer to Figure I for Step 17 ( For V6-3.5L (tt) only, not necessary on V6-2.7L (tt) )

Step 17: Locate the valve cover vent tube that feeds into driver's side turbo inlet. It is not necessary to remove the engine cover.



Figure J

Refer to Figure J for Step 18. ( For V6-3.5L (tt) only, not necessary on V6-2.7L (tt) )

Step 18: Note the release clip on the vent tube connectors. Apply pressure against the exposed tail and pull vent fitting off of the turbo inlet tube. It is not necessary to disconnect at the valve cover end. There is a sensor and wire harness on this vent tube. Do not damage or remove these components.



Figure K

Refer to Figure K for Step 19 ( For V6-3.5L (tt) only, not necessary on V6-2.7L (tt) )

Step 17: Insert vent fitting with slash cut facing turbo inlet. It should not be a loose fit. It is direction dependent and must not rotate once installed.

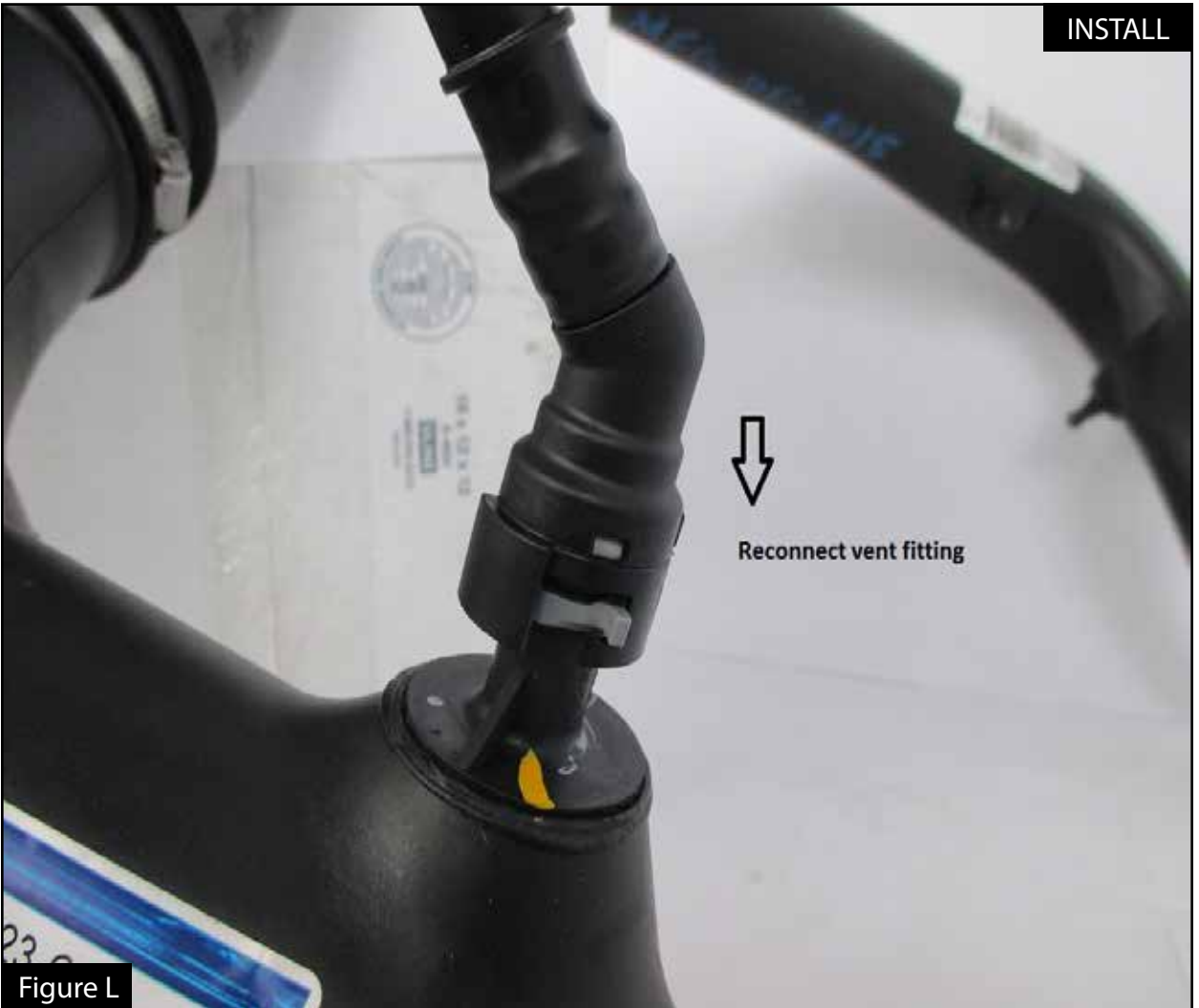

Figure L

### Refer to Figure L for Steps 20-21

Step 20: Reconnect the vent fitting. It will snap over without having to release the plastic clip.

Pull up slightly to confirm installation. ( For V6-3.5L (tt) only, not necessary for V6-2.7L (tt) )

Step 21: Installation is complete. Any codes can be cleared with a code reader or by disconnecting the battery. You will lose any radio presets with battery disconnection.

If removal of the vent insert is required, it can be pulled out with internal snap ring pliers.

NOTE: Retighten all connections after approximately 100-200 miles.

**Place the included CARB EO sticker on or near the device on a smooth, clean surface.**

**EO identification is required to pass the smog inspection.**



**advanced FLOW engineering, inc.**

Corona, CA 92879

<https://afepower.com/contact>