

advanced FLOW engineering

Cold Air Intake System

Instruction Manual P/N: 56-70062D / 56-70062R

Make: Honda
Make: Acura

Model: Civic Type R
Model: Integra Type S

Year: 2023-2024
Year: 2024-2024

Engine: L4-2.0L(t)
Engine: L4-2.0L(t)



- Please read the entire instruction manual before proceeding.
- Ensure all components listed are present.
- If you are missing any of the components, call customer support at 951-493-7185.
- Ensure you have all necessary tools before proceeding.
- Do not attempt to work on your vehicle when the engine is hot.
- Retain factory parts for future use.

Label	Qty.	Description	Part Number
A	1	Air Filter (Pro 5R) For 56-70062R	24-91103
A	1	Air Filter (Pro DRY S) For 56-70062D	21-91103
B	1	Tube	05-5670062B1
C	1	Housing	05-5670062B2
D	2	Screw, M4 x 10mm	03-50490
E	1	Alcohol Wipes, (Single-Use Packet)	05-01716
F	2	Clip, Harness Holder	05-01760
G	1	Gasket	05-01782
H	1	Extension Harness: MAF sensor	05-70045

Installation will require the following tools:

Socket Set, Torx Set, Extensions, Ratchet, Pliers, Screwdriver Set, Trim Removal Tool

Warranty Information available at: <https://afepower.com/contact#warranty>

Emissions Disclaimer: This product is not currently CARB exempt and is not available for purchase in California or for use on any vehicle registered with the California Department of Motor Vehicles.

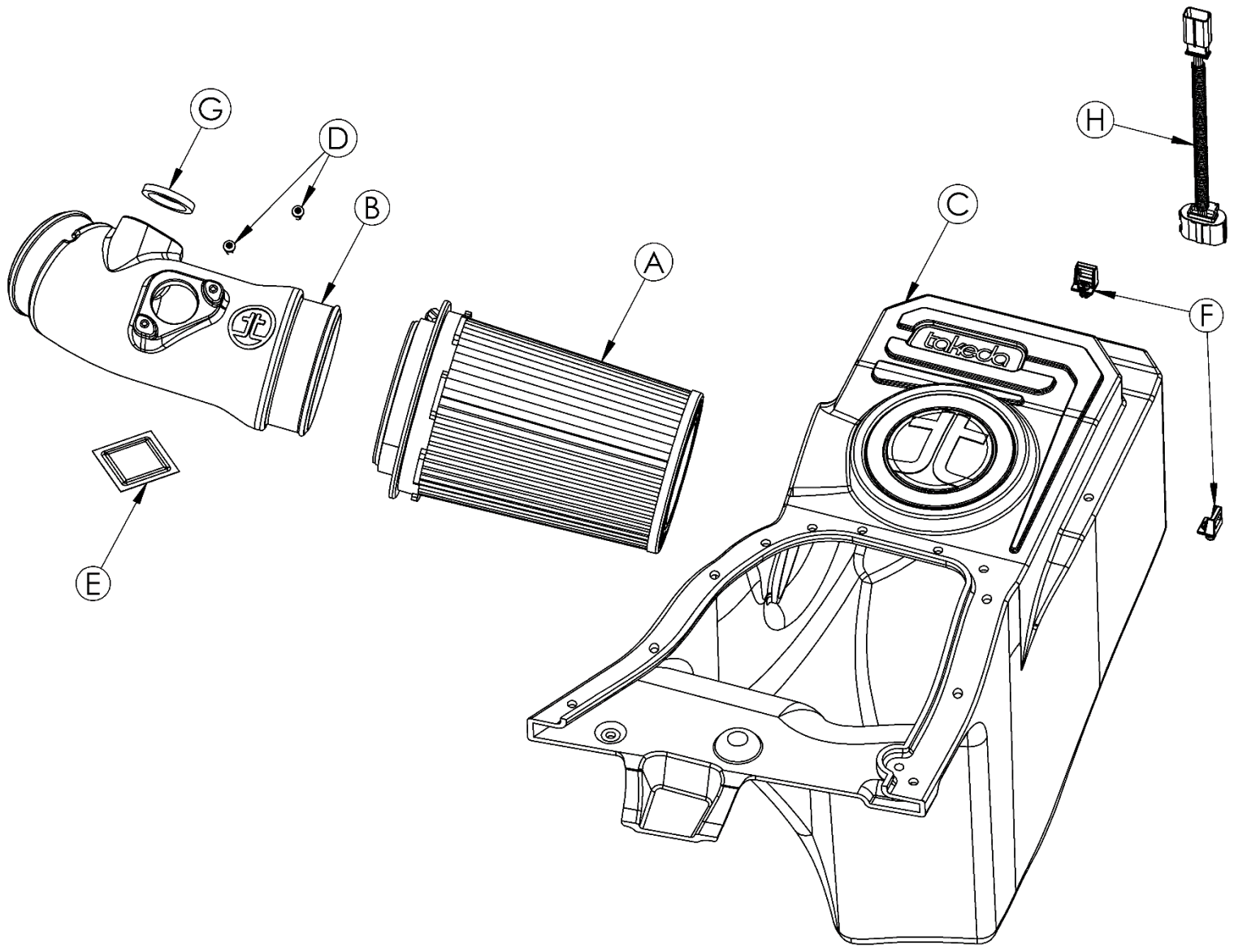

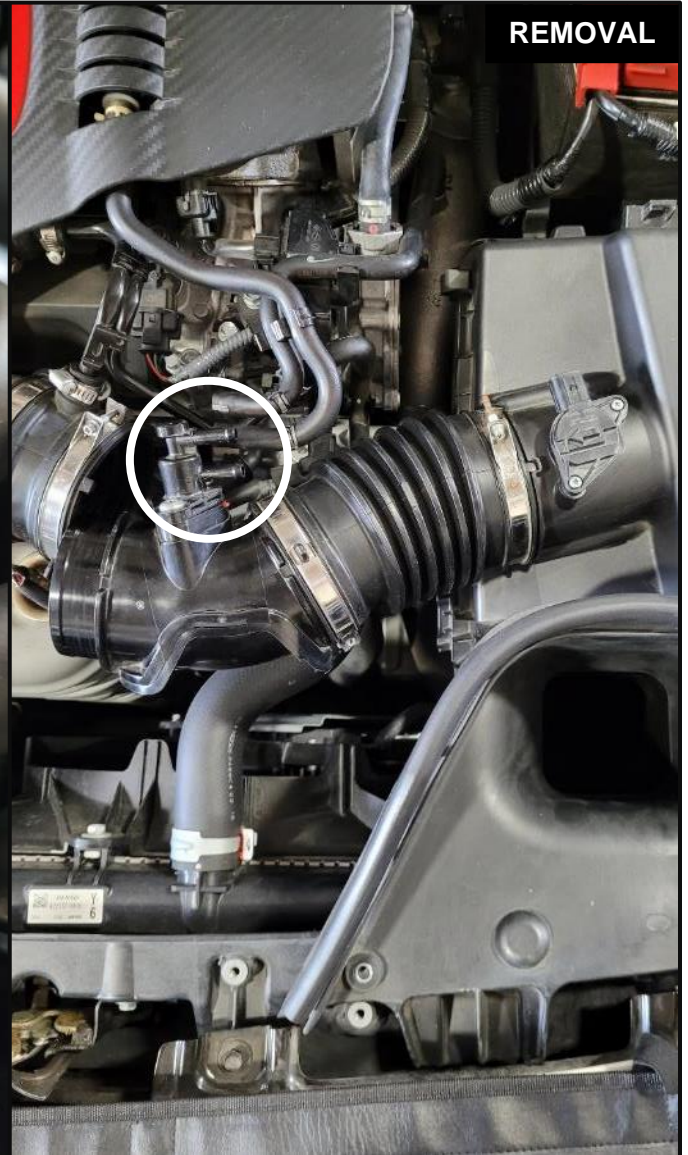
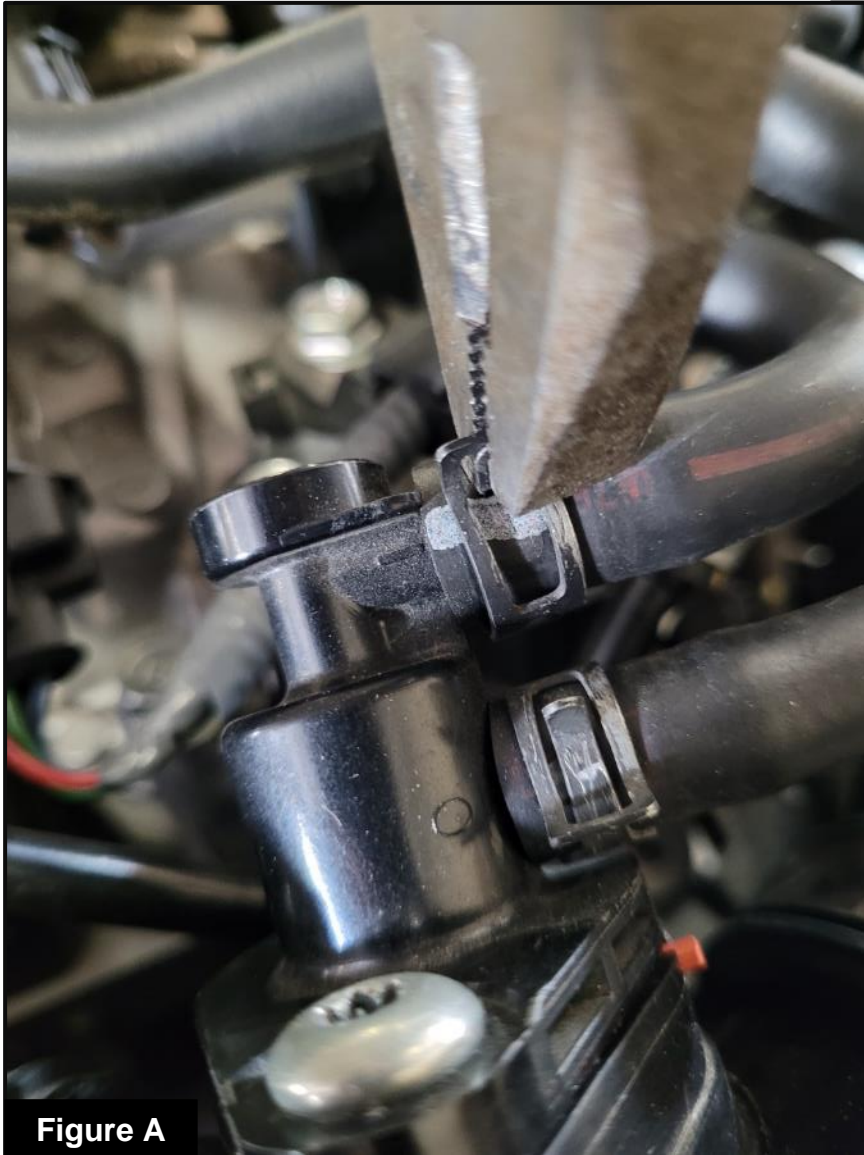

Refer to Figure A for Steps 1-2

Step 1: Use pliers to slide back both hose clamps on jet purge assembly

Step 2: Carefully use a flat head screwdriver to help remove hoses



Figure B

Refer to Figure B for Step 3

Step 3: Use a 5.5mm socket to loosen hose clamp on intake tube. Do not remove hose clamp

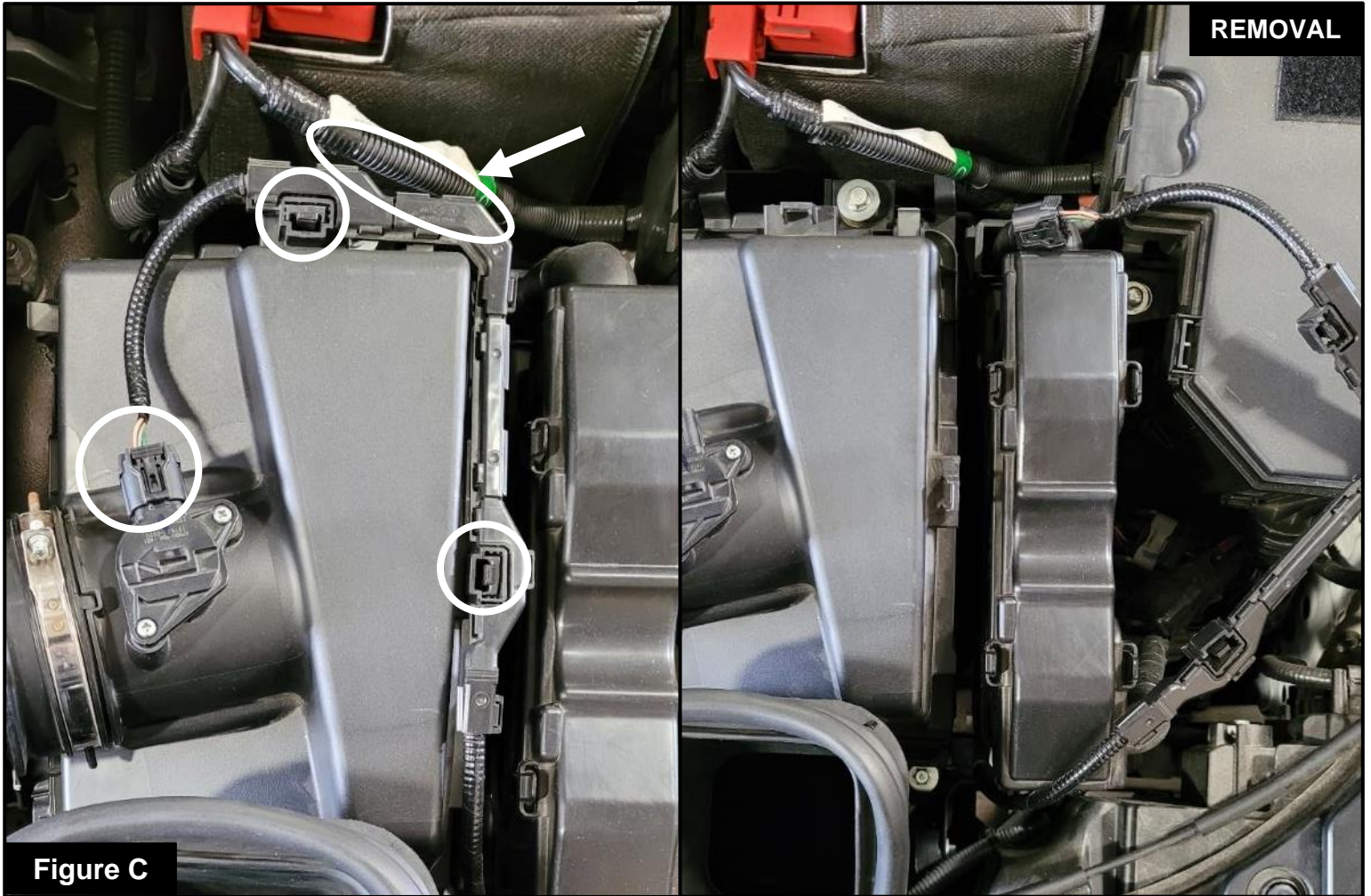

Refer to Figure C for Steps 4-5

Step 4: Use a pry tool to remove battery harness that is connected to back of housing

Step 5: Unclip Mass Air Flow (MAF) sensor and MAF sensor harness

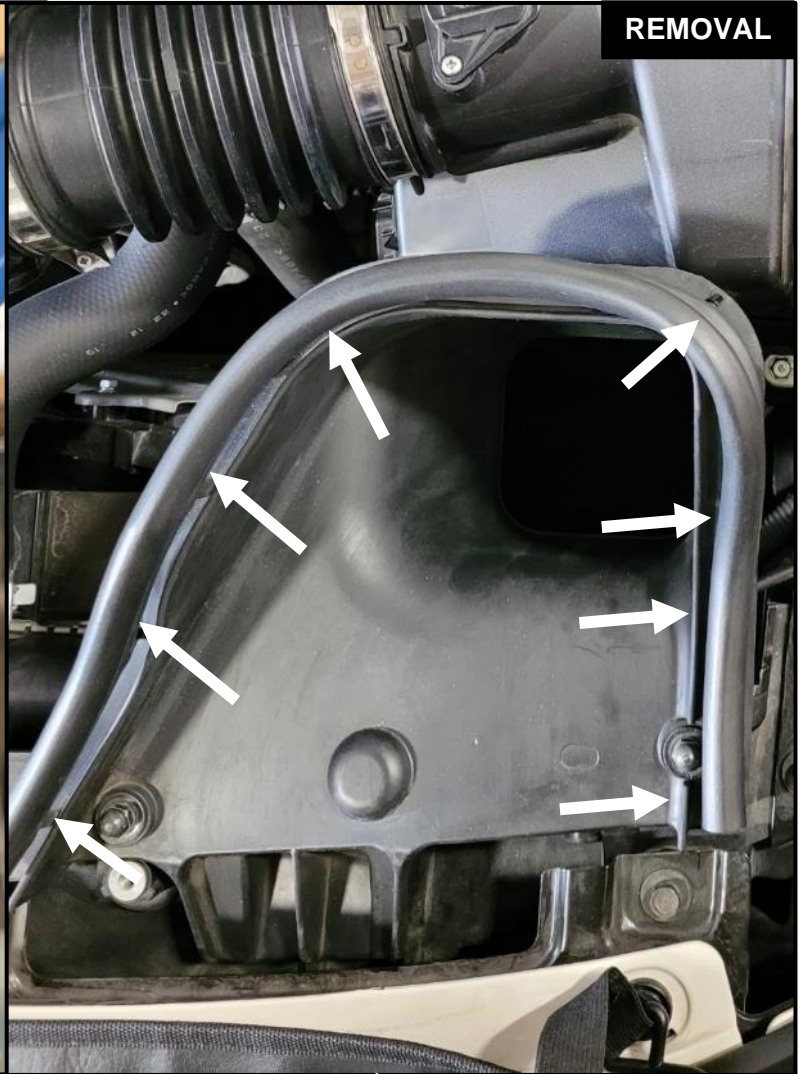

Refer to Figure D for Step 6

Step 6: Use a pry tool to remove factory trim seal carefully. Trim seal will be reinstalled on the TAKEDA housing

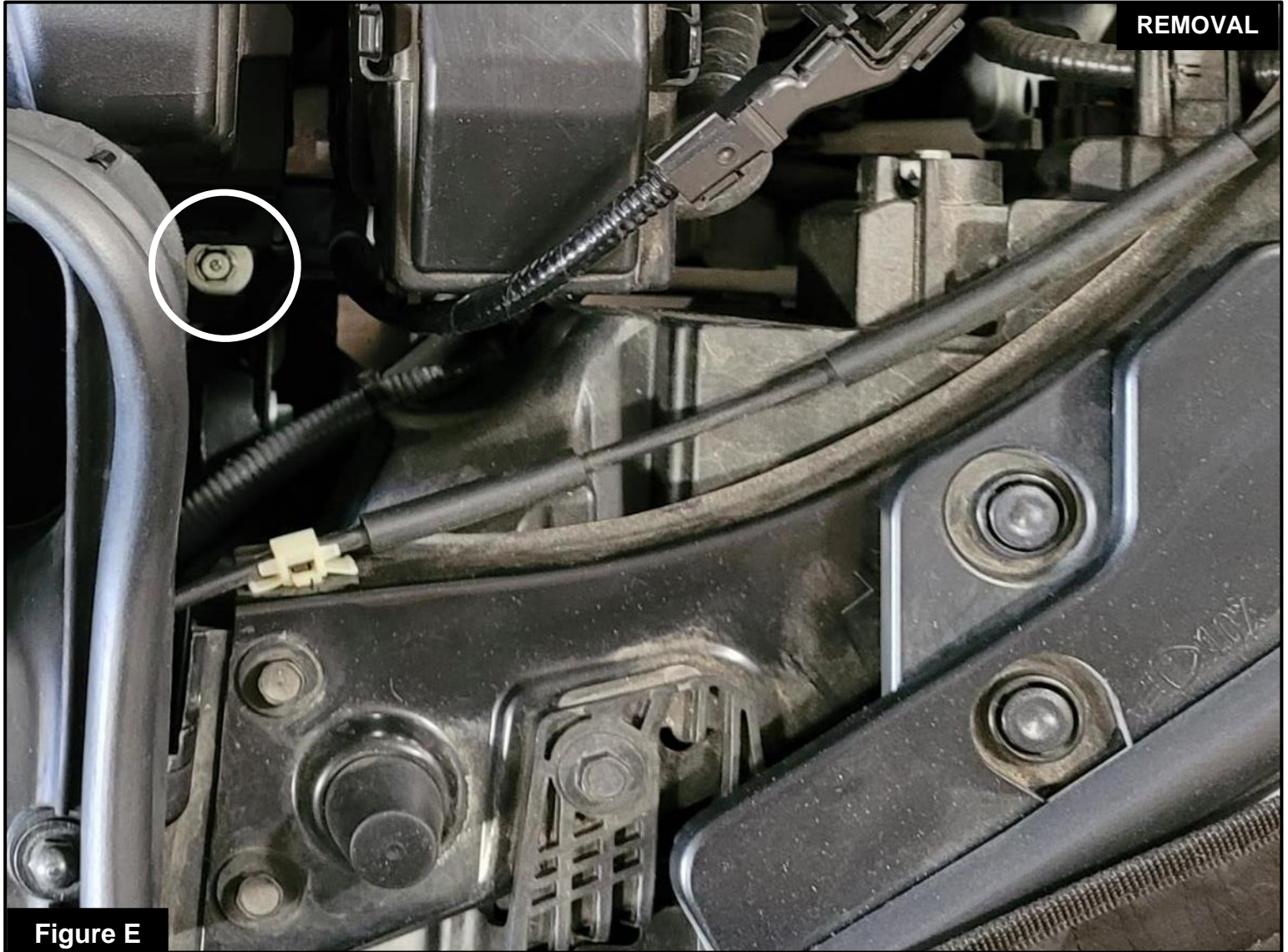

Refer to Figure E for Step 7

Step 7: Use a 10mm socket with a long extension and ratchet tool to fully loosen the screw at the bottom right of housing (screw does not come out)

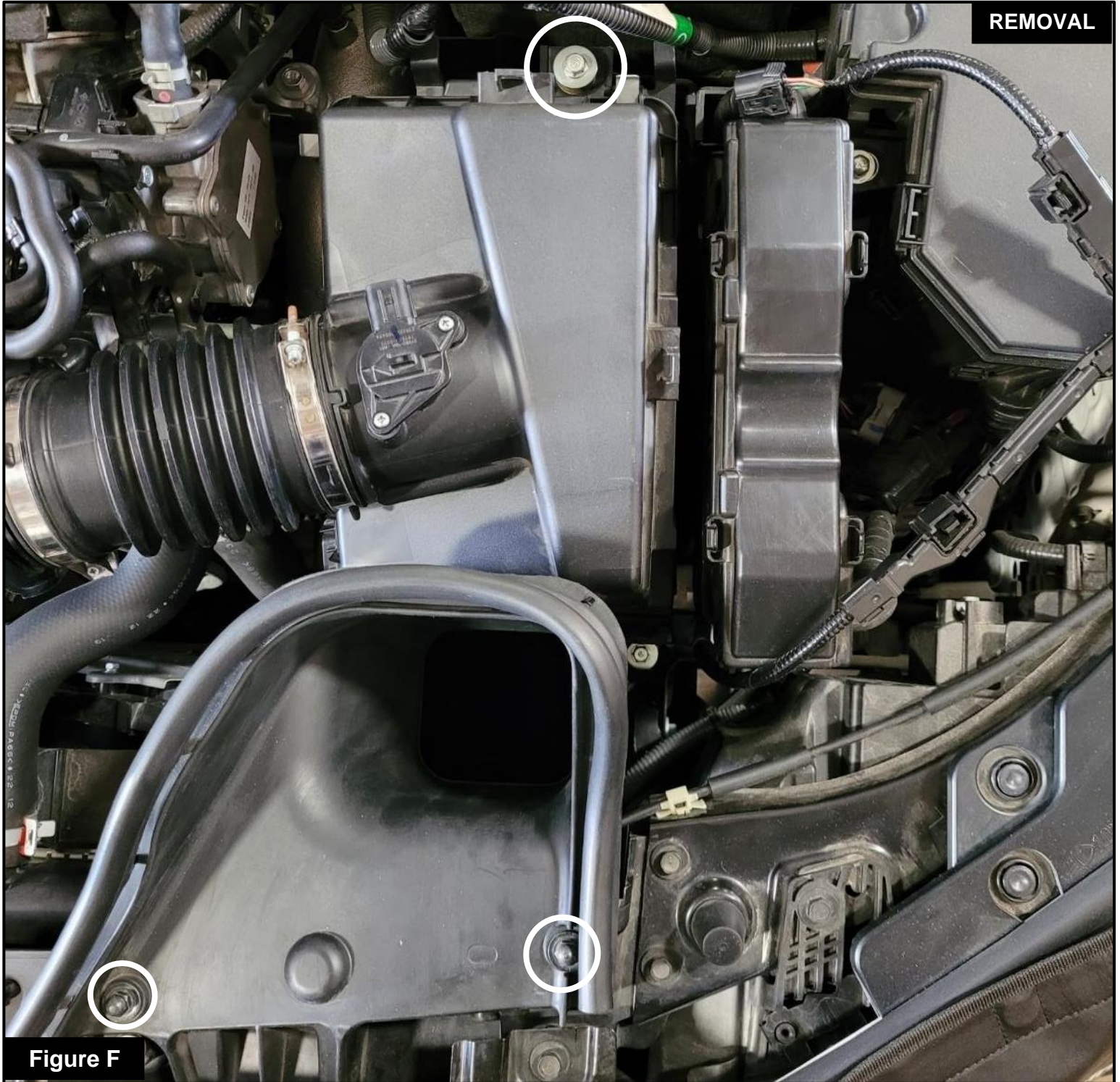
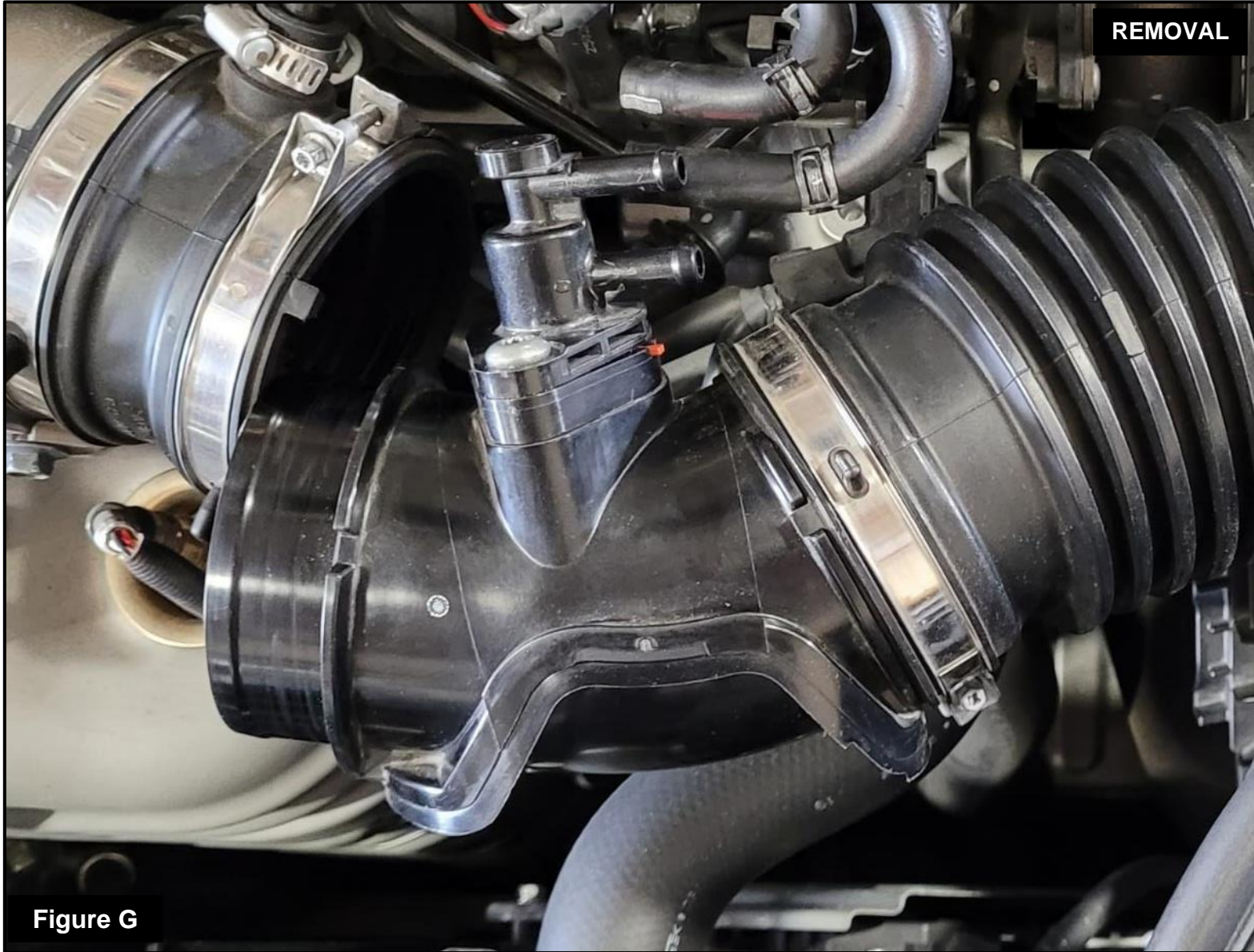

Figure F

Refer to Figure F for Steps 8-9

Step 8: Use a 10mm socket to remove screw located at the back of the housing

Step 9: Use a 10mm socket to remove the 2 screws located at the front of the housing. All 3 screws will be used for the installation of TAKEDA intake



Refer to Figure G for Step 10

Step 10: Pull out tube from coupling and remove entire factory airbox out of the vehicle



Refer to Figure H for Step 11

Step 11: Transfer bottom Grommet from factory housing to TAKEDA housing



Figure J

Refer to Figure J for Step 12

Step 12: Transfer the back Grommet from the factory housing to the TAKEDA housing

**Figure K****Refer to Figure K for Step 13**

Step 13: Use alcohol wipe provided in the kit to clean the gasket groove. Next remove the white film from the foam gasket and apply the sticky side of gasket into groove



Figure L

Refer to Figure L for Step 14

Step 14: Use a T-30 Torx to remove the factory screws and jet purge assembly from factory tube and reinstall them on the TAKEDA tube using the factory screws



Figure M

Refer to Figure M for Step 15

Step 15: Use a Phillips screwdriver to remove the MAF sensor from the factory tube. Then, use a T-20 Torx screwdriver to install the provided black screws, securely attaching the MAF sensor onto the TAKEDA tube



Figure N

Refer to Figure N for Step 16

Step 16: Carefully install housing into vehicle (Do not tighten down anything yet). Insert filter into the TAKEDA housing

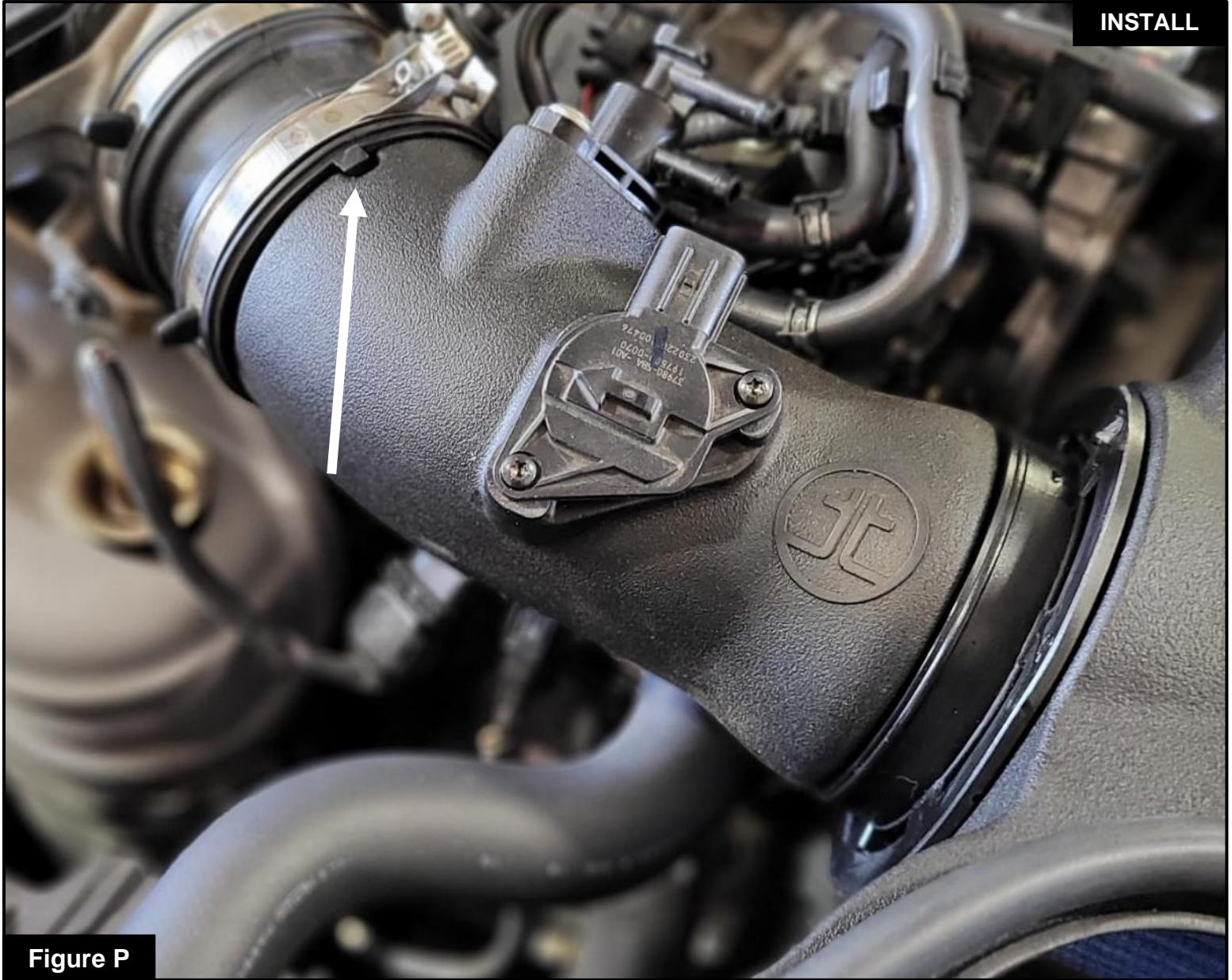

Figure P

Refer to Figure P for Step 17

Step 17: Install the TAKEDA tube into the filter and the factory coupler (line up notch)

INSTALL

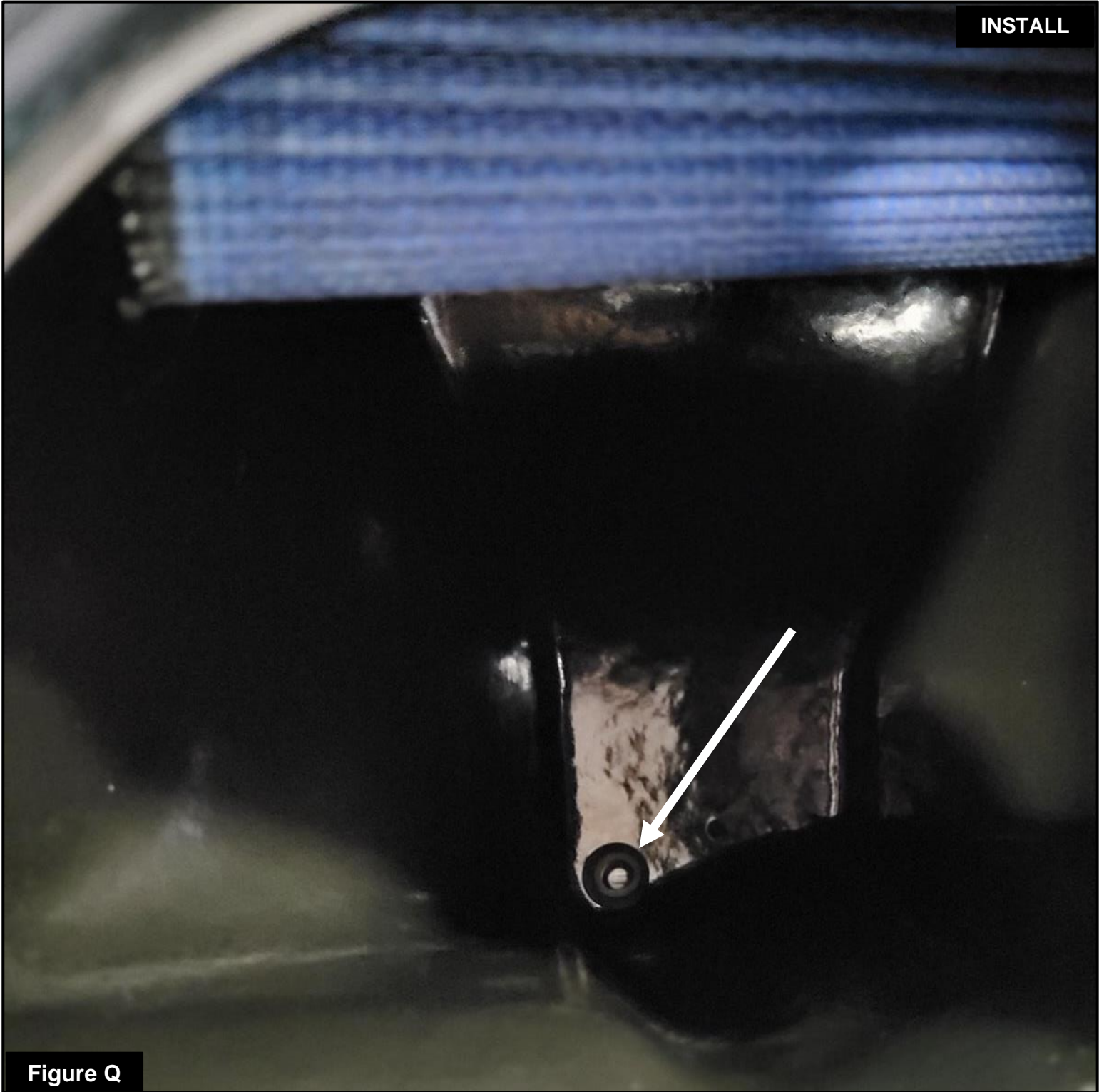
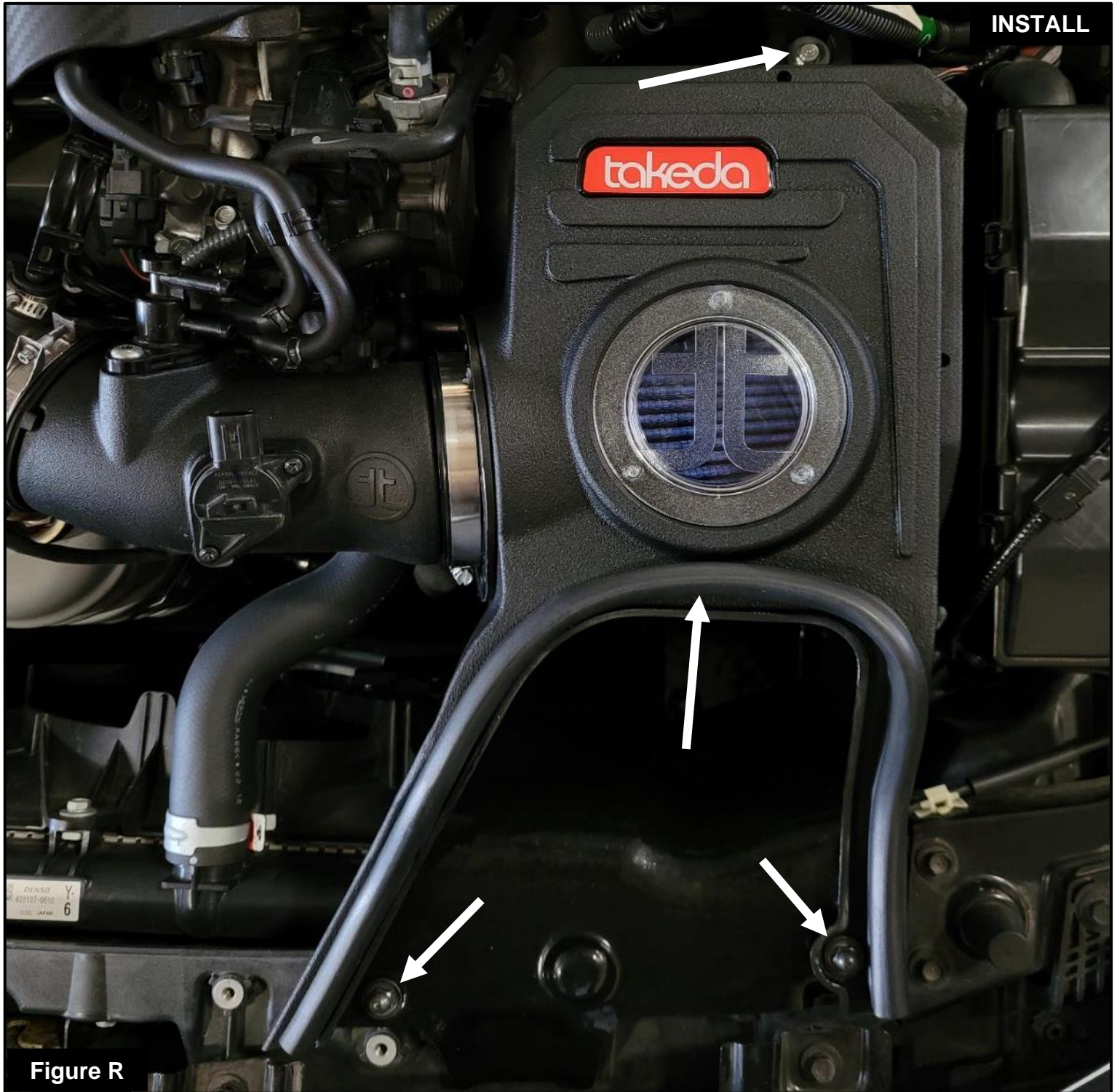

Figure Q

Refer to Figure Q for Step 18

Step 18: Line up the bottom grommet hole with stud mount and push down housing to pop into position



Refer to Figure R for Step 19

Step 19: Use a 10mm socket to install the far back screw and the 2 front screws

Step 20: Install the factory trim seal into the holes on the TAKEDA housing



Figure S

Refer to Figure S for Step 21

Step 21: Use pliers to reinstall the jet purge assembly hoses and hose clamps

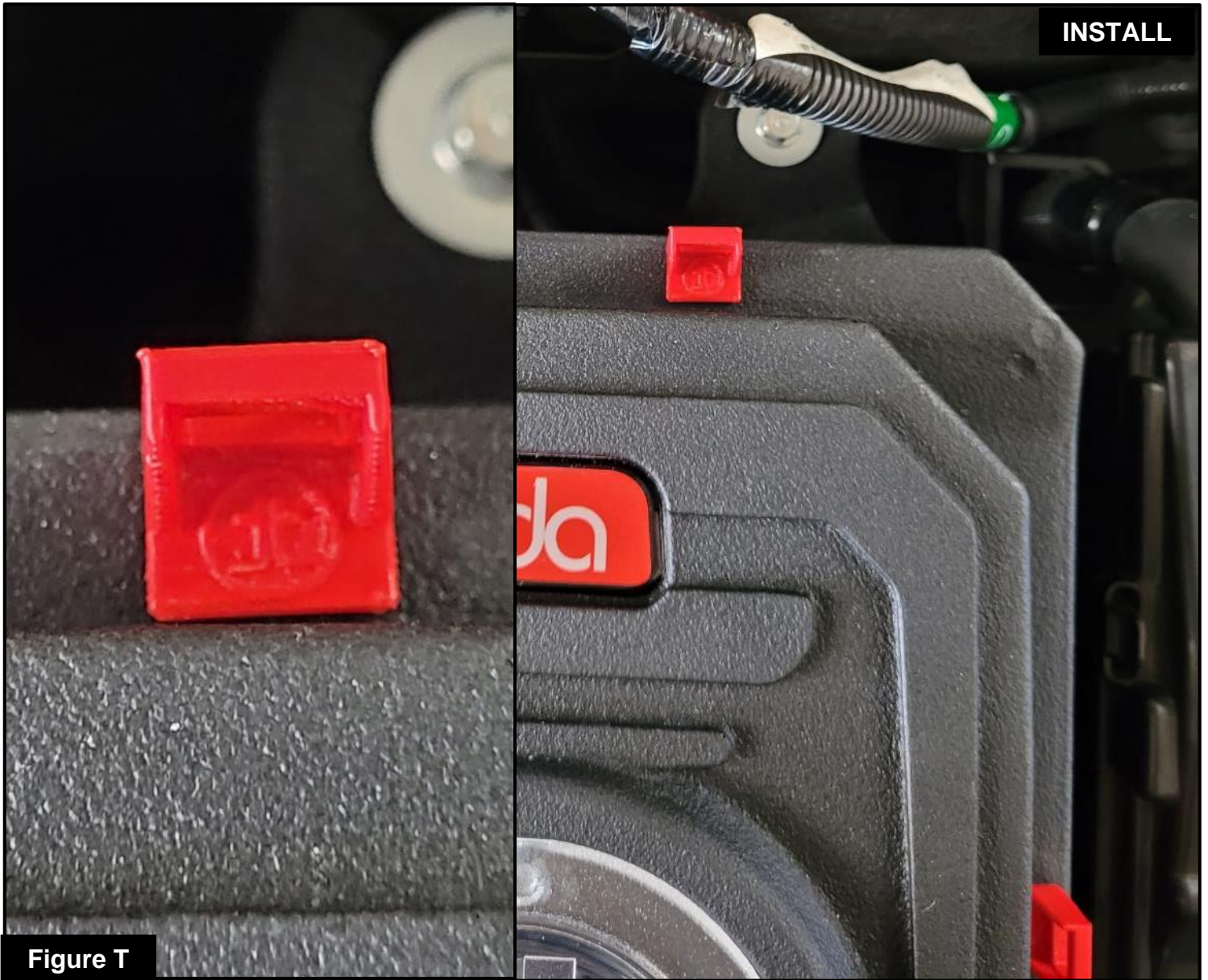

Figure T

Refer to Figure T for Step 22

Step 22: Install the TAKEDA harness holder clips onto the housing

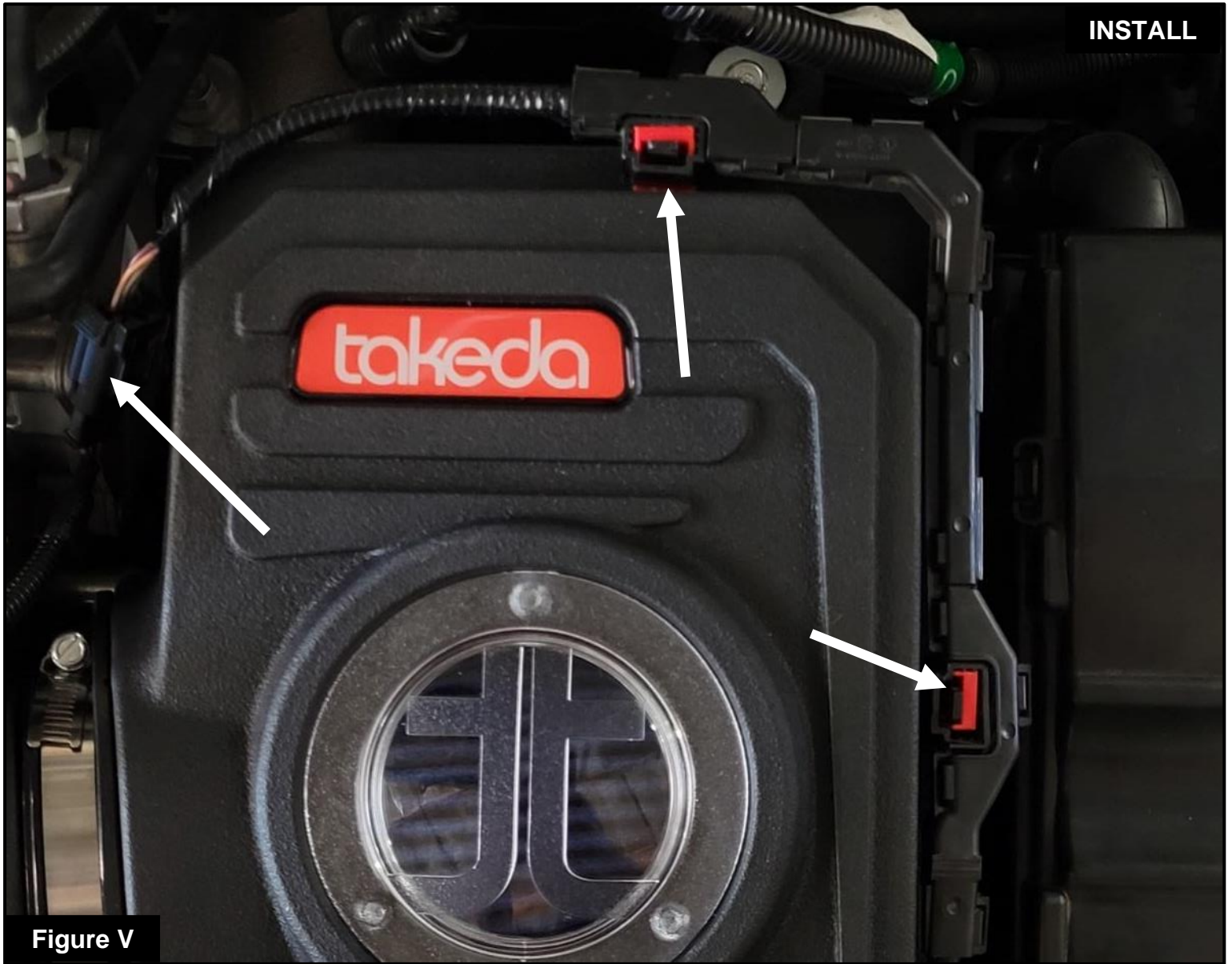

Figure V

Refer to Figure V for Step 23

Step 23: Install the Mass Air Flow (MAF) sensor extension to factory harness and clip harness onto TAKEDA harness holder clips



Figure W

Refer to Figure W for Steps 24-26

Step 24: Use a 8mm socket to tighten the hose clamp between tube and filter

Step 25: Use a 5.5mm socket to tighten down factory hose clamp on the TAKEDA tube

Step 26: Connect the Mass Air Flow (MAF) sensor harness to MAF sensor



Your installation is now complete. Thank you for choosing Takeda USA!

NOTE: Check to ensure that all screws, clamps, and connectors are secure after 100-200 miles.



PAGE LEFT BLANK INTENTIONALLY



PAGE LEFT BLANK INTENTIONALLY



PAGE LEFT BLANK INTENTIONALLY



advanced FLOW engineering, inc.

Corona, CA 92879

<https://afepower.com/contact>