

advanced FLOW engineering

Cold Air Intake System

Instruction Manual P/N: 52-10012R / 52-10012D

Make: FORD

Model: F-150

Year: 2021-2022

Engine: V8-5.0L



- Please read the entire instruction manual before proceeding.
- Ensure all components listed are present.
- If you are missing any of the components, call customer support at 951-493-7185.
- Ensure you have all necessary tools before proceeding.
- Do not attempt to work on your vehicle when the engine is hot.
- Retain factory parts for future use.

Label	Qty.	Description	Part Number
A1	1	Air Filter (Pro 5R) For 52-10012R	24-91040
A2	1	Air Filter (Pro DRY S) For 52-10012D	21-91040
B	1	Tube, Plastic	05-5210012B1
C	1	Housing, Aluminum	05-5210010B2
D	1	Coupling, Elbow Reducer	05-01587
E	1	Clamp, 060 (3-5/16" – 4-1/4")	05-50002
F	1	Clamp, 072 (3" – 5")	03-50010
G	2	Screw, Hex Head: M6 x 1 x 25	03-50114
H	1	Seal, Trim: 7/16" Bulb 1/16" Edge Thk	05-00072
I	2	Washer, Spring Lock: 03-50750	03-50750
J	1	Fitting, SAE 15.82 (5/8") to 3/8" NPT	05-01339

Installation will require the following tools:

7mm, 8mm and 13mm Nut Drivers or Ratchet and Sockets, Flat Head Screwdriver, 20mm wrench or adjustable wrench

Warranty Information available at: <https://afepower.com/contact#warranty>

Emissions Disclaimer: This product is not currently CARB exempt and is not available for purchase in California or for use on any vehicle registered with the California Department of Motor Vehicles.

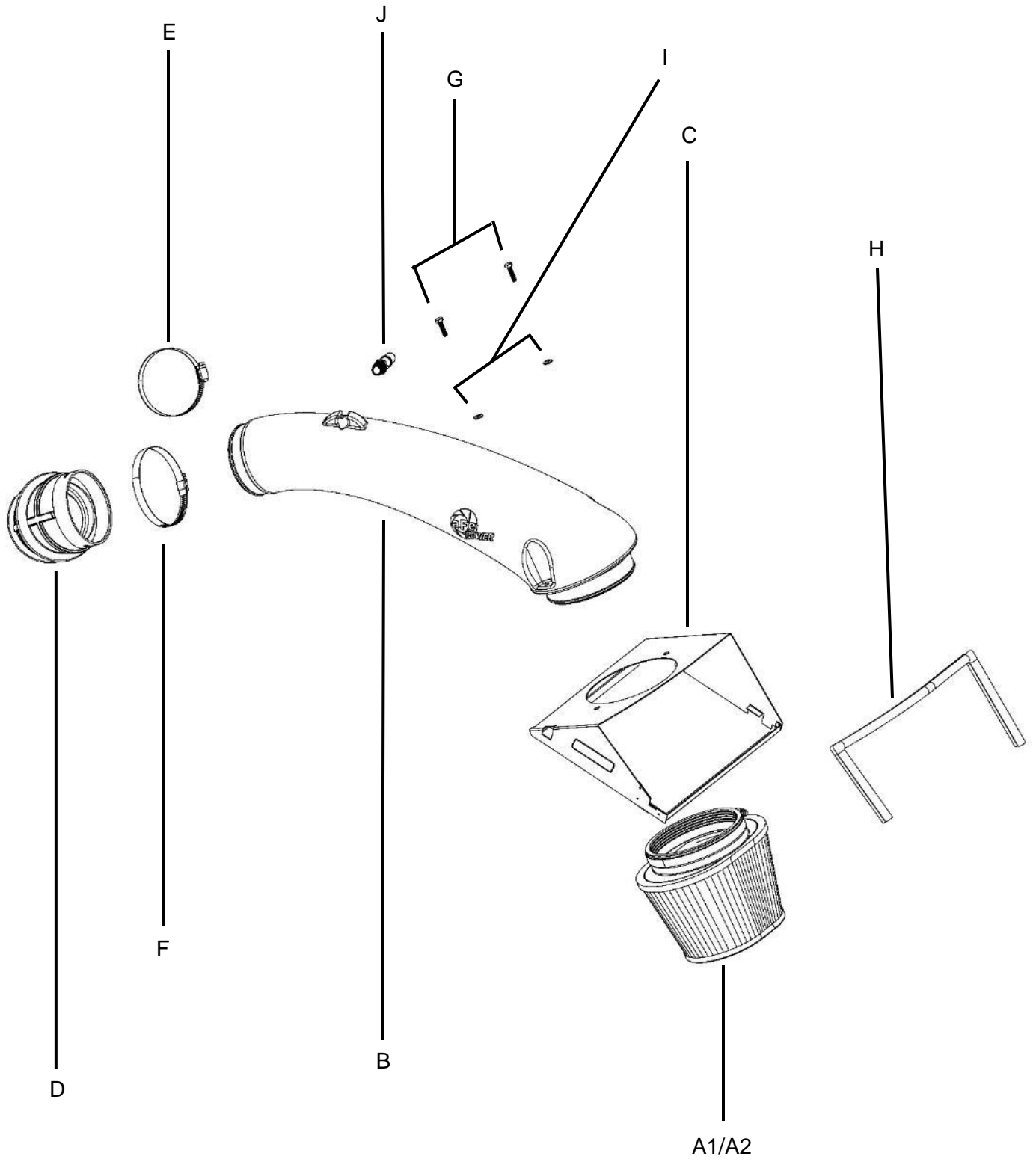



Refer to Figure A for Steps 1-3

Step 1: Loosen the clamp securing the intake tube to the throttle body.

Step 2: Detach the coolant hose from the intake tube.

Step 3: Disconnect the vent hose connected to the intake tube.



Figure B

Refer to Figure B for Steps 4-6

Step 4: Unlatch the two clips securing the air box lid.

Step 5: Remove the air box lid and intake tube from the vehicle.

Step 6: Remove the factory air filter from the air box.

**Figure C****Refer to Figure C for Step 7**

Step 7: Install the NPT fitting onto the aFe POWER tube. This is a NPT connection, do not overtighten it.

The small space between the hex part and the tube is normal.

**Figure D****Refer to Figure D for Steps 8-10**

Step 8: Install the seal trim on the top edge of the aFe POWER housing.

Step 9: Install the aFe POWER tube onto the housing using the provided spring washers and M6 screws.

Make sure the washers are installed in the orientation shown in the picture.

Step 10: Install the air filter onto the tube and tighten the clamp.



Refer to Figure E for Step 11

Step 11: Install the coupling and clamps onto the throttle body, do not tighten clamps yet.



Figure F

Refer to Figure F for Steps 12-13

Step 12: Install the complete assembly into the truck, start with the aFe POWER housing first, and then work the tube into the coupling.

Step 13: Tighten the clamps and secure the aFe POWER housing with the two clips on the airbox.

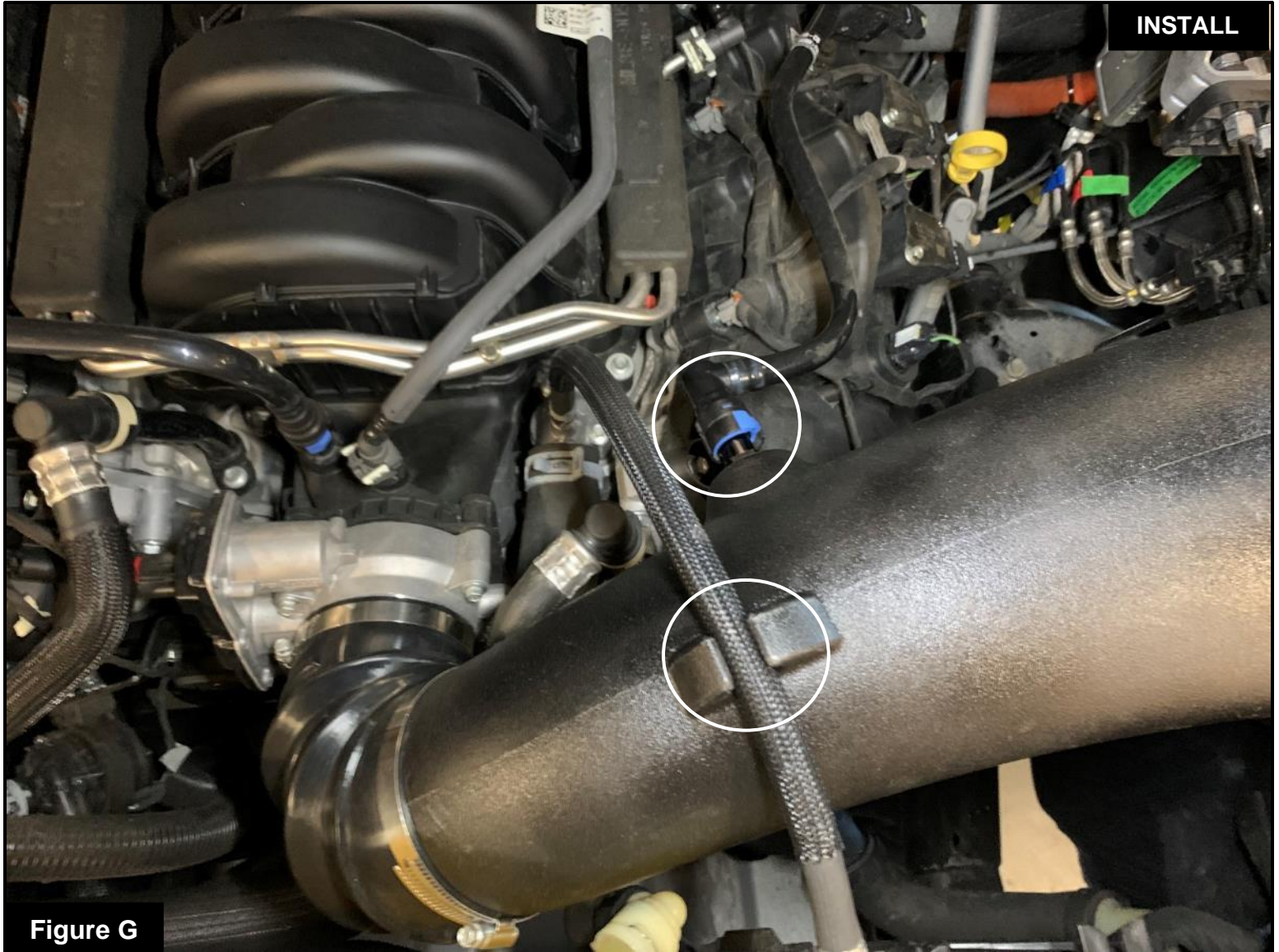

Figure G

Refer to Figure G for Steps 14-15

Step 14: Connect the vent hose to the aFe POWER tube.

Step 15: Attach coolant hose to the aFe POWER tube.

**Figure H****Refer to Figure H for Step 16**

Step 16: Verify all clamps and connections are secured. Your installation is now complete. Thank you for choosing aFe POWER!

Optional DAS Air Scoop P/N: 52-10010S (Black)/SL (Blue)/SR (Red) and Intake Cover P/N: 54-32648-B are available and will work on this Rapid Induction Intake System.



advanced FLOW engineering, Inc.

252 Granite Street Corona, CA 92879

<https://afepower.com/contact>