

MOMENTUMTM HD

advanced FLOW engineering

Cold Air Intake System

Instruction Manual P/N: 50-70070D / 50-70070T

Make: RAM

Model: 1500

Year: 2020-2023

Engine: V6-3.0L (td)



- Please read the entire instruction manual before proceeding.
- Ensure all components listed are present.
- For technical support please call 951-493-7185.
- Ensure you have all necessary tools before proceeding.
- Do not attempt to work on your vehicle when the engine is hot.
- Retain factory parts for future use.

Label	Qty.	Description	Part Number
A1	1	Air Filter (Pro 10R)	20-91147
A2	1	Air Filter (Pro DRY S)	21-91147
B	1	Housing	05-5070070B3
C	1	Tube #2	05-5070070B2
D	1	Tube #1	05-5070070B1
E	1	Coupling, Silicone Elbow	05-01727
F	1	Coupling, Silicone Bellow	05-01726
G	2	Clamp, #048	03-50007
H	1	Mini Clamp, #016	03-50091
J	1	Bolt, M6 x 1 x 25	03-50114
K	1	Flat Washer, M6	03-50070
M	1	Isolator Mount, M6 x 1 x 1	03-50206
N	1	Clamp, T-Bolt (8-5/16" – 8-5/8")	03-50267
P	1	Plug, Silicone	05-01429
Q	2	Clamp, T-Bolt (3-1/16" – 3-3/8")	03-50320
R	2	Screw, M4 x 0.7	03-50491

Installation will require the following tools:

8mm, 10mm, 11mm deep, 13mm deep sockets, socket driver, 6" extension, 1/8" Flathead screwdriver, T20 Torx driver

Warranty Information available at <https://afepower.com/contact#warranty>

Emissions Disclaimer: This product is not currently CARB exempt and is not available for purchase in California or for use on any vehicle registered with the California Department of Motor Vehicles.

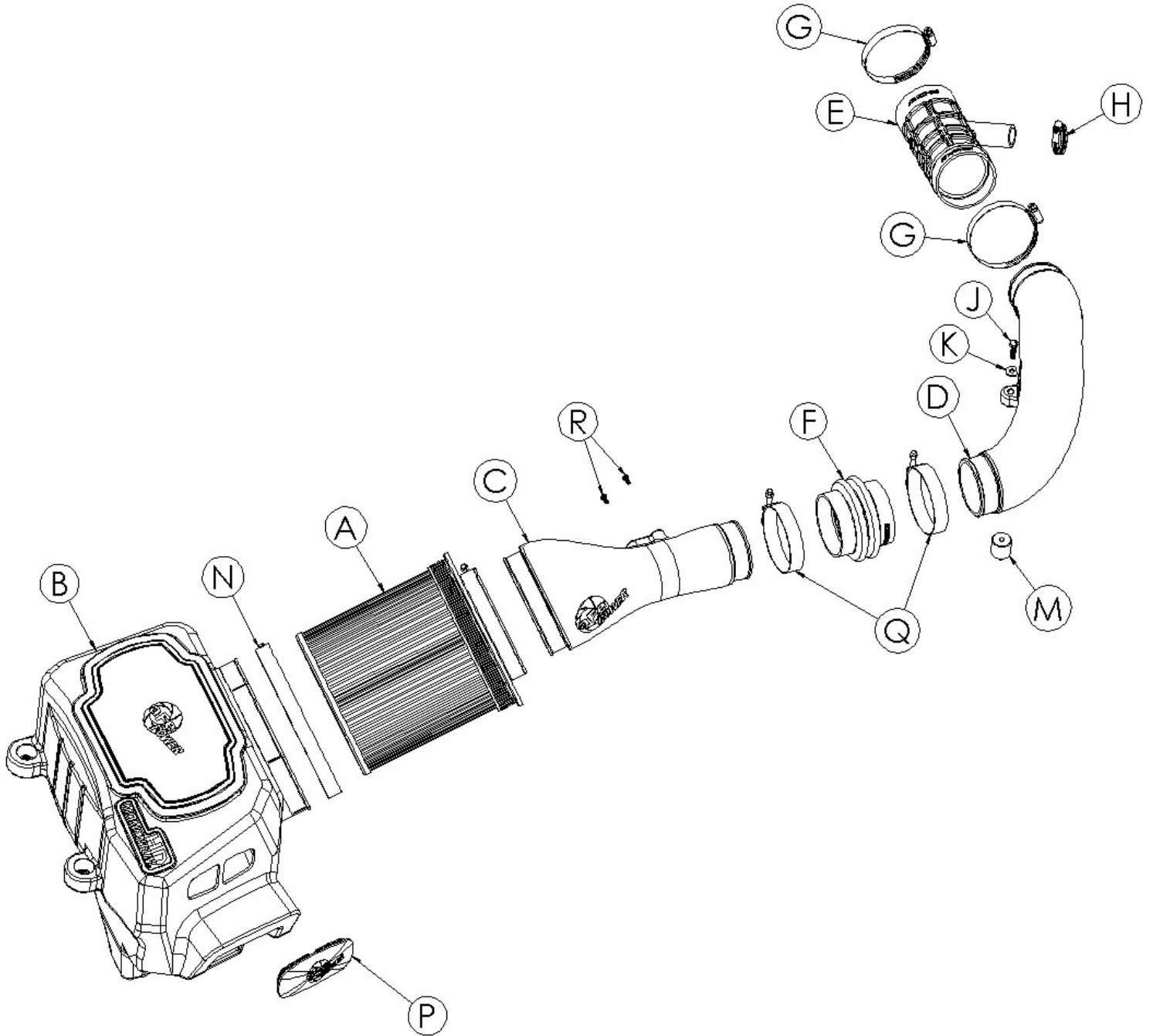

**Figure A****Refer to Figure A for Step 1**

Step 1: Using a 10mm socket and extension, loosen the two (2x) screws ① securing your engine cover to the vehicle, then remove the engine cover.

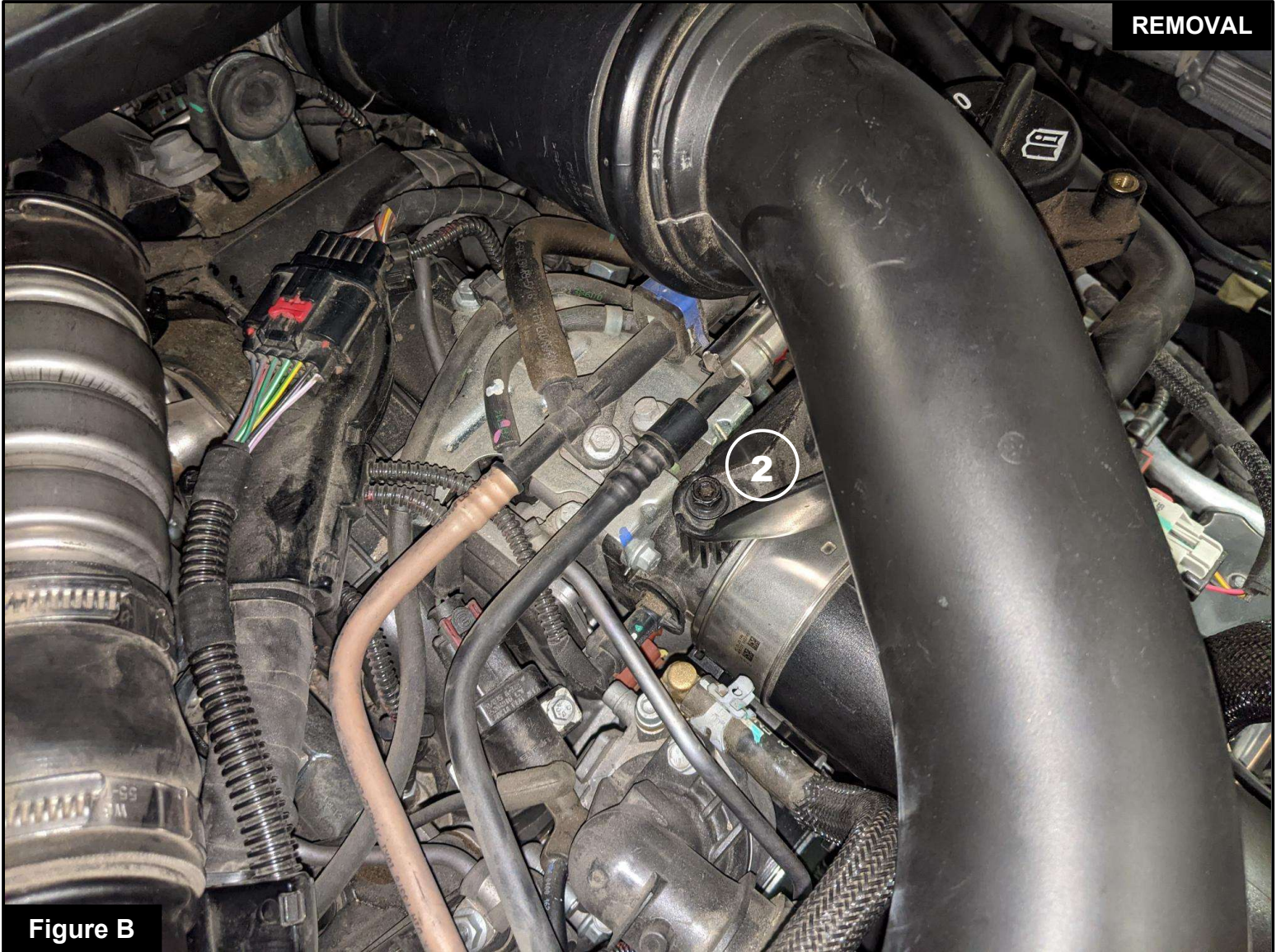
**Figure B****Refer to Figure B for Step 2**

Step 2: Using a 10mm socket and driver, remove the screw ② securing the factory intake tube to the engine inlet.

**Figure C****Refer to Figure C for Steps 3-4**

Step 3: Using a small flathead screwdriver, open the middle pinch clamp ③ on the factory CCV line.

Remove the CCV sensor from the fitting on the factory inlet tube.

Step 4: Using an 8mm socket and driver, loosen the clamp at the factory turbo inlet ④.

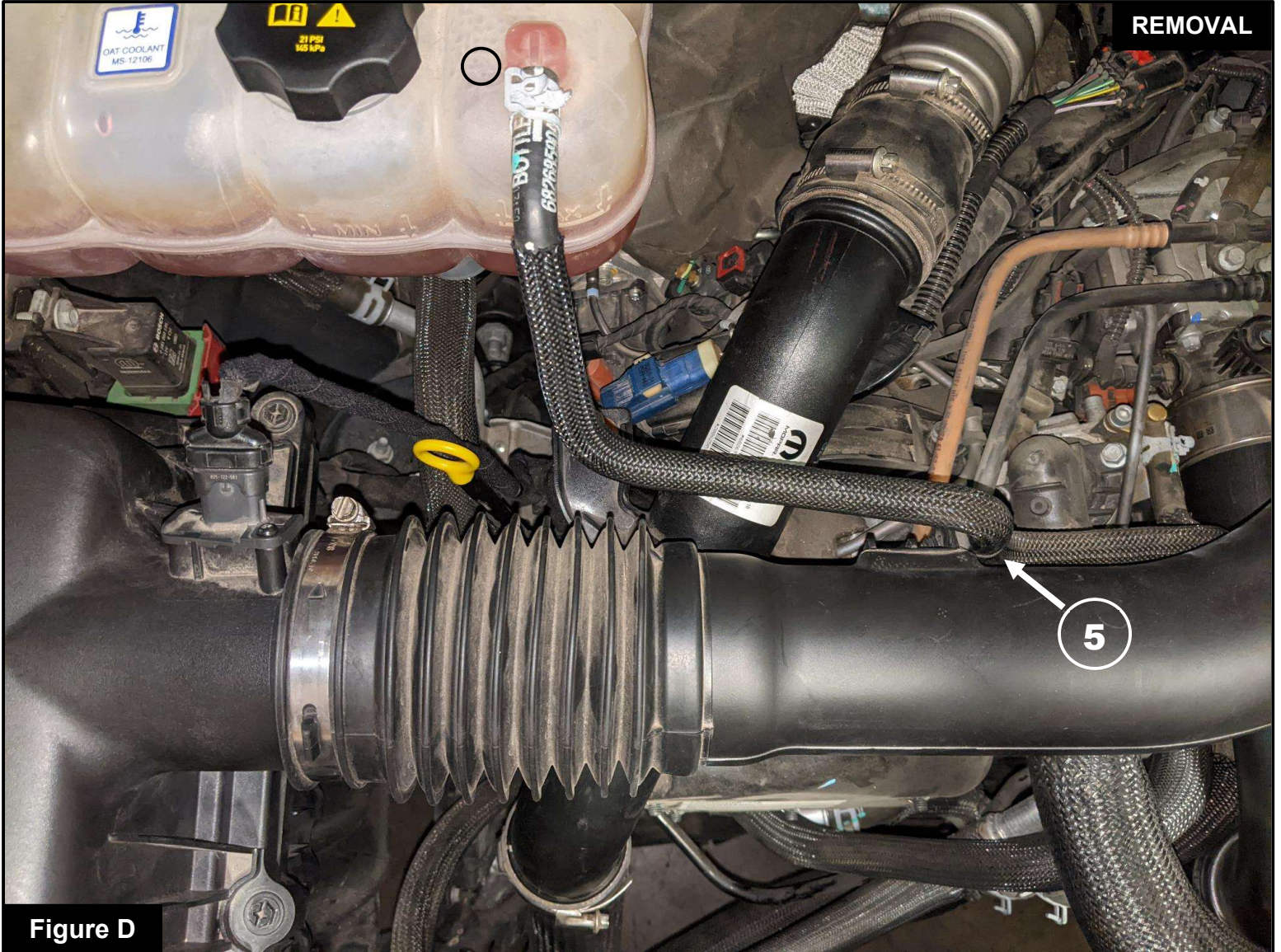

Figure D

Refer to Figure D for Steps 5-6

Step 5: Disconnect the coolant line clip (5) from the factory intake tube.

Step 6: Remove the factory intake tube from the vehicle by pulling straight up off the rubber grommet securing it to the factory turbo charge pipe.

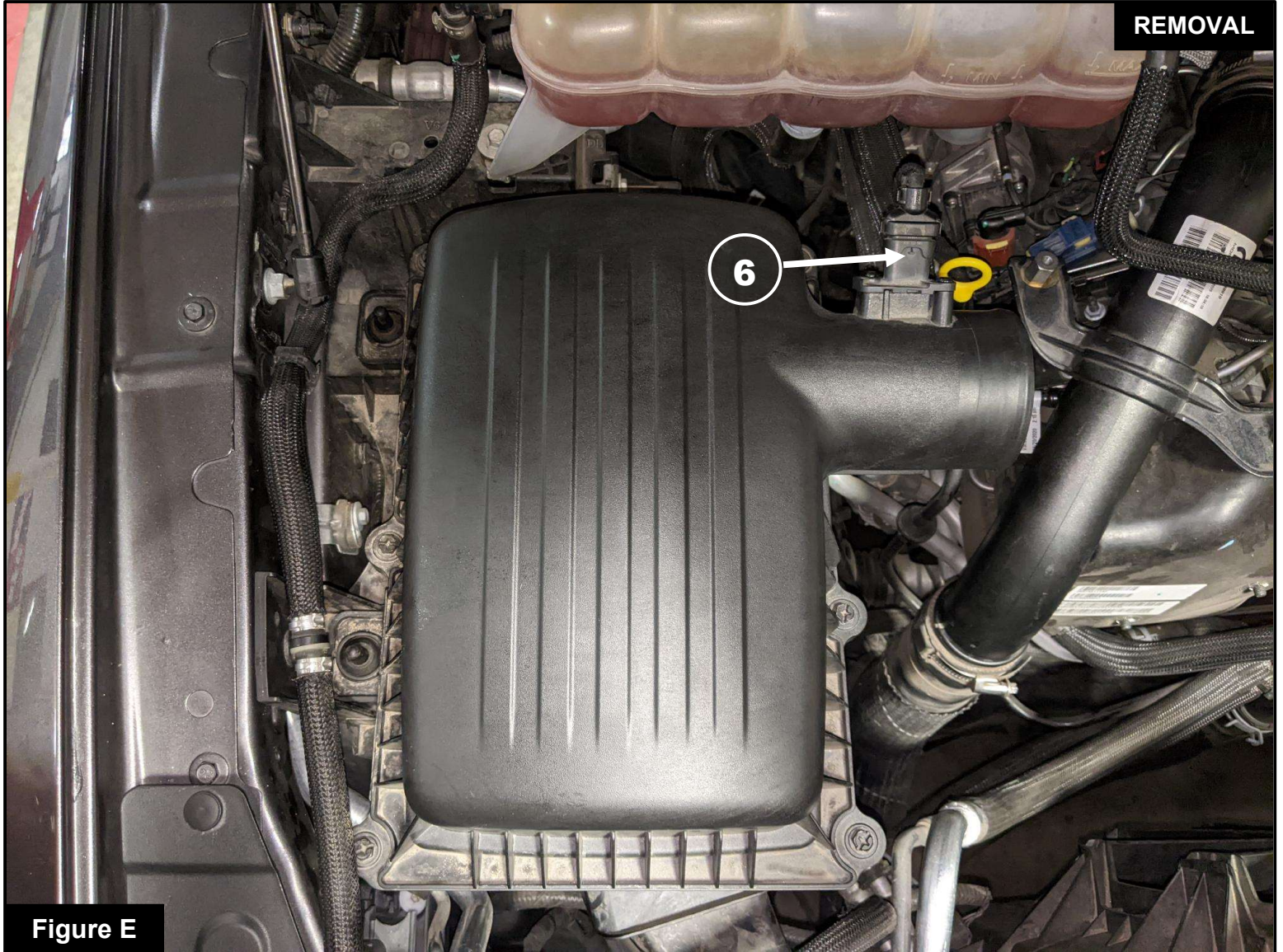

Figure E

Refer to Figure E for Steps 7-8

Step 7: Disconnect the Mass Airflow (MAF) sensor wire harness (6).

Step 8: Remove the factory airbox by pulling straight up off the four (4x) mounting grommets.

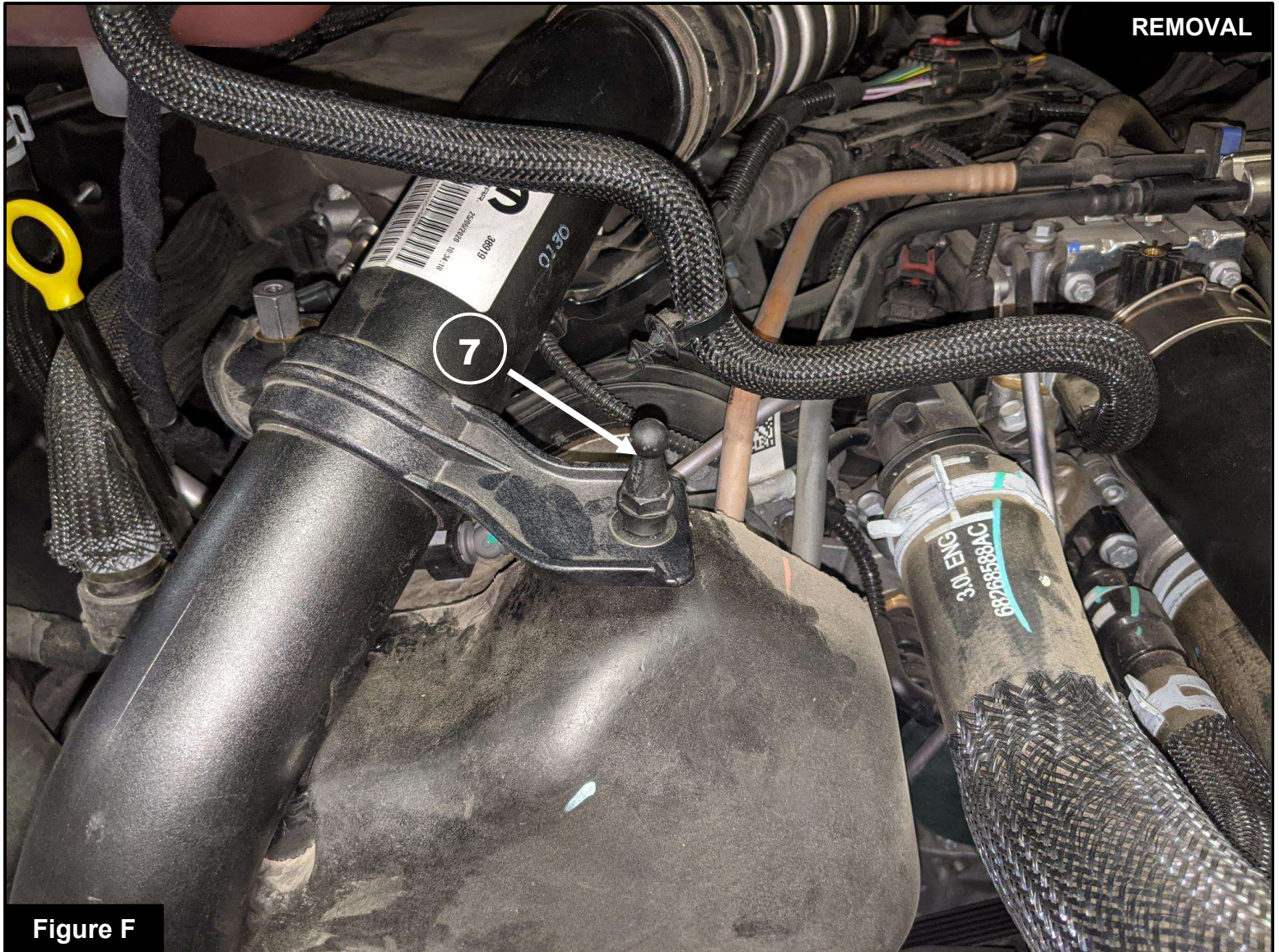

Figure F

Refer to Figure F for Step 9

Step 9: Using a 13mm deep socket and driver, remove the factory mounting stud (7) located on the factory turbo chargepipe.



Figure G

Refer to Figure G for Step 10

Step 10: Transfer three (3x) of the mounting grommets (8) from the factory airbox to your aFe POWER filter housing as shown. Leave the front upper mounting location open.

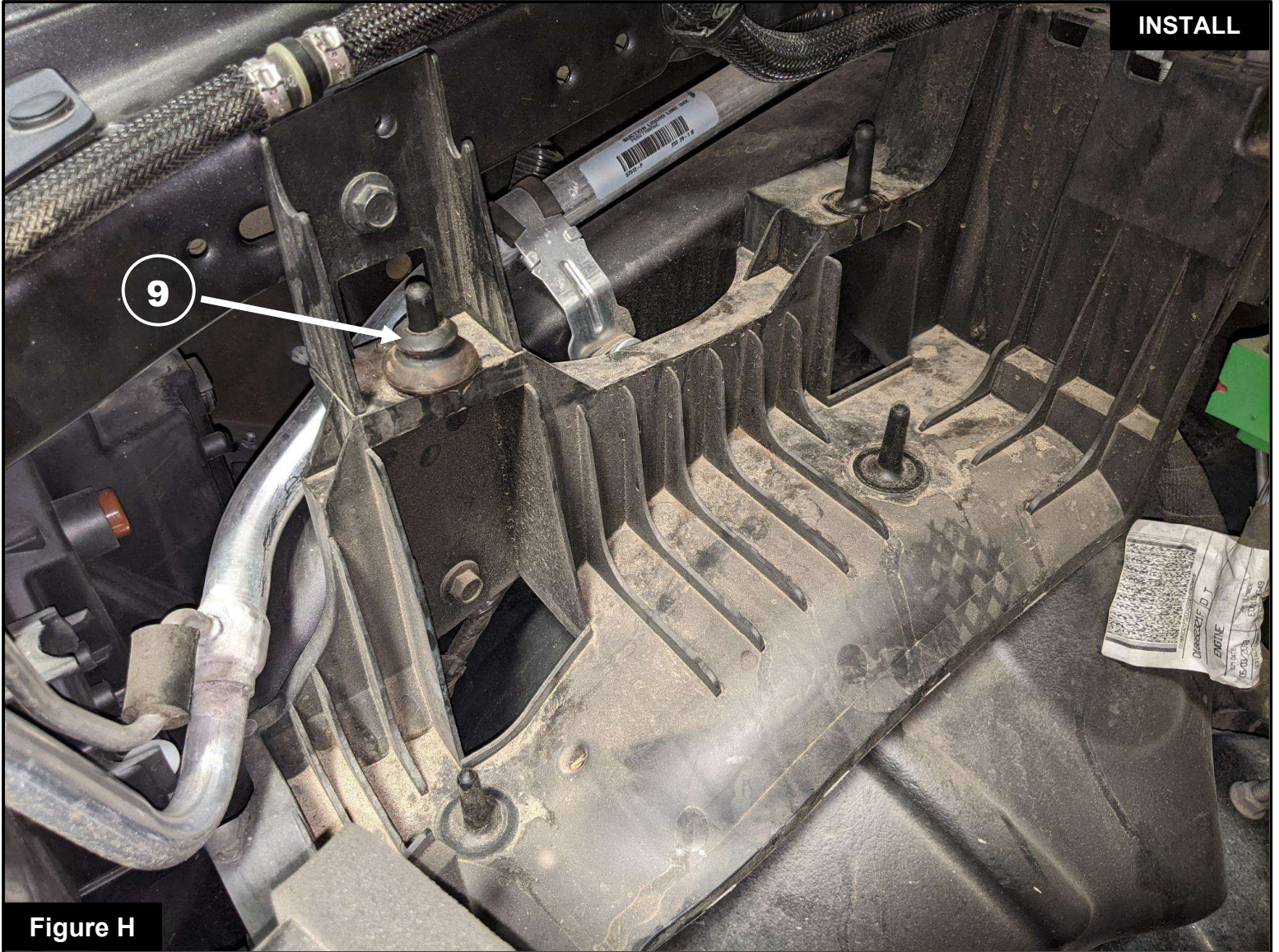
**Figure H****Refer to Figure H for Step 11**

Step 11: Install the remaining OE grommet ⑨ onto the upper front mounting location in the vehicle.



Figure I

Refer to Figure I for Steps 12-13

Step 12: Install your aFe POWER housing ⑩ into the vehicle by lining up the four (4x) mounting points, and pressing firmly to full seat the housing.

Step 13: Install your aFe POWER air filter into the filter housing along with the largest supplied T-Bolt clamp. Leave all clamps loose

**Figure J****Refer to Figure J for Step 14**

Step 14: Install the supplied angled coupling (11) and two (2x) #048 worm gear clamps (12) onto the turbo inlet with the coupling port facing towards the drivers side fender as shown. Leave both clamps loose.

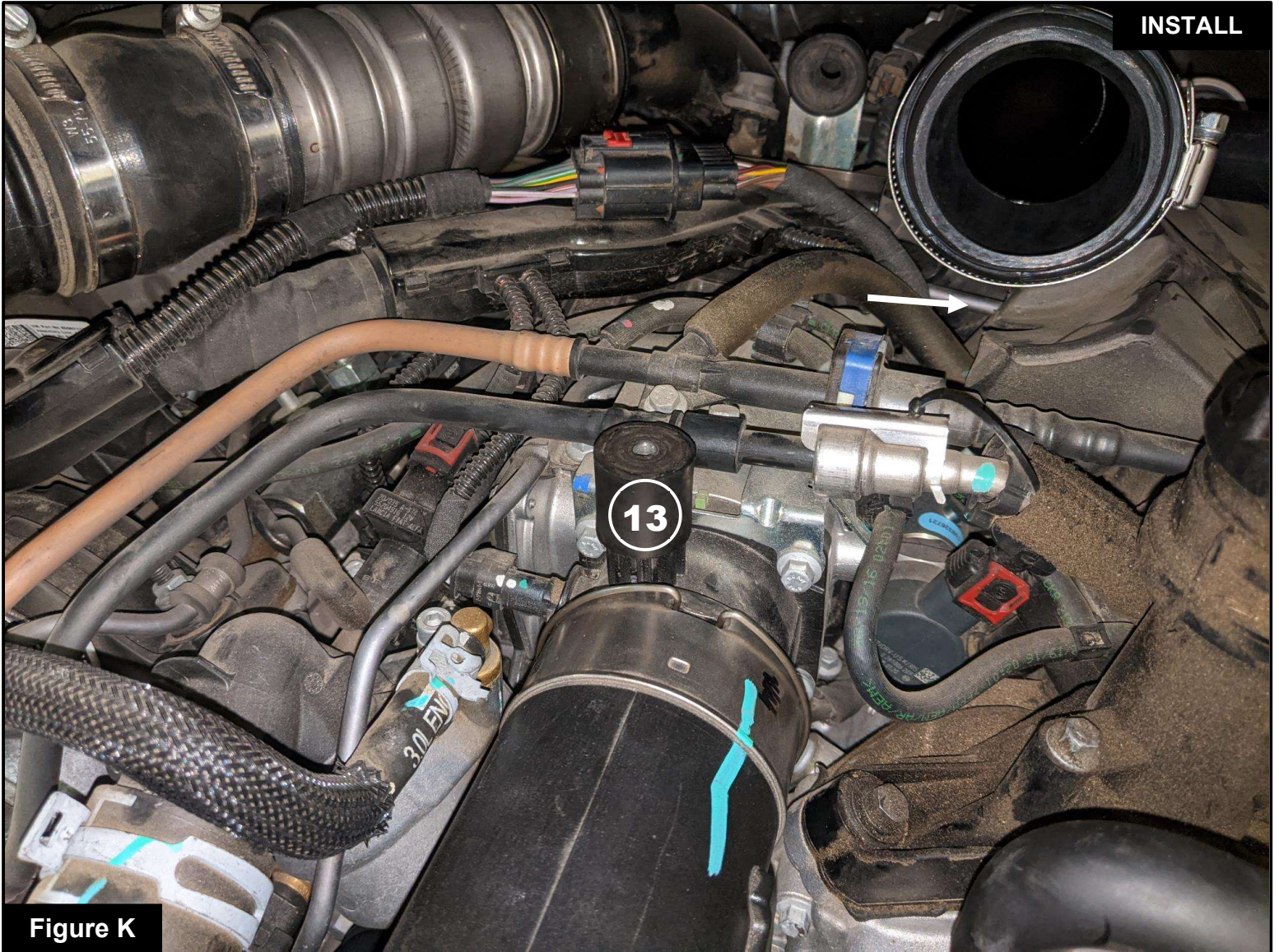

Figure K

Refer to Figure K for Step 15

Step 15: Install the supplied M6 Isolator mount (13) into the mounting location on the engine inlet. Hand tighten.



Figure L

Refer to Figure L for Steps 16-17

Step 16: Install the angled aFe POWER tube (14) with the aFe POWER logo near the turbo inlet. Line up the mounting leg with the isolator mount, and rotate the coupler at the turbo inlet for alignment.

Step 17: Secure the tube to the isolator mount using the supplied M6 screw and flat washer (15). Tighten using a 10mm socket and extension.

**Figure M****Refer to Figure M for Step 18**

Step 18: Install the supplied #016 mini clamp (16) onto the open port on the turbo inlet coupler, then press the CCV fitting into the port. Tighten the clamp using a small flathead screwdriver.

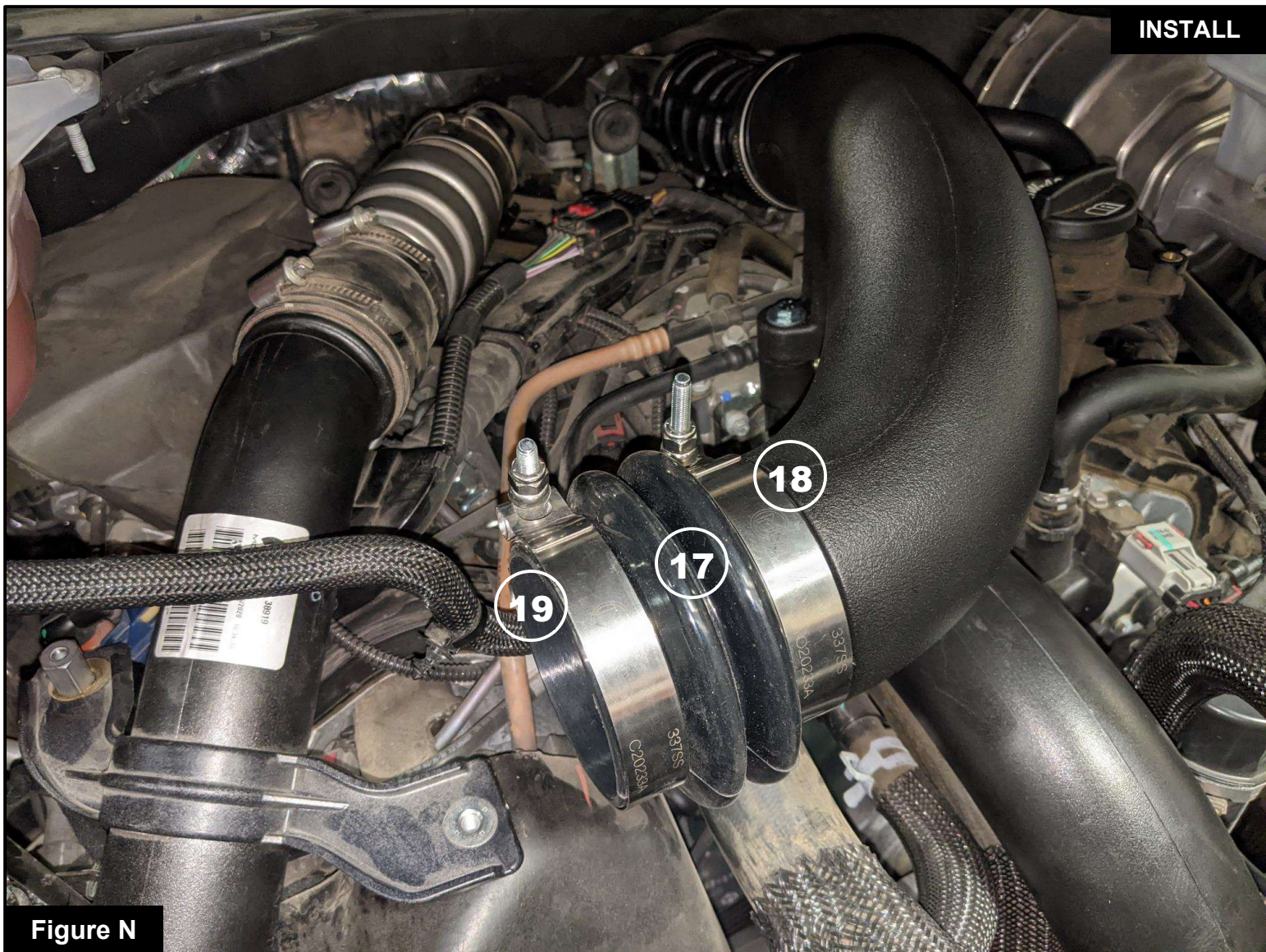
**Figure N****Refer to Figure N for Steps 19-20**

Step 19: Install the supplied bellows coupling (17) and one remaining T-Bolt clamp (18) onto the open end of the installed intake tube. Tighten the clamp using an 11mm deep socket and driver.

Step 20: Place the remaining T-Bolt clamp (19) loosely on the open end of the coupling.

**Figure O****Refer to Figure O for Step 21**

Step 21: Transfer the Mass Airflow (MAF) sensor ②① from the top of the factory airbox to the shorter aFe POWER air intake tube. Secure the sensor using the supplied M4 screws ②①. Tighten using a T20 Torx driver.

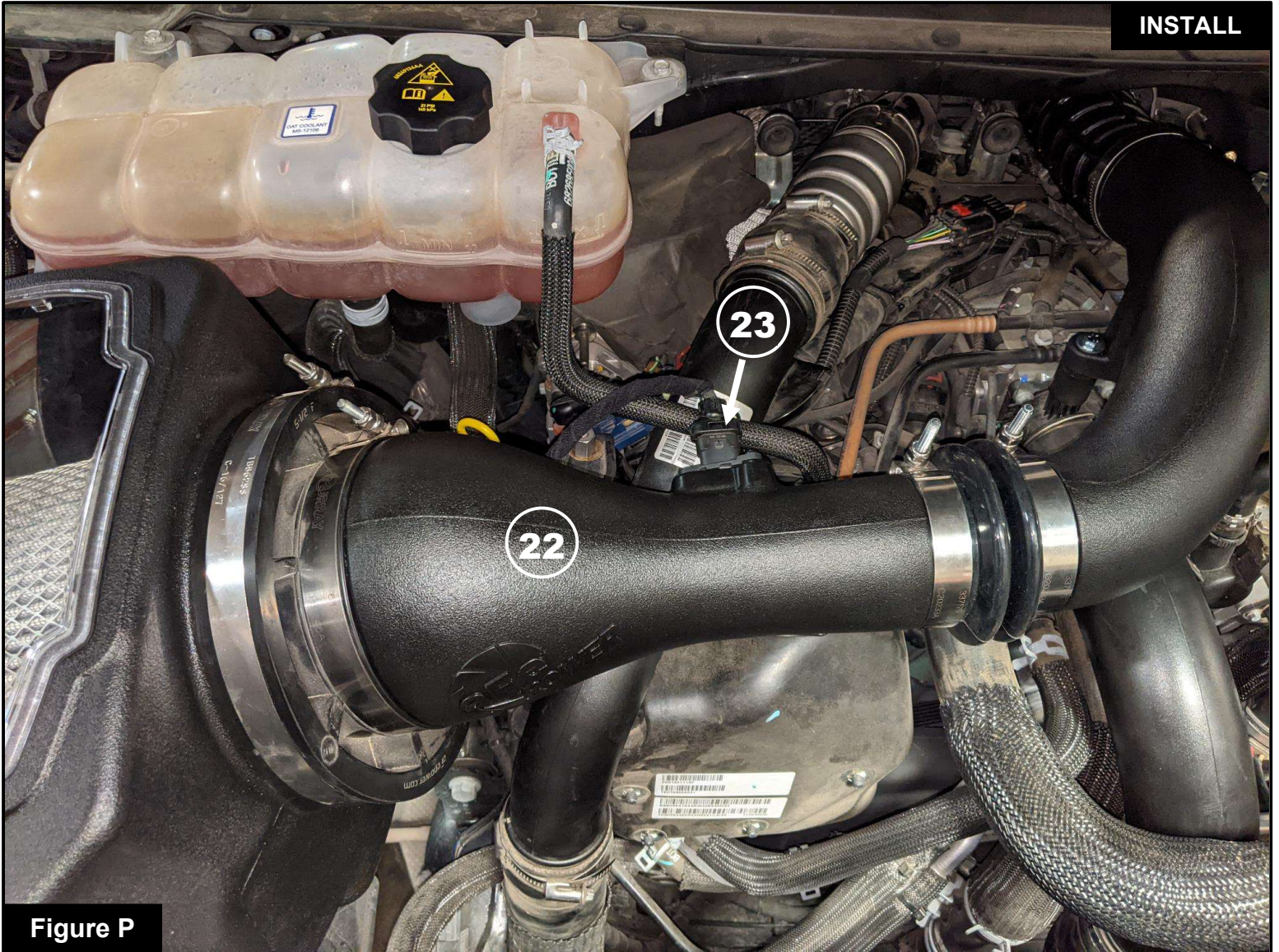
Figure P

Refer to Figure P for Steps 22-23

Step 22: Install the shorter intake tube with MAF sensor (22) first into the open end of the bellows coupler installed in step #19, then into the air filter. Tighten both clamps using an 11mm deep socket and driver.

Step 23: Reconnect the MAF sensor wire harness (23).

**Figure Q****Refer to Figure Q for Step 24**

Step 24: Reinstall the engine cover. Tighten both screws ②4 using a 10mm socket and extension.

**Figure R****Refer to Figure R for Step 25**

Step 25: (Optional) Install the supplied silicone inlet plug (25) if you wish to fully seal your aFe POWER intake system. Best airflow is obtained with the plug removed. Your installation is now complete. Thank you for choosing aFe POWER!

NOTE: Check all screws, clamps, and connectors are secure after 100-200 miles.



PAGE LEFT BLANK INTENTIONALLY



PAGE LEFT BLANK INTENTIONALLY



advanced FLOW engineering, inc.

Corona, CA 92879

<https://afepower.com/contact>