

**MOMENTUM** *GT*

***advanced FLOW engineering***

**Momentum GT Air Intake System**

**Instruction Manual P/N: 50-70113D / 50-70113R**

Make: CHEVROLET

Model: COLORADO

Year: 2023-2024

Engine: L4-2.7L(t)

Make: GMC

Model: CANYON

Year: 2023-2024

Engine: L4-2.7L(t)



- Please read the entire instruction manual before proceeding.
- Ensure all components listed are present.
- If you are missing any of the components, call customer support at 951-493-7185.
- Ensure you have all necessary tools before proceeding.
- Do not attempt to work on your vehicle when the engine is hot.
- Retain factory parts for future use.

| Label | Qty. | Description                                     | Part Number  |
|-------|------|---|--------------|
| A     | 1    | Air Filter, P5R (For 50-70113R Only)            | 24-91092     |
| A     | 1    | Air Filter, PDS (For 50-70113D Only)            | 21-91092     |
| B     | 1    | Tube, 1 of 2 (With aFe POWER logo Engraved)     | 05-5070113B1 |
| C     | 1    | Tube, 2 of 2 (With MAF Sensor Pad)              | 05-5070113B2 |
| D     | 1    | Housing With Clear Sight Window                 | 05-5070113B3 |
| E     | 1    | Coupling, Silicone Bellow: 3-3/4"ID x 3"L       | 05-01509     |
| F     | 1    | Coupling, Silicone Elbow: 2.50"x 3.50" x 90 Deg | 05-01758     |
| G     | 1    | Plug, Silicone                                  | 05-01429     |
| H     | 2    | Clamp, 060 (3-5/16" - 4-1/4")                   | 03-50002     |
| J     | 1    | Clamp, 056 (3-1/16" - 4 ")                      | 03-50009     |
| K     | 1    | Clamp, 044 (2-5/16" - 3-1/4")                   | 03-50019     |
| M     | 2    | Grommet, Rubber                                 | 03-50076     |
| N     | 2    | Spacer, Aluminum: 7/16" x 1/2"                  | 03-50772     |
| P     | 1    | Fitting, Vent Tube                              | 05-01692     |
| Q     | 2    | Screw, Torx: M4 x .7 x 10mm                     | 03-50490     |
| R     | 1    | Cable tie                                       | 05-60167     |

**Installation will require the following tools:** T20 and T30 Torx bits/drivers, 7mm, 8mm, 10mm and 11mm nut drivers/sockets and ratchet, trim removal tool, 15mm wrench or adjustable wrench

Warranty Information available at <https://afepower.com/contact#warranty>

**Emissions Disclaimer:** This product is not currently CARB exempt and is not available for purchase in California or for use on any vehicle registered with the California Department of Motor Vehicles.

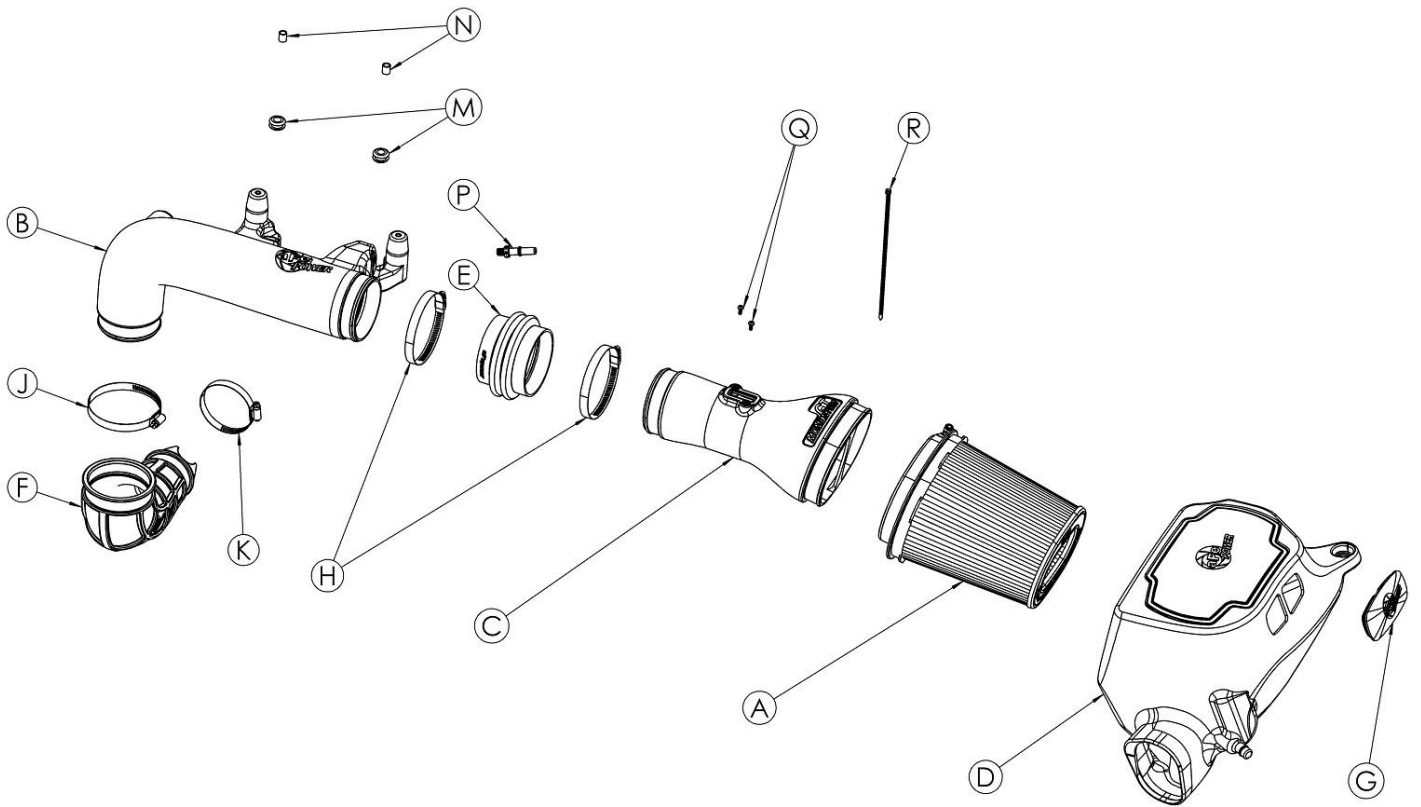



**Figure A**

## **Refer to Figure A for Step 1**

Step 1: Using a T30 Torx driver, remove the two screws securing the engine cover. Save them for later use as the engine cover will be reinstalled with those screws.



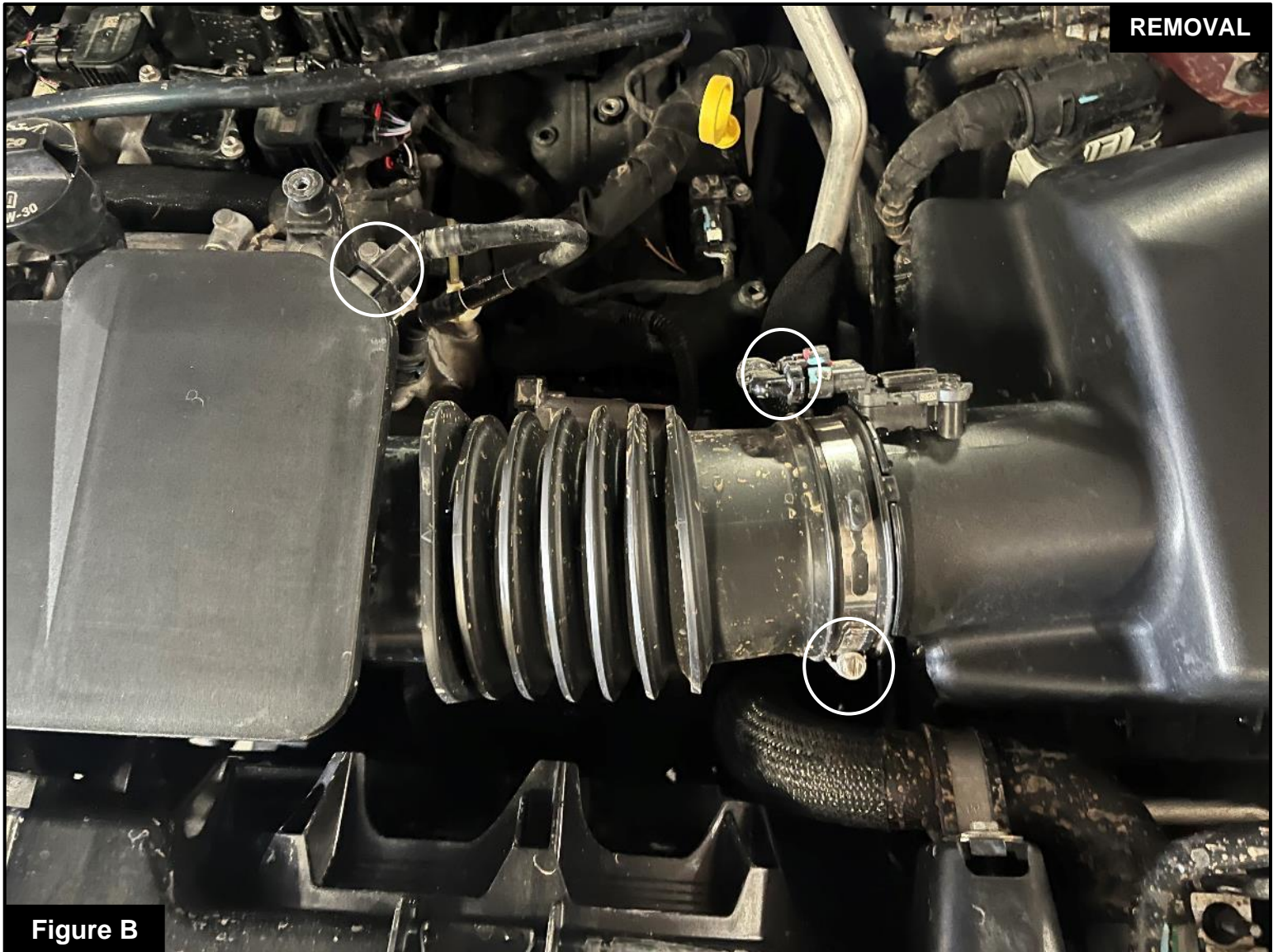

Figure B

**Refer to Figure B for Steps 2-4**

Step 2: Disconnect the harness from the Mass Air Flow (MAF) sensor.

Step 3: Disconnect the quick disconnect fitting by pressing on the grey tab and pulling it out.

Step 4: Using a 7mm driver, loosen the clamp between the factory tube and factory housing.

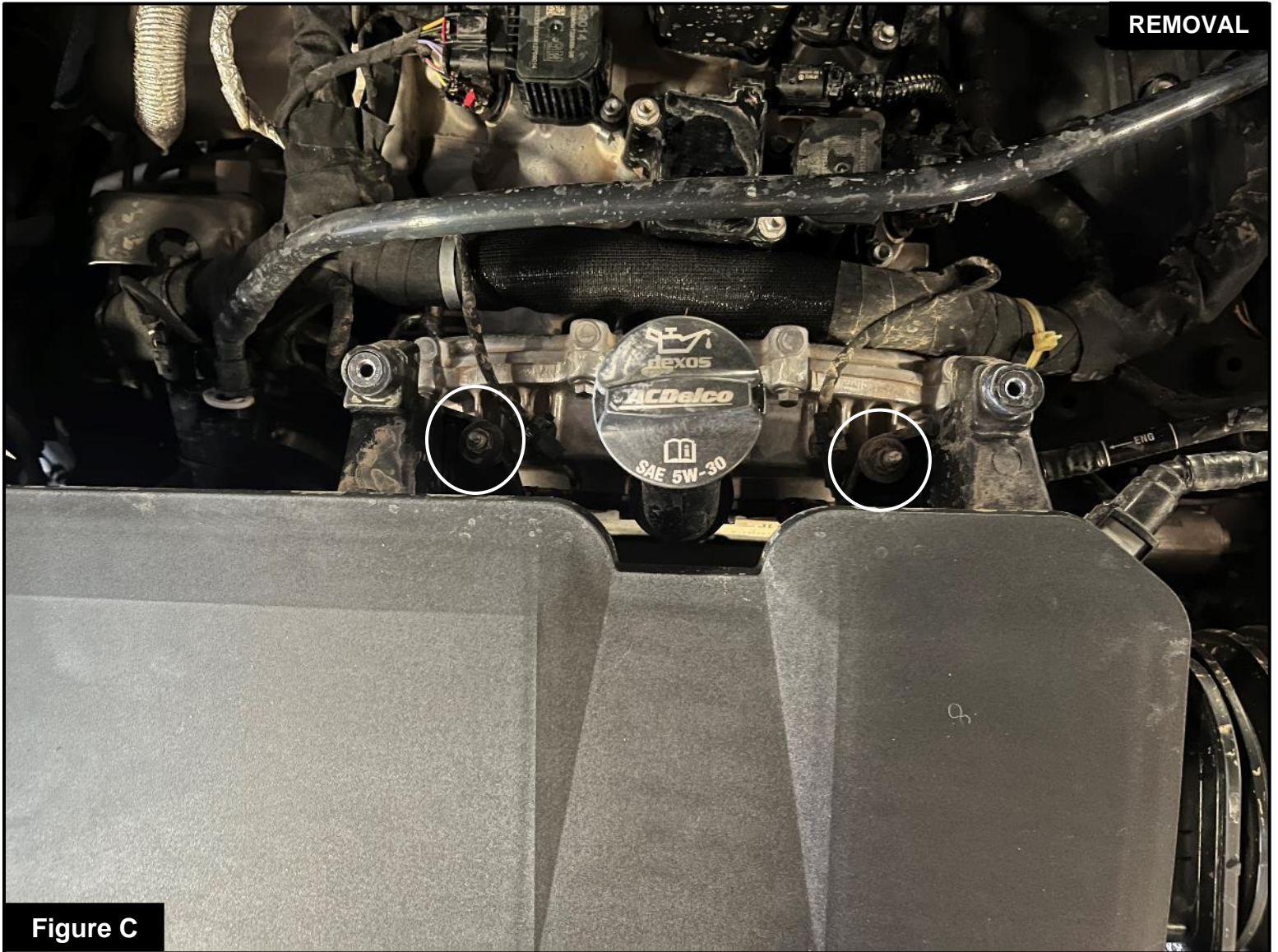
**Figure C****Refer to Figure C for Step 5**

Step 5: With a 10mm socket and extension, remove the two nuts securing the tube to the engine. Those nuts will be reused to secure the aFe POWER tube.





**Figure D**

**Refer to Figure D for Steps 6-9**

Step 6: Disconnect the quick-disconnect fitting by pressing on the grey tab.

Step 7: Disconnect the electrical connector going to the purge valve.

Step 8: Using a 7mm driver, loosen the clamp connecting the factory intake tube to the turbo.

Step 9: Pull the tube out of the vehicle.



Figure E

**Refer to Figure E for Step 10**

Step 10: Using an 8mm driver, untighten the three screws securing the top half of the factory airbox to the bottom half.



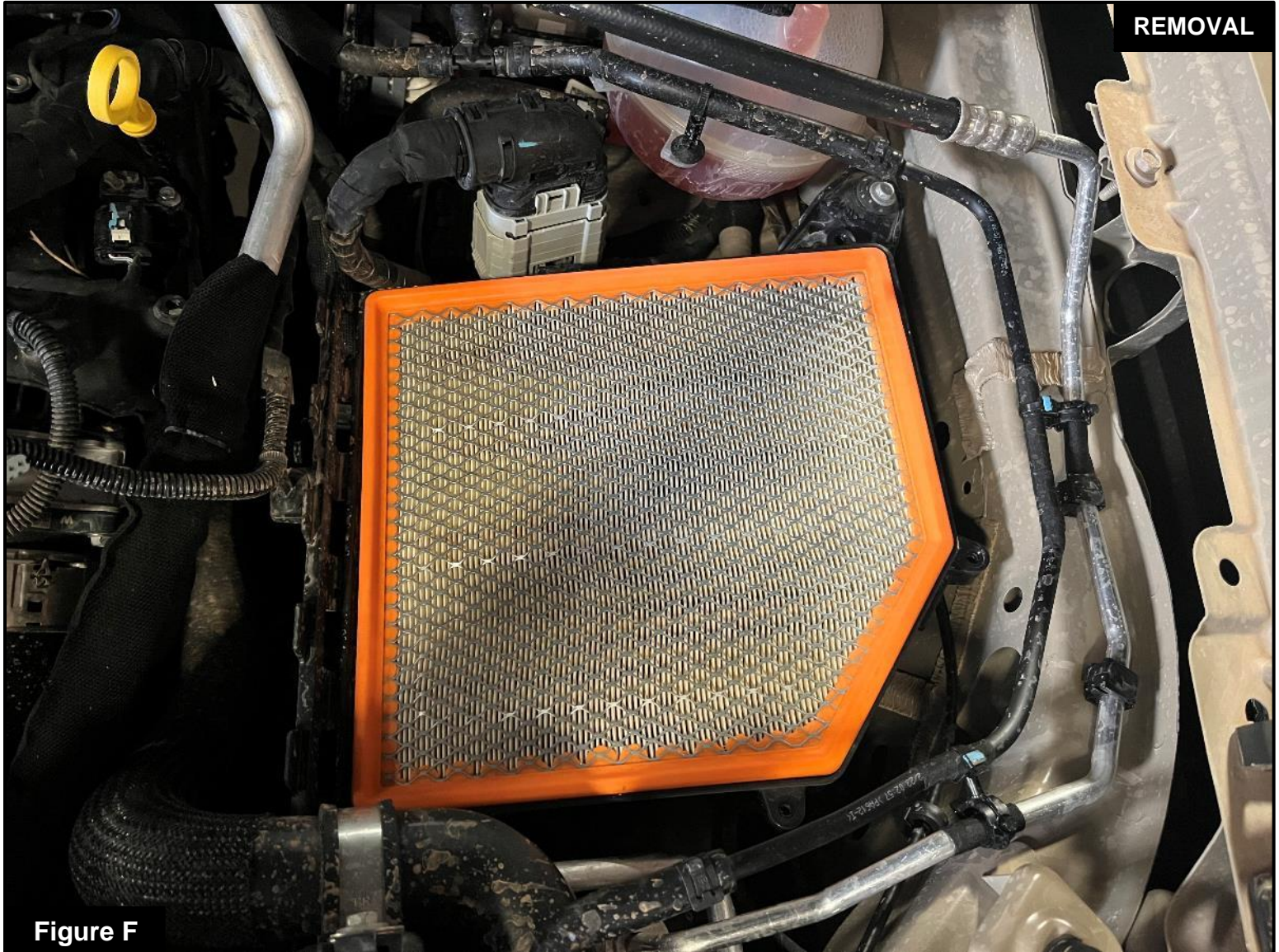
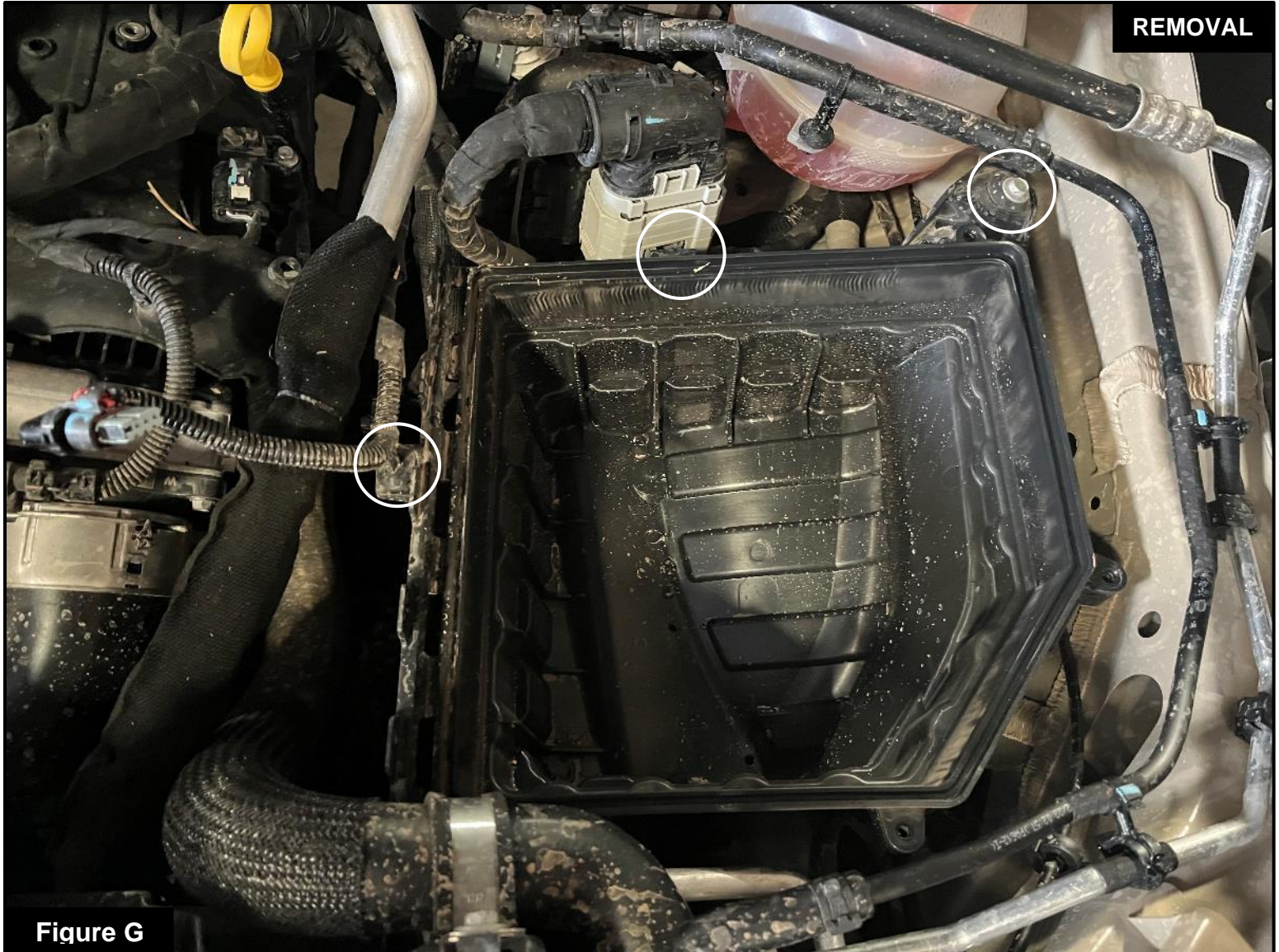

Figure F

**Refer to Figure F for Step 11**

Step 11: Remove the top half of the factory airbox and remove the air filter.





**Figure G**

**Refer to Figure G for Steps 12-15**

Step 12: Unclip the MAF harness from the the factory airbox.

Step 13: Unclip the connector mounted on the back of the factory airbox.

Step 14: Remove the 10mm screw securing the factory airbox. It will be reused to secure the aFe POWER housing.

Step 15: Remove the factory airbox out of the vehicle.



**Figure H****Refer to Figure H for Step 16**

Step 16: Using a 10mm socket or driver, carefully remove the purge valve from the factory intake tube and install it onto the aFe POWER intake tube. Secure it with the factory screw.



**Figure I****Refer to Figure I for Steps 17-18**

Step 17: Using an adjustable wrench or a 15mm wrench, install the supplied black aluminum fitting into the NPT insert on the tube. For NPT fittings, it is normal to have a small gap between the 16mm hex and the tube.

Step 18: Install the two supplied grommets and metal inserts onto the mounts on the tube. Place the grommets into the mounts first, then push the metal inserts into them.



**Figure J****Refer to Figure J for Step 19**

Step 19: Using a T20 Torx driver, remove the MAF sensor from the factory housing and install it into the aFe POWER intake tube using the supplied M4 screws.

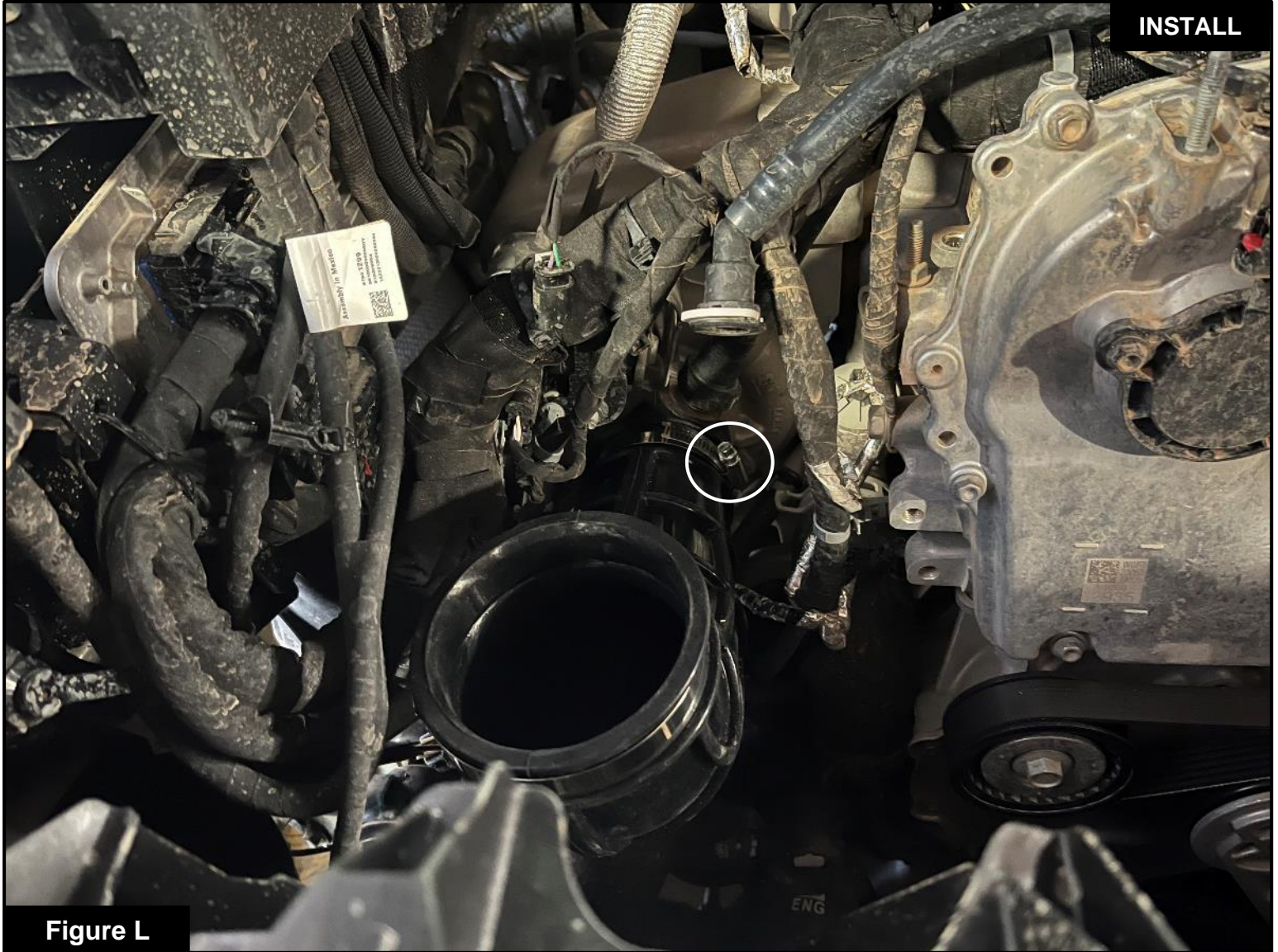

**Figure K****Refer to Figure K for Steps 20-21**

Step 20: Transfer the grommet from the factory housing to the aFe POWER housing.

Step 21: Remove the metal insert and grommet from the factory housing and install them onto the mount on the aFe POWER housing.





**Figure L**

**Refer to Figure L for Steps 22-23**

Step 22: Place the two smaller clamps onto the coupling.

Step 23: Install the coupling over the turbo and align it with the feature on the turbo. Tighten clamp at the turbo.





Figure M

**Refer to Figure M for Steps 24-28**

- Step 24: Install the longer aFe POWER tube into the coupling, making sure that the two studs on the engine go into the holes on the tube.
- Step 25: Secure the tube onto the two studs with the two nuts removed in step 5.
- Step 26: Reconnect the electrical connector to the purge valve.
- Step 27: Reconnect the quick-disconnect connector to the purge valve.
- Step 28: Tighten the clamp between the coupling and tube.





**Figure N**

**Refer to Figure N for Steps 30-31**

Step 30: Reconnect the quick-disconnect fitting to the aluminum fitting on the aFe POWER tube.

Step 31: Place the bellows coupling with the clamps at the end of the aFe POWER tube. Only tighten the clamp on the aFe POWER tube side at this time.

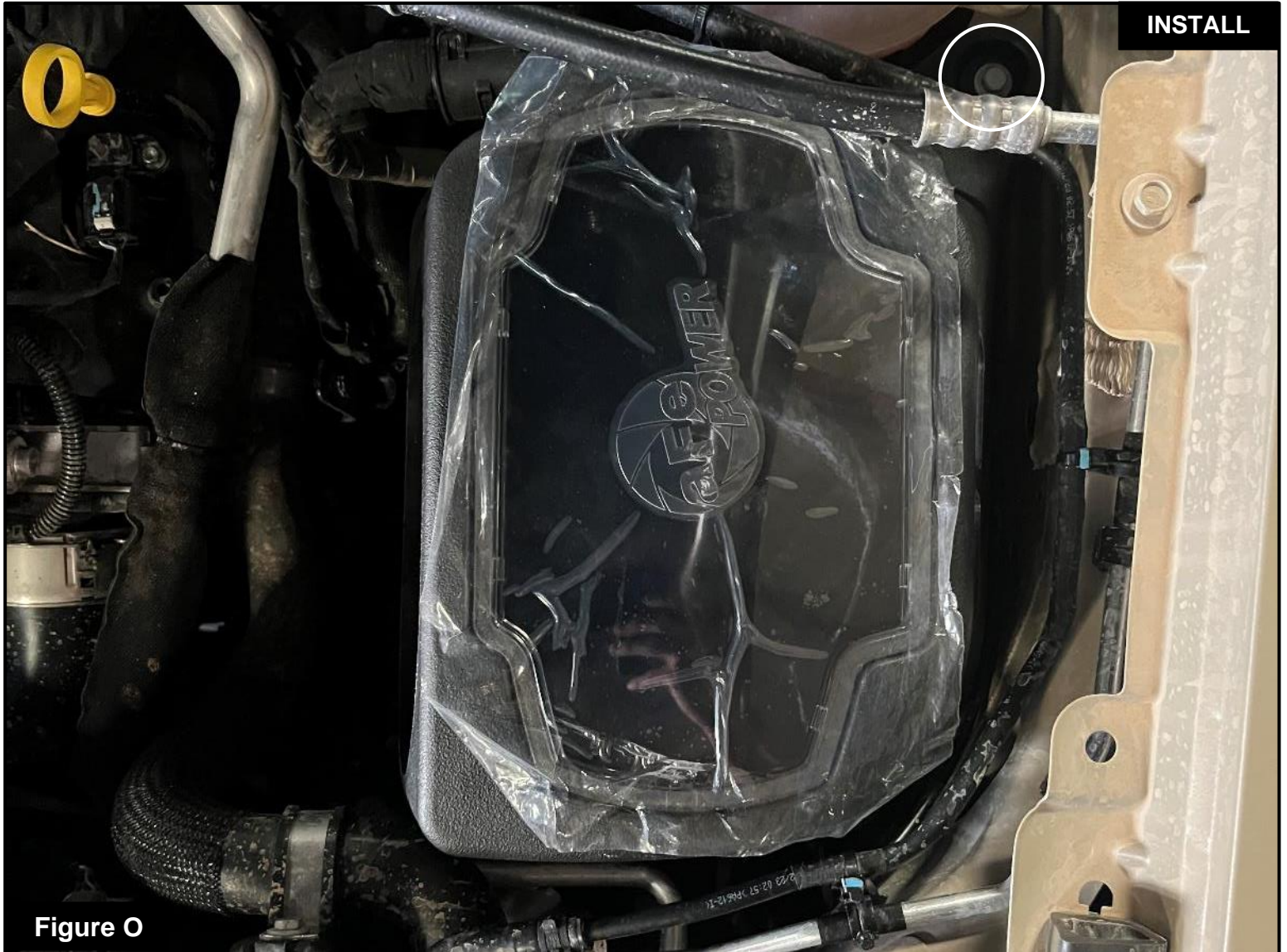

Figure O

**Refer to Figure O for Steps 32-34**

Step 32: Install the aFe POWER housing into the engine bay. Direct the inlet of the housing into the engine bay, then rotate it into place.

Step 33: Make sure that the housing peg at the bottom goes into the grommet on in the engine bay, and that the side grommet goes into the slot opening.

Step 34: Secure the housing with the screw removed in step 14.



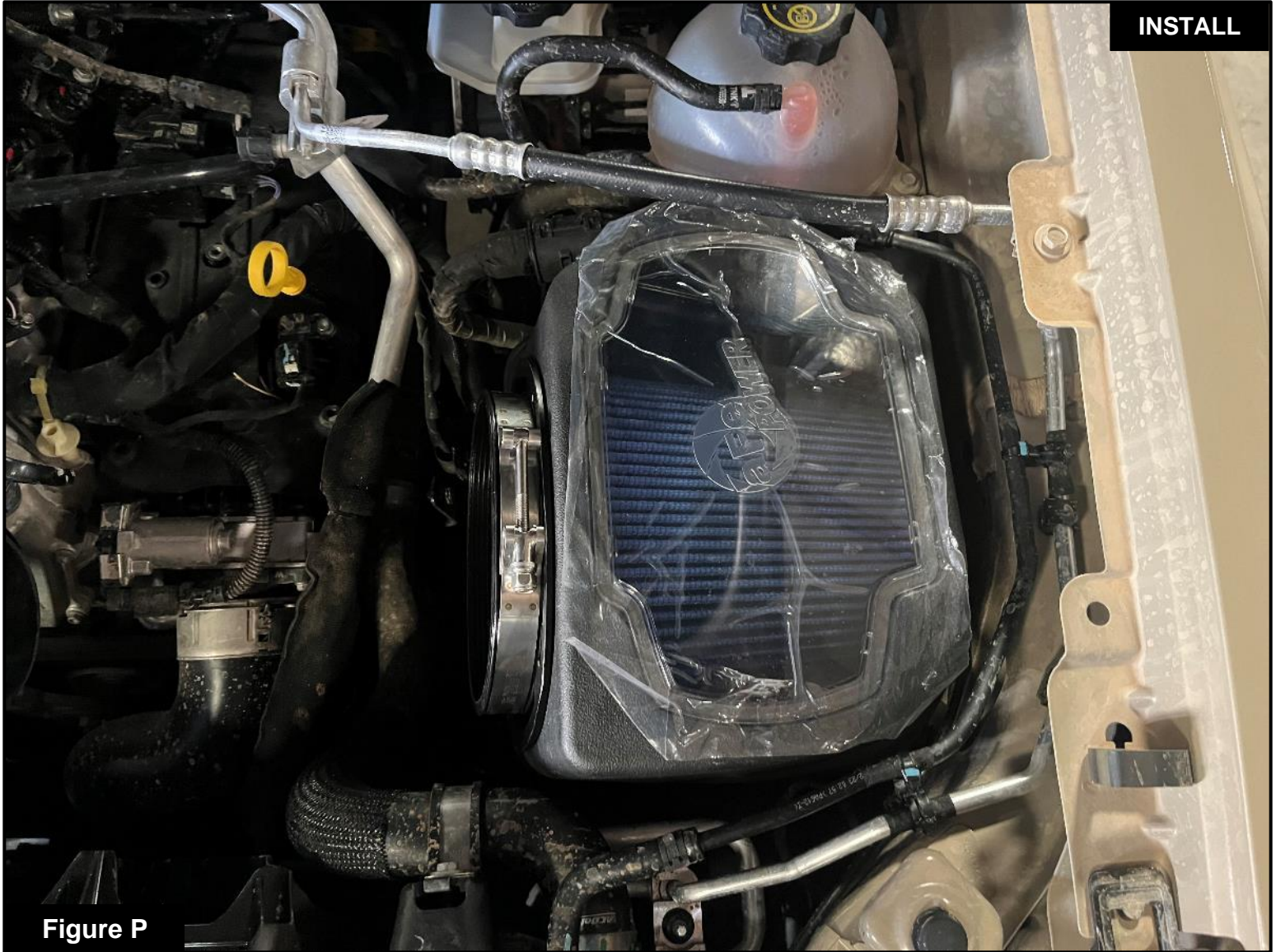

**Figure P**

**Refer to Figure P for Steps 35-36**

Step 35: Mount the connector (removed in step 13) into the slot on the back of the aFe POWER housing.

Step 36: Install the air filter into the housing by firmly pushing it into the housing until the filter tabs lock it into place. Install the clamp onto the air filter, but do not tighten at this time.



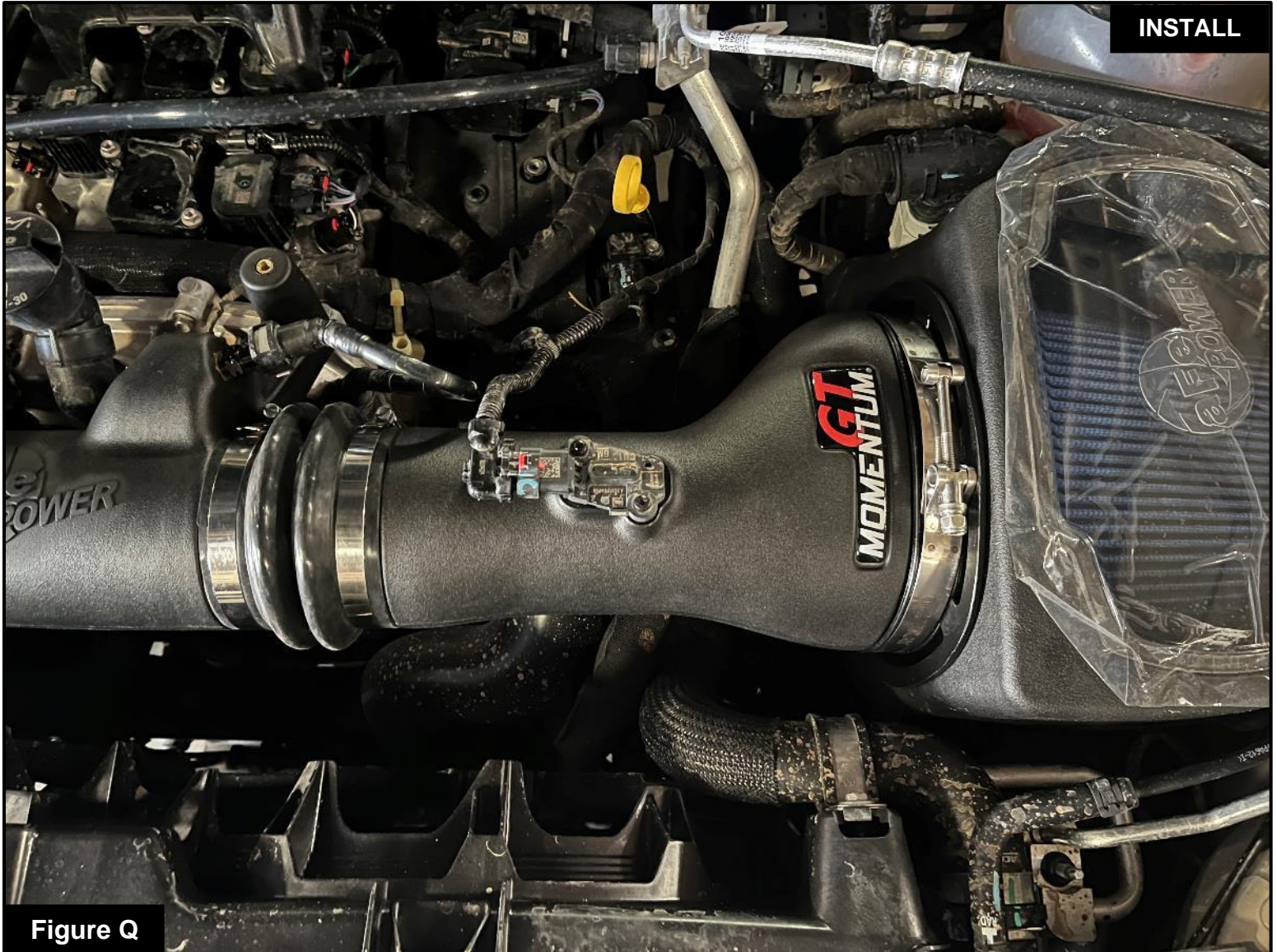

**Refer to Figure Q for Steps 37-39**

Step 37: Install the short aFE POWER tube by sliding it into the air filter opening, then into the bellows coupling.

Step 38: Align the tube, coupling, and air filter, then tighten all clamps.

Step 39: Reconnect the MAF sensor harness. Use the provided cable tie to secure the harness if desired.





Figure R

### **Refer to Figure R for Step 40**

Step 40: This kit includes an optional plug to close off the auxiliary air inlet. Install the plug if you wish to close it off to only capture cold air from the factory inlet.

Without the plug installed, the aFe POWER intake will capture the maximum amount of air available. More airflow offers more power. Some of this air is picked up from inside the engine compartment and could be warmer air, which will affect the performance of the vehicle.

With the plug installed on the housing, it will block off any hot engine air entering the housing to make sure only the coolest air available is directed into the engine. The plug will also reduce the noise generated by the intake.





**Refer to Figure S for Steps 41-42**

Step 41: Reinstall the engine cover and secure it to the aFe POWER tube using the screws removed in step 1.

Step 42: Remove the protective film from the air filter housing window.

**Your installation is now complete. Verify all connection and screws are secured. Thank you for choosing aFe POWER!**





**PAGE LEFT BLANK INTENTIONALLY**



***advanced FLOW engineering, Inc.***

Corona, CA 92879

<https://afepower.com/contact>