

advanced FLOW engineering Cold Air Intake System

Instruction Manual P/N: 50-73006 / 51-73006

Make: Ford Model: Super Duty F-250/F-350/F-450/F-550 Year: 2017-2019 Engine: V8-6.7L(td)



9

- Please read the entire instruction manual before proceeding.
- Ensure all components listed are present.
- For technical support please call 951-493-7185.
- Ensure you have all necessary tools before proceeding.
- Do not attempt to work on your vehicle when the engine is hot.
- Retain factory parts for future use.

Label	Qty.	Description	Part Number
A1	1	Air Filter (Pro 10R)	20-91061
A2	1	Air Filter (Pro DRY S)	21-91061
B	1	Intake Tube	05-73006B1
C	1	Housing	05-73006B2
D	1	Plug	05-01225
E	1	Coupler, Silicone Hump	05-01204
F	1	Washer, Flat: M6	03-50070
G	2	Screw, Torx: M4 x .7 x 8mm	03-50491
H	1	Screw, Hex Hd: M6x1x20mm	03-50057
J	1	Fixing Clamp, 3/4"ID	03-50234
K	2	Clamp, 072 (3" - 5")	03-50010
M	1	Clamp, T-bolt (8-5/16" - 8-5/8") (SS)	03-50267
N	1	Harness, Ford MAF Extension	05-70037

Installation will require the following tools:

7mm, 8mm, 10mm & 11mm nut driver or socket and extension, T-20 Torx driver

Warranty Information available at <https://afepower.com/contact#warranty>

Emissions Disclaimer: This product is not currently CARB exempt and is not available for purchase in California or for use on any vehicle registered with the California Department of Motor Vehicles.

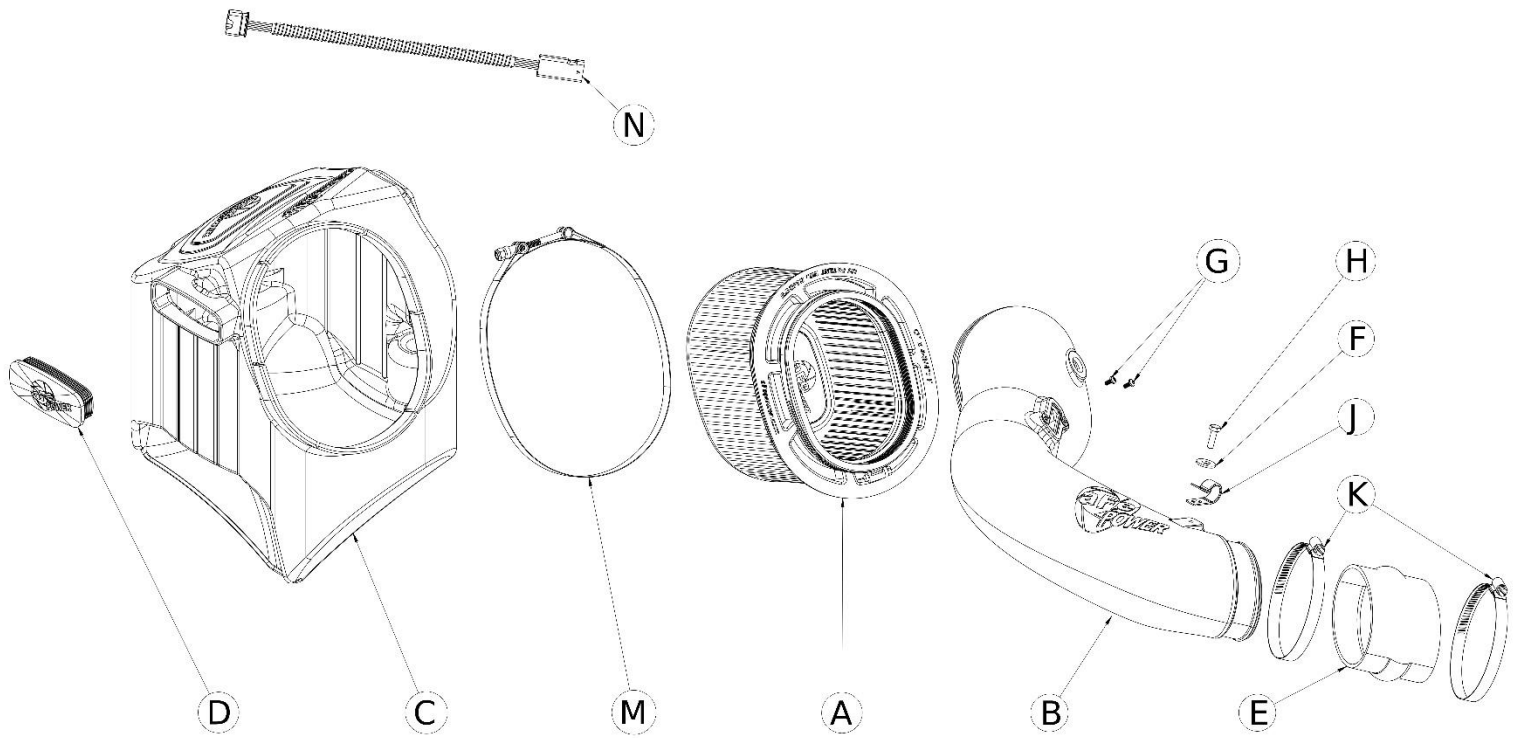

**Figure A****Refer to Figure A for Step 1**

Step 1: Remove the two 8mm screws ① securing the OE filter housing, and loosen the two clamps on the OE tube.



Figure B

Refer to Figure B for Step 2

Step 2: Push the small hoses ② out of the way on the OE tube, and remove the tube.

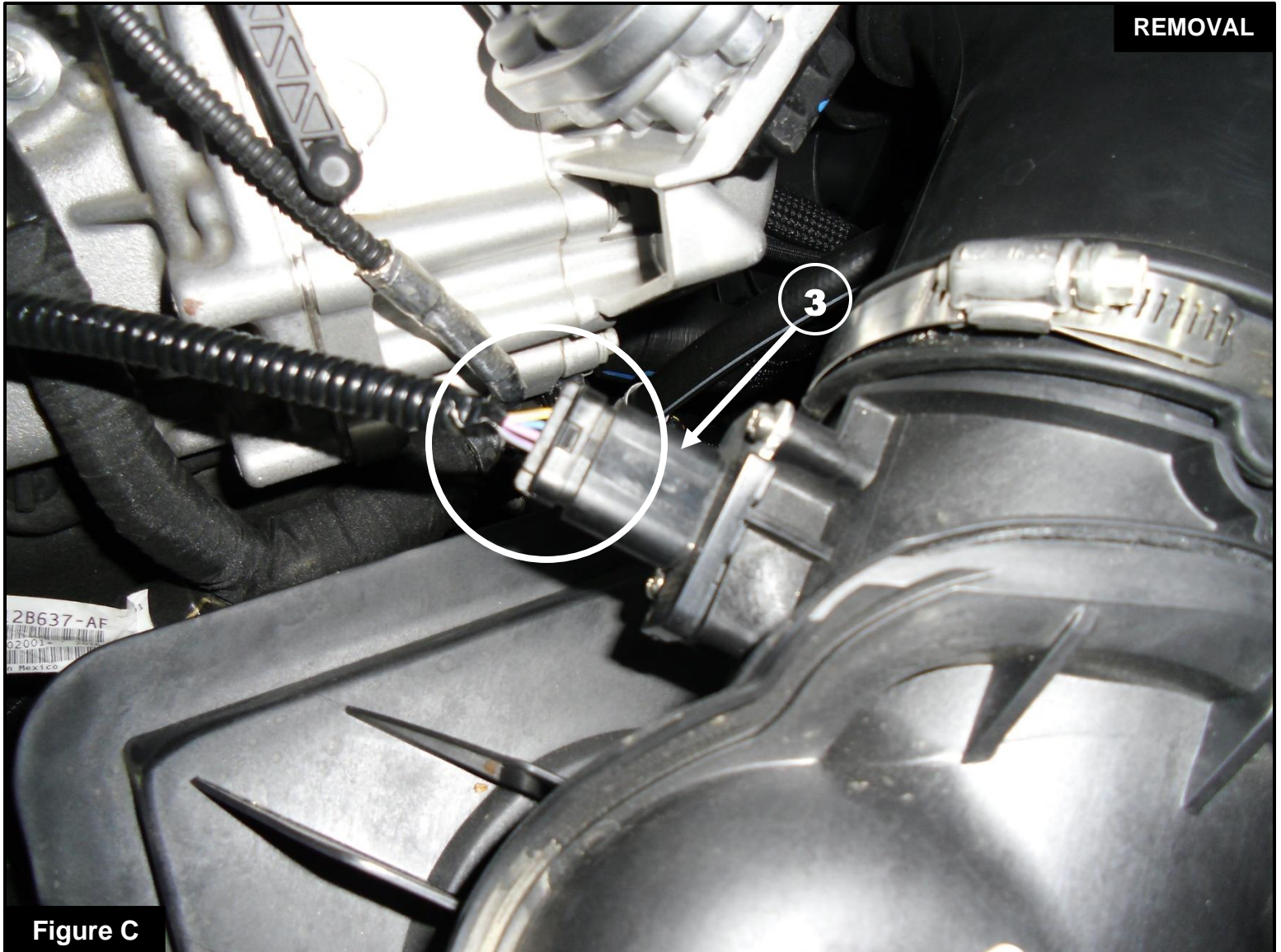
**Figure C****Refer to Figure C for Steps 3-4**

Step 3: Slide back the red locking tab on the bottom side of the MAF sensor connector (3), and then disconnect the sensor.

Step 4: Remove the OE air box, pulling in an upward motion.



Figure D

CLAMPS SHOWN MAY VARY

Refer to Figure D for Steps 5-6

Step 5: Remove the factory grommets (4) from the OE air box and install on the Momentum HD housing.

Step 6: Slide the filter into the housing and install the provided T-bolt clamp (5). Tighten only the T-bolt clamp.

INSTALL



Figure E

CLAMPS SHOWN MAY VARY

Refer to Figure E for Step 7

Step 7: Install the Momentum HD housing into the vehicle by pushing it in to the factory grommet.

**CLAMPS SHOWN MAY VARY****Figure F****Refer to Figure F for Steps 8-10**

Step 8: Transfer the factory filter minder and grommet (6) on to the Momentum HD tube.

Step 9: Transfer the MAF sensor (7) from the OE housing to the Momentum HD tube using the provided screws.

Step 10: Install the silicone coupler (8) and the clamps (9) onto the small end of the tube. Do not tighten the clamps.



Figure G

Refer to Figure G for Steps 11-15

- Step 11: Install the Momentum HD tube by first sliding the coupler over the turbo inlet. Connect the other end to the air filter.
- Step 12: Tighten all the clamps.
- Step 13: Reconnect the MAF sensor (10) using the provided MAF extension harness.
- Step 14: Secure the hose to the tube with the provided fixing clamp, 6mm screw and washer (11).
- Step 15: Reinstall the two factory screws removed in Step 1 securing the air box.



Figure H

Refer to Figure H for Steps 16-18

Step 16: If you have purchased the aFe air scoop (P/N: 54-73006-S), follow its install instruction sheet.

Step 17: If you don't have the air scoop, you have the option to close off the extra air inlet with the furnished plug or to keep it open.

- Without the plug installed, the aFe Power intake will capture the maximum air available. More airflow offers more power. Yet some of this air is picked up from inside the engine compartment and could be warmer air. Warmer air will affect the performance of the vehicle.
- The plug installed on the housing will block off any hot engine air entering the housing and make sure the coolest air available is directed into the engine. It will also reduce the noise of the intake.

Step 18: Check all the components are tight and secure. Your installation is now complete.

NOTE: Place enclosed CARB EO sticker on or near the device on a smooth, clean surface.

EO identification label is required to pass the smog inspection.



advanced FLOW engineering, inc.

1375 Sampson Avenue Corona, CA 92879

<https://afepower.com/contact>