

## advanced FLOW engineering

Cold Air Intake System

Instruction Manual P/N: 51-76005 / 54-76005

---

Make: Toyota Model: Tacoma Year: 2016-2023 Engine: V6-3.5L



- Please read the entire instruction manual before proceeding.
- Ensure all components listed are present.
- If you are missing any of the components, call customer support at 951-493-7185.
- Ensure you have all necessary tools before proceeding.
- Do not attempt to work on your vehicle when the engine is hot.



## Retain factory parts for future use.

Label	Qty.	Description	Part Number
A1	1	Air Filter (Pro 5R)	24-91092
A2	1	Air Filter (Pro DRY S)	21-91092
A3	1	Air Filter (Pro-GUARD 7)	72-91092
B	1	Tube	05-76005B1
C	1	Housing	05-76005B2
D	2	Clamp, #052	03-50008
E	1	Coupling, Silicone Reducer	05-01400
F	2	Screw, Torx: M4x.7x8mm	03-50491
G	1	Seal, Trim (15" in.)	05-00007
H	1	Plug, Silicone	05-01429

Installation will require the following tools:

8mm nut driver, 10mm deep socket & driver, 12mm deep socket & driver, 7/16" deep socket, phillips screwdriver, T20 torx screwdriver.

**Warranty Information available at:** <https://afepower.com/contact#warranty>

**Emission Disclaimer:** This system is not currently CARB exempt and is not available for sale in California or for use on any vehicle registered with the California Department of Motor Vehicle.

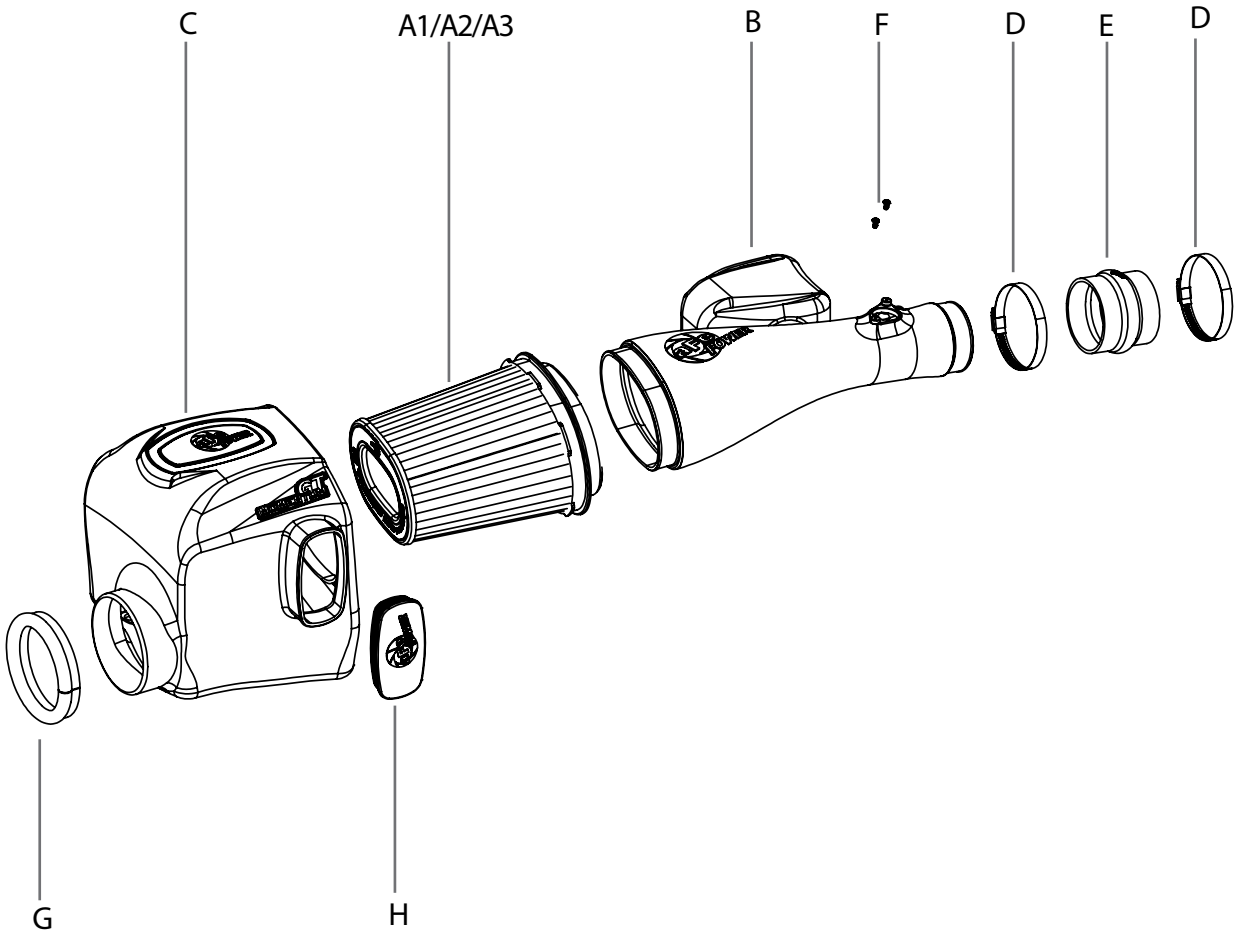



Figure A

Refer to Figure A for Step 1

Step 1: Remove the engine cover by lifting the front up and pulling the cover towards you.



Figure B

Refer to Figure B for Steps 2-4

Step 2: Disconnect the Mass Air Flow (MAF) harness (1) from the sensor in the factory tube.

Step 3: Disconnect the MAF wiring harness from both plastic clips (2).

Step 4: Disconnect the Crank Case Vent (CCV) hose (3) from the factory intake tube.

\*Optional: save the factory spring clip for later use.



Figure C

Refer to Figure C for Steps 5-8

Step 5: With a 10mm nut driver, loosen the hose clamp at the throttle body (4).

Step 6: Unclip both toggle clamps on the factory housing (5).

Step 7: Lift and remove the upper intake housing and intake tube at this time.

Step 8: Remove the factory air filter.



Figure D

Refer to Figure D for Steps 9-10

Step 9: With a 12mm nut driver, loosen all three ⑥ bolts securing the lower housing in place.

Step 10: Lift and remove the lower half of the factory housing at this time.

INSTALL



Figure E

Refer to Figure E for Step 11

Step 11: Remove and transfer the three steel sleeves and three rubber isolation grommets to the Momentum housing ⑦.





Figure F

Refer to Figure F for Step 12

Step 12: Install the rubber trim seal on the round fender-side opening of the Momentum housing.

Note: Get one end seated on the housing first then slowly work all the way around, pressing it onto the housing as you go.



Figure G

Refer to Figure G for Step 13

Step 13: Using a phillips head screwdriver, remove the MAF sensor ⑧ and transfer to the Momentum intake tube. Secure MAF sensor using the two provided T20 Torx screws.



Figure H

Refer to Figure H for Steps 14-15

Step 14: Before installing the Momentum housing, insert two previously removed bolts into the rubber grommets from the inside and one on the outer mounting location.

Step 15: Lower the housing into the engine bay, align each bolt and tighten. Careful not to over tighten.



Figure I

Refer to Figure I for Steps 16-17

Step 16: Insert the filter into the housing as shown (9). Press until you feel or hear all 6 of the tabs seat themselves in the housing. Gently pull on the filter to verify it is properly seated.

Step 17: Slide the coupling over the throttle body as shown, smaller end on the throttle body (10).



Figure J

Refer to Figure J for Steps 18-21

Step 18: Insert the tube into the air filter as shown then lower the other end into the coupling at the throttle body.

Step 19: Slip both provided hose clamps over the coupling as shown (11).

Step 20: Align the tube with the coupling and filter then tighten both clamps at the throttle body with an 8mm nut driver.

Step 21: Tighten the t-bolt clamp on the filter securing it to the intake tube (12).



Figure K

Refer to Figure K for Steps 22-23

Step 22: Reconnect the CCV hose to the intake tube (13), followed by the factory spring clip.

Step 23: Reconnect the MAF sensor as shown (14).



Figure L

Refer to Figure L for Step 24

Step 24: Reinstall engine cover. Your installation is now complete.

NOTE: Check all bolts, clamps and connectors after 200 miles.



**advanced FLOW engineering, inc.**

Corona, CA 92879

<https://afepower.com/contact>