

GT
MOMENTUM

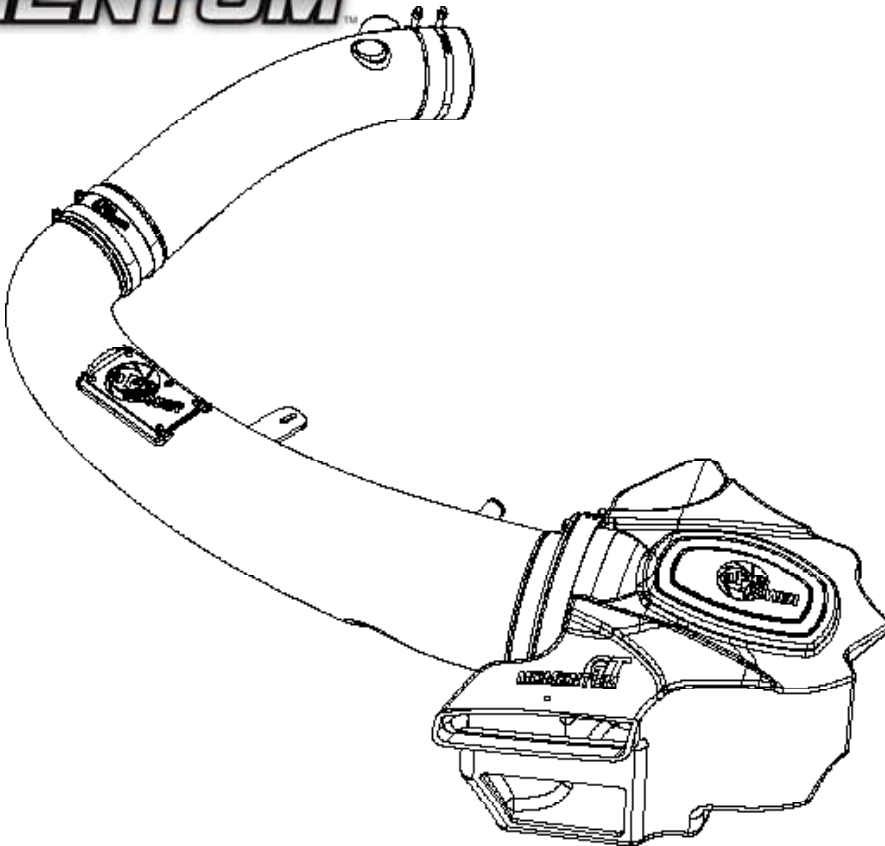

advanced FLOW engineering Momentum Air Intake

Instruction Manual P/N: 54-76207/ 51-76207

Make: **Jeep** Model: **Grand Cherokee (WK2)** Year: **2011-2015** Engine: **V6-3.6L**
Make: **Dodge** Model: **Durango** Year: **2011-2015** Engine: **V6-3.6L**



- Please read the entire instruction manual before proceeding.
- Ensure all components listed are present.
- If you are missing any of the components, call customer support at 951-493-7100.
- Ensure you have all necessary tools before proceeding.
- Do not attempt to work on your vehicle when the engine is hot.
- Disconnect the negative battery terminal before proceeding.

Retain factory parts for future use.

| Label | Qty. | Description | Part Number |
|-------|------|-----------------------------|-----------------------|
| A1 | 1 | Air Filter (Pro DRY S) | 21-91062 (Gray Media) |
| A2 | 1 | Air Filter (Pro-5R) | 24-91062 (Blue Media) |
| B | 1 | Intake Tube #1 | 05-76207B1 |
| C | 1 | Intake Tube #2 | 05-76207B2 |
| D | 1 | Housing | 05-76205B2 |
| E | 1 | Bracket, Aluminum Support | 05-01356B |
| F | 3 | Washer, Flat 1/4" | 03-50043 |
| G | 1 | Coupling, Silicone Straight | 05-01280 |
| H | 1 | Coupling, Silicone Straight | 05-01223 |
| I | 2 | Clamp, T-Bolt | 03-50292 |
| J | 2 | Clamp #56 | 03-50009 |
| K | 1 | Clamp #72 Clamp, T-Bolt | 03-50290 |
| L | 1 | Grommet | 03-50167 |
| M | 1 | Fuel Hose (14" inches) | 05-00069 |
| N | 1 | Fitting, air temp sensor | 05-01454 |

Tools Needed: 8mm Nut Driver, 10mm Nut Driver/Deep Socket.

Recommended: Acetone, Panel Popper.

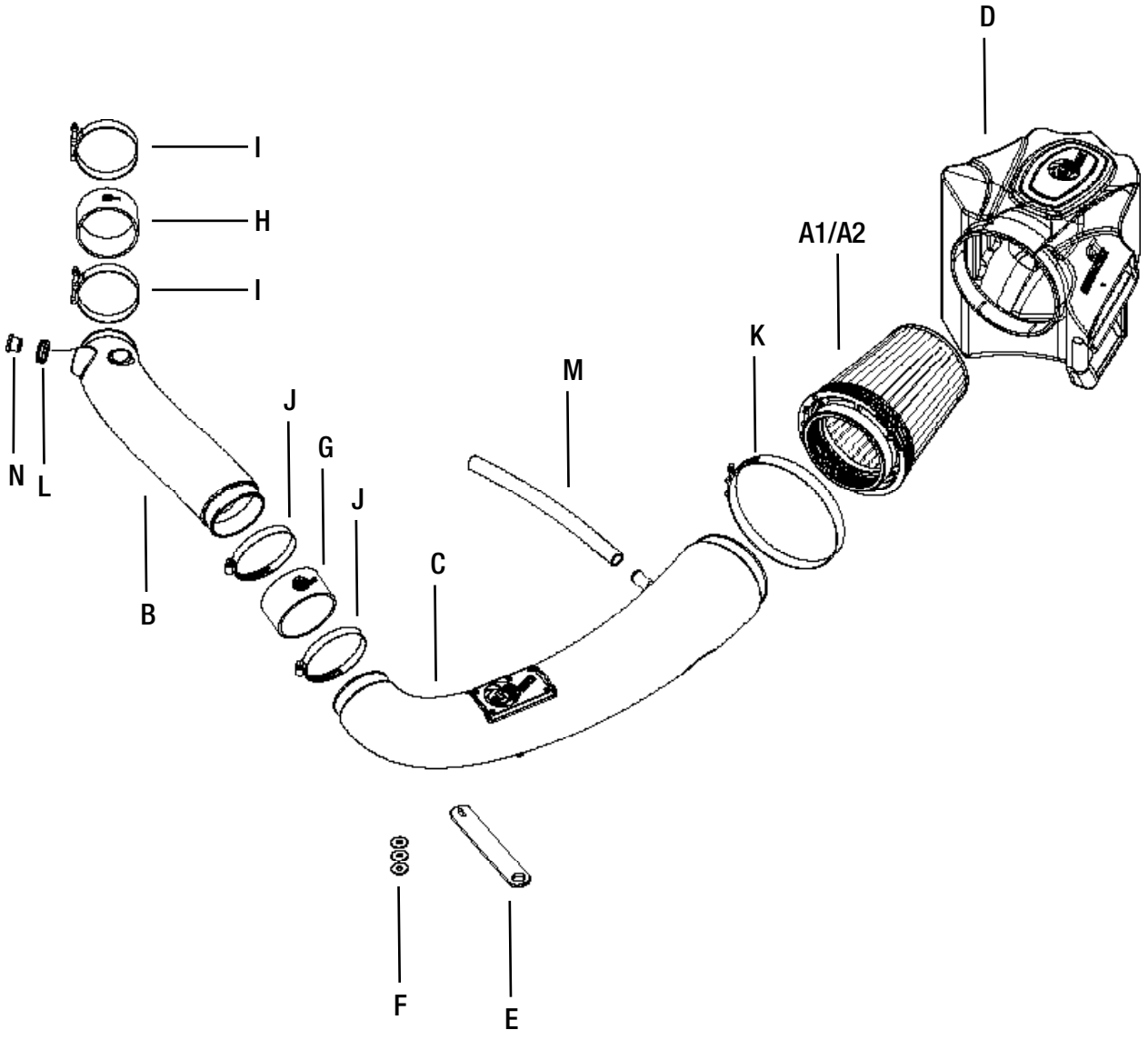



Figure A

Refer to Figure A for Step 1

Step 1: Remove the engine cover by pulling up firmly.



Figure B

Refer to Figure B for Step 2

Step 2: Carefully pull up and remove the trim seal (2) on top of the factory intake scoop and 2-3 clips on either side. This helps with the removal of the factory airbox and installation of the aFe housing.

Note: It may help to use a panel popper when pulling the clips.



Refer to Figure C for Steps 3-8

Step 3: Disconnect the temp sensor wire harness. ③

Step 4: Remove the temp sensor with a 90 degree turn counter clockwise. Be sure not to damage the sensor.

Step 5: Loosen the hose clamp at the throttle body and at the air box.

Step 6: Disconnect the vent hose from the air box along with the power steering hose clip.

Step 7: Remove the stock intake tube, and air filter housing by pulling straight up and out of the vehicle.

Step 8: Remove the factory (x3) grommets from the bottom of the OE air box. Save as these will be used later in the installation.



Figure D

Refer to Figure D for Step 9

Step 9: Transfer the (x3) rubber grommets ④ from the OE housing to the aFe housing as shown

**Figure E****Refer to Figure E for Steps 10-13**

Step 10: Clean the inside of the rotomold housing flange and both mating surfaces of the filter flange (acetone recommended).

Step 11: Pre assemble the housing as shown (5) by inserting the aFe filter into the housing and tightening the large t-bolt clamp using your 10mm nut driver.

Step 12: To make installation of the housing easier, reposition the cable shown in the inset picture, below the factory mounting location pin.

Step 13: Install the housing assembly into the vehicle. It may help to align the back-lowest rubber grommet with your hand first and the others will follow. Press down firmly to securely seat the housing.

Note: It may help to use a small amount of lubricant on the inside of the rubber grommets

**Figure F****Refer to Figure F for Steps 14-17**

- Step 14: Remove the (x2) nuts securing the vacuum pump and install the support bracket as shown. ⑥
- Step 15: Install the (x3) provided washers above the rubber spacer on the left side to space the pump down equally with the bracket.
- Step 16: Reinstall both nuts. Only snug the right one so it can be aligned properly once the tubes are installed.
- Step 17: Transfer the rubber grommet from its stock mounting location to the end ⑦ of the bracket as shown.

**Figure G****Refer to Figure G for Steps 18-20**

Step 18: Pre-assemble both tubes as shown above.

Step 19: Install grommet into hole in the smaller aFe tube (8) then push the aluminum fitting in it.

Note: It may help to use a small amount of lubricant on the inside of the rubber grommet.

Step 20: Carefully insert the temperature sensor into the aluminum fitting and secure by turning clockwise.



Figure H

Refer to Figure H for Steps 21-24

Step 21: Install the shorter aFe tube first (9) by sliding the silicone coupling over the throttle body.

Step 22: Install the larger aFe tube, filter side first (10) then rotate the tube and slide the silicone coupling over the smaller tube (11).

Step 23: Align the tubes where there are no gaps and tighten all clamps.

Step 24: Tighten the nut securing the support bracket in place.



Figure 1

Refer to Figure 1 for Step 25

Step 25: Measure approximately 4" from the end of the OE vent tube and cut to accept the new 5/8" rubber vent hose. Cut the provided rubber vent hose to 12" long and slip over the OE vent hose and connect it to the intake tube. Save the original vent tube that was cut and the remaining 5/8" rubber vent hose. These will be used if the vehicle is returned to stock.

***Optional:** As shown in the inset, if you feel confident in your ability with a heat gun, you can heat the OE hose at the bend and carefully bend it to align with the tube. It is important to heat the entire bend evenly to avoid kinking.



Figure J

Refer to Figure J for Steps 26-29

Step 26: Reconnect temperature sensor harness.

Step 27: Verify all connections are secured.

Step 28: Reinstall the rubber trim seal into factory locations and onto the aFe housing.

Step 29: Reinstall engine cover. Your installation is now complete.

NOTE: Place enclosed CARB EO sticker on or near the device on a smooth/clean surface. EO identification label is required to pass the smog test inspection.



Pro DRY S Air Filter



P/N: 21-91062

Pro 5R Air Filter



P/N: 24-91062

Pro DRY S Restore Kit



P/N: 90-59999

Blue Squeeze Restore Kit



P/N: 90-50501

Blue Aerosol Restore Kit



P/N: 90-50001

aFe Power Hat



P/N: 40-10083

To purchase any of the items above, view airflow charts, dyno graphs, photos, and video; please go to aFepower.com.

Warranty

General Terms:

- aFe warrants their products to be free from manufacturer's defects due to workmanship and material.
- This warranty applies only to the original purchaser of the product and is nontransferable.
- Proof of purchase of the aFe product is required for all warranty claims.
- Warranty is valid provided aFe instructions for installation and/or cleaning were properly followed.
- Proper maintenance with regular inspections of product is required to insure warranty coverage.
- Damage due to improper installation, abuse, unauthorized repair or alteration is not warranted.
- Incidental or consequential damages or cost, including installation and removal of part, incurred due to failure of aFe product is not covered under this warranty.
- All warranty is limited to the repair and/or replacement of the aFe part. To request Return Goods Authorization ("RGA"), email RGA@afepower.com or call (951)493-7100. Upon receipt of the RGA, you must return the product to the address provided in the RGA, freight prepaid and accompanied with a dated proof of purchase and the RGA. Upon receipt of the defective product and upon verification of proof of purchase, aFe will either repair or replace the defective product within a reasonable time, not to exceed thirty days.

| Product Category | P/N Prefix | Warranty duration |
|----------------------------------|------------------------|--------------------------|
| Direct OE Replacement Filters | 10, 11, 30, 31, 71, 73 | Life of the vehicle |
| Racing Filters | 18 | 1 year |
| Universal | 21, 24, 72 | 2 years |
| Air Intake Systems | 50, 51, 54, 55, 75 | 2 years |
| Exhaust Systems | 49 | 2 years |
| Intercoolers & Intercooler Tubes | 46-2 | 2 years |
| Intake Manifolds | 46-1 | 2 years |
| Differential Cover | 46-7 | Life of the vehicle |
| Exhaust Manifolds | 46 | 2 years |
| Throttle Body Spacers | 46-3 | 2 years |
| Fluid Filters | 44 | 90 days |
| Pre-Filters | 28 | 2 years |
| Heavy Duty OE Replacement | 70 | 2 years |
| PowerSports OE Replacement | 81, 87 | 2 years |
| PowerSports Intake Systems | 85 | 2 years |

No other warranty expressed or implied applies nor is any person or advanced FLOW engineering authorized to assume any other warranty. Some States do not allow the exclusion or limitation of incidental or consequential damages or do not allow limitations on how long an implied warranty lasts, so the above limitations or exclusions may not apply to you. This warranty gives you specific legal rights, and you may also have other rights which vary from State to State.



advanced FLOW engineering, inc.
252 Granite Street Corona, CA 92879
TEL: 951.493.7100 • TECH: 951.493.7134
E-Mail: Tech@aFepower.com