

**GT**  
**MOMENTUM™**

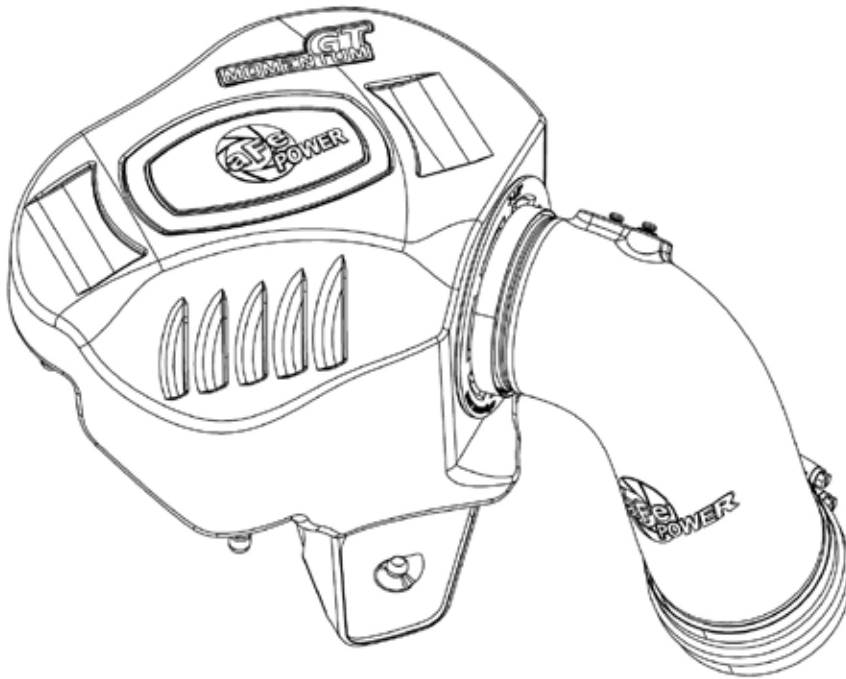

## advanced FLOW engineering

Momentum GT Cold Air Intake System

**Instruction Manual** P/N: 51-76309 / 54-76309

Make: **BMW** Model: **340i/ix/GT (F30/F31/F34)**

Make: **BMW** Model: **440i/ix/Gran Coupe (F32/F36)**

Make: **BMW** Model: **M140i/ix/M240i/ix (F20/F21/F22)**

Year: **2016-2019**

Year: **2016-2020**

Year: **2016-2021**

Engine: **L6-3.0L (t) B58**

Engine: **L6-3.0L (t) B58**

Engine: **L6-3.0L (t) B58**

NOTE: This air intake system will not fit convertible models.



- Please read the entire instruction manual before proceeding.
- Ensure all components listed are present.
- If you are missing any of the components, call technical support at 951-493-7185 or e-mail tech@afepower.com.
- Ensure you have all necessary tools before proceeding.
- Do not attempt to work on your vehicle when the engine is hot.

## Retain factory parts for future use.

Label	Qty.	Description	Part Number
A1	1	Air Filter (Pro 5R)	24-91103
A2	1	Air Filter (Pro DRY S)	21-91103
B	1	Housing	05-76309B2
C	1	Tube	05-76309B4
D	2	Screw, Torx: M4	03-50490
E	2	Clamp, #060	03-50002
F	1	Coupling, Silicone Dbl. Hump	05-01417
G	1	Mount, Rubber	03-50534

Installation will require the following tools:

Phillips screwdriver & 8mm nut driver, flat head screwdriver, 11mm socket, socket wrench, T20 torx driver.

Note: Not legal for use in California. The use of this device in any on-road or off-road vehicles registered with the California Dept of Motor Vehicles (DMV) is strictly prohibited.

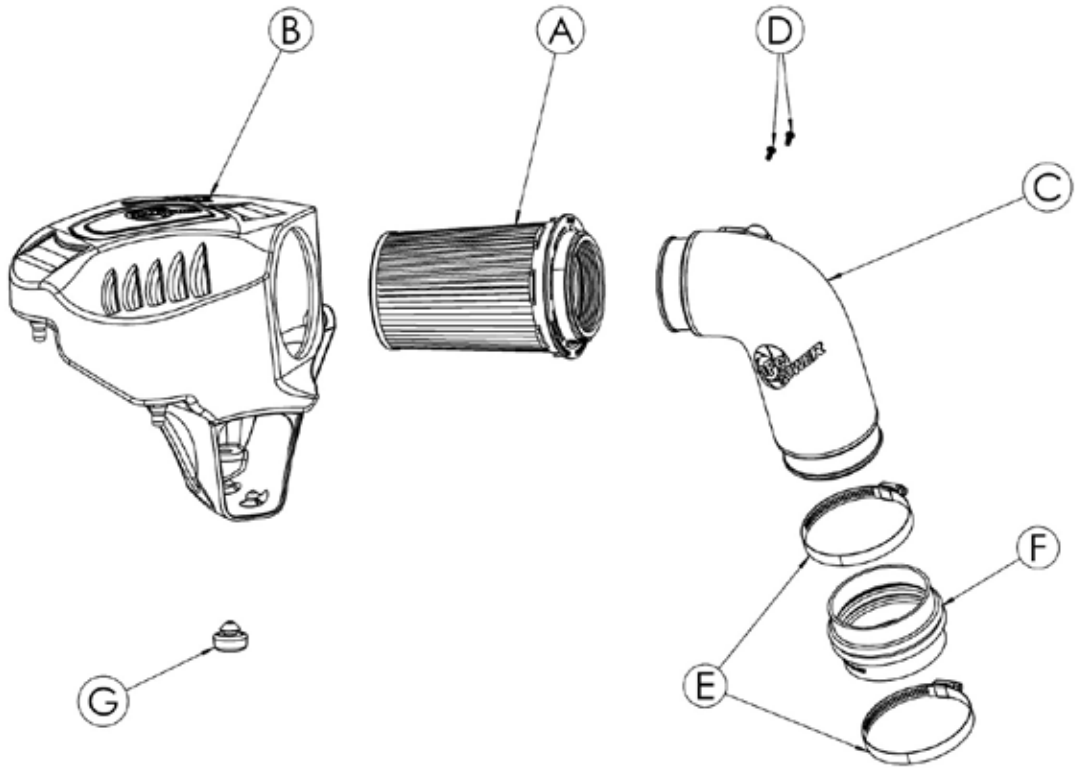



**Refer to Figure A for Steps 1-3**

- Step 1: Untighten the clamp securing the tube to the factory airbox and disconnect the Mass Air Flow (MAF) sensor.
- Step 2: Pull the factory airbox out of the vehicle.
- Step 3: Untighten the clamp securing the intake tube to the turbo inlet tube, then take the intake tube out of the vehicle.



Figure B

Refer to Figure B for Steps 4-5

Step 4: Install the aFe filter into the aFe housing by firmly pushing it until it snap in. Install the clamp on the filter, but do not tighten as this time.

Step 5: Install the provided grommet into the small hole at the bottom of the aFe housing.



Figure C

Refer to Figure C for Step 6

Step 6: Verify the two factory grommets stayed in their location when you removed the factory airbox. If necessary, re-install them.

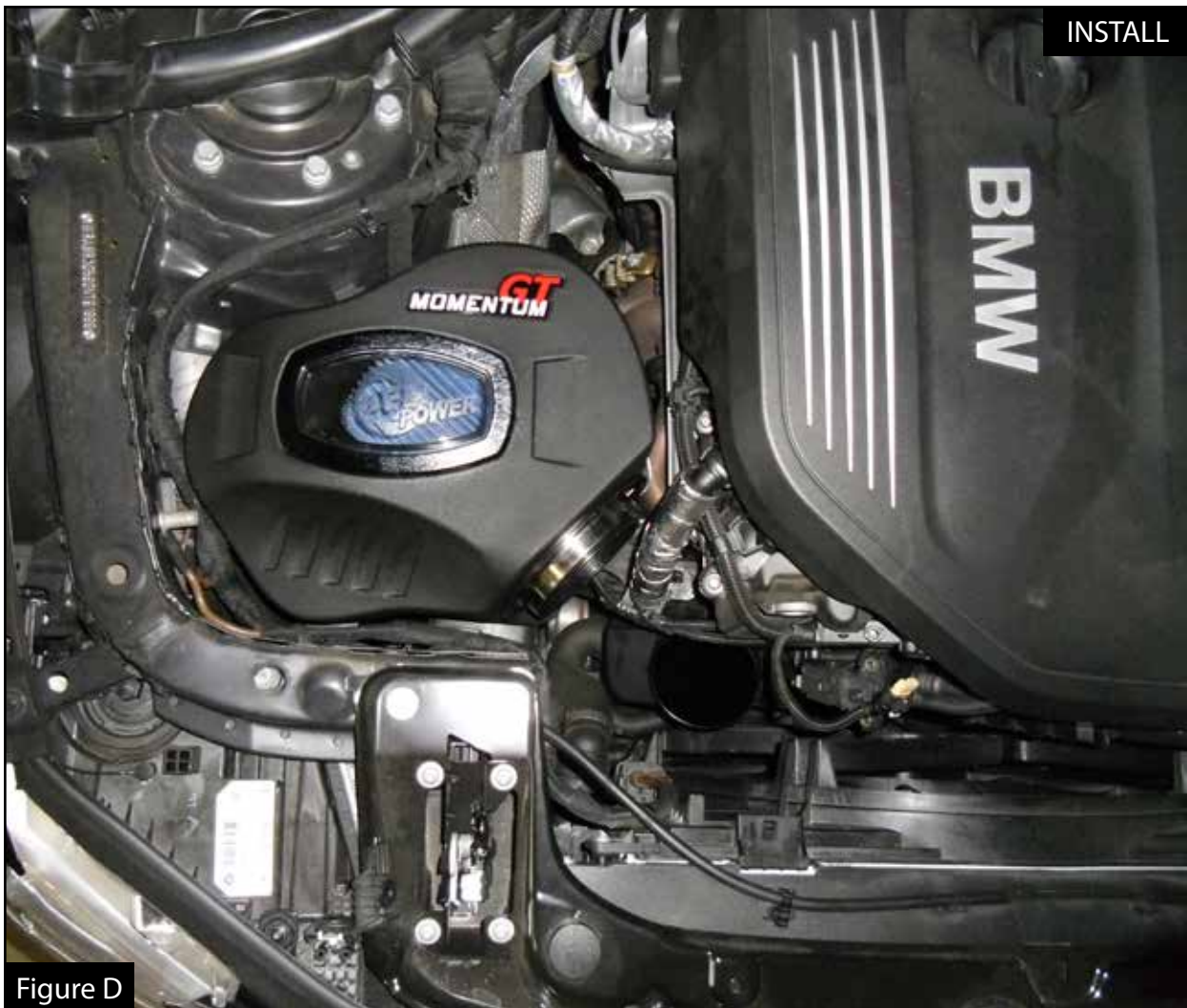

Figure D

Refer to Figure D for Step 7

Step 7: Install the aFe housing assembly by firmly pushing it into the grommets.

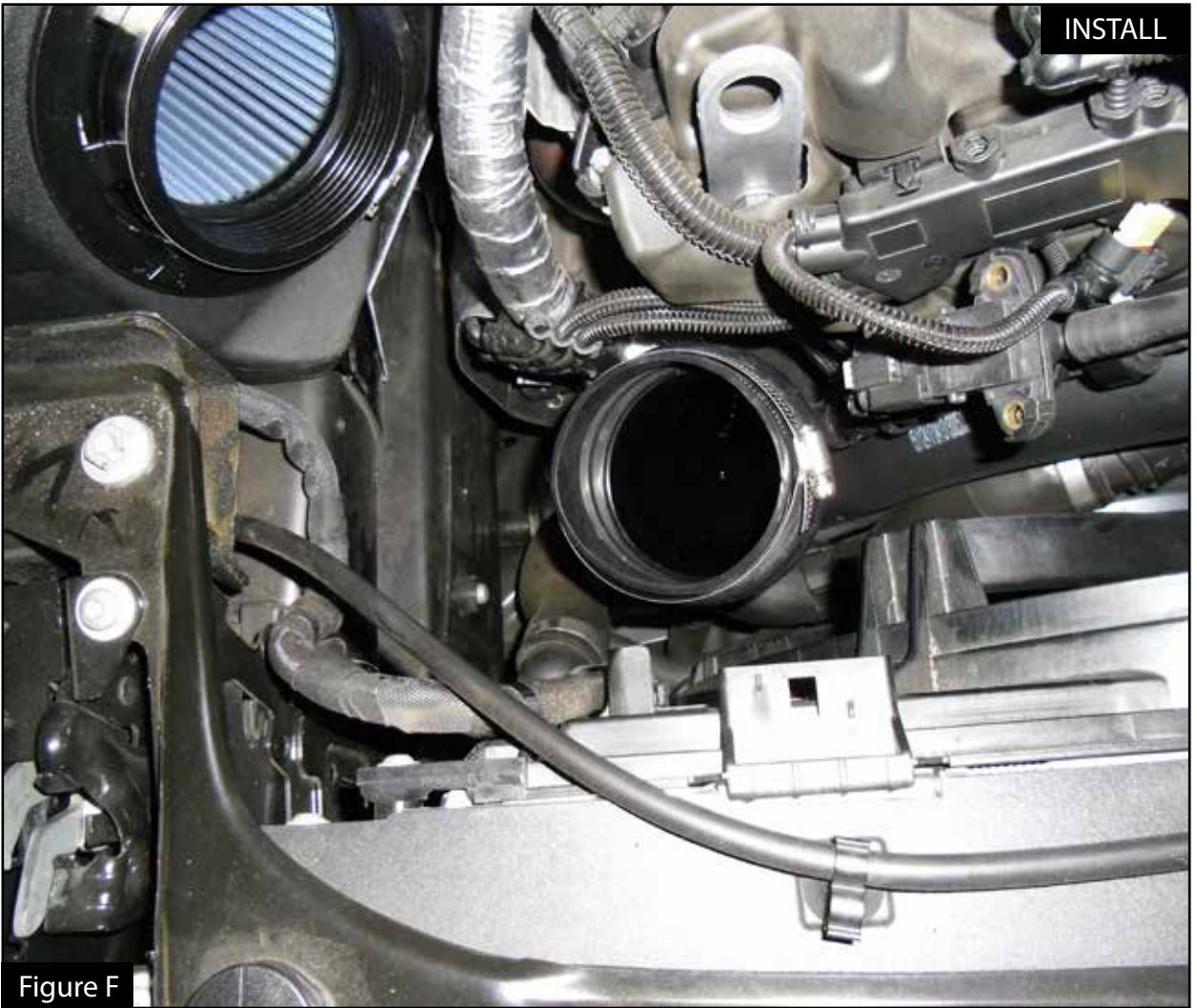

Figure E

Refer to Figure E for Step 8

Step 8: Transfer the MAF sensor from the factory airbox to the aFe intake tube. Secure it using the provided screws.





Refer to Figure F for Step 9

Step 9: Install the aFe coupling over the factory turbo inlet. Install the clamps but do not tighten at this time.



Refer to Figure G for Steps 10-11

Step 10: Install the aFe tube into the vehicle by sliding it in the coupling first then into the filter.

Step 11: Align the tube, coupling and filter then tighten all clamps.



Figure H

Refer to Figure H for Steps 12-13

Step 12: Re-connect the MAF sensor harness.

Step 13: Your installation is now complete. Thank you for choosing aFe Power!

NOTE: Check all clamps, and connectors after 200 miles.

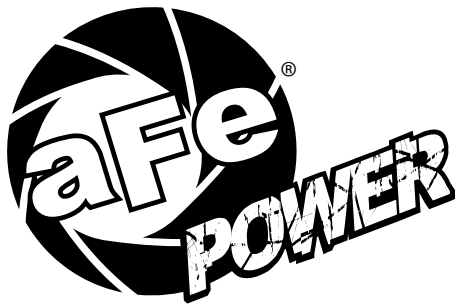

**advanced FLOW engineering, inc.**

Corona, CA 92879

[afepower.com/contact](http://afepower.com/contact)