



INSTALLATION INSTRUCTIONS

Cat-Back Exhaust

MAKE: Subaru
MODEL: Impreza
YEAR: 2012-2016
ENGINE: H4-2.0L

49-36052-P
49-36052-B

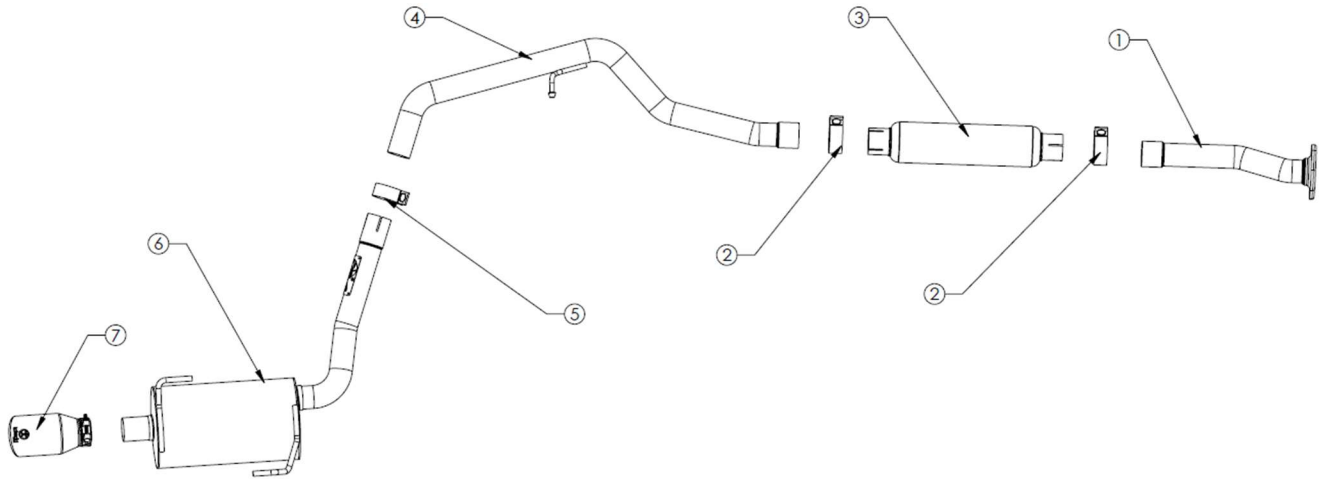

Item	Description	Part Number	Quantity
1	Front Pipe Assembly	05-245122	1
2	2-1/2" Band clamp	05-41061	2
3	Resonator	05-245163	1
4	Mid-pipe Assembly	05-245123	1
5	2-1/4" Band clamp	05-41210	1
6	Muffler Assembly	05-245124	1
7	Clamp-on Polished Tip	49T25404-P08	1
	Clamp-on Black Tip	49T25404-B08	1

aFe POWER recommends professional installation on this product. Thoroughly inspect the aFe POWER exhaust system to make sure there is no damage from shipping (if damage is noted, immediately contact aFe POWER customer service). Allow time for your vehicle to cool down prior to installation. When working on your vehicle proceed with caution. Wear protective safety equipment; eye goggles and gloves to ensure a safe installation.

Install band clamps to proper torque specifications of 40-45 ft-lb.

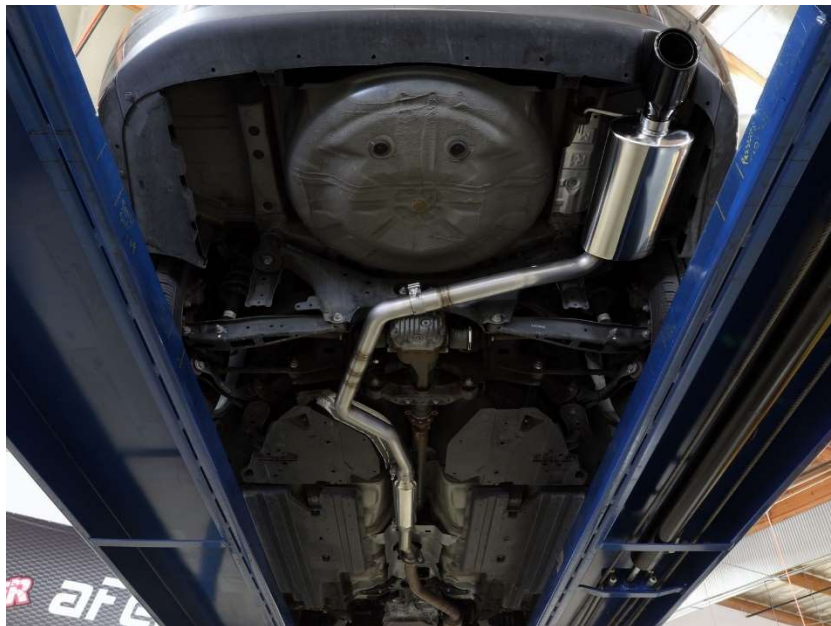



INSTALLATION INSTRUCTIONS

MAKE: Subaru
MODEL: Impreza
YEAR: 2012-2016
ENGINE: H4-2.0L

Cat-Back Exhaust

49-36052-P

49-36052-B

-
1. **(Read instructions prior to installation.)** It is recommended to not fully tighten the exhaust until it has been fully installed. Leave loose for adjustability.
 2. Secure vehicle on jack stands (refer to your manual for specified jack stand positions).
 3. For faster installation, spread out the parts of the exhaust alongside your vehicle as shown in the diagram above.
 4. Secure the stock exhaust with jack/stands.
 5. Remove the (x2) spring loaded bolts on the OE exhaust system.
 6. Remove OE exhaust system by using a pry bar or hanger rod tool and removing the (x3) rubber hanger isolation mounts.
 7. Transfer the (x3) rubber hanger isolation mounts to the TAKEDA exhaust system Muffler Assembly and Mid-pipe hangers.
 8. Install the TAKEDA Front Pipe Assembly onto the stock rear downpipe using the (x2) OE spring loaded bolts.
 9. Slide the TAKEDA Resonator over the TAKEDA Front Pipe using the provided 2-1/2" band clamp but do not tighten all the way.
 10. Install the TAKEDA Mid-pipe Assembly onto the Resonator using the provided 2-1/2" band clamp and slide the OE hanger isolation mount onto the frame hanger rods.
 11. Install the TAKEDA Muffler Assembly onto the Mid-pipe Assembly using the provided 2-1/4" band clamp and slide the (x2) OE hanger isolation mounts onto the frame hanger rods.
 12. Install Clamp-on Tip to the TAKEDA Muffler Assembly using the supplied band clamp.
 13. Ensure that all the components of the TAKEDA exhaust system are aligned and are at a safe clearance from all wires, hoses, brake lines, body parts, and tires.
 14. Start from the front of the TAKEDA exhaust system and evenly tighten all clamps and fasteners.
 15. Start the vehicle and check for any leaks. If any leaks are found, determine cause and repair as necessary.
 16. Remove vehicle from jacks stands.
 17. It is recommended to re-tighten all clamps and hardware after 50-100 miles.