



# INSTALLATION INSTRUCTIONS

Axle-Back Exhaust

MAKE: BMW  
MODEL: 228i  
YEAR: 2014-2016  
ENGINE: L4-2.0L (t)

49-36346-B  
49-36346-P

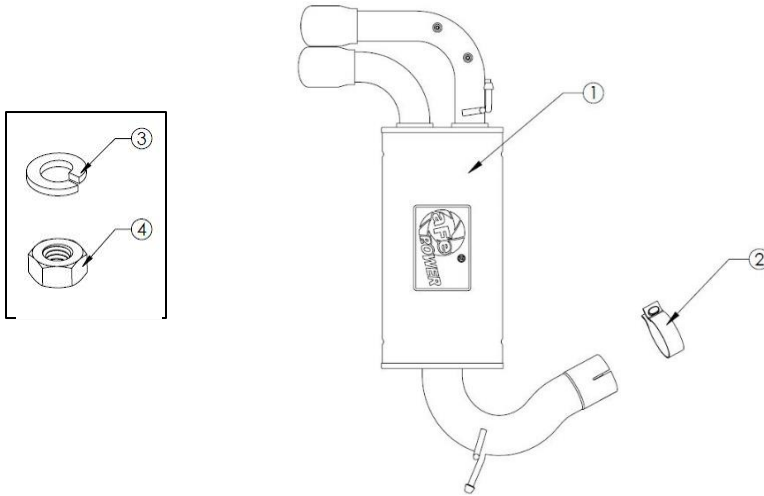

Item	Description	Part Number	Quantity
1	Muffler Assembly w/ Black Tip	05-145728B	1
1	Muffler Assembly w/ Polished Tip	05-145728P	1
2	Clamp, Band: 3"	05-41055	1
3	Lock Washer	03-50062	1
4	M6 Hex Nut	03-50059	1

aFe POWER recommends professional installation on this product. Thoroughly inspect the aFe POWER exhaust system to make sure there is no damage from shipping (if damage is noted, immediately contact aFe POWER customer service). Allow time for your vehicle to cool down prior to installation. When working on your vehicle proceed with caution. Wear protective safety equipment; eye goggles and gloves to ensure a safe installation.

Install band clamps to proper torque specifications of 40-45 ft-lb.





## INSTALLATION INSTRUCTIONS

**Axle-Back Exhaust**

**MAKE:** BMW  
**MODEL:** 228i  
**YEAR:** 2014-2016  
**ENGINE:** L4-2.0L (t)

49-36346-B  
49-36346-P

1. **(Read instructions prior to installation.)** It is recommended to not fully tighten the exhaust until it has been fully installed. Leave loose for adjustability.
2. Secure vehicle on jack stands (refer to your manual for specified jack stand positions).
3. For faster installation, spread out the parts of the exhaust alongside your vehicle as shown in the diagram above.
4. Secure the stock exhaust with jack/stands.
5. Un-plug the actuator drive at the rear of the OE muffler.
6. Remove the actuator drive off the OE exhaust and install onto the aFe POWER Muffler Assembly brackets (the fixing bow and exhaust flap will not be re-used). Use (x1) supplied M6 nut and lock washer to secure the original bottom bolt to the actuator drive as shown in figure 3.
7. Identify the location of the dimple on the bottom of the OE mid-pipe. Refer to figure 1 and 2. Mark the location of the dimple once found.
8. Cut the OE stock exhaust at the marked location of the dimple. Remove the muffler portion of the OE exhaust once cut.
9. Using (x1) supplied 3" band clamp, install the aFe POWER muffler assembly onto the stock mid-pipe where cut was made, but do not fully tighten.
10. Secure the aFe POWER Muffler Assembly with jack stand and properly bolt the rubber hanger mounts back on and tighten.
11. Ensure that the aFe POWER Muffler Assembly is aligned and is at a safe clearance from all wires, hoses, brake lines, body parts, and tires.
12. Tighten the 3" band clamp securing the aFe Muffler Assembly to the OE mid-pipe.
13. Plug the actuator drive wire back on the actuator drive. See figure 3.
14. Start the vehicle and check for any leaks. If any leaks are found, determine cause and repair as necessary.
15. Remove vehicle from jacks stands.
16. It is recommended to re-tighten all clamps and hardware after 50-100 miles.