



## INSTALLATION INSTRUCTIONS

**MAKE:** Dodge  
**MODEL:** RAM 2500/3500  
**YEAR:** 2004.5-2007  
**ENGINE:** L6-5.9L (td) Cummins  
**WHEELBASE:** 140.5" & 170.5"



**5" Cat-back (409SS)**  
**P/N: 49-42012**

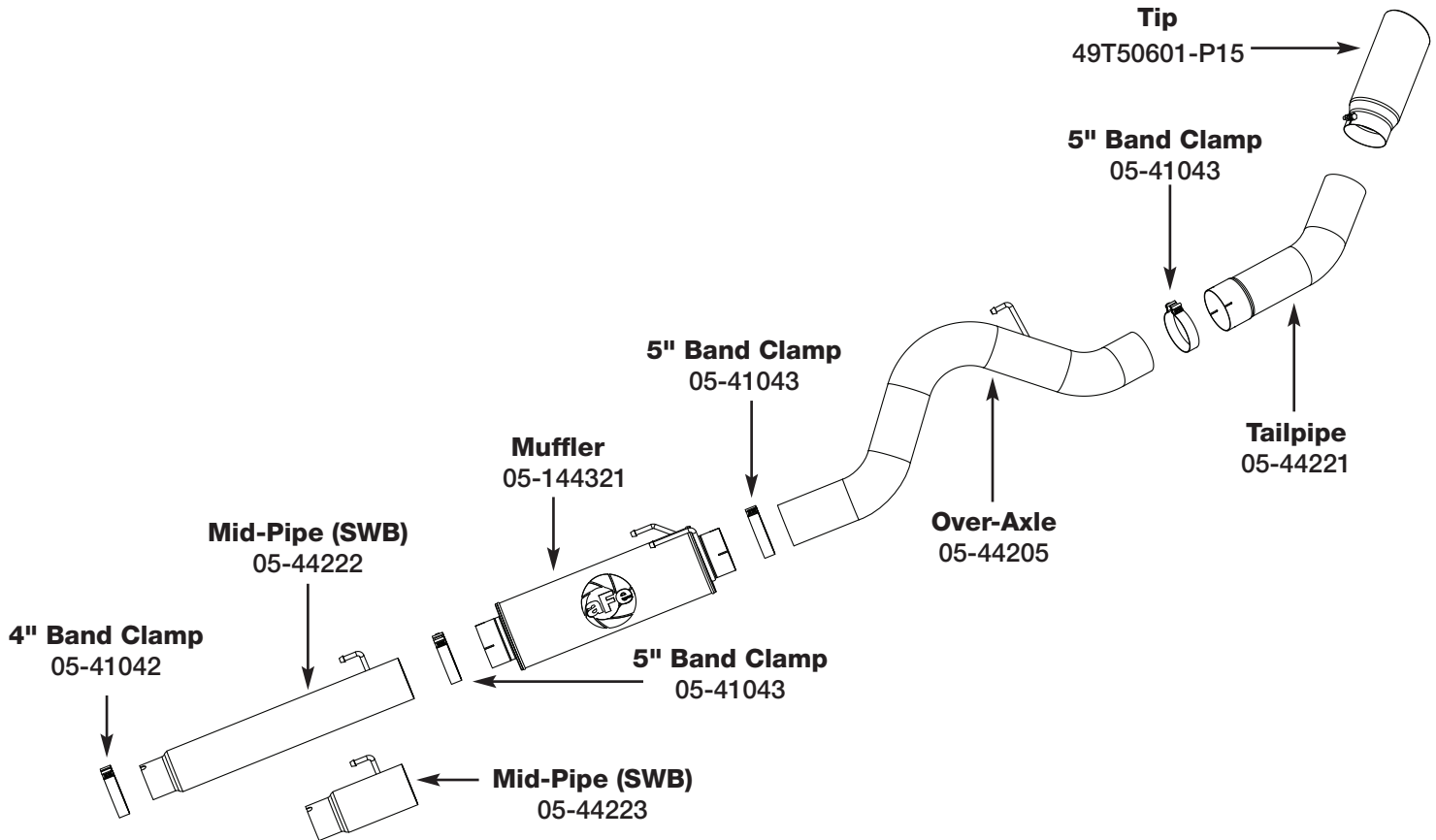

**Step 1: (Read Instructions prior to installation)** Remove your stock exhaust from the rear of your truck working your way forward. It may be necessary to cut the pipes if the slip joints are stuck. Take caution not to damage the factory isolation mounts as they will be reused. **It is recommended to not fully tighten the clamps until the entire system has been installed.**

**Step 2:** For faster installation spread the pieces of the exhaust along side of your vehicle according to the diagram shown.

**Step 3:** Install the mid-pipe with the 4" band clamp. Be sure to select the correct mid-pipe depending on the wheelbase length.

**Step 4:** Install the muffler using the two 5" clamps indicated.

**Step 5:** Utilizing the factory isolation mounts now install over-axle tube, then install the tailpipe with clamp. Tighten all clamps from front to rear.

**Step 6:** Install the exhaust tip and tighten. Your installation is now complete. It is recommended to re-tighten all parts after 50-100 miles.

### NOTE:

- aFe recommends that the tailpipe be at least 1/2"-1" away from any body panels to avoid heat related body damage. **Tighten and secure.**

**Caution:** Allow time for your vehicle to cool down prior to installation. When working on or under your vehicle proceed with caution. Exhaust systems reach high temperatures and may cause serious burns. Wear protective safety equipment; eye goggles and gloves to ensure a safe installation. **aFe recommends professional installation on our products.**