



# INSTALLATION INSTRUCTIONS

Cat -Back Exhaust

**MAKE:** Dodge/RAM  
**MODEL:** 1500/ 1500 Classic  
**YEAR:** 09-18/19-22 (Classic) Note: Does Not Fit 2019 RAM 1500 (DT)  
**ENGINE:** 5.7L

49-42074-B  
 49-42074-P

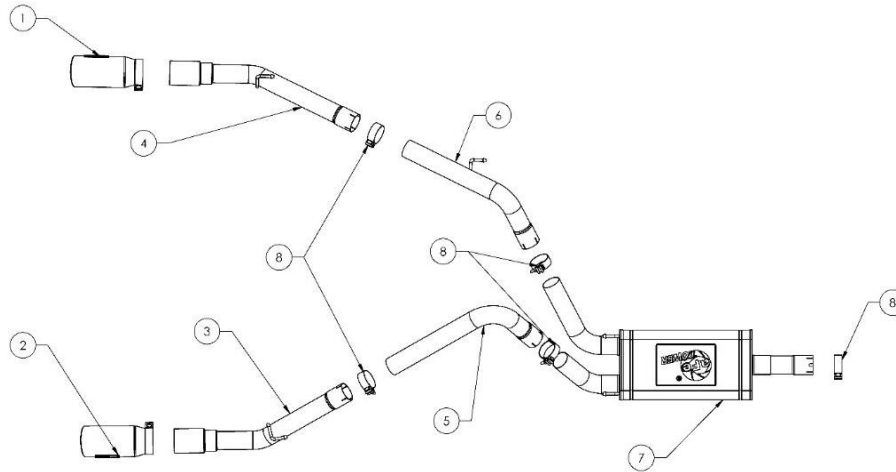

Item	Description	Part Number	Quantity
1	EXH Tip 4 In x 5 Out, 12L Black	49T40501-B12	1
1	EXH Tip 4 In x 5 Out, 12L Polished	49T40501-P12	1
2	EXH Tip 4 In x 5 Out, 12L Black	49T40502-B12	1
2	EXH Tip 4 In x 5 Out, 12L Polished	49T40502-P12	1
3	Right Tail Pipe Assembly	05-144819	1
4	Left Tail-Pipe Assembly	05-144818	1
5	Right Over-Axle Assembly	05-44231	1
6	Left Over-Axle Assembly	05-44230	1
7	Muffler Assembly	05-44247	1
8	Clamp, Band: 3"	05-41055	5

**aFe POWER recommends professional installation on this product.** Thoroughly inspect the aFe POWER exhaust system to make sure there is no damage from shipping (if damage is noted, immediately contact aFe POWER customer service). Allow time for your vehicle to cool down prior to installation. When working on your vehicle proceed with caution. Wear protective safety equipment; eye goggles and gloves to ensure a safe installation.

Install band clamps to proper torque specifications of 40-45 ft-lb.





## INSTALLATION INSTRUCTIONS

**MAKE:** Dodge/RAM  
**MODEL:** 1500/ 1500 Classic  
**YEAR:** 09-18/19-22 (Classic) Note: Does Not Fit 2019 RAM 1500 (DT)  
**ENGINE:** 5.7L

**Cat -Back Exhaust**

49-42074-B

49-42074-P

1. **(Read instructions prior to installation.)** It is recommended to not fully tighten the exhaust until it has been fully installed. Leave loose for adjustability.
2. Secure vehicle on jack stands (refer to your manual for specified jack stand positions).
3. For faster installation, spread out the parts of the exhaust alongside your vehicle as shown in the diagram above.
4. Secure the stock exhaust with jack/stands.
5. Remove the exhaust up to clamp just in front of the O.E. muffler assembly.
6. Install the aFe power Muffler assembly using the provided band 3" clamp.
7. Install the driver's side over-axle pipe using the provided 3" band clamp. Slide the hanger into the O.E isolation mount.
8. Install the Driver's side tailpipe and tip using the provided clamps. Slide the hanger into the O.E. isolation mount.
9. Install the passenger's side over-axle pipe using the provided 3" band clamp.
10. Install the passenger's side tailpipe and tip using the provided clamps. Slide the hanger into the O.E. isolation mount.
11. Adjust the exhaust system and tips to desired position.
12. Ensure that all the components of the aFe POWER exhaust system are aligned and are at a safe clearance from all wires, hoses, brake lines, body parts, and tires.
13. Start from the front of the aFe exhaust system and evenly tighten all clamps and fasteners.
14. Start the vehicle and check for any leaks. If any leaks are found, determine cause and repair as necessary.
15. Remove vehicle from jacks stands.
16. It is recommended to re-tighten all clamps and hardware after 50-100 miles.