



# INSTALLATION INSTRUCTIONS

Cat-Back Exhaust

MAKE: GM  
MODEL: Silverado/Sierra 2500  
YEAR: 2020-2022  
ENGINE: V8-6.6L

49-44123-P  
49-44123-B

NOTE: Fits RC/LB 141.4, EC/LB 162.5, and CC/LB 172 WB

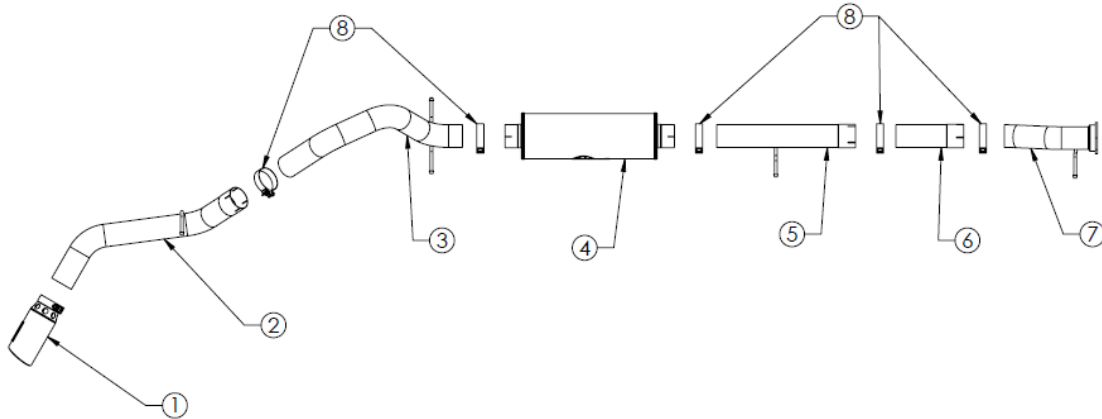

Item	Description	Part Number	Quantity
1	Tip	49T40501-B121	1
1	Tip	49T40501-P121	1
2	Tail Pipe	05-144918	1
3	Over Axle	05-144917	1
4	Muffler	49-91002	1
5	Mid Pipe	05-144919	1
6	Mid Pipe Extension	05-144915	1
7	Front pipe	05-144914	1
8	Band Clamp	05-41172	5

aFe POWER recommends professional installation on this product. Thoroughly inspect the aFe POWER exhaust system to make sure there is no damage from shipping (if damage is noted, immediately contact aFe POWER customer service). Allow time for your vehicle to cool down prior to installation. When working on your vehicle proceed with caution. Wear protective safety equipment; eye goggles and gloves to ensure a safe installation.

Install band clamps to proper torque specifications of 40-45 ft-lb.

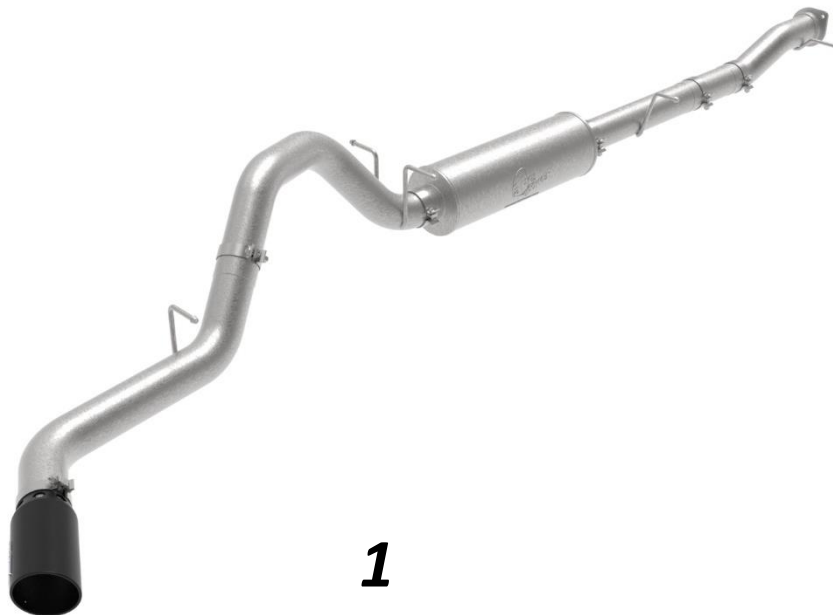



## INSTALLATION INSTRUCTIONS

Cat-Back Exhaust

**MAKE:** GM  
**MODEL:** Silverado/Sierra 2500  
**YEAR:** 2020-2022  
**ENGINE:** V8-6.6L

49-44123-P  
49-44123-B

**NOTE: Fits RC/LB 141.4, EC/LB 162.5, and CC/LB 172 WB**

1. **(Read instructions prior to installation.)** It is recommended to not fully tighten the exhaust until it has been fully installed. Leave loose for adjustability.
2. Secure vehicle on jack stands (refer to your manual for specified jack stand positions).
3. For faster installation, spread out the parts of the exhaust alongside your vehicle as shown in the diagram above.
4. Secure the stock exhaust with jack/stands.
5. Install the aFe POWER front pipe using the 2 O.E. nuts removed in step 1. Slide the hanger into the O.E. isolation mount.
6. For the CC/LB 172" wheelbase install the extension pipe using the provided 4" band clamp. If installing on the EC/LB 162.5" wheelbase the extension pipe is not needed. If installing on the RC/LB 141.4" wheelbase the extension pipe is not needed.
7. Install the mid pipe using the provided 4" band clamp. Slide the hanger into the O.E. isolation mount. If installing on the RC/LB 141.4" wheelbase the mid pipe is not needed.
8. Install the muffler using the provided 4" band clamps.
9. Install the over-axle pipe using the provided 4" band clamps. Slide the hangers into the O.E. isolation mounts.
10. Install the tailpipe using the provided 4" band clamp. Slide the hanger into the O.E. isolation mount.
11. Install the Tip and adjust the system to preference.
12. Ensure that all the components of the aFe POWER exhaust system are aligned and are at a safe clearance from all wires, hoses, brake lines, body parts, and tires.
13. Start from the front of the aFe exhaust system and evenly tighten all clamps and fasteners.
14. Start the vehicle and check for any leaks. If any leaks are found, determine cause and repair as necessary.
15. Remove vehicle from jacks stands.
16. It is recommended to re-tighten all clamps and hardware after 50-100 miles.