

GT
MOMENTUM

advanced FLOW engineering

Cold Air Intake System

Instruction Manual P/N: 50-70124D/50-70124R

Make: LEXUS

Model: GX550

Year: 2024-2025

Engine: V6-3.4L (tt)



- Please read the entire instruction manual before proceeding.
- Ensure all components listed are present.
- If you are missing any of the components, call customer support at 951-493-7185.
- Ensure you have all necessary tools before proceeding.
- Do not attempt to work on your vehicle when the engine is hot.
- Retain factory parts for future use.

Label	Qty.	Description	Part Number
A	2	Air Filter (Pro 5R) For 50-70124R	20-91203R
A	2	Air Filter (Pro DRY S) For 50-70124D	20-91203D
B	1	Tube: Driver Side	05-5070091B1
C	1	Tube: Passenger Side	05-5070091B2
D	1	Housing: Driver Side	05-5070124B3
E	1	Housing: Passenger Side	05-5070124B4
F	2	Coupler, Silicone Elbow Reducer: (3"x2-1/2")IDx 35Deg	05-01421
G	2	Clamp, 044 (2-5/16" - 3-1/4")	03-50019
H	2	Clamp, 048 (2-9/16" - 3-1/2 ")	03-50007
J	10	Push-in Rivet, Christmas Tree Style	03-50616
K	1	Gasket, Inlet Passenger Side: 05-5070124B4	05-01762
M	1	Gasket, Inlet Driver Side: 05-5070124B3	05-01711
N	4	Screw, Torx: M4 x 10mm	03-50490
P	2	Alcohol Wipes	05-01716

Installation will require the following tools:

8mm and 10mm Nut Drivers or Ratchet and Sockets, 8mm Nut Driver or Ratchet and socket, Flat Head and Phillips Screwdriver, T20 Torx Driver.

Warranty Information available at: <https://afepower.com/contact#warranty>

Emissions Disclaimer: This product is not currently CARB exempt and is not available for purchase in California or for use on any vehicle registered with the California Department of Motor Vehicles.

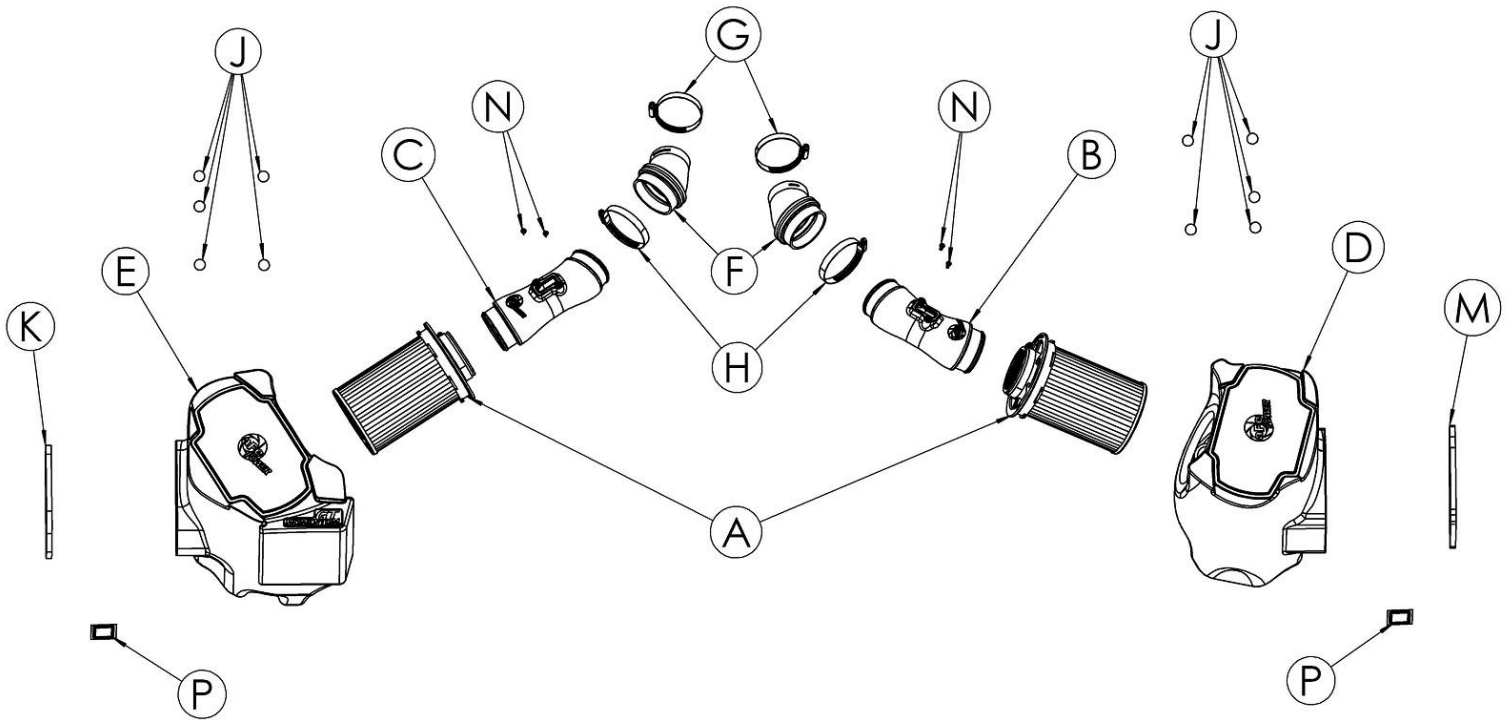

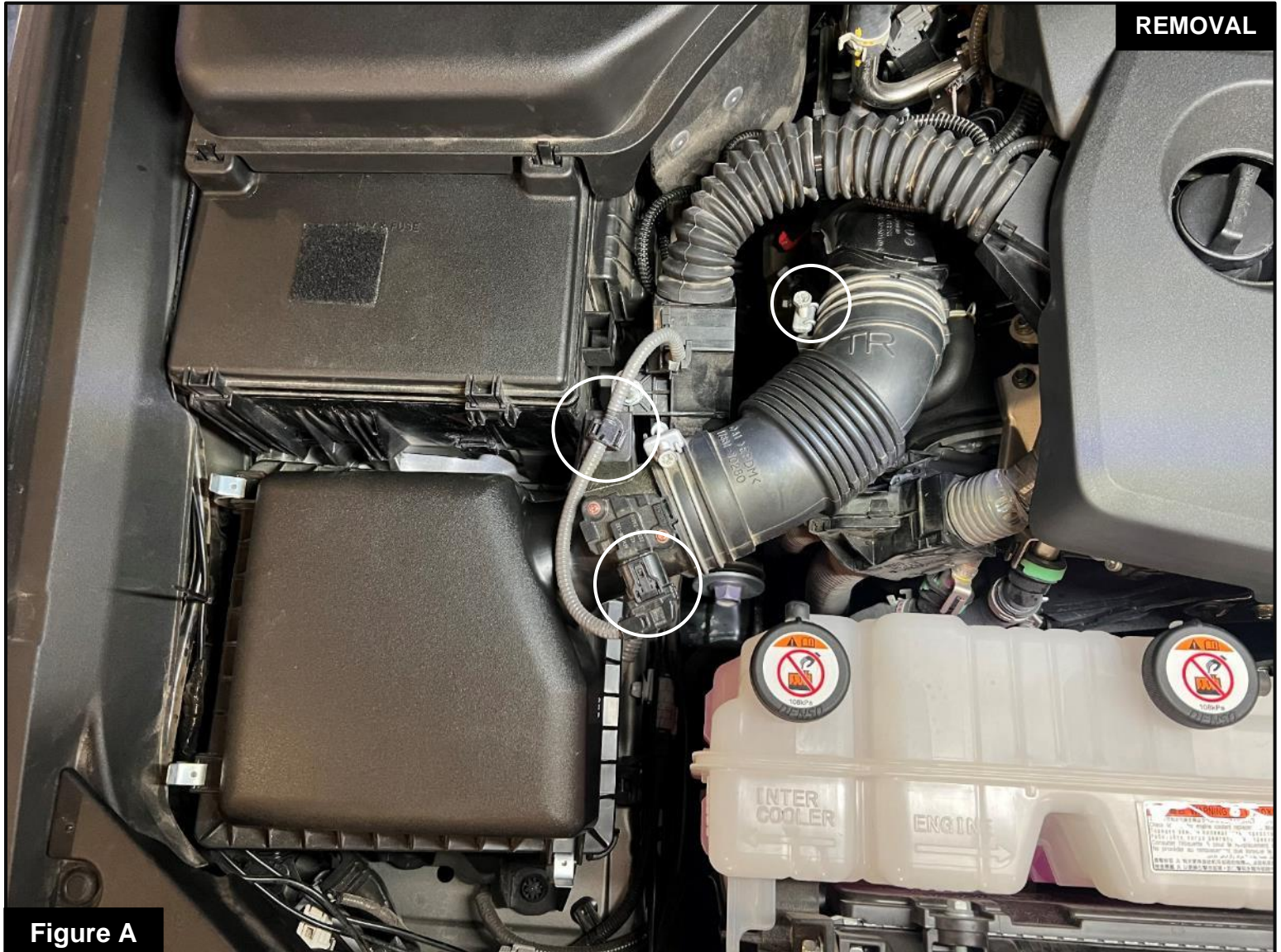

Figure A

Refer to Figure A for Steps 1-3

Step 1: Disconnect the passenger side Mass Air Flow (MAF) sensor and unclip the harness from the airbox.

Step 2: Loosen the clamp securing the intake tube to the turbo inlet, using a 10mm socket or nut driver.

Step 3: Lift the passenger side air intake assembly from the vehicle by firmly pulling the grommets out of the mounts.



Refer to Figure B for Step 4

Step 4: Remove the (2) two 10mm screws securing the passenger side air inlet duct, then remove the duct from the vehicle.



Refer to Figure C for Step 5

Step 5: Transfer the (3) three grommets from the passenger side factory air box to the aFe POWER passenger side housing.

**Figure D****Refer to Figure D for Step 6**

Step 6: Wipe the non-texture surface of the air inlet with the provided cleaning wipe to remove any residual mold release. Wait for the alcohol to evaporate, then apply the foam gasket onto the surface of the air inlet.

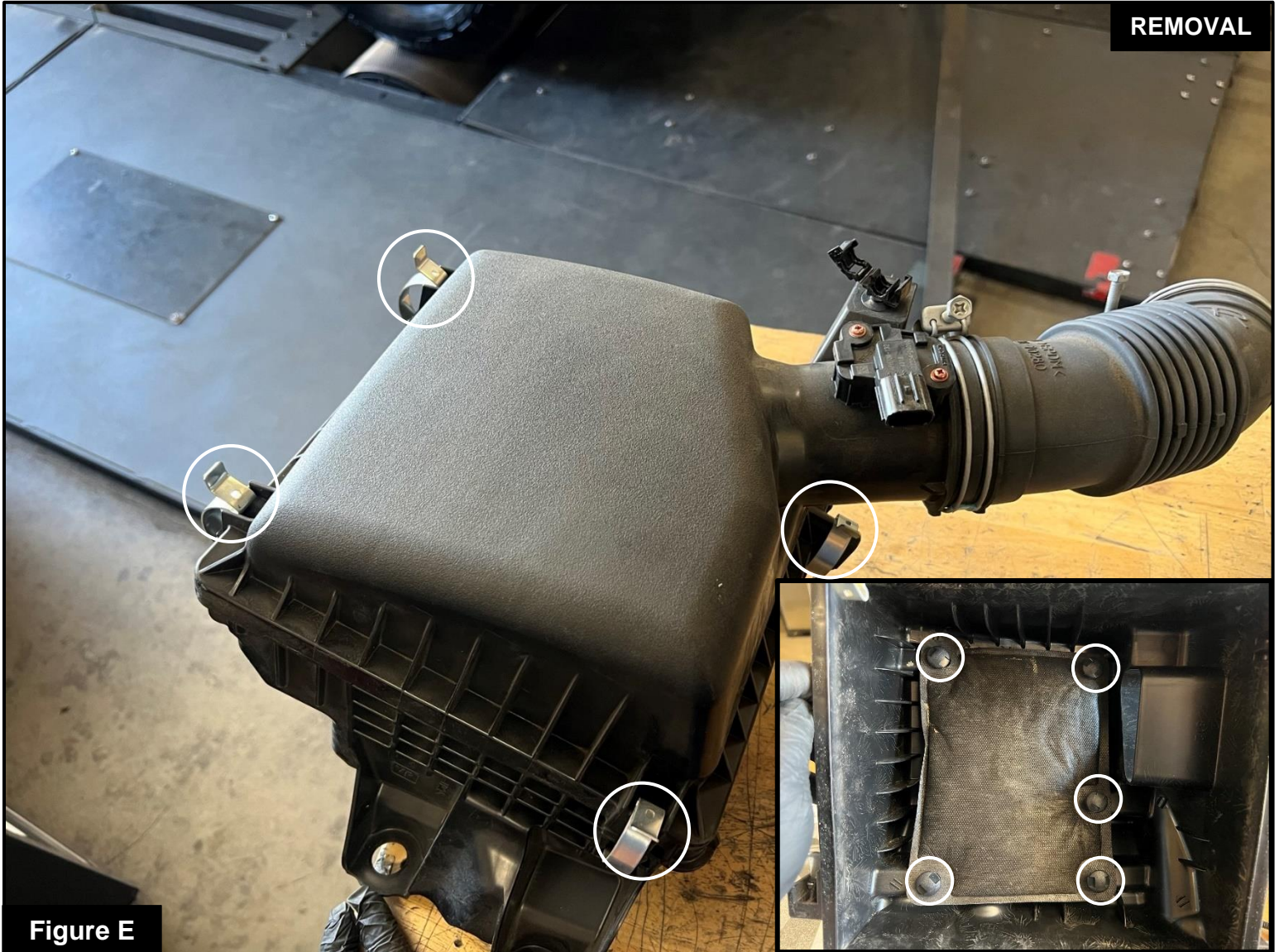
**Figure E****Refer to Figure E for Steps 8-9**

Step 8: Unlatch the (4) four clips securing the top of the factory airbox, and then remove the top portion of the airbox.

Step 9: Using a pry tool, remove the (5) five clips holding down the charcoal pouch.

**Figure E****Refer to Figure E for Step 10**

Step 10: Secure the charcoal pouch onto the inside of the aFe POWER airbox using the (5) five provided push clips.

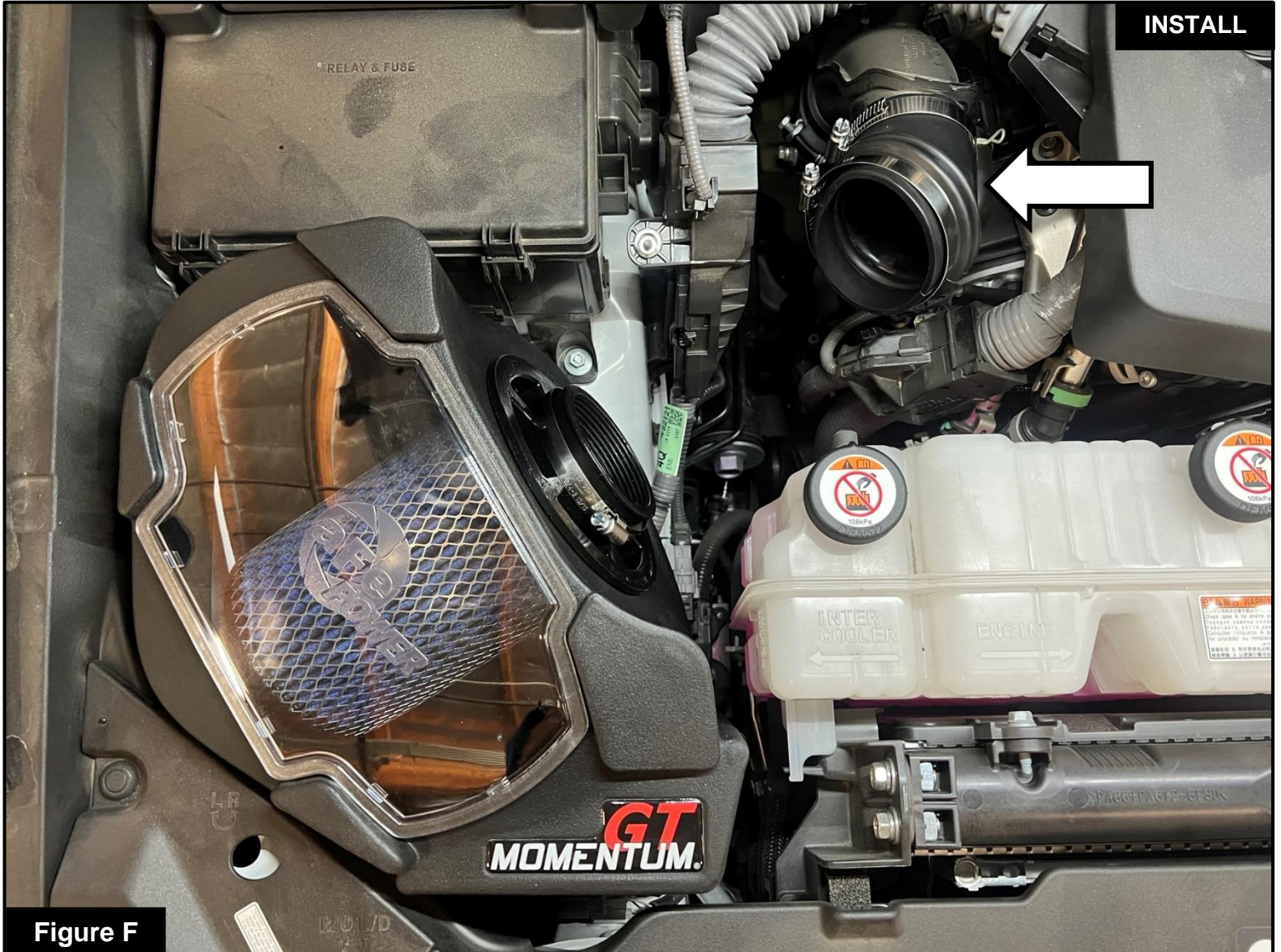

Figure F

Refer to Figure F for Step 11-13

Step 11: Install the aFe POWER air box into the vehicle. Make sure the housing is secured onto the (3) three mounting pegs.

Step 12: Install the aFe POWER air filter into the housing by firmly pushing it into the housing until the filter tabs lock it into place. Install the clamp onto the filter, but do not tighten at this time.

Step 13: Loosely install the clamps onto the aFe POWER coupler, and then install the coupler onto the turbo inlet as shown. Do not tighten the clamps at this time.

**Figure G****Refer to Figure G for Step 14**

Step 14: Transfer the MAF sensor from the passenger side factory intake to the aFe POWER intake tube and secure it using the provided M4 T-20 Torx screws.

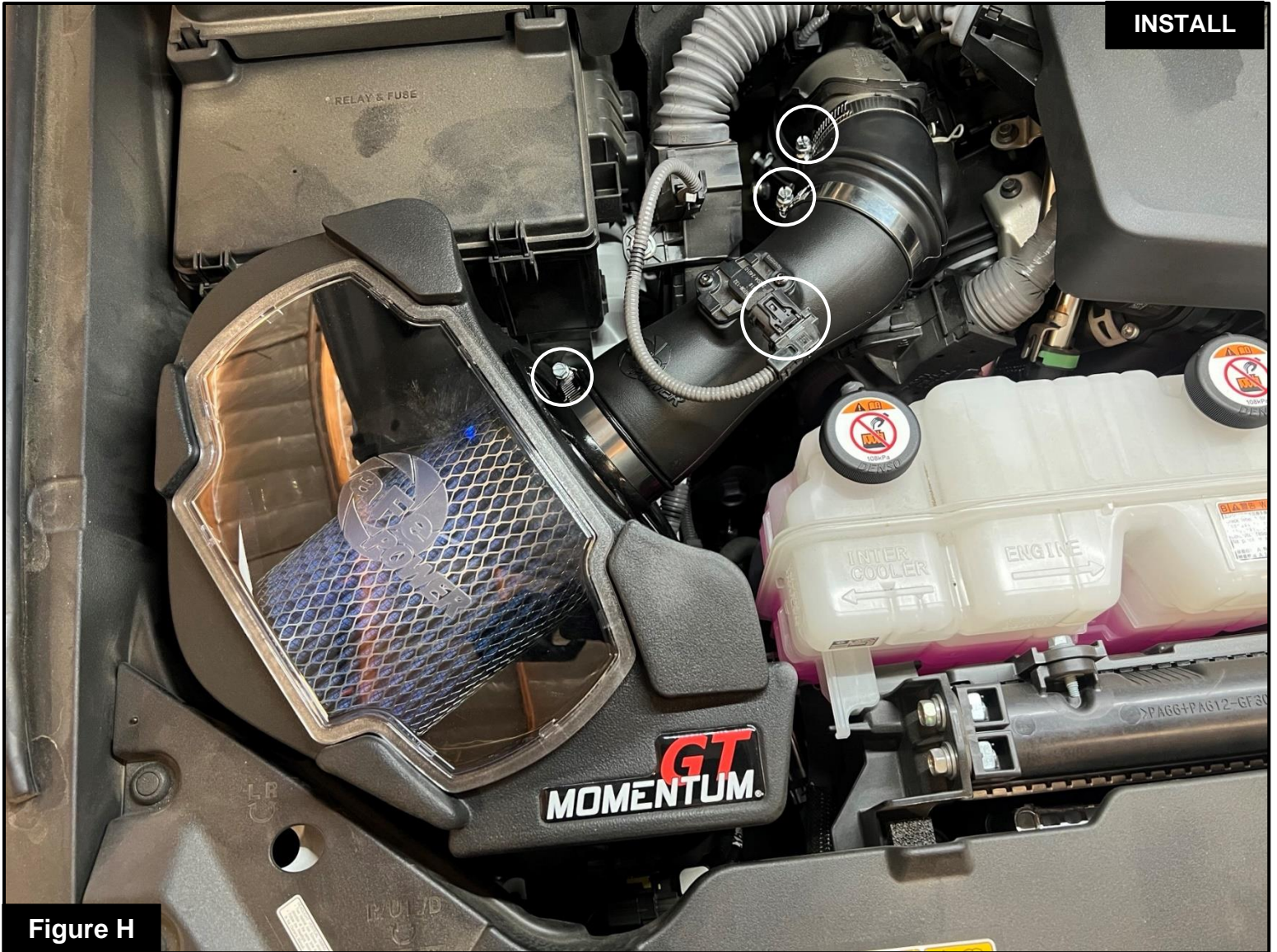

Refer to Figure H for Steps 15-16

Step 15: Install the aFe POWER passenger side intake tube between the coupling and filter. Align the tube and coupler and then tighten all clamps.

Step 16: Connect the MAF sensor harness to the MAF sensor.

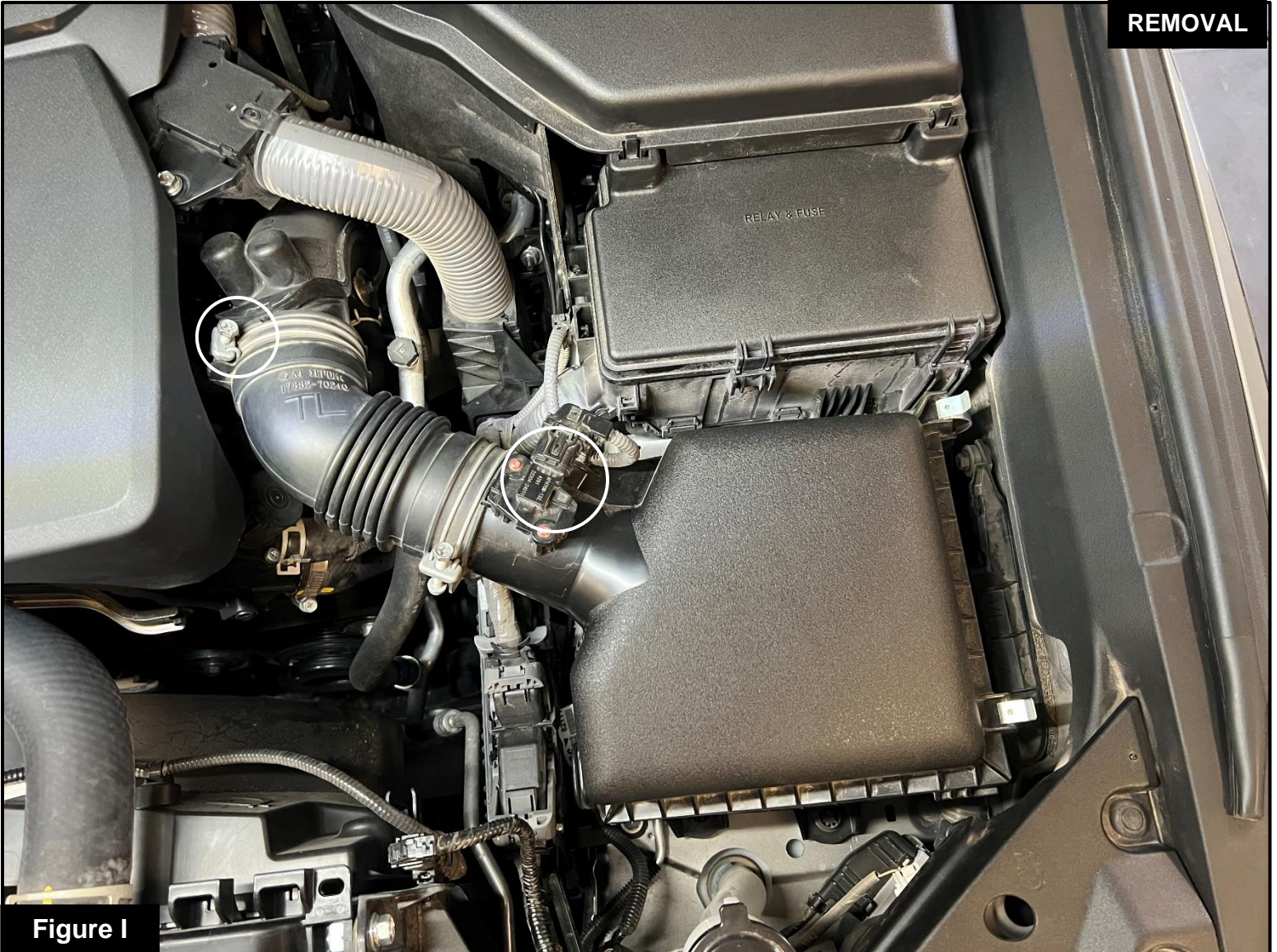
**Figure I****Refer to Figure I for Steps 17-19**

Step 17: Disconnect the driver side MAF sensor and unclip the harness from the airbox.

Step 18: Loosen the clamp securing the intake tube to the turbo inlet, using a 10mm socket or nut driver.

Step 19: Lift the driver side air intake assembly from the vehicle by firmly pulling the grommets out of the mounts.

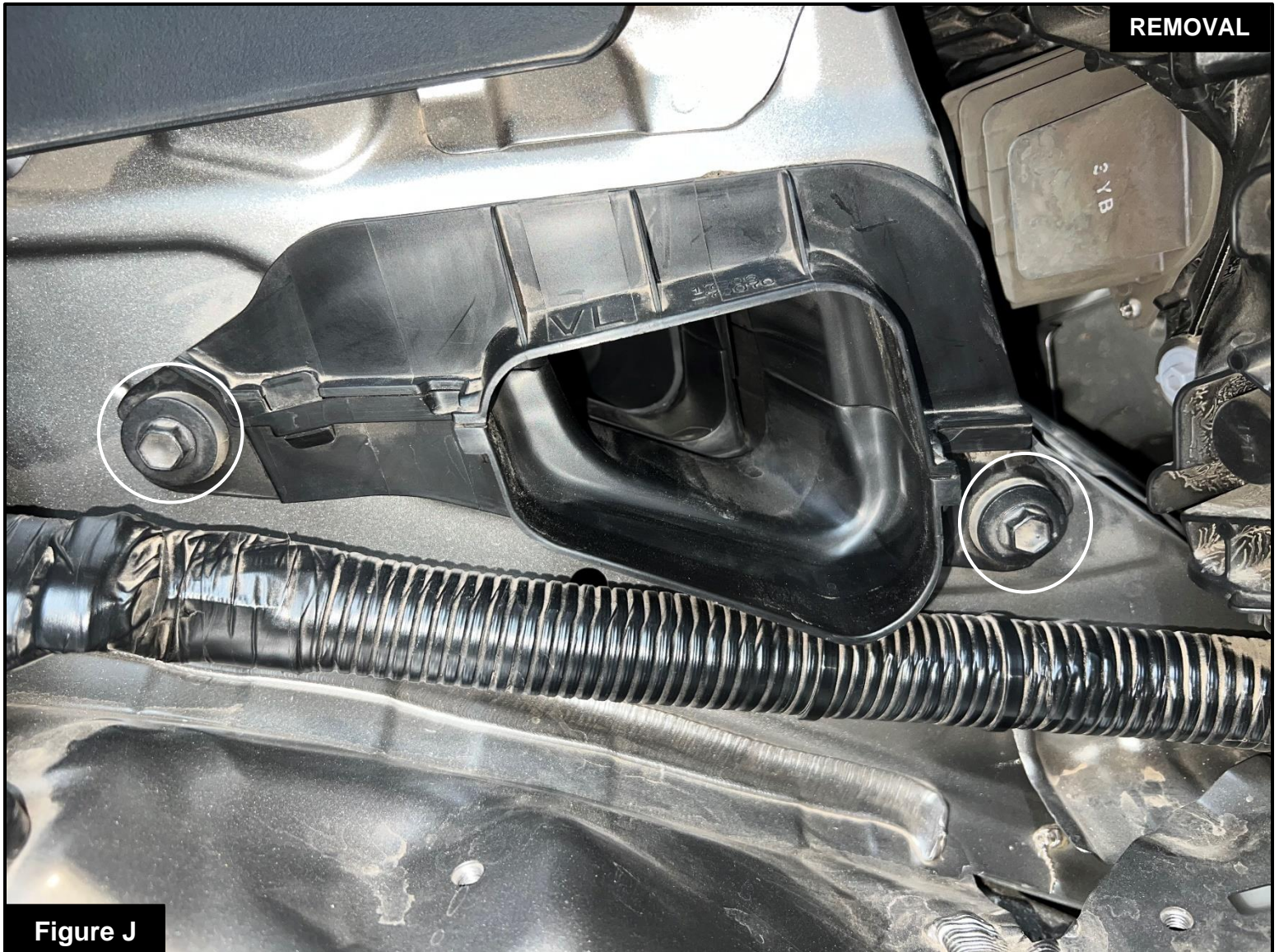

Figure J

Refer to Figure J for Step 20

Step 20: Remove the two 10mm screws securing the driver side air inlet duct, then remove the duct from the vehicle.

**Figure K****Refer to Figure K for Step 21**

Step 21: Transfer the (3) three grommets from the driver side factory air box to the aFe POWER driver side air box.



Figure L

Refer to Figure L for Step 23

Step 23: Wipe the non-texture surface of the aFe POWER air box with the provided cleaning wipe to remove any residual mold release. Wait for the alcohol to evaporate, then apply the foam gasket onto the surface of the air inlet.

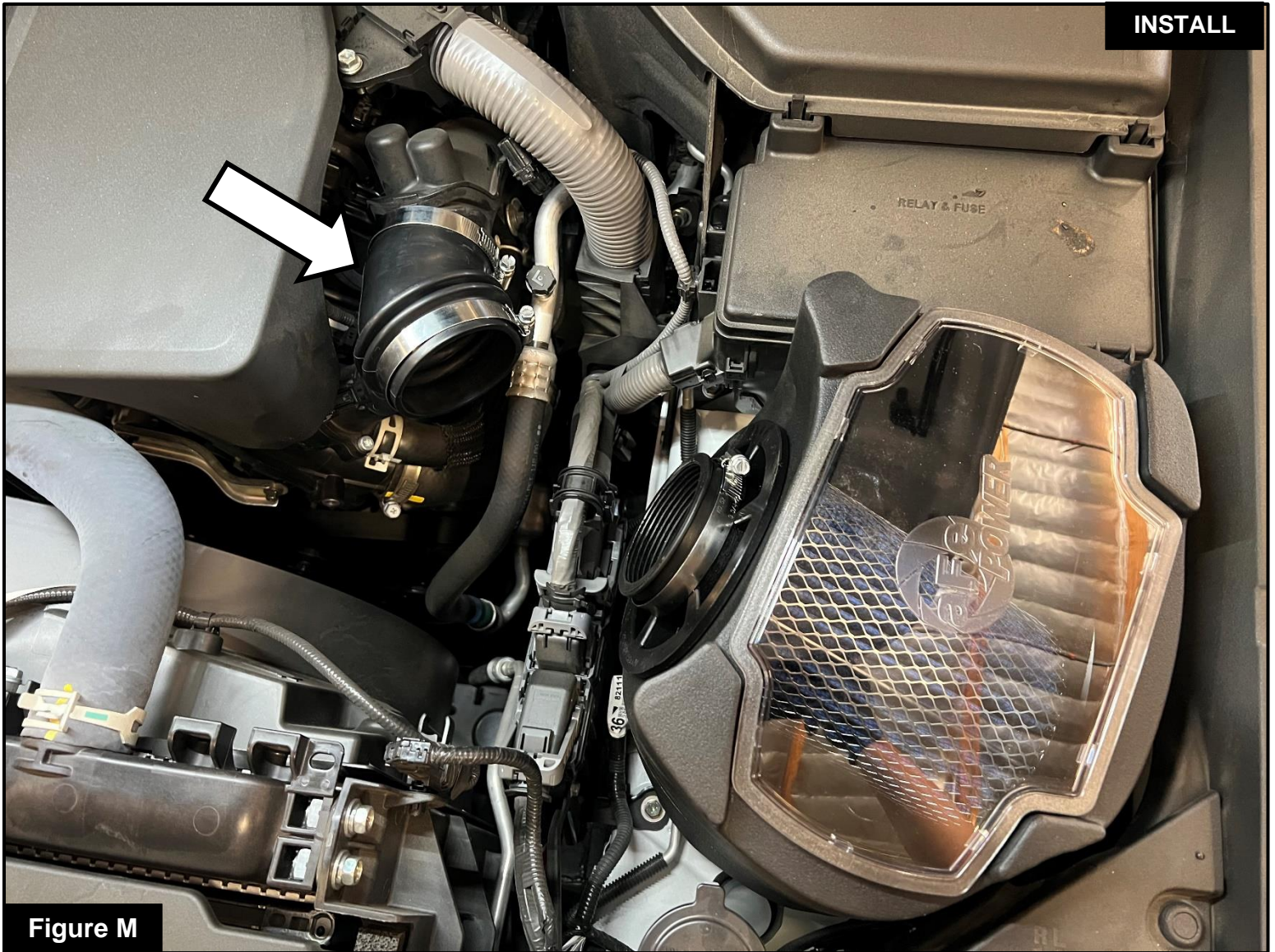

Figure L

Refer to Figure L for Steps 24-25

Step 24: Using a pry tool, remove the (5) five clips holding down the charcoal pouch.

Step 25: Install the (5) five provided push clips to secure the charcoal pouch onto the inside of the aFe POWER airbox.

**Figure M****Refer to Figure M for Steps 26-28**

Step 26: Install the aFe POWER air box into the vehicle. Make sure the housing is secured onto the (3) three mounting pegs.

Step 27: Install the aFe POWER air filter into the housing by firmly pushing it into the housing until the filter tabs lock it into place. Install the clamp onto the filter, but do not tighten at this time.

Step 28: Loosely install the clamps onto the aFe POWER coupler, and then install the coupler onto the turbo inlet as shown. Do not tighten the clamps at this time.

**Figure O****Refer to Figure N for Step 29**

Step 29: Transfer the MAF sensor from the driver side factory intake to the aFe POWER intake tube and secure it using the provided M4 T20-Torx screws.

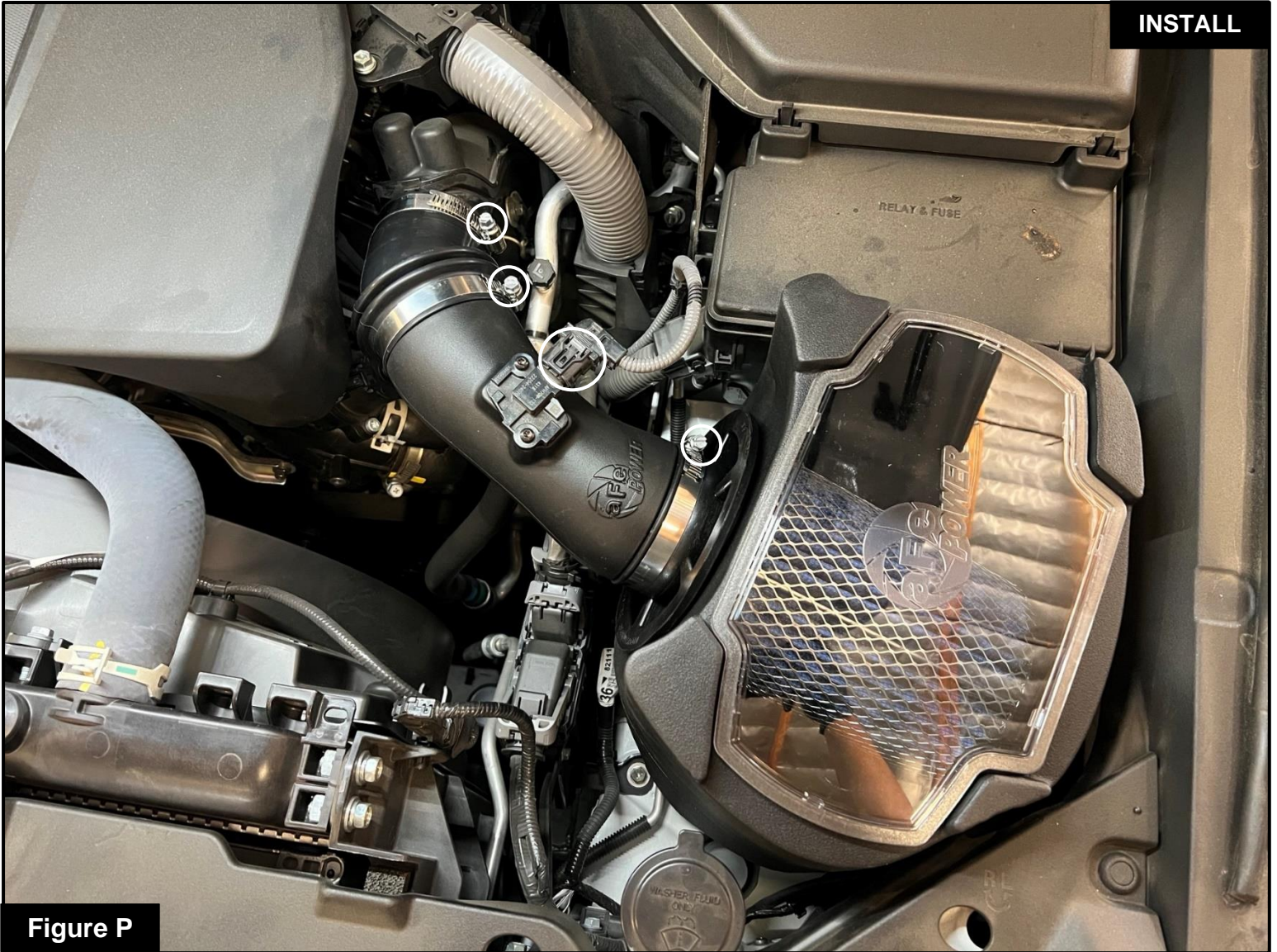
**Figure P****Refer to Figure P for Steps 30-31**

Step 30: Install the aFe POWER driver side intake tube between the coupling and filter. Align the tube and coupling and then tighten all clamps.

Step 31: Connect the MAF sensor harness to the MAF sensor.



Figure Q

Refer to Figure Q for Step 32

Step 32: Make sure all clamps and connections are secured. Your installation is now complete. Thank you for choosing aFe POWER!



PAGE LEFT BLANK INTENTIONALLY



PAGE LEFT BLANK INTENTIONALLY



advanced FLOW engineering, Inc.

Corona, CA 92879

<https://afepower.com/contact>